

PLAN	SURVEYED	BY	DATE
NOTE BOOK	PLOTTED		
NO.	CHECKED		
	AT		
	MAX		
	FILE		
	NAME		

PROFILE	SURVEYED	BY	DATE
NOTE BOOK	PLOTTED		
NO.	CHECKED		
	AT		
	MAX		
	FILE		
	NAME		

MATCH LINE STA. 552+00
SEE SHT. 2 FOR CONT.

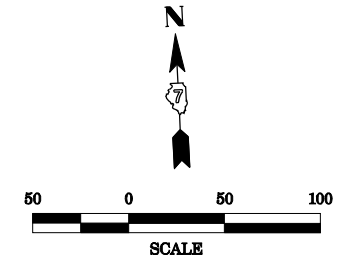
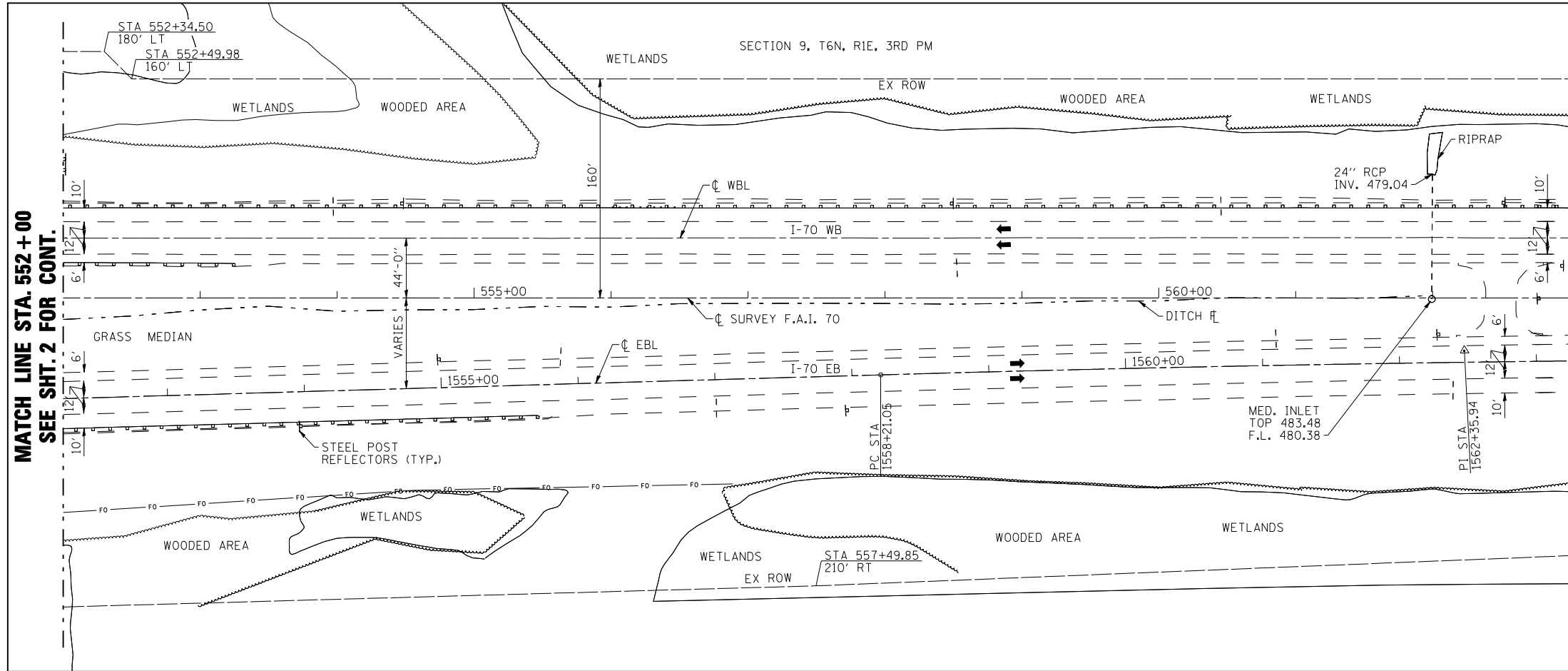

☉ EBL CURVE DATA
 PI STA 1562+35.94
 $\Delta = 1^{\circ} 39' 46''$ (RT)
 $D = 0^{\circ} 12' 01''$
 $R = 28,591.87'$
 $T = 414.89'$
 $L = 829.72'$
 $E = 3.01'$
 PC STA 1558+21.05
 PT STA 1566+50.77

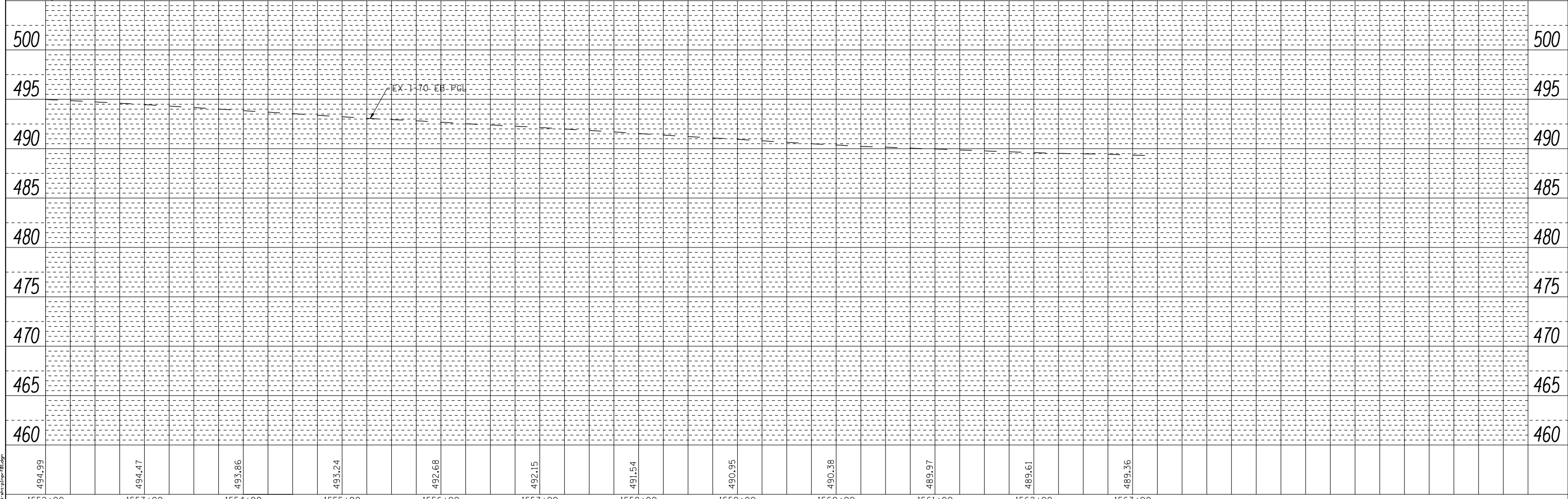

PRINT DRIVER = I:\D:\R\B\B\A\B
 PLOT MAKE = PLOT MAKE
 FILE NAME = D:\7475\145\145\145.dwg



USER NAME = has	DESIGNED - ELH	REVISED -
ESCA PROJECT NO. 1000.05	DRAWN - HAS	REVISED -
SCALEs: (HORIZ) 1"=50' (VERT) 1"=5'	CHECKED - ELH	REVISED -
PLOT DATE = 1/29/2014 1:45:05 PM	DATE - 01/14	REVISED -

STATE OF ILLINOIS
DEPARTMENT OF TRANSPORTATION

SCALE: 1"=50'	SHEET NO. 6 OF 6 SHEETS	STA. 1552+00.00 TO STA. 1563+00.00
---------------	-------------------------	------------------------------------

F.A.I. RTE.	SECTION	COUNTY	TOTAL SHEETS	SHEET NO.
70	(26-3B-1, 3B-1(3))BR	FAYETTE	277	33
CONTRACT NO. 74175				
FED. ROAD DIST. NO.	ILLINOIS FED. AID PROJECT AID			