

Notes:
 See sheet 39 of 113 for Sections C-C & D-D and View E-E.
 $a_6(E)$ thru $a_9(E)$ bar spacings measured along C WBL.
 Bars indicated thus 15 x 2-#4 etc. indicates 15 lines of bars with 2 lengths per line.
 Order all bars full length. Cut bars in field to fit inlet boxes.

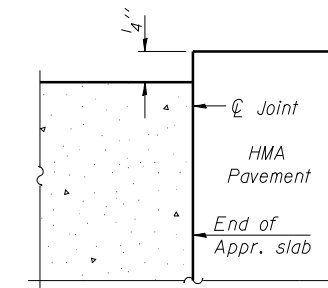

FLEXIBLE PAVEMENT
 DETAIL A

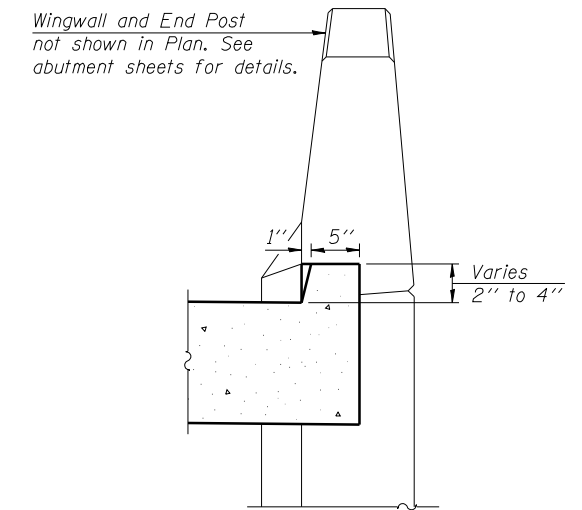

VIEW B-B

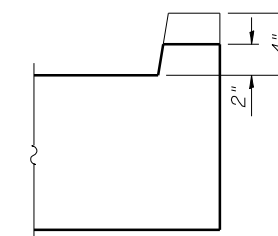

VIEW F-F

(Sheet 1 of 2)

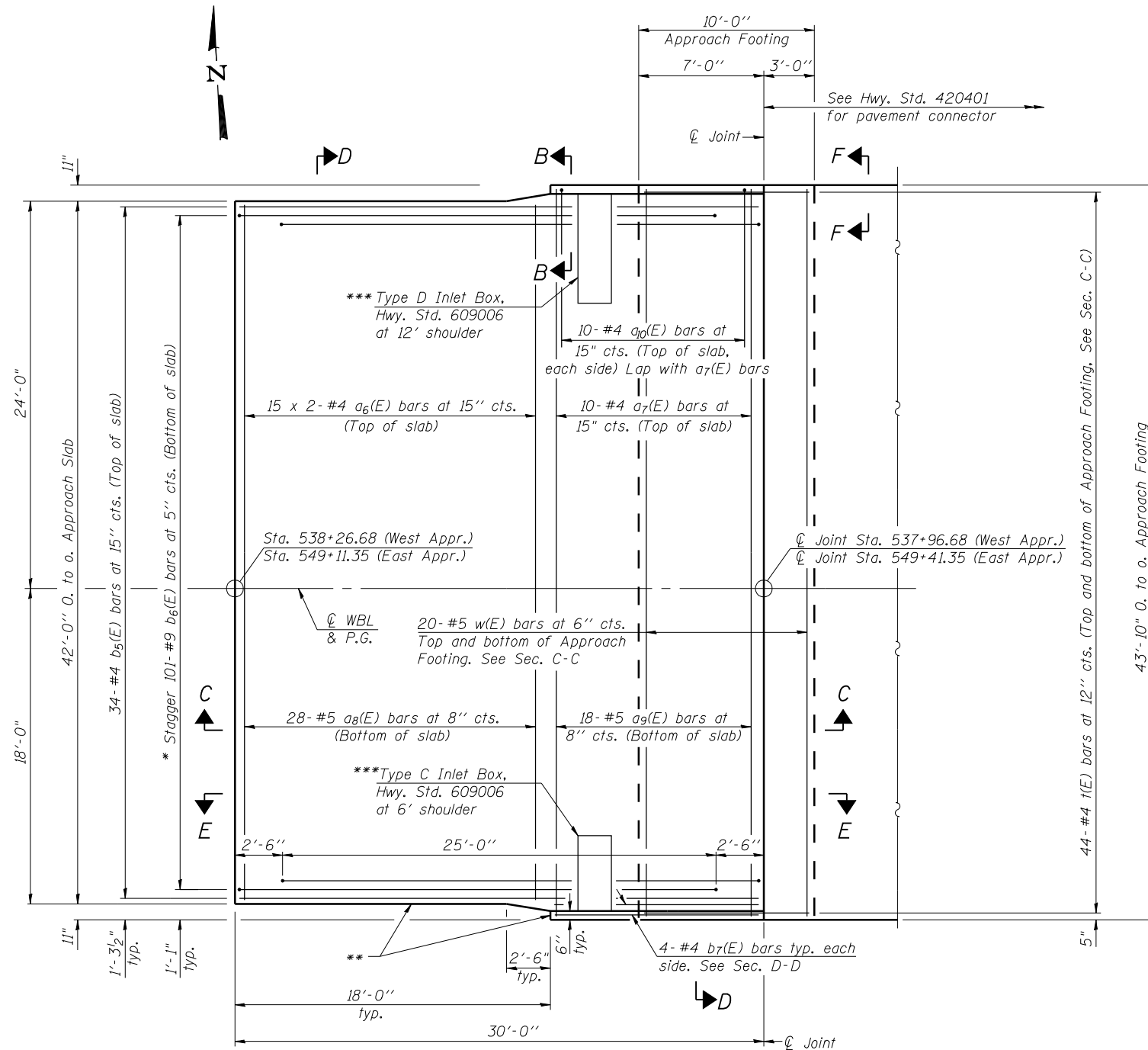

PLAN

(East approach shown; west approach opposite hand)

- * Tilt #9 $b_6(E)$ bars as required to maintain clearance.
- ** Preformed flexible foam expansion joint filler according to Article 1051.09 of the Std. Specifications; full depth of slab, full length of wingwall. Typ. each wingwall.
- *** See Roadway plans for details and quantities.

MINIMUM BAR LAP

(Approach slab)
 #4 bar = 2'-4"



USER NAME = hos	DESIGNED - SHL	06/13	REVISED -
ESCA PROJECT NO. 1070.09	CHECKED - MTD	08/13	REVISED -
	DRAWN - DWH/JPC	08/13	REVISED -
PLOT DATE = 1/28/2014 1:07:36 PM	CHECKED - ELH	10/13	REVISED -

STATE OF ILLINOIS
 DEPARTMENT OF TRANSPORTATION

BRIDGE APPROACH SLAB DETAILS - WB
 STRUCTURE NO. 026-0106

SHEET NO. 38 OF 113 SHEETS

F.A.I. RTE.	SECTION	COUNTY	TOTAL SHEETS	SHEET NO.
70	(26-3B-1, 3B-1(3))BR	FAYETTE	277	118
				CONTRACT NO. 74175

ILLINOIS FED. AID PROJECT