

PROJECT I-70-205162
 SEC. 26-2HL
 BEGINS STA. 495+23

PROJECT I-70-205162
 SEC. 25-2HL
 ENDS STA. 536+50

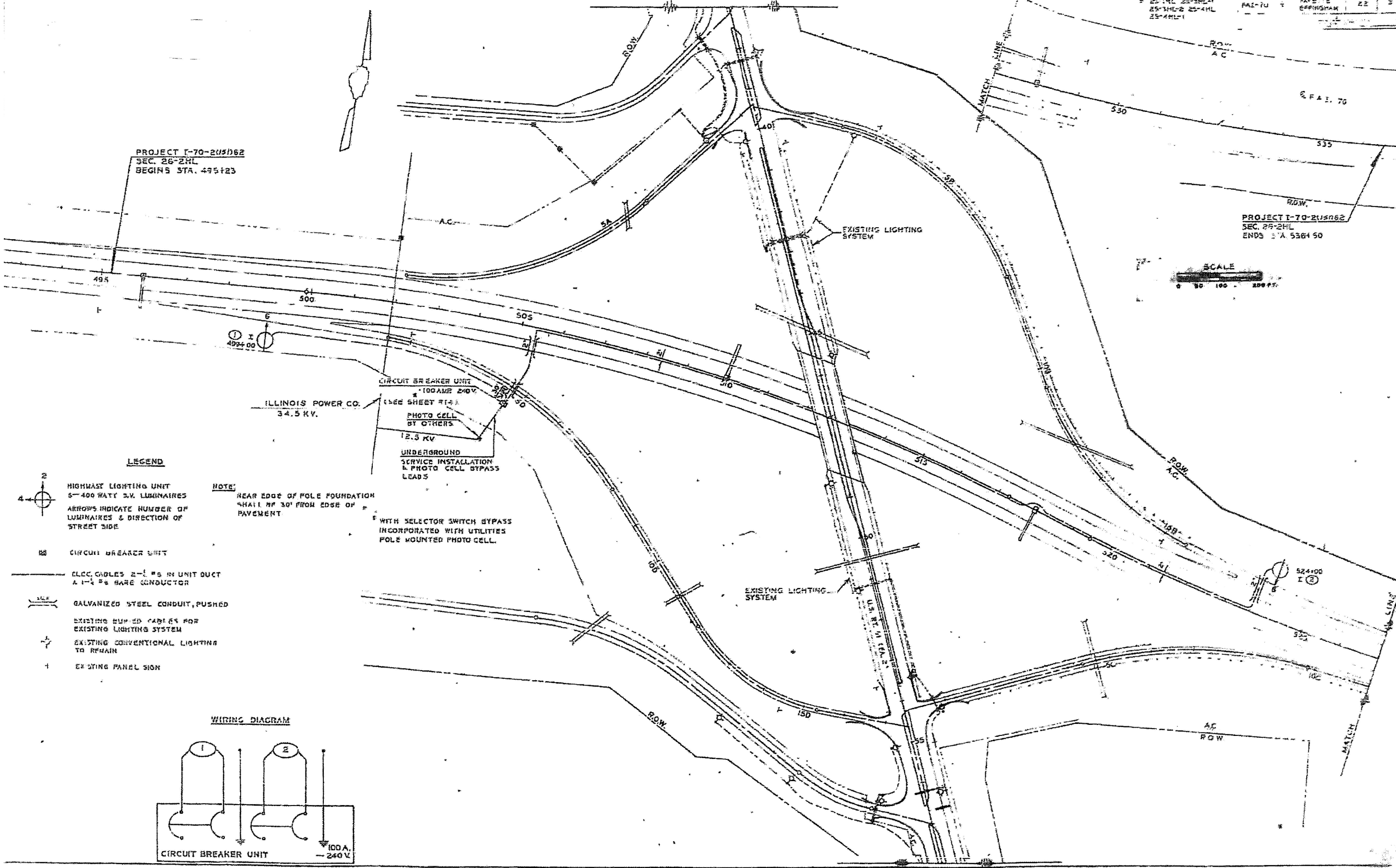

LEGEND

- HIGHMAST LIGHTING UNIT
S-400 WATT 2-V. LUMINAIRE
ARROWS INDICATE NUMBER OF LUMINAIRE & DIRECTION OF STREET SIDE
- CIRCUIT BREAKER UNIT
- ELEC. CABLES 2-# IN UNIT DUCT & 1-# BARE CONDUCTOR
- GALVANIZED STEEL CONDUIT, PUSHED
- EXISTING BURIED CABLES FOR EXISTING LIGHTING SYSTEM
EXISTING CONVENTIONAL LIGHTING TO REMAIN
EXISTING PANEL SIGN

NOTE:
 REAR EDGE OF POLE FOUNDATION SHALL BE 30' FROM EDGE OF PAVEMENT

CIRCUIT BREAKER UNIT
 * 100 AMP 240 V.
 (SEE SHEET #14)
 PHOTO CELL BY OTHERS
 12.5 KV
 UNDERGROUND SERVICE INSTALLATION & PHOTO CELL BYPASS LEADS

WITH SELECTOR SWITCH BYPASS INCORPORATED WITH UTILITIES POLE MOUNTED PHOTO CELL.

WIRING DIAGRAM

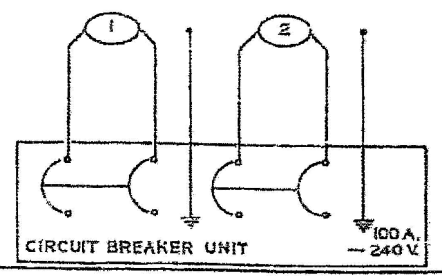

F.A.I. ROUTE 70 & U.S. ROUTE 51 INTERCHANGE

PRINT DRIVER: LEO E. BARNETT
 SCALE: AS SHOWN
 FILE NAME: I-70-205162-25-2HL-1.DWG

USER NAME = has	DESIGNED - MES	REVISED -
ESCA PROJECT NO. 1000.05	DRAWN - HAS	REVISED -
PLOT SCALE = 0/2" = 1' / IN.	CHECKED - MES	REVISED -
PLOT DATE = 1/29/2014 2:00:08 PM	DATE - 11/13	REVISED -

**STATE OF ILLINOIS
 DEPARTMENT OF TRANSPORTATION**

**EXISTING INTERCHANGE LIGHTING PLAN
 FOR INFORMATION ONLY**

SCALE: SHEET NO. 1 OF 1 SHEETS STA. TO STA.

F.A.I. RTE.	SECTION	COUNTY	TOTAL SHEETS	SHEET NO.
70	(26-3B-1, 3B-1(3))BR	FAYETTE	277	244A
FED. ROAD DIST. NO. ILLINOIS FED. AID PROJECT			CONTRACT NO. 74175	