

WEST MEDIAN CROSSOVER - EB NOTES

1. SPLICE TEMPORARY CABLE TO EXISTING CONDUCTORS IN TOWER HANDHOLE. EXISTING TOWER AND LUMINAIRES SHALL REMAIN OPERATIONAL DURING AND AFTER CONSTRUCTION. THE COST OF THIS WORK SHALL BE INCLUDED IN THE TEMPORARY LIGHTING SYSTEM PAY ITEM. SEE TOWER 1 ON EXISTING AS-BUILT DRAWING.
2. ALL TEMPORARY LUMINAIRES AT THIS CROSSOVER SHALL BE TILTED TEN DEGREES UP FROM THE STANDARD TILT OF 45 DEGREES.
3. SPAN BETWEEN TEMPORARY POLES 2 AND 3 IS UNDERGROUND TO AVOID CONFLICT WITH OVERHEAD UTILITY LINES. INSTALL AERIAL CABLE IF THERE IS ADEQUATE CLEARANCE.

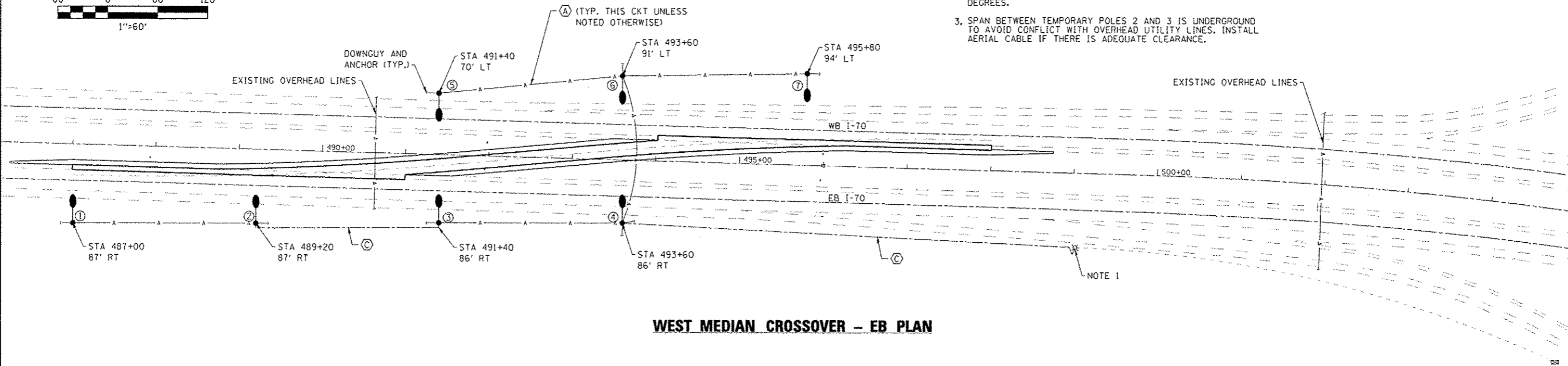

WEST MEDIAN CROSSOVER - EB PLAN

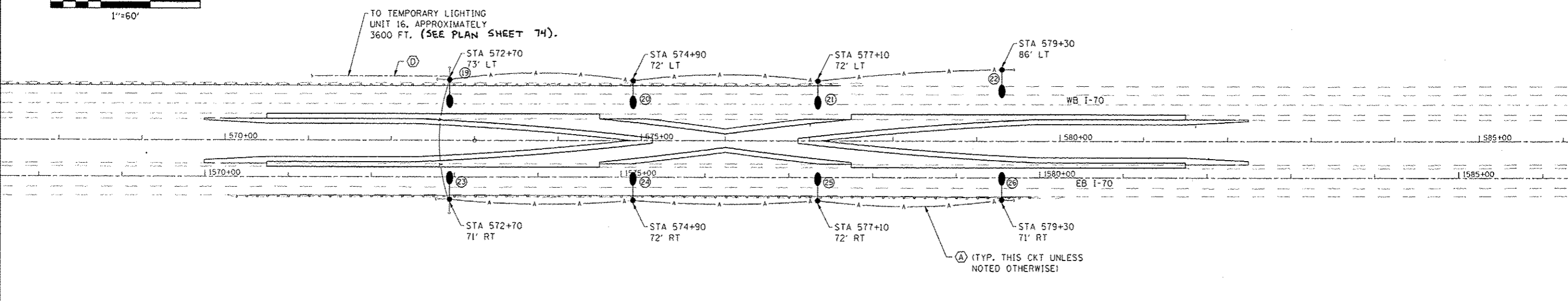
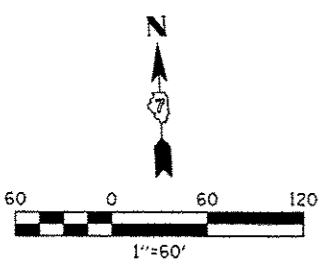

EAST MEDIAN CROSSOVERS PLAN

PLOT DATE: 1/29/2014 1:59:28 PM
 USER: has
 ESCA PROJECT NO: 1008-05
 PLOT SCALE: 0.2" = 1' IN.
 DATE: 11/13

USER NAME - has	DESIGNED - MES	REVISED -
ESCA PROJECT NO. 1008-05	DRAWN - HAS	REVISED -
PLOT SCALE - 0.2" = 1' IN.	CHECKED - MES	REVISED -
PLOT DATE - 1/29/2014 1:59:28 PM	DATE - 11/13	REVISED -

STATE OF ILLINOIS
DEPARTMENT OF TRANSPORTATION

TEMPORARY LIGHTING DETAILS

SCALE: SHEET NO. 2 OF 4 SHEETS STA. TO STA.

P.A.I. RTE.	SECTION	COUNTY	TOTAL SHEETS	SHEET NO.
70	(26-3B-1, 3B-1(3))BR	FAYETTE	277	73
CONTRACT NO. 74175				
FED. ROAD DIST. NO. ILLINOIS FED. AID PROJECT				