

SPBGR, 775.0'  
 STA. 2779+19.09 TO STA. 2786+94.09  
 TRAFFIC BARRIER TERMINAL, TYPE 1  
 STA. 2786+94.09 TO STA. 2787+44.09  
 TRAFFIC BARRIER TERMINAL, TYPE 6  
 STA. 2778+75.34 TO STA. 2779+19.09  
 GUARDRAIL REMOVAL 385'

PROPOSED PREFORMED PLASTIC  
 PAVEMENT MARKING TYPE B - INLAID - LINE 6"

PROPOSED HOT-MIX  
 ASPHALT SHOULDERS (2 1/4")

EXISTING R.O.W. LINE

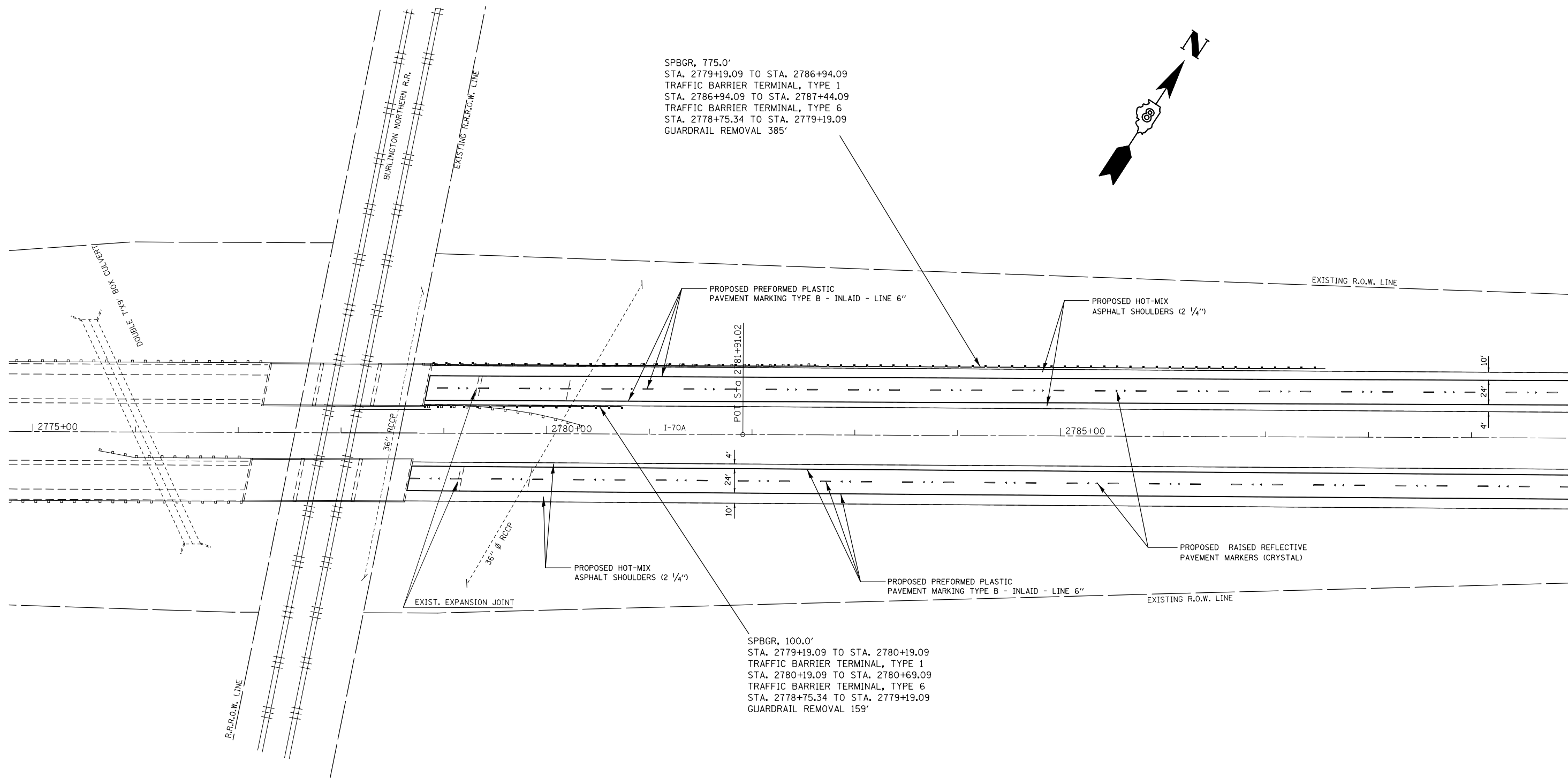

SPBGR, 100.0'  
 STA. 2779+19.09 TO STA. 2780+19.09  
 TRAFFIC BARRIER TERMINAL, TYPE 1  
 STA. 2780+19.09 TO STA. 2780+69.09  
 TRAFFIC BARRIER TERMINAL, TYPE 6  
 STA. 2778+75.34 TO STA. 2779+19.09  
 GUARDRAIL REMOVAL 159'

FILE NAME =	USER NAME = wedmore_jb	DESIGNED -	REVISED -
et:\pw\work\p\dot\wedmore_jb\d0149884\0876021-sh1-plan.dgn		DRAWN -	REVISED -
	PLOT SCALE = 100.0000' / 1in.	CHECKED -	REVISED -
	PLOT DATE = 3/10/2014	DATE -	REVISED -

**STATE OF ILLINOIS  
 DEPARTMENT OF TRANSPORTATION**

**PLAN SHEETS**

SCALE: SHEET NO. OF SHEETS STA. TO STA.

F.A.I. RTE.	SECTION	COUNTY	TOTAL SHEETS	SHEET NO.
70	3-5RS-3	BOND	59	22
CONTRACT NO. 76D21				
FED. ROAD DIST. NO. ILLINOIS FED. AID PROJECT				

MATCHLINE 2790+00