

EXIST. CURVE CH10R1C1  
 PI STA. = 8+85.27  
 $\Delta$  = 35° 47' 59" (RT)  
 D = 8° 18' 13"  
 R = 690.00'  
 T = 222.86'  
 L = 431.13'  
 E = 35.10'  
 e = ----  
 T.R. = ----  
 S.E. RUN = ----  
 P.C. STA. = 6+62.41  
 P.T. STA. = 10+93.53

SPBGR, 100.0'  
 STA. 3004+08.90 TO STA. 3005+08.90  
 TRAFFIC BARRIER TERMINAL, TYPE 1  
 STA. 3005+08.90 TO STA. 3005+58.90  
 TRAFFIC BARRIER TERMINAL, TYPE 6  
 STA. 3003+63.15 TO STA. 3004+08.90  
 GUARDRAIL REMOVAL 120'

EXIST. CURVE CH10R2C2  
 PI STA. = 11+46.40  
 $\Delta$  = 44° 29' 59" (RT)  
 D = 8° 18' 13"  
 R = 690.00'  
 T = 282.29'  
 L = 535.90'  
 E = 55.51'  
 e = ----  
 T.R. = ----  
 S.E. RUN = ----  
 P.C. STA. = 8+64.11  
 P.T. STA. = 14+00.02

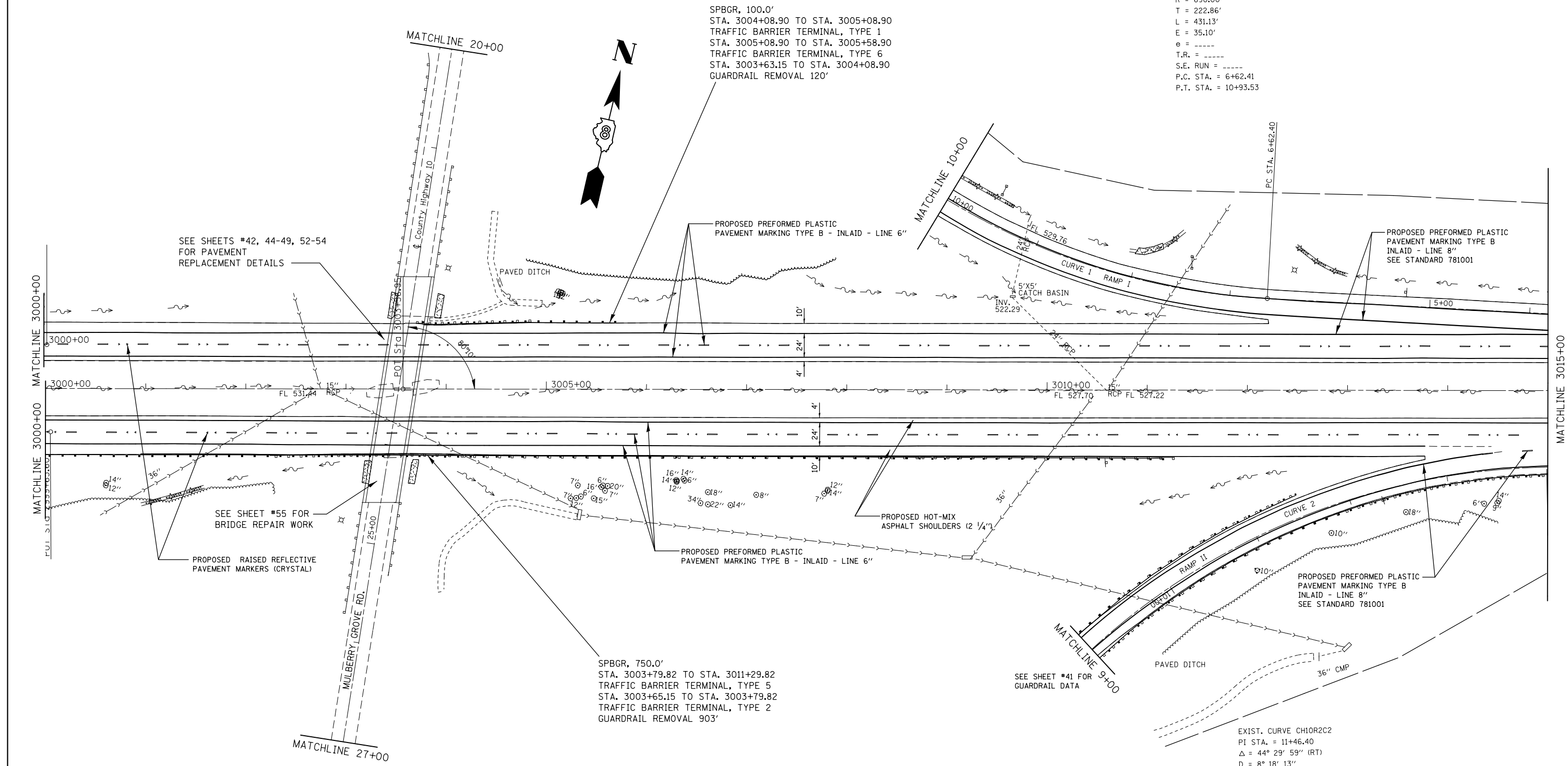

FILE NAME =	USER NAME = wedmore_jb	DESIGNED -	REVISED -
et:\pw\work\p\midot\wedmore_jb\d0149884\0876021-sh1-plan.dgn		DRAWN -	REVISED -
		CHECKED -	REVISED -
		DATE -	REVISED -

**STATE OF ILLINOIS  
 DEPARTMENT OF TRANSPORTATION**

<b>PLAN SHEETS</b>			
SCALE:	SHEET NO.	OF SHEETS	STA. TO STA.

F.A.I. RTE.	SECTION	COUNTY	TOTAL SHEETS	SHEET NO.
70	3-5RS-3	BOND	59	37
CONTRACT NO. 76D21				
FED. ROAD DIST. NO. ILLINOIS FED. AID PROJECT				