

EXIST. CURVE CH10R4C7  
 PI STA. = 2+79.43  
 $\Delta = 27^\circ 23' 16''$  (LT)  
 $D = 17^\circ 34' 31''$   
 $R = 326.00'$   
 $T = 79.43'$   
 $L = 155.83'$   
 $E = 9.54'$   
 $e = \text{-----}$   
 $T.R. = \text{-----}$   
 $S.E. \text{ RUN} = \text{-----}$   
 $P.C. \text{ STA.} = 2+00.00$   
 $P.T. \text{ STA.} = 3+55.83$

SPBGR, 325.0'  
 STA. 2+03.23 TO STA. 5+28.23  
 TRAFFIC BARRIER TERMINAL, TYPE 1  
 STA. 1+53.23 TO STA. 2+03.23  
 TRAFFIC BARRIER TERMINAL, TYPE 2  
 GUARDRAIL REMOVAL 275'

EXIST. CURVE CH10R1C1  
 PI STA. = 8+85.27  
 $\Delta = 35^\circ 47' 59''$  (RT)  
 $D = 8^\circ 18' 13''$   
 $R = 690.00'$   
 $T = 222.86'$   
 $L = 431.13'$   
 $E = 35.10'$   
 $e = \text{-----}$   
 $T.R. = \text{-----}$   
 $S.E. \text{ RUN} = \text{-----}$   
 $P.C. \text{ STA.} = 6+62.41$   
 $P.T. \text{ STA.} = 10+93.53$

EXIST. CURVE CH10R4C6  
 PI STA. = 7+66.48  
 $\Delta = 46^\circ 55' 42''$  (RT)  
 $D = 13^\circ 19' 29''$   
 $R = 430.00'$   
 $T = 186.65'$   
 $L = 352.19'$   
 $E = 38.76'$   
 $e = \text{-----}$   
 $T.R. = \text{-----}$   
 $S.E. \text{ RUN} = \text{-----}$   
 $P.C. \text{ STA.} = 5+79.83$   
 $P.T. \text{ STA.} = 9+32.02$

SPBGR, 237.5'  
 STA. 2+55.48 TO STA. 4+92.98  
 TRAFFIC BARRIER TERMINAL, TYPE 1  
 STA. 2+05.48 TO STA. 2+55.48  
 TRAFFIC BARRIER TERMINAL, TYPE 2  
 GUARDRAIL REMOVAL 288'

PROPOSED PREFORMED PLASTIC  
 PAVEMENT MARKING TYPE B - INLAID - LINE 6"

PROPOSED PREFORMED PLASTIC  
 PAVEMENT MARKING TYPE B - INLAID - LINE 6"

PROPOSED HOT-MIX  
 ASPHALT SHOULDERS (2")

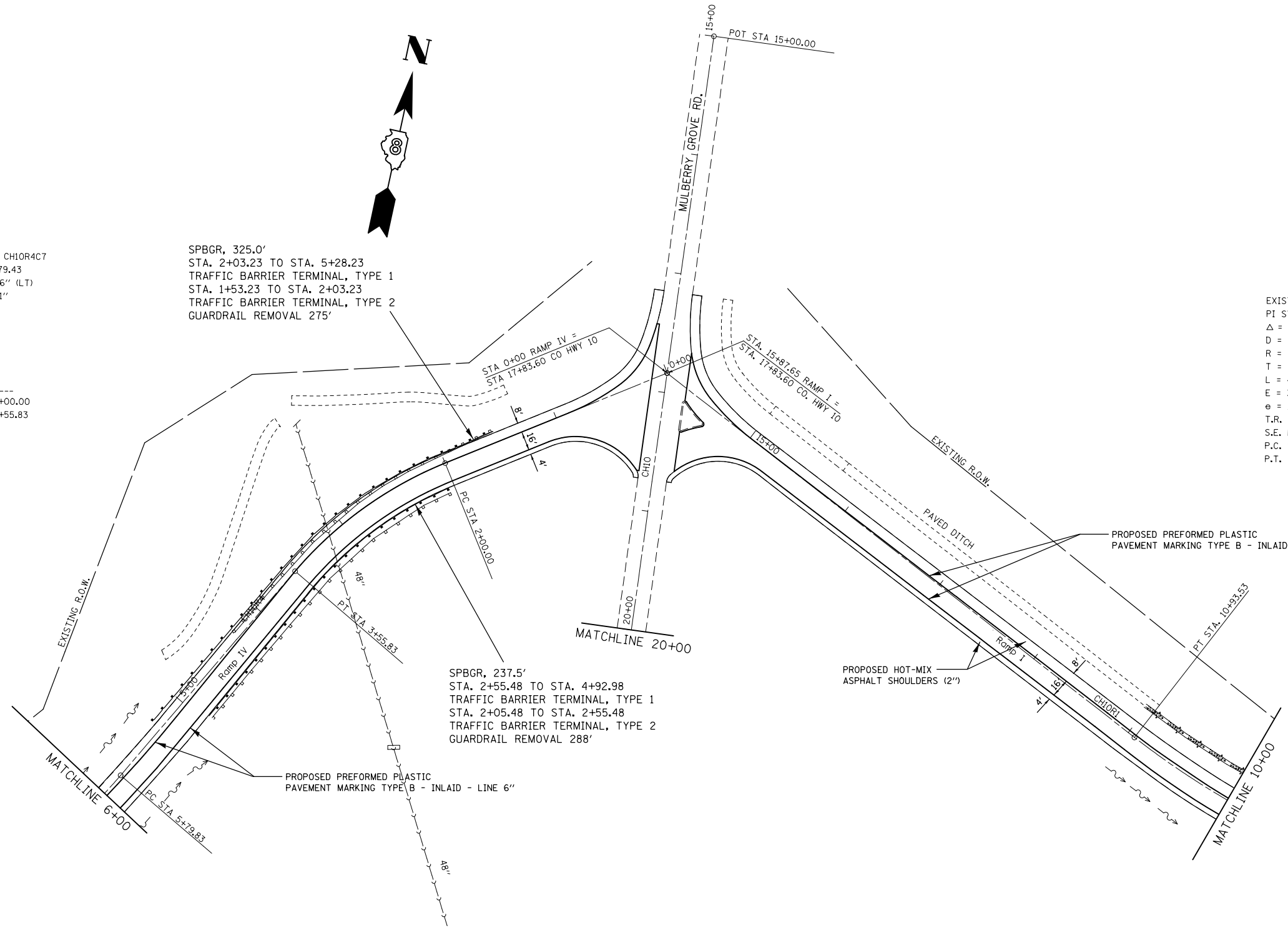

FILE NAME =	USER NAME = wedmore JB	DESIGNED -	REVISED -
et:\pw\work\p\dot\wedmore JB\d0149884\0876021-sh-t-plan.dgn		DRAWN -	REVISED -
	PLOT SCALE = 100.0000' / 1" =	CHECKED -	REVISED -
	PLOT DATE = 3/10/2014	DATE -	REVISED -

**STATE OF ILLINOIS  
 DEPARTMENT OF TRANSPORTATION**

<b>PLAN SHEETS</b>			
SCALE:	SHEET NO.	OF SHEETS	STA. TO STA.

F.A.I. RTE.	SECTION	COUNTY	TOTAL SHEETS	SHEET NO.
70	3-5RS-3	BOND	59	40
CONTRACT NO. 76D21				
FED. ROAD DIST. NO. ILLINOIS FED. AID PROJECT				