

**LONGITUDINAL SECTION**  
(Dim. at Rt. L's to C.Rdwy.)

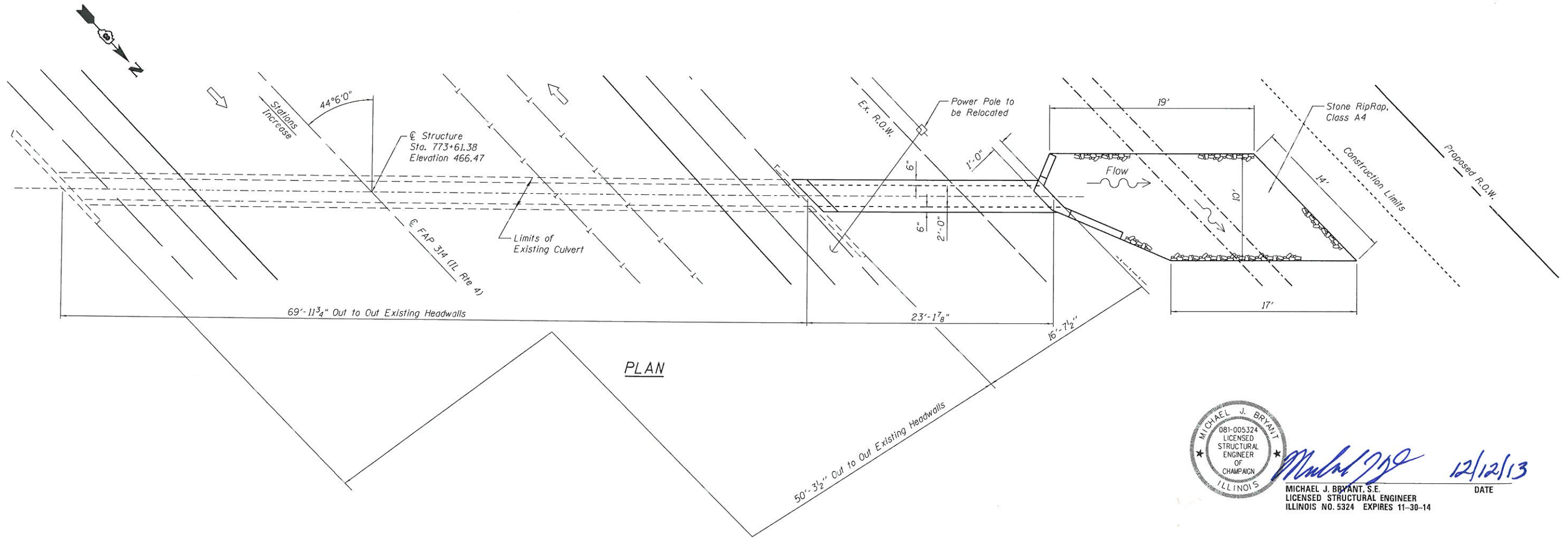

**PLAN**

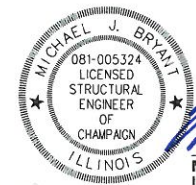

*Michael J. Bryant*  
 MICHAEL J. BRYANT, S.E.  
 LICENSED STRUCTURAL ENGINEER  
 ILLINOIS NO. 5324 EXPIRES 11-30-14  
 DATE 12/12/13

X:\CA\12011\111884-1\A\CAD\Plans\AS SUBMITTED TO DB\General\Plan.dgn



USER NAME =	DESIGNED -	REVISD -
PLOT SCALE =	CHECKED -	REVISD -
PLOT DATE =	DRAWN -	REVISD -
	CHECKED -	REVISD -

STATE OF ILLINOIS  
DEPARTMENT OF TRANSPORTATION

GENERAL PLAN  
STA. 773 + 61.38 CULVERT EXTENSION

SHEET NO. OF SHEETS

F.A.P. RTE.	SECTION	COUNTY	TOTAL SHEETS	SHEET NO.
314	(110,111)-1	MADISON	34	25
				CONTRACT NO. 76F76
ILLINOIS FED. AID PROJECT				