

STATE OF ILLINOIS
DEPARTMENT OF TRANSPORTATION
DIVISION OF HIGHWAYS

F.A.S. RTE.	SECTION	COUNTY	TOTAL SHEETS	SHEET NO.
747	59RS-3	JERSEY	19	1
ILLINOIS			CONTRACT NO. 76G59	

INDEX OF SHEETS

1	COVER SHEET
2	GENERAL NOTES, HIGHWAY STANDARDS, COMMITMENTS, ADT
3	SUMMARY OF QUANTITIES
4 - 11	TYPICAL SECTIONS
12	SCHEDULES OF QUANTITIES
13	LINE DIAGRAM
14 - 15	CONCRETE GUTTER DETAILS
16 - 17	EROSION CONTROL PLAN
18	PLAN DETAILS
19	ENTRANCE DETAILS

**PROPOSED
HIGHWAY PLANS**

FAS ROUTE 747 (IL 3)
SECTION 59RS-3
PROJECT ACRS-0747 (104)
FROM IL 109 TO MADISON COUNTY LINE
RESURFACING - 3P
JERSEY COUNTY

C-98-059-13



END PROJECT MM 3.59
LAT. 38°59'58.34"N
LONG. -90°10'50.29"W

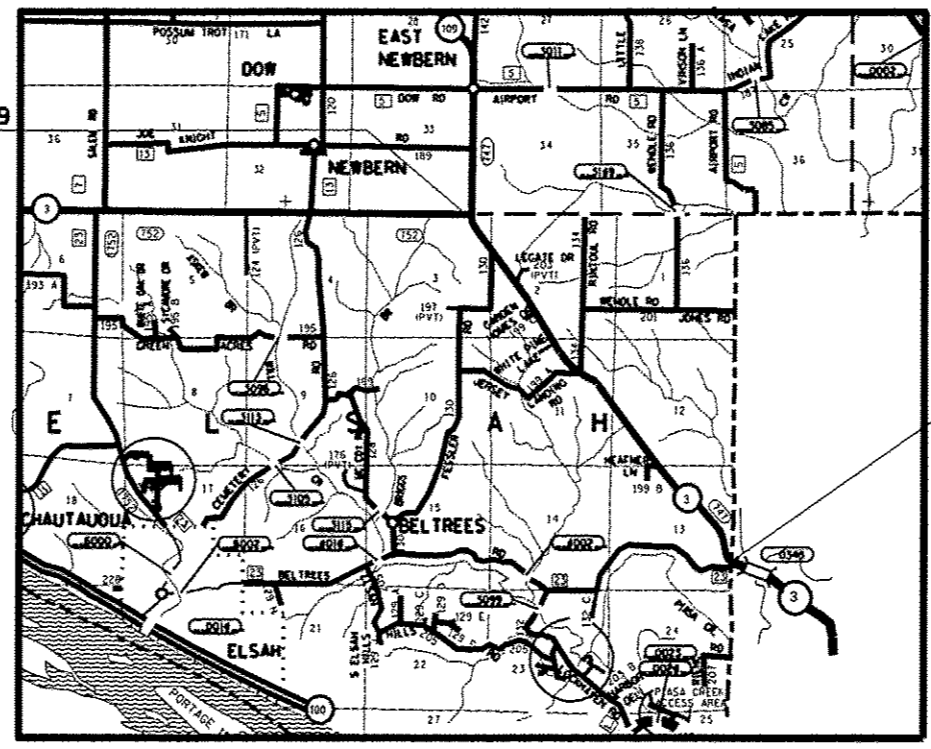

BEGIN PROJECT MM 0.00
LAT. 38°57'33.37"N
LONG. -90°16'30.76"W

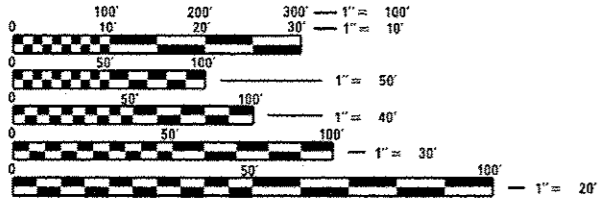

FULL SIZE PLANS HAVE BEEN PREPARED USING STANDARD ENGINEERING SCALES. REDUCED SIZED PLANS WILL NOT CONFORM TO STANDARD SCALES. IN MAKING MEASUREMENTS ON REDUCED PLANS, THE ABOVE SCALES MAY BE USED.

J.U.L.I.E.
JOINT UTILITY LOCATION INFORMATION FOR EXCAVATION
1-800-892-0123
OR 811

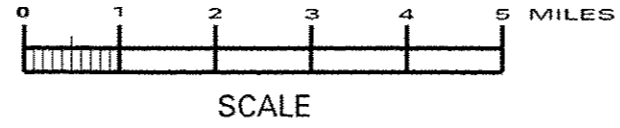

GROSS LENGTH = 18955.2 FT. = 3.59 MILE
NET LENGTH = 18955.2 FT. = 3.59 MILE

PROJECT ENGINEER: TIM PADGETT (618) 346-3325
PROJECT MANAGER: PHIL COPPERNOLL (618) 346-3480

CONTRACT NO. 76G59

STATE OF ILLINOIS
DEPARTMENT OF TRANSPORTATION
DIVISION OF HIGHWAYS

SUBMITTED January 28 20 14

John D. Baranzelli, P.E.
DEPUTY DIRECTOR OF HIGHWAYS, REGION 5 ENGINEER

March 21 20 14

John D. Baranzelli, P.E.
actg ENGINEER OF DESIGN AND ENVIRONMENT

March 21 20 14

Omer Osman, P.E.
DIRECTOR OF HIGHWAYS, CHIEF ENGINEER

PRINTED BY THE AUTHORITY
OF THE STATE OF ILLINOIS

GENERAL NOTES

- ILLINOIS STATE LAW REQUIRES A 48-HOUR NOTICE BE GIVEN TO ALL UTILITIES BEFORE DIGGING. FIELD MARKING OF FACILITIES MAY BE OBTAINED BY CONTACTING J.U.L.I.E. OR FOR NON-MEMBERS, THE UTILITY COMPANY DIRECTLY. AGENCIES KNOWN TO HAVE FACILITIES WITHIN THE PROJECT AREA ARE AS FOLLOWS:
 - AMEREN ILLINOIS - GAS & ELECTRIC
 - AT&T ILLINOIS - COMMUNICATIONS
 - JERSEY COUNTY RURAL WATER COMPANY - WATER
 - M.J.M. ELECTRIC COOPERATIVE, INC. - ELECTRIC
 - NUSTAR PIPELINE OPERATING PARTNERSHIP L.P. - PIPELINE

MEMBERS OF J.U.L.I.E. ((800) 892-0123 OR 811) ARE INDICATED BY *. NON-J.U.L.I.E. MEMBERS MUST BE NOTIFIED INDIVIDUALLY.
- THE CONTRACTOR SHALL VERIFY ALL DIMENSIONS AND CONDITIONS IN THE FIELD PRIOR TO CONSTRUCTION AND ORDERING OF MATERIALS.
- THE CONTRACTOR AND ENGINEER SHALL BE AWARE THAT NO SURVEY WAS PERFORMED FOR THIS PROJECT. THE STATIONING AND TOPO SHOWN IN THE PLANS WAS CREATED USING MICROFILM AND FIELD MEASUREMENTS MADE BY DESIGN PERSONNEL. BOTH SHALL BE ASSUMED TO BE APPROXIMATE.
- NO OVERNIGHT LANE CLOSURES WILL BE ALLOWED.
- "ROAD CONSTRUCTION AHEAD" SIGNS SHALL BE PLACED AT EACH END OF THE PROJECT PLUS THE INTERSECTING SIDE ROADS, AND WILL BE INCLUDED IN THE TRAFFIC CONTROL PAY ITEMS. ALL CONSTRUCTION SIGNS SHALL BE FLUORESCENT ORANGE, 48" X 48".
- PROPOSED PAVEMENT MARKING SHALL BE PLACED IN THE SAME LOCATIONS AS EXISTING AS DIRECTED BY THE RESIDENT ENGINEER.
- SHORT-TERM PAVEMENT MARKING SHALL BE APPLIED TO THE MILLED, PRIMED, AND FINAL BITUMINOUS SURFACE. ONLY THE REMOVAL OF THE FINAL SURFACE APPLICATION SHALL BE PAID FOR AS WORK ZONE PAVEMENT MARKING REMOVAL - SQ. FT.
- THE CONTRACTOR SHALL POST AND MAINTAIN THE ROADWAY WITH "NO PASSING ZONES NOT STRIPED NEXT ___ MILES" SIGNS UNTIL MARKINGS HAVE BEEN RESTORED IN ACCORDANCE WITH ARTICLE 701.17(C). COST INCLUDED IN THE TRAFFIC CONTROL PAY ITEMS.
- FLAGGERS SHALL BE REQUIRED AT ALL TIMES DURING PATCHING OPERATIONS.
- ACCESS SHALL BE MAINTAINED TO ALL PROPERTIES UNLESS OTHERWISE NOTED IN THE PLANS.
- THE THICKNESS OF THE HMA MIXTURE SHOWN ON THE PLANS IS THE NOMINAL THICKNESS. DEVIATIONS FROM THE NOMINAL THICKNESS WILL BE PERMITTED WHEN SUCH DEVIATIONS OCCUR DUE TO IRREGULARITIES IN THE EXISTING SURFACE OR BASE ON WHICH THE HMA MIXTURE IS PLACED.
- ALL TURF AREAS DISTURBED FOR ANY REASON OUTSIDE THE AREAS OF CONSTRUCTION SHALL BE PERMANENTLY SEEDED AS DIRECTED BY THE ENGINEER AT THE CONTRACTOR'S EXPENSE.
- THE FOLLOWING MIXTURE REQUIREMENTS ARE APPLICABLE FOR THIS PROJECT:

MIXTURE USE	SURFACE	F.D. PATCHING	SHOULDERS
AC/PG	PG 64-22	PG 64-22	PG 64-22
DESIGN AIR VOIDS	4.0% @ Ndes=70	4.0% @ Ndes=70	**2.0% @ Ndes=30
MIX COMPOSITION (GRADATION MIXTURE)	IL 9.5	IL 19.0 F.G.	NMAS 3/4"
ERUCTION AGG.	MIXTURE "D"	MIXTURE "B"	

**Top Lift Shoulders - Design this mix at 2.0% voids and add asphalt to reduce voids to 1.5%.

Plan quantities for HMA Surface Course items are calculated using a unit weight of 112 lb/sq yd/in (59.8 kg/sq m/25 mm thickness).

- ANY EMBANKMENT REQUIRED ON THE FORESLOPES FOR THE CONSTRUCTION OF THE PROPOSED GUTTER SHALL BE CONSTRUCTED ACCORDING TO SECTION 205 OF THE STANDARD SPECIFICATIONS. COST TO BE INCLUDED IN THE PAY ITEM FOR CONCRETE GUTTER OF THE TYPE SPECIFIED.
- ALL EXCAVATION REQUIRED TO CONSTRUCT THE NEW GUTTER AND APPURTANANCES SHALL BE INCLUDED IN THE PAY ITEM CONCRETE GUTTER OF THE TYPE SPECIFIED.
- ALL MILLED AREAS SHALL BE RESURFACED WITH THE APPROPRIATE SURFACE COURSE PRIOR TO OPENING THE LANE TO TRAFFIC.

HIGHWAY STANDARDS

000001-06	701011-04
001006	701201-04
280001-07	701301-04
285001-02	701306-03
442201-03	701311-03
606101-04	701901-03
606201-02	780001-04
701006-05	781001-03

COMMITMENTS

NONE

ADT

(2013) ACTUAL = 5950
 (2014) ESTIMATED = 6000
 (2024) ESTIMATED = 6400
 SU = 3.8%
 MU = 1.5%

MISSISSIPPI

CODE NO.	ITEM	UNIT	TOTAL QUANTITY	80% FED 20% STATE
				ROADWAY 0005
25000200	SEEDING, CLASS 2	ACRE	0.5	0.5
25000400	NITROGEN FERTILIZER NUTRIENT	POUND	29	29
25000500	PHOSPHORUS FERTILIZER NUTRIENT	POUND	29	29
25000600	POTASSIUM FERTILIZER NUTRIENT	POUND	29	29
25100115	MULCH, METHOD 2	ACRE	0.5	0.5
28000400	PERIMETER EROSION BARRIER	FOOT	2894	2894
28500100	FABRIC FORMED CONCRETE REVETMENT MAT	SQ YD	189	189
40200800	AGGREGATE SURFACE COURSE, TYPE B	TON	4	4
40600200	BITUMINOUS MATERIALS (PRIME COAT)	TON	16.5	16.5
40600300	AGGREGATE (PRIME COAT)	TON	80	80
40603340	HOT-MIX ASPHALT SURFACE COURSE, MIX "D", N70	TON	6642	6642
44000158	HOT-MIX ASPHALT SURFACE REMOVAL, 2 1/4"	SQ YD	52630	52630
44200201	PAVEMENT PATCHING, TYPE I, 17 INCH	SQ YD	4	4
44200202	PAVEMENT PATCHING, TYPE II, 17 INCH	SQ YD	31	31
44200204	PAVEMENT PATCHING, TYPE III, 17 INCH	SQ YD	23	23
44200206	PAVEMENT PATCHING, TYPE IV, 17 INCH	SQ YD	25	25

CODE NO.	ITEM	UNIT	TOTAL QUANTITY	80% FED 20% STATE
				ROADWAY 0005
48102100	AGGREGATE WEDGE SHOULDER, TYPE B	TON	515	515
48203100	HOT-MIX ASPHALT SHOULDERS	TON	8	8
60600095	CLASS SI CONCRETE (OUTLET)	CU YD	34.9	34.9
60602500	CONCRETE GUTTER, TYPE A	FOOT	1043	1043
60602800	CONCRETE GUTTER, TYPE B	FOOT	1214	1214
67000400	ENGINEER'S FIELD OFFICE, TYPE A	CAL MO	2	2
67100100	MOBILIZATION	L SUM	1	1
70100450	TRAFFIC CONTROL AND PROTECTION, STANDARD 701201	L SUM	1	1
70100460	TRAFFIC CONTROL AND PROTECTION, STANDARD 701306	L SUM	1	1
70300100	SHORT TERM PAVEMENT MARKING	FOOT	5172	5172
70300220	TEMPORARY PAVEMENT MARKING - LINE 4"	FOOT	65050	65050
70301000	WORK ZONE PAVEMENT MARKING REMOVAL	SQ FT	575	575
* 78000200	THERMOPLASTIC PAVEMENT MARKING - LINE 4"	FOOT	65050	65050
* 78100100	RAISED REFLECTIVE PAVEMENT MARKER	EACH	239	239
78300200	RAISED REFLECTIVE PAVEMENT MARKER REMOVAL	EACH	239	239
Ø 20076600	TRAINEES	HOURLY	1000	1000
X4402720	GUTTER REMOVAL (SPECIAL)	FOOT	1451	1451
Ø 20076604	TRAINEES TRAINING PROGRAM GRADUATE	HOURLY	1000	1000

* SPECIALTY ITEM
Ø 0042

FILE NAME :	USER NAME :	DESIGNED :	REVISED :
c:\pwwork\prado\conoverp\ad8351353\d016g59-shi-plen.dgn	conoverp	-	-
PLOT SCALE :	CHECKED :	REVISED :	REVISED :
1/28/2014	-	-	-

STATE OF ILLINOIS
DEPARTMENT OF TRANSPORTATION

SUMMARY OF QUANTITIES

SCALE:	SHEET NO. 1 OF 1 SHEETS	STA.	TO STA.	F.A.S. RTE.	SECTION	COUNTY	TOTAL SHEETS	SHEET NO.
				747	SR95-3	JERSEY	19	3
				FED. ROAD DIST. NO.		ILLINOIS FED. AID PROJECT		

CONTRACT NO. 76659

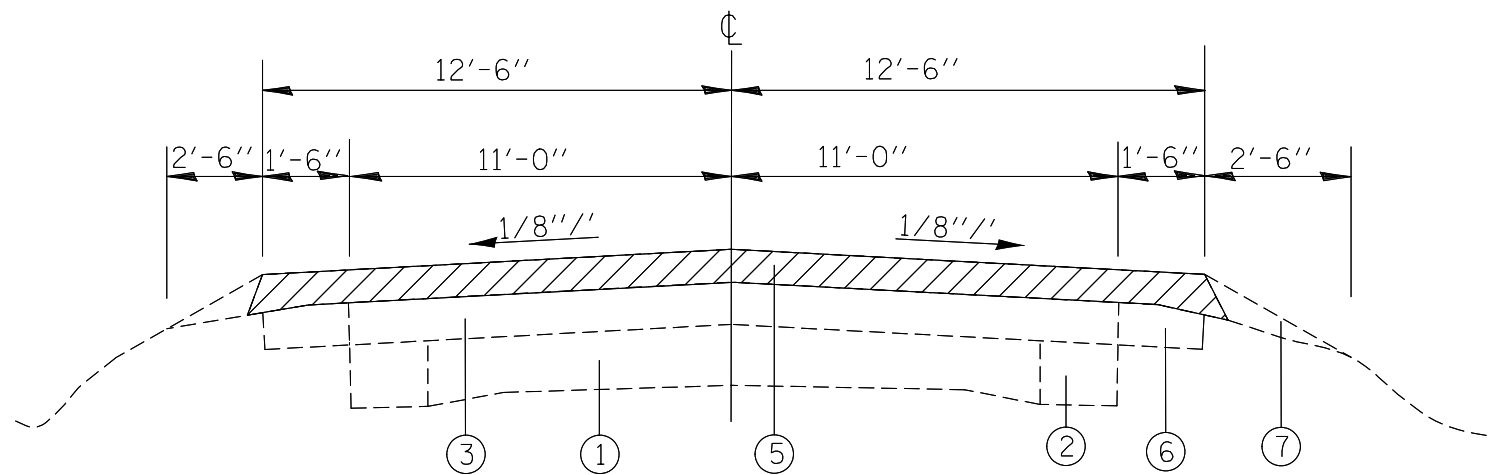

MILE 0.000 TO MILE 0.012
 MILE 0.492 TO MILE 0.630
 MILE 0.730 TO MILE 0.797

- ① EXIST. PCC PAVEMENT 9-6-9
- ② EXIST. PCC WIDENING, 9"
- ③ EXIST. HMA OVERLAY, VAR. 4 1/4" TO 5 3/4"
- ④ EXIST. LEVELING BINDER, VAR. 0" TO 3 1/4"
- ⑤ EXIST. HMA RESURFACING, 2 1/4"
- ⑥ EXIST. HMA SHOULDERS, 6"
- ⑦ EXIST. AGG. SHOULDERS, TYPE B, VAR. 2 1/4" TO 0"
- ⑧ EXIST. CONCRETE GUTTER
- ⑨ EXIST. CONCRETE GUTTER, TYPE A
- ⑩ PROP. HMA SURFACE COURSE, MIX D, N70, 2 1/4"
- ⑪ PROP. AGG. WEDGE SHOULDER, TYPE B, 3/4"
- ⑫ PROP. CONCRETE GUTTER, TYPE A
- ⑬ PROP. CONCRETE GUTTER, TYPE B

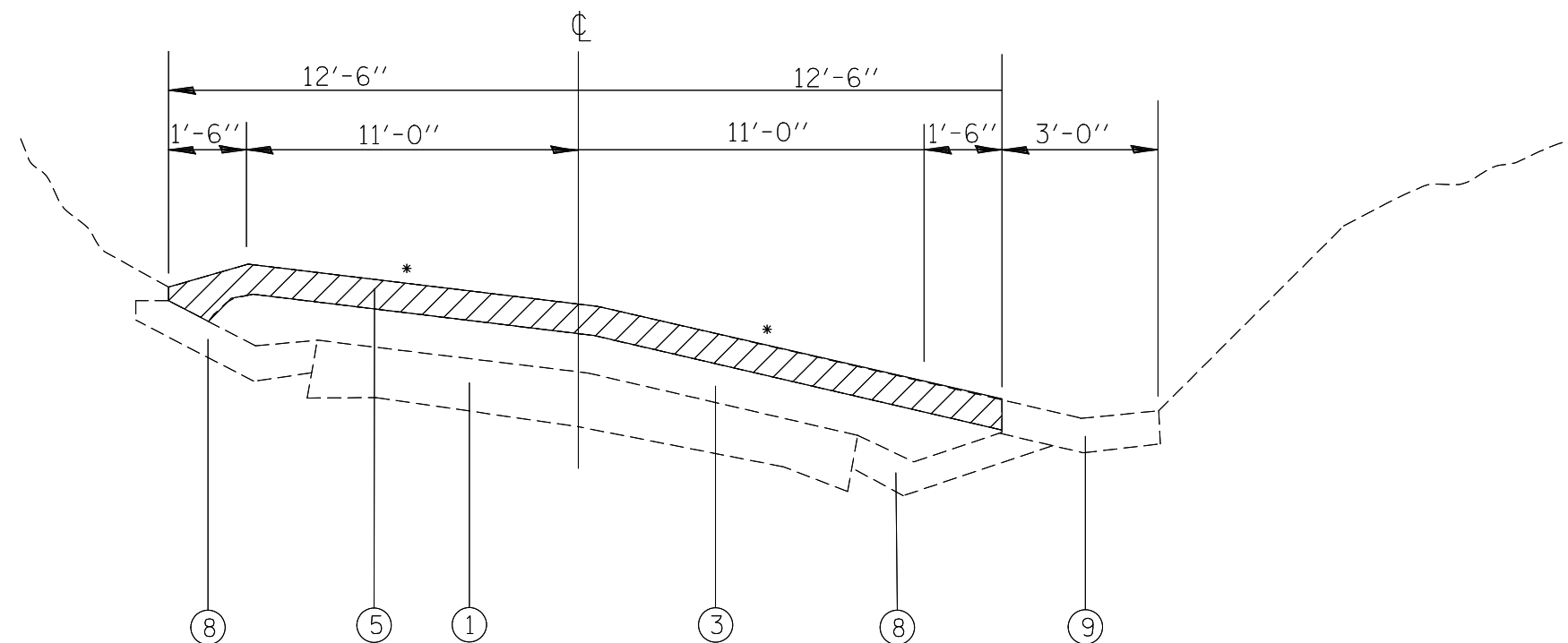

HMA SURFACE REMOVAL, 2 1/4"

MILE 0.012 TO MILE 0.176

*SLOPE VARIES

FILE NAME =	USER NAME = conoverpj	DESIGNED -	REVISED -	STATE OF ILLINOIS DEPARTMENT OF TRANSPORTATION	EXISTING TYPICAL SECTIONS			F.A.S. RTE.	SECTION	COUNTY	TOTAL SHEETS	SHEET NO.
et:\pwork\pwork\conoverpj\d0351353\d876g59-sh-t-plan.dgn		DRAWN -	REVISED -		747	59RS-3	JERSEY	19	4			
	PLOT SCALE = 100.0000' / 1in.	CHECKED -	REVISED -		CONTRACT NO. 76G59							
	PLOT DATE = 1/28/2014	DATE -	REVISED -		SCALE:	SHEET NO. 1 OF 4 SHEETS	STA.	TO STA.	FED. ROAD DIST. NO.	ILLINOIS FED. AID PROJECT		

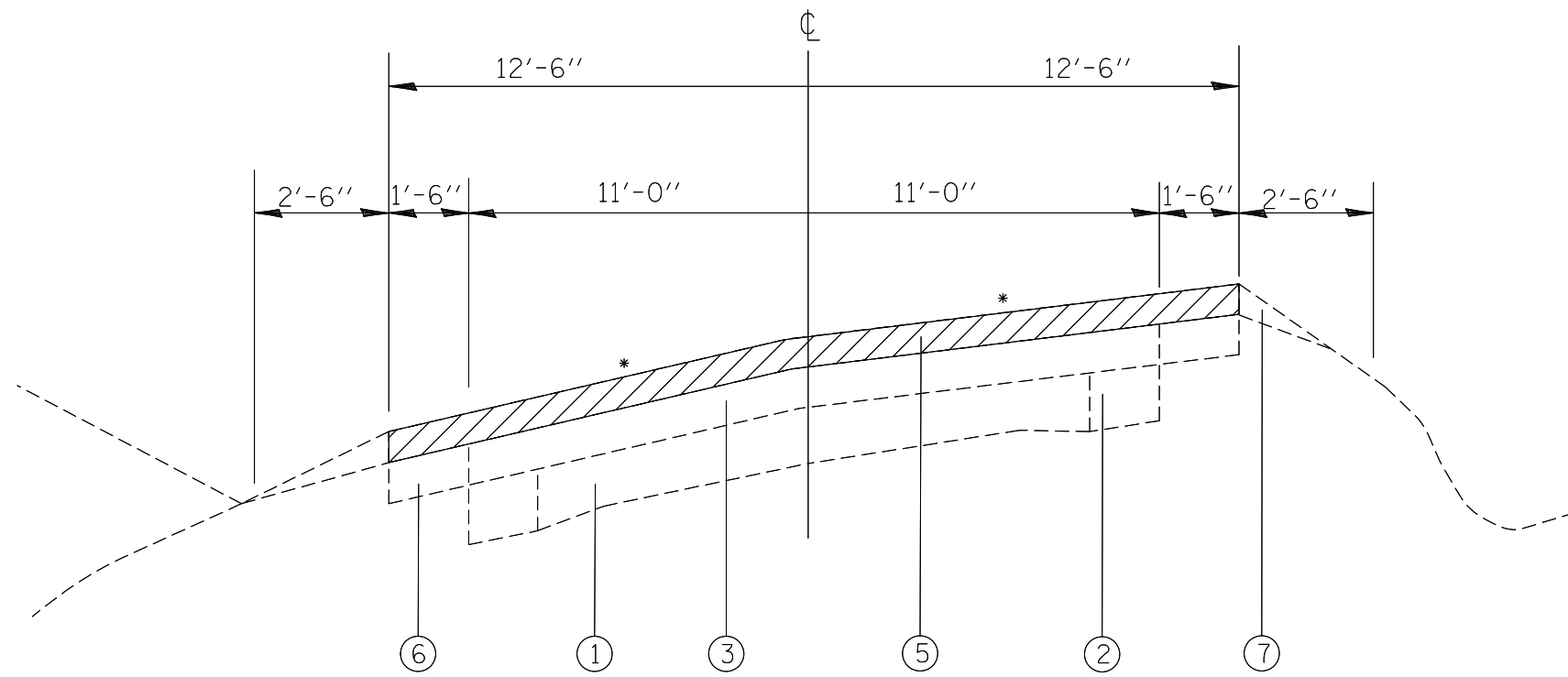

*SLOPE VARIES

MILE 0.176 TO MILE 0.492

- ① EXIST. PCC PAVEMENT 9-6-9
- ② EXIST. PCC WIDENING, 9"
- ③ EXIST. HMA OVERLAY, VAR. 4 1/4" TO 5 3/4"
- ④ EXIST. LEVELING BINDER, VAR. 0" TO 3 1/4"
- ⑤ EXIST. HMA RESURFACING, 2 1/4"
- ⑥ EXIST. HMA SHOULDERS, 6"
- ⑦ EXIST. AGG. SHOULDERS, TYPE B, VAR. 2 1/4" TO 0"
- ⑧ EXIST. CONCRETE GUTTER
- ⑨ EXIST. CONCRETE GUTTER, TYPE A
- ⑩ PROP. HMA SURFACE COURSE, MIX D, N70, 2 1/4"
- ⑪ PROP. AGG. WEDGE SHOULDER, TYPE B, 3/4"
- ⑫ PROP. CONCRETE GUTTER, TYPE A
- ⑬ PROP. CONCRETE GUTTER, TYPE B

HMA SURFACE REMOVAL, 2 1/4"

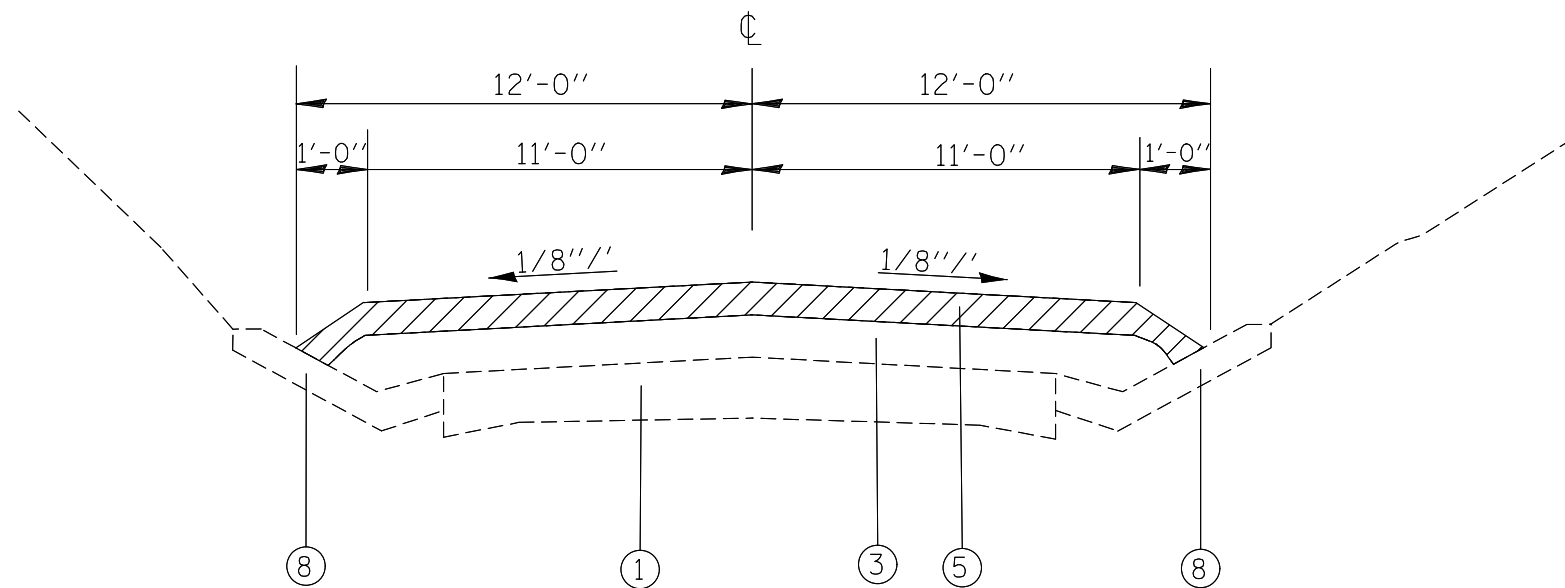

MILE 0.630 TO MILE 0.730

FILE NAME =	USER NAME = conoverpj	DESIGNED -	REVISED -
et:\pw\work\p\dot\conoverpj\d0351353\d876g59-shr-plan.dgn		DRAWN -	REVISED -
PLOT SCALE = 100.0000' / in.		CHECKED -	REVISED -
PLOT DATE = 1/28/2014		DATE -	REVISED -

**STATE OF ILLINOIS
DEPARTMENT OF TRANSPORTATION**

EXISTING TYPICAL SECTIONS

SCALE: SHEET NO. 2 OF 4 SHEETS STA. TO STA.

F.A.S. RTE.	SECTION	COUNTY	TOTAL SHEETS	SHEET NO.
747	59RS-3	JERSEY	19	5
FED. ROAD DIST. NO. ILLINOIS FED. AID PROJECT			CONTRACT NO. 76G59	

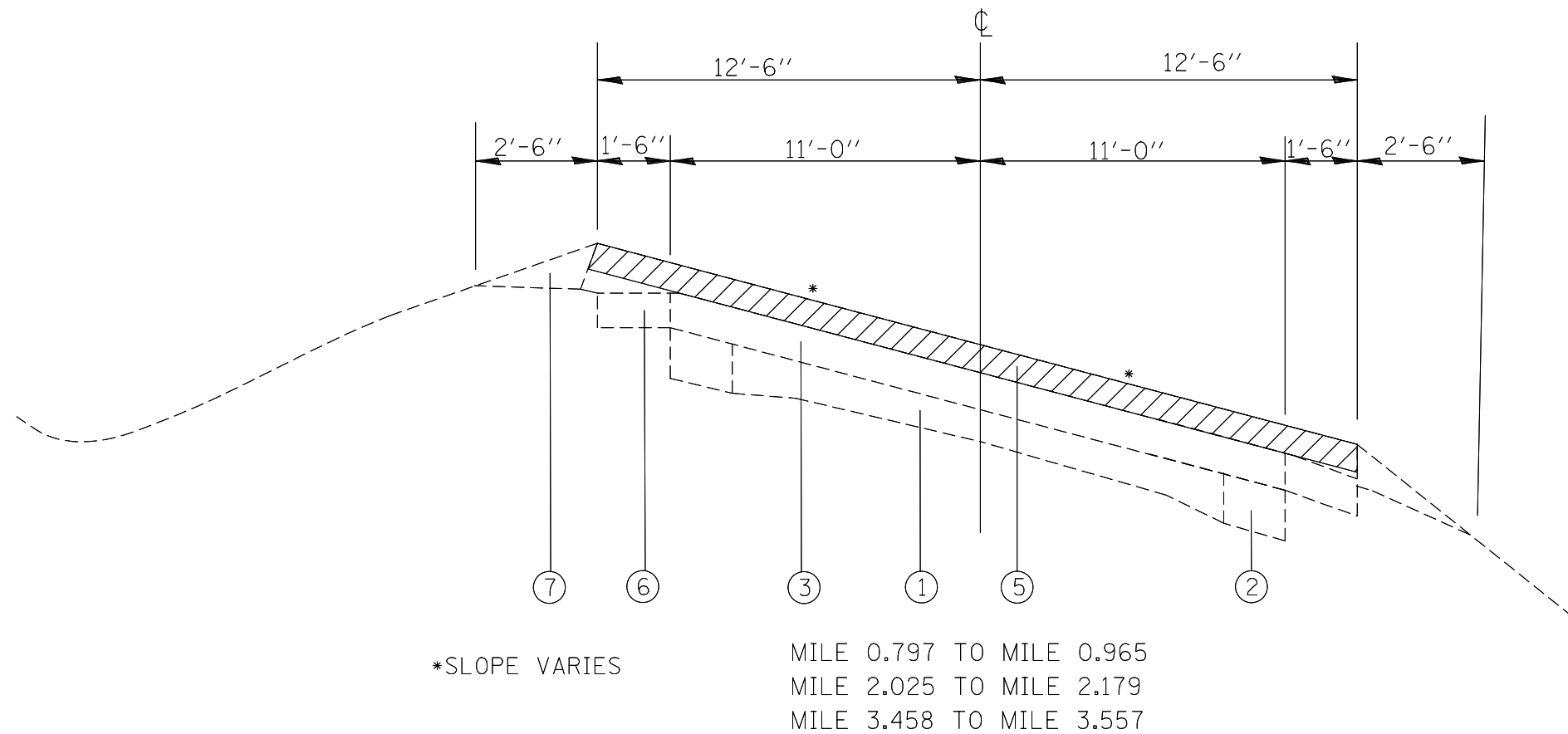

- ① EXIST. PCC PAVEMENT 9-6-9
- ② EXIST. PCC WIDENING, 9"
- ③ EXIST. HMA OVERLAY, VAR. 4 1/4" TO 5 3/4"
- ④ EXIST. LEVELING BINDER, VAR. 0" TO 3 1/4"
- ⑤ EXIST. HMA RESURFACING, 2 1/4"
- ⑥ EXIST. HMA SHOULDERS, 6"
- ⑦ EXIST. AGG. SHOULDERS, TYPE B, VAR. 2 1/4" TO 0"
- ⑧ EXIST. CONCRETE GUTTER
- ⑨ EXIST. CONCRETE GUTTER, TYPE A
- ⑩ PROP. HMA SURFACE COURSE, MIX D, N70, 2 1/4"
- ⑪ PROP. AGG. WEDGE SHOULDER, TYPE B, 3/4"
- ⑫ PROP. CONCRETE GUTTER, TYPE A
- ⑬ PROP. CONCRETE GUTTER, TYPE B

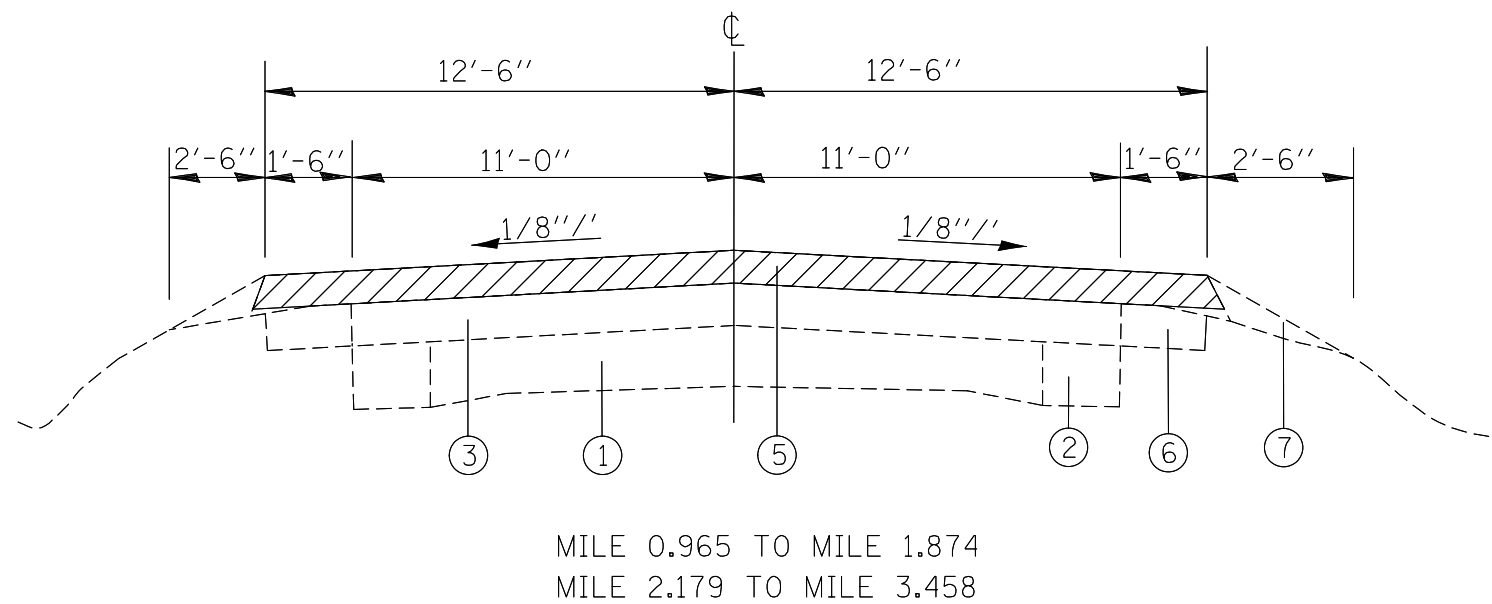

HMA SURFACE REMOVAL, 2 1/4"

FILE NAME =	USER NAME = conoverpj	DESIGNED -	REVISED -	STATE OF ILLINOIS DEPARTMENT OF TRANSPORTATION	EXISTING TYPICAL SECTIONS			F.A.S. RTE.	SECTION	COUNTY	TOTAL SHEETS	SHEET NO.
et:\pwork\pwork\conoverpj\d0351353\d876g59-shr-plan.dgn		DRAWN -	REVISED -		747	59RS-3	JERSEY	19	6			
PLOT SCALE = 100.0000' / 1in.		CHECKED -	REVISED -		SCALE: SHEET NO. 3 OF 4 SHEETS STA. TO STA.			CONTRACT NO. 76G59				
PLOT DATE = 1/28/2014		DATE -	REVISED -		FED. ROAD DIST. NO.		ILLINOIS FED. AID PROJECT					

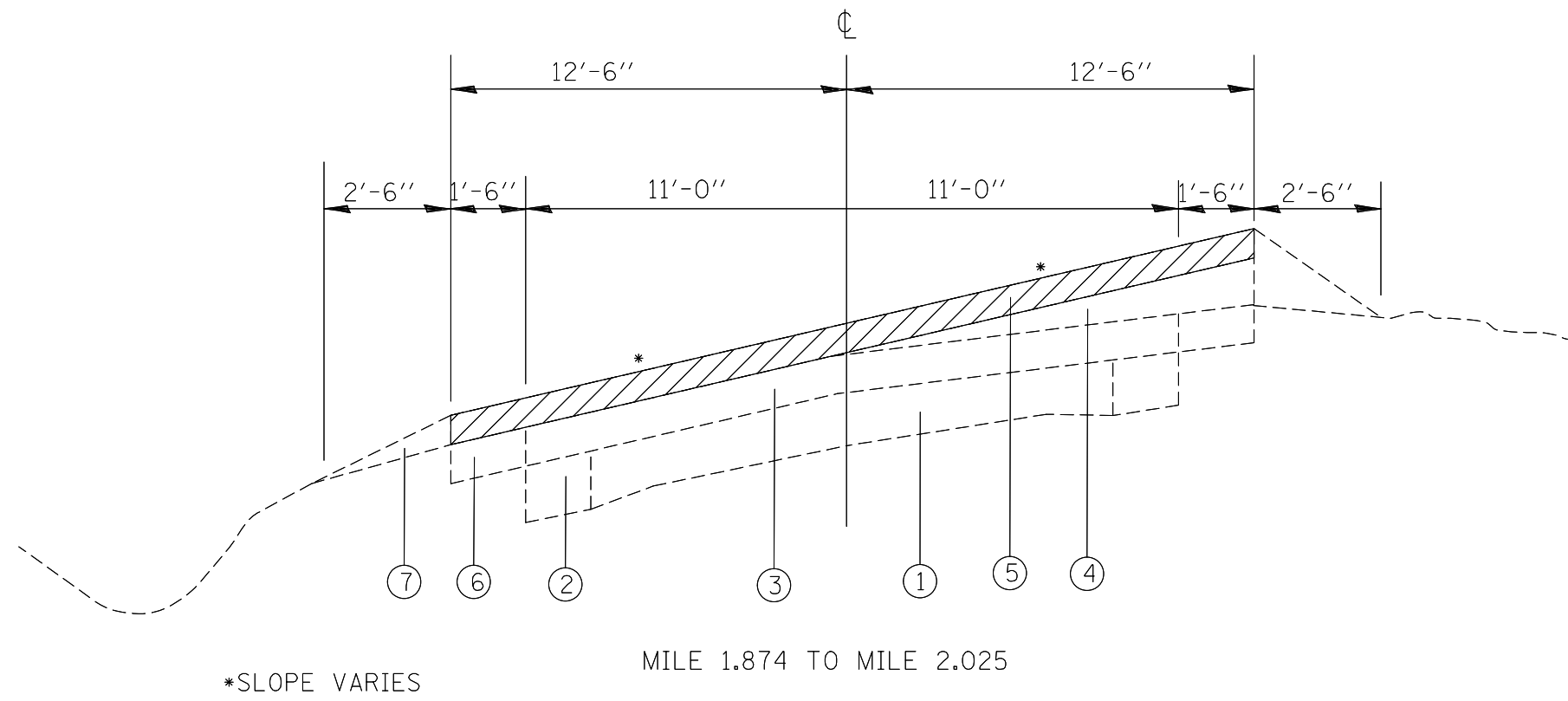

- ① EXIST. PCC PAVEMENT 9-6-9
- ② EXIST. PCC WIDENING, 9"
- ③ EXIST. HMA OVERLAY, VAR. 4 1/4" TO 5 3/4"
- ④ EXIST. LEVELING BINDER, VAR. 0" TO 3 1/4"
- ⑤ EXIST. HMA RESURFACING, 2 1/4"
- ⑥ EXIST. HMA SHOULDERS, 6"
- ⑦ EXIST. AGG. SHOULDERS, TYPE B, VAR. 2 1/4" TO 0"
- ⑧ EXIST. CONCRETE GUTTER
- ⑨ EXIST. CONCRETE GUTTER, TYPE A
- ⑩ PROP. HMA SURFACE COURSE, MIX D, N70, 2 1/4"
- ⑪ PROP. AGG. WEDGE SHOULDER, TYPE B, 3/4"
- ⑫ PROP. CONCRETE GUTTER, TYPE A
- ⑬ PROP. CONCRETE GUTTER, TYPE B

*SLOPE VARIES

MILE 1.874 TO MILE 2.025

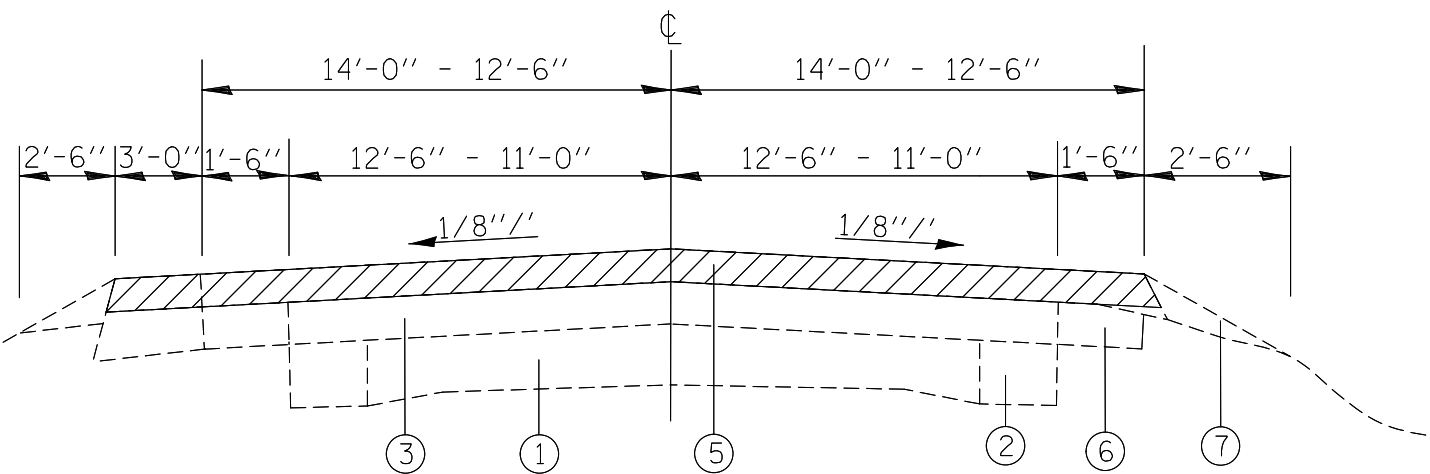

HMA SURFACE REMOVAL, 2 1/4"

MILE 3.557 TO MILE 3.590

FILE NAME =	USER NAME = conoverpj	DESIGNED -	REVISED -	STATE OF ILLINOIS DEPARTMENT OF TRANSPORTATION	EXISTING TYPICAL SECTIONS			F.A.S. RTE.	SECTION	COUNTY	TOTAL SHEETS	SHEET NO.
e:\pwork\pwork\conoverpj\d0351353\d876g59-shr-plan.dgn		DRAWN -	REVISED -		747	59RS-3	JERSEY	19	7			
PLOT SCALE = 100.0000' / 1in.		CHECKED -	REVISED -		SCALE: SHEET NO. 4 OF 4 SHEETS STA. TO STA.			CONTRACT NO. 76G59				
PLOT DATE = 1/28/2014		DATE -	REVISED -		FED. ROAD DIST. NO. ILLINOIS FED. AID PROJECT							

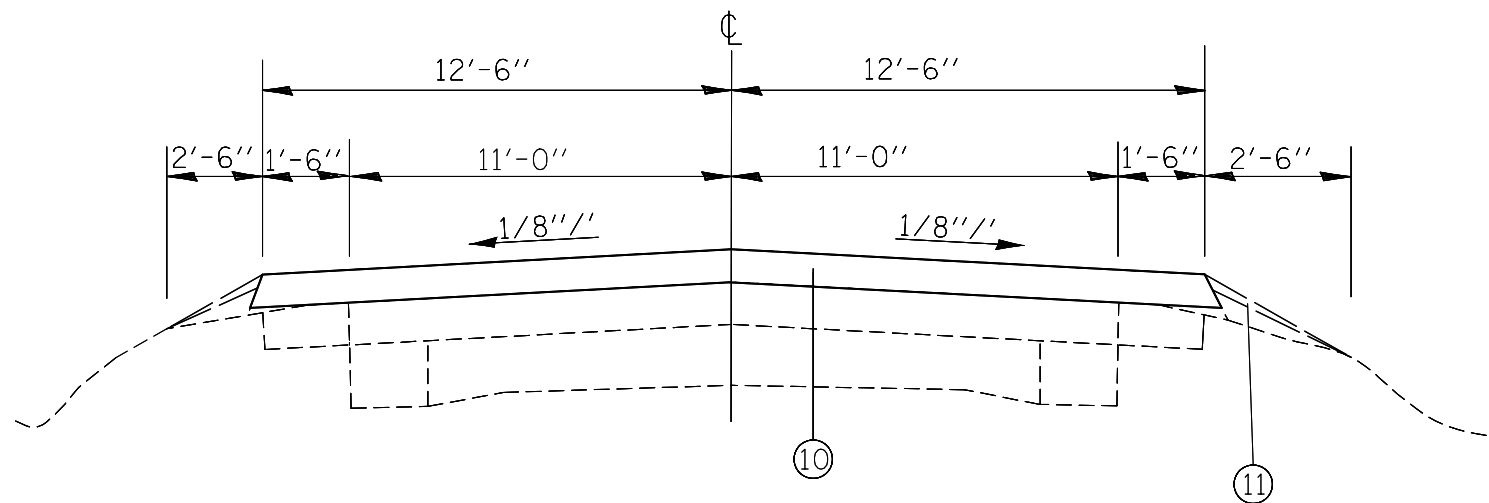

MILE 0.000 TO MILE 0.012
 MILE 0.492 TO MILE 0.630
 MILE 0.730 TO MILE 0.797

- ① EXIST. PCC PAVEMENT 9-6-9
- ② EXIST. PCC WIDENING, 9"
- ③ EXIST. HMA OVERLAY, VAR. 4 1/4" TO 5 3/4"
- ④ EXIST. LEVELING BINDER, VAR. 0" TO 3 1/4"
- ⑤ EXIST. HMA RESURFACING, 2 1/4"
- ⑥ EXIST. HMA SHOULDERS, 6"
- ⑦ EXIST. AGG. SHOULDERS, TYPE B, VAR. 2 1/4" TO 0"
- ⑧ EXIST. CONCRETE GUTTER
- ⑨ EXIST. CONCRETE GUTTER, TYPE A
- ⑩ PROP. HMA SURFACE COURSE, MIX D, N70, 2 1/4"
- ⑪ PROP. AGG. WEDGE SHOULDER, TYPE B, 3/4"
- ⑫ PROP. CONCRETE GUTTER, TYPE A
- ⑬ PROP. CONCRETE GUTTER, TYPE B

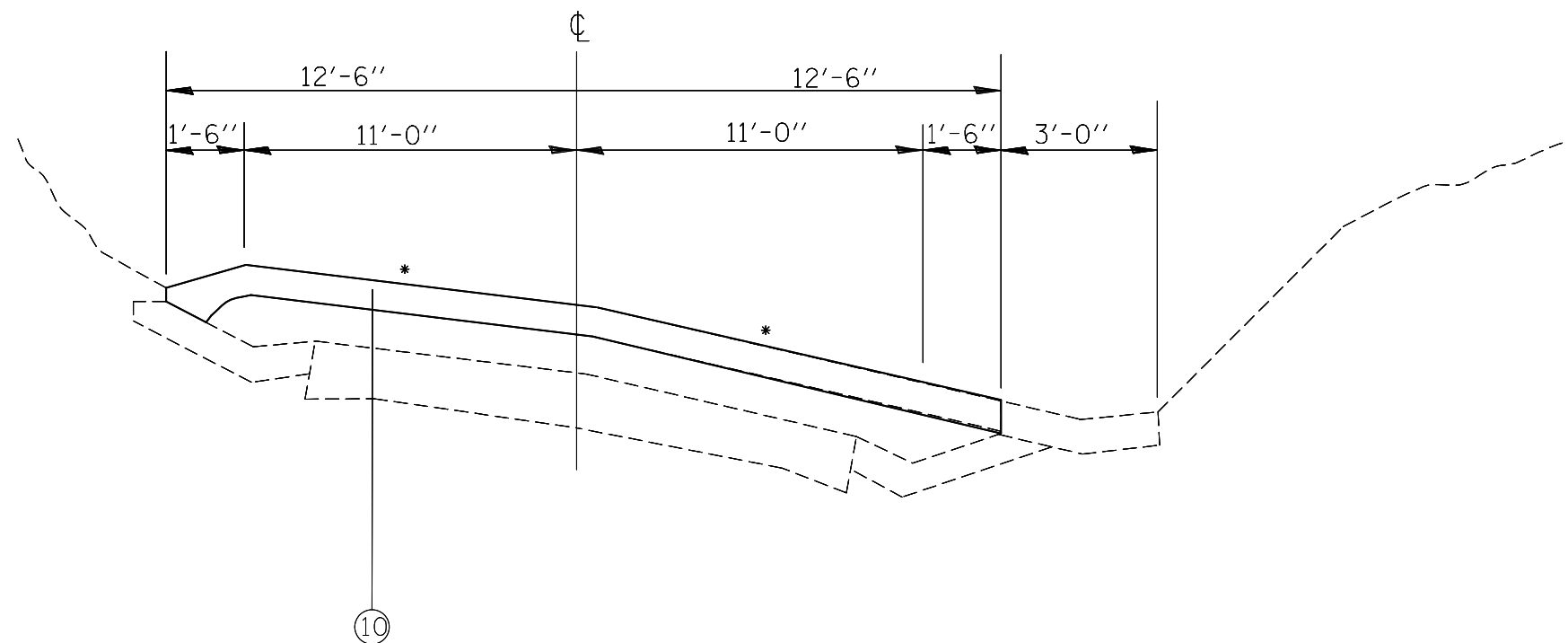

MILE 0.012 TO MILE 0.176

*SLOPE VARIES

FILE NAME =	USER NAME = conoverpj	DESIGNED -	REVISED -	STATE OF ILLINOIS DEPARTMENT OF TRANSPORTATION	PROPOSED TYPICAL SECTIONS			F.A.S. RTE.	SECTION	COUNTY	TOTAL SHEETS	SHEET NO.
et:\pwork\pwork\conoverpj\d0351353\d876g59-shr-plan.dgn		DRAWN -	REVISED -		747	59RS-3	JERSEY	19	8			
PLOT SCALE = 100.0000' / in.		CHECKED -	REVISED -		CONTRACT NO. 76059							
PLOT DATE = 1/28/2014		DATE -	REVISED -		SCALE:	SHEET NO. 1 OF 4 SHEETS	STA.	TO STA.	FED. ROAD DIST. NO.	ILLINOIS FED. AID PROJECT		

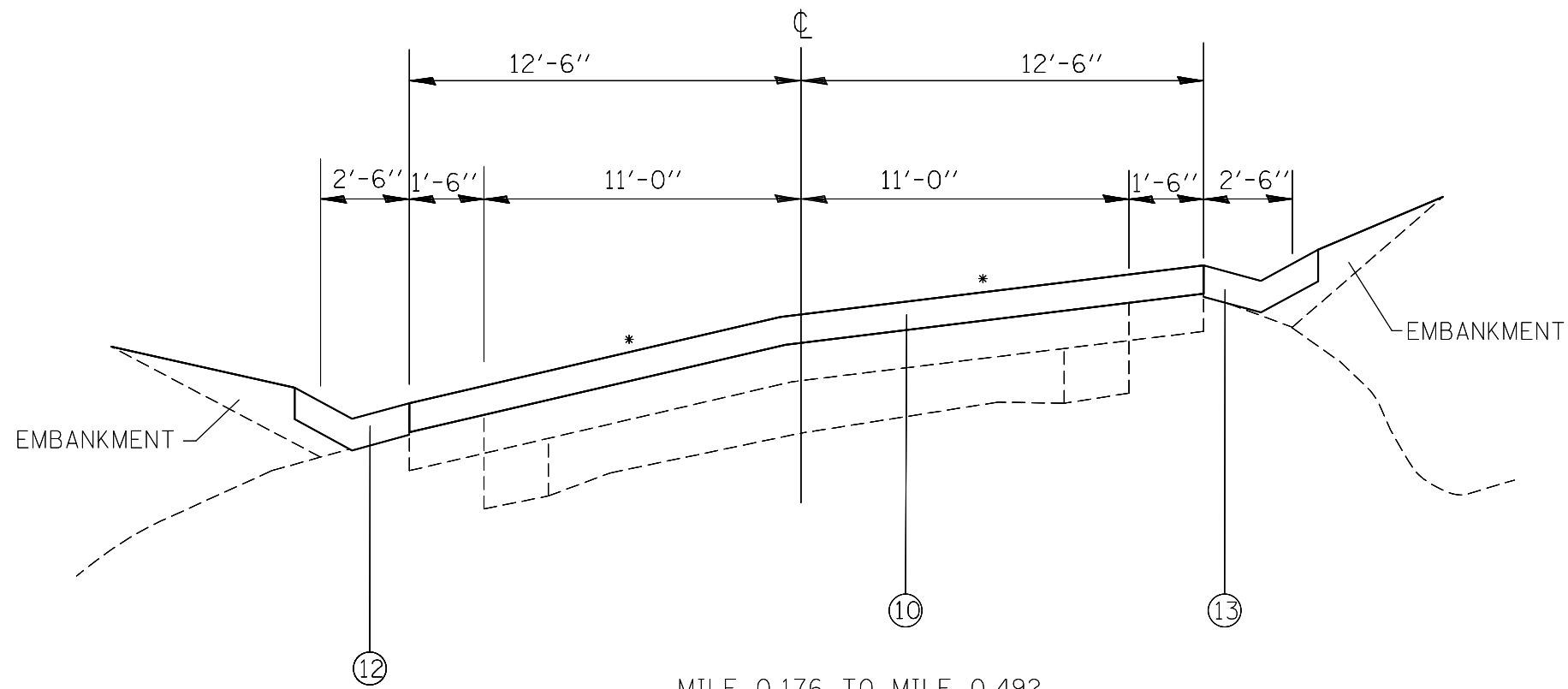

MILE 0.176 TO MILE 0.492

*SLOPE VARIES

SEE DETAIL ON SHEET 18 FOR NEW GUTTER.

- ① EXIST. PCC PAVEMENT 9-6-9
- ② EXIST. PCC WIDENING, 9"
- ③ EXIST. HMA OVERLAY, VAR. 4 1/4" TO 5 3/4"
- ④ EXIST. LEVELING BINDER, VAR. 0" TO 3 1/4"
- ⑤ EXIST. HMA RESURFACING, 2 1/4"
- ⑥ EXIST. HMA SHOULDERS, 6"
- ⑦ EXIST. AGG. SHOULDERS, TYPE B, VAR. 2 1/4" TO 0"
- ⑧ EXIST. CONCRETE GUTTER
- ⑨ EXIST. CONCRETE GUTTER, TYPE A
- ⑩ PROP. HMA SURFACE COURSE, MIX D, N70, 2 1/4"
- ⑪ PROP. AGG. WEDGE SHOULDER, TYPE B, 3/4"
- ⑫ PROP. CONCRETE GUTTER, TYPE A
- ⑬ PROP. CONCRETE GUTTER, TYPE B

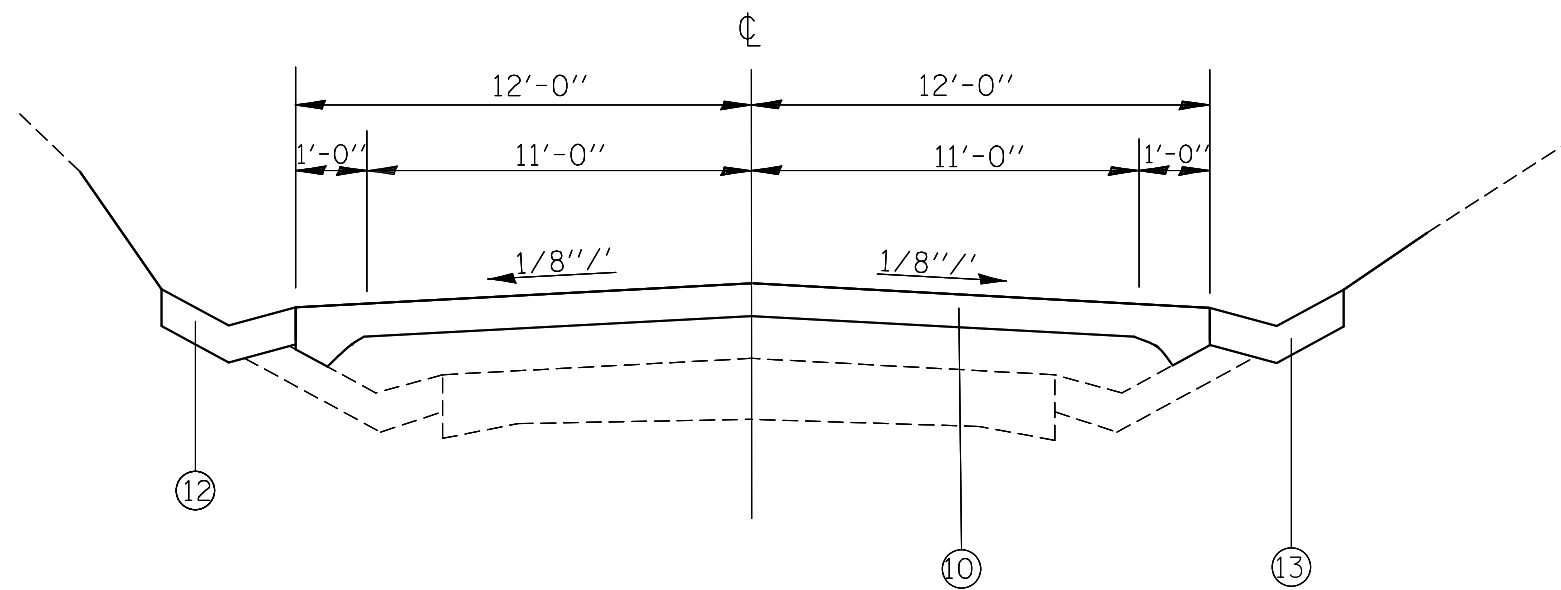

MILE 0.630 TO MILE 0.730

SEE DETAIL ON SHEET 18 FOR NEW GUTTER.

FILE NAME =	USER NAME = conoverpj	DESIGNED -	REVISED -	STATE OF ILLINOIS DEPARTMENT OF TRANSPORTATION	PROPOSED TYPICAL SECTIONS			F.A.S. RTE.	SECTION	COUNTY	TOTAL SHEETS	SHEET NO.
et:\pwork\pwork\conoverpj\d0351353\d876g59-shr-plan.dgn	PLOT SCALE = 100.0000' / 1in.	DRAWN -	REVISED -					747	59RS-3	JERSEY	19	9
PLOT DATE = 1/28/2014	DATE -	CHECKED -	REVISED -		SCALE: SHEET NO. 2 OF 4 SHEETS STA. TO STA.			CONTRACT NO. 76059				
		DATE -	REVISED -		FED. ROAD DIST. NO.		ILLINOIS FED. AID PROJECT					

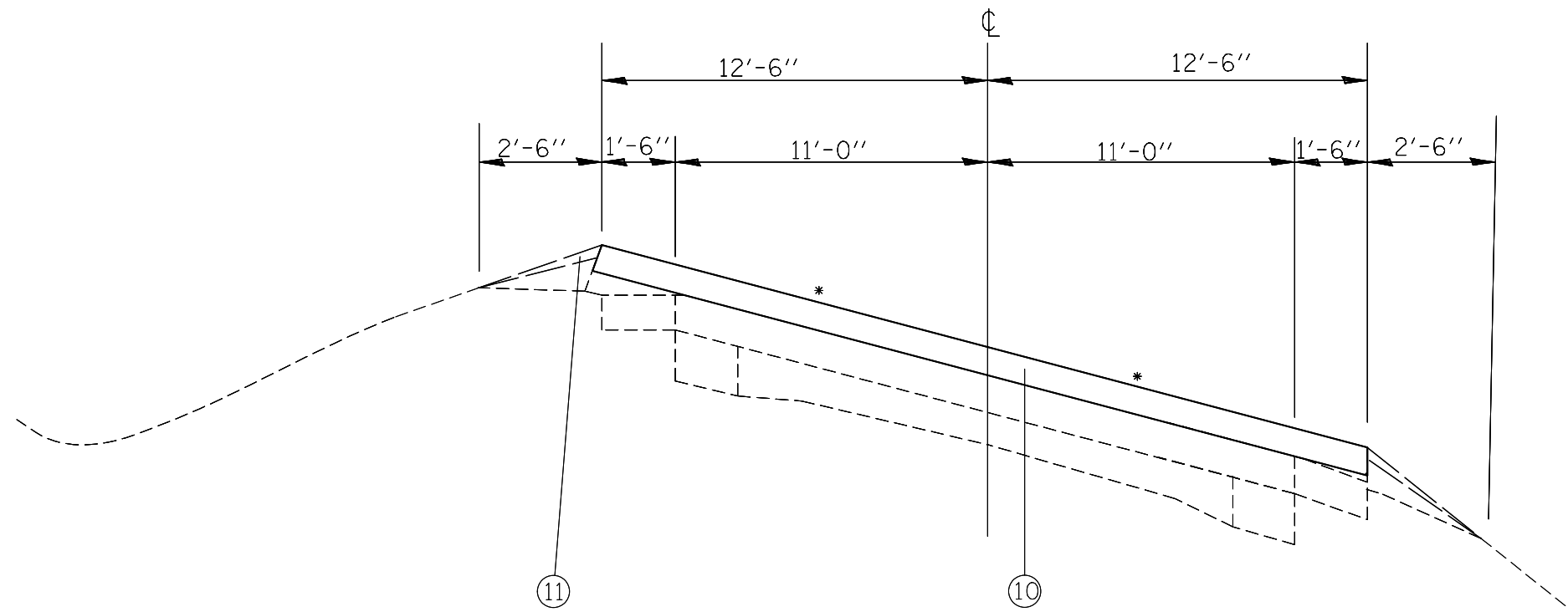

*SLOPE VARIES

MILE 0.797 TO MILE 0.965
 MILE 2.025 TO MILE 2.179
 MILE 3.458 TO MILE 3.557

- ① EXIST. PCC PAVEMENT 9-6-9
- ② EXIST. PCC WIDENING, 9"
- ③ EXIST. HMA OVERLAY, VAR. 4 1/4" TO 5 3/4"
- ④ EXIST. LEVELING BINDER, VAR. 0" TO 3 1/4"
- ⑤ EXIST. HMA RESURFACING, 2 1/4"
- ⑥ EXIST. HMA SHOULDERS, 6"
- ⑦ EXIST. AGG. SHOULDERS, TYPE B, VAR. 2 1/4" TO 0"
- ⑧ EXIST. CONCRETE GUTTER
- ⑨ EXIST. CONCRETE GUTTER, TYPE A
- ⑩ PROP. HMA SURFACE COURSE, MIX D, N70, 2 1/4"
- ⑪ PROP. AGG. WEDGE SHOULDER, TYPE B, 3/4"
- ⑫ PROP. CONCRETE GUTTER, TYPE A
- ⑬ PROP. CONCRETE GUTTER, TYPE B

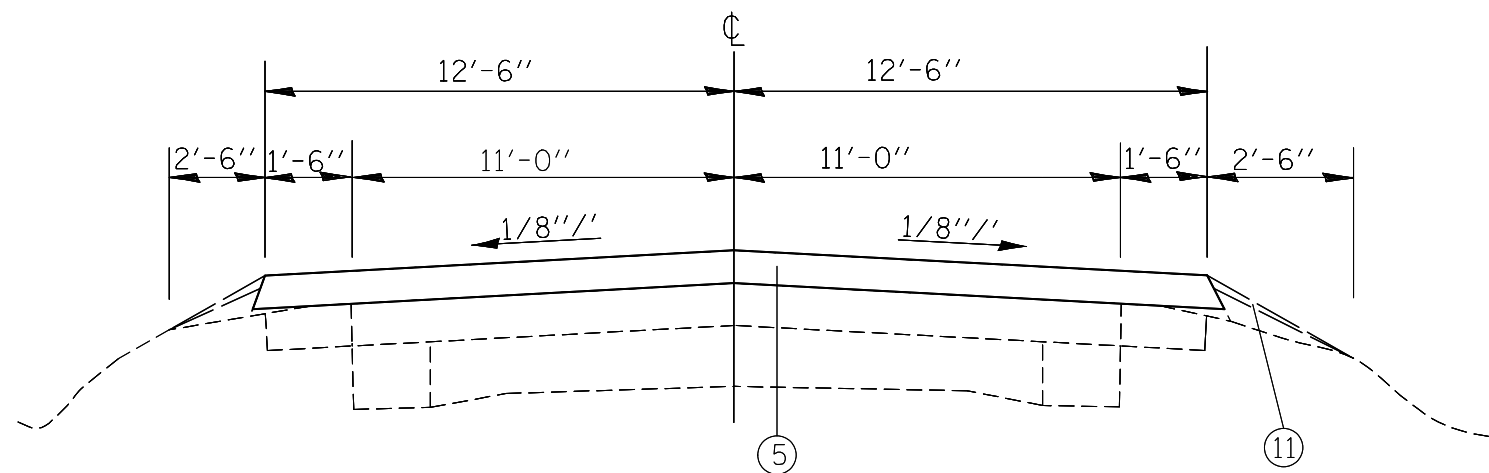

MILE 0.965 TO MILE 1.874
 MILE 2.179 TO MILE 3.458

FILE NAME =	USER NAME = conoverpj	DESIGNED -	REVISED -
et:\pwork\pwork\conoverpj\d0351353\d876g59-shr-plan.dgn		DRAWN -	REVISED -
	PLOT SCALE = 100.0000' / in.	CHECKED -	REVISED -
	PLOT DATE = 1/28/2014	DATE -	REVISED -

STATE OF ILLINOIS
 DEPARTMENT OF TRANSPORTATION

PROPOSED TYPICAL SECTIONS

SCALE: SHEET NO. 3 OF 4 SHEETS STA. TO STA.

F.A.S. RTE.	SECTION	COUNTY	TOTAL SHEETS	SHEET NO.
747	59RS-3	JERSEY	19	10
FED. ROAD DIST. NO. ILLINOIS FED. AID PROJECT			CONTRACT NO. 76G59	

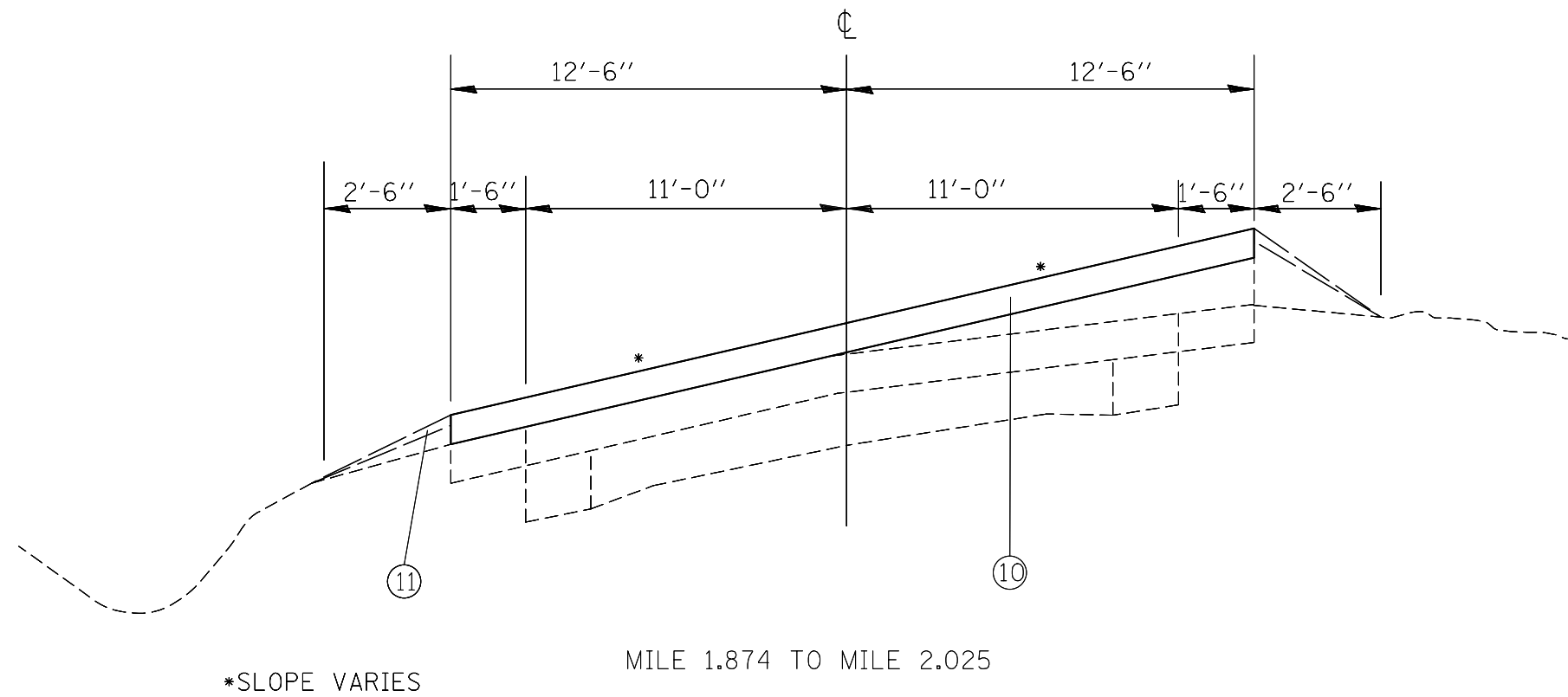

- ① EXIST. PCC PAVEMENT 9-6-9
- ② EXIST. PCC WIDENING, 9"
- ③ EXIST. HMA OVERLAY, VAR. 4 1/4" TO 5 3/4"
- ④ EXIST. LEVELING BINDER, VAR. 0" TO 3 1/4"
- ⑤ EXIST. HMA RESURFACING, 2 1/4"
- ⑥ EXIST. HMA SHOULDERS, 6"
- ⑦ EXIST. AGG. SHOULDERS, TYPE B, VAR. 2 1/4" TO 0"
- ⑧ EXIST. CONCRETE GUTTER
- ⑨ EXIST. CONCRETE GUTTER, TYPE A
- ⑩ PROP. HMA SURFACE COURSE, MIX D, N70, 2 1/4"
- ⑪ PROP. AGG. WEDGE SHOULDER, TYPE B, 3/4"
- ⑫ PROP. CONCRETE GUTTER, TYPE A
- ⑬ PROP. CONCRETE GUTTER, TYPE B

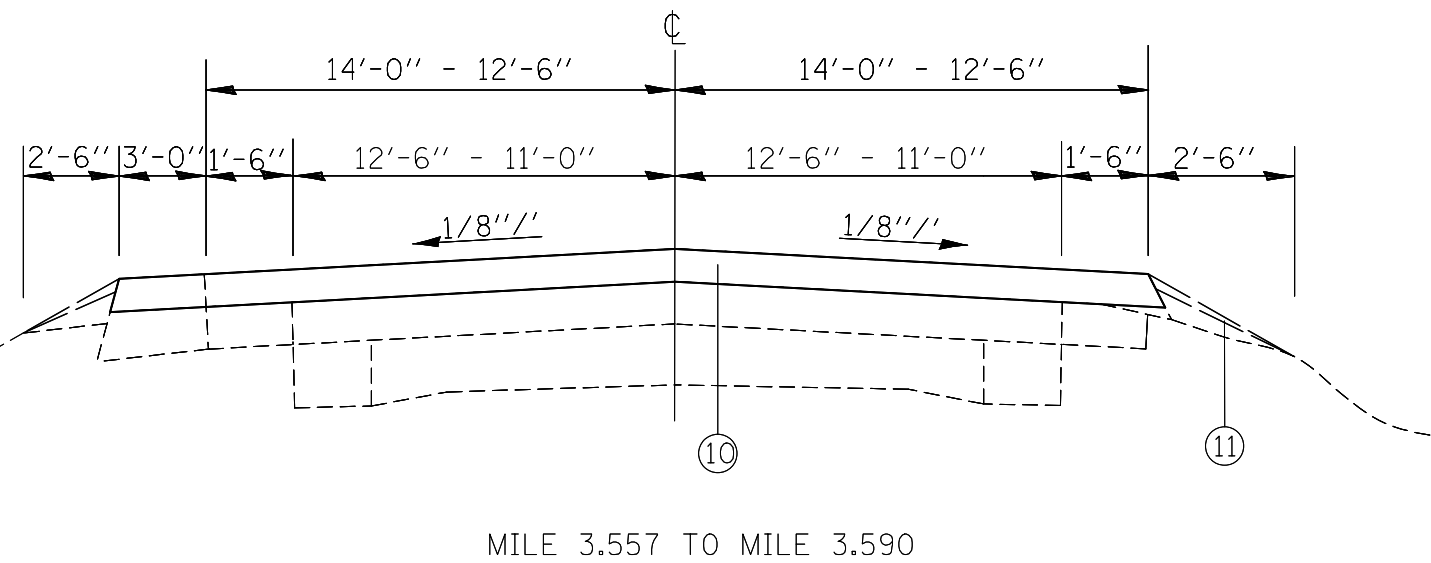

FILE NAME =	USER NAME = conoverpj	DESIGNED -	REVISED -
e:\pwork\pwork\conoverpj\d0351353\d876g59-shr-plan.dgn		DRAWN -	REVISED -
PLOT SCALE = 100.0000' / 1in.		CHECKED -	REVISED -
PLOT DATE = 1/28/2014		DATE -	REVISED -

STATE OF ILLINOIS
DEPARTMENT OF TRANSPORTATION

PROPOSED TYPICAL SECTIONS

SCALE: SHEET NO. 4 OF 4 SHEETS STA. TO STA.

F.A.S. RTE.	SECTION	COUNTY	TOTAL SHEETS	SHEET NO.
747	59RS-3	JERSEY	19	11
FED. ROAD DIST. NO. ILLINOIS FED. AID PROJECT			CONTRACT NO. 76G59	

MILLING & RESURFACING						
LOCATION	HMA SURF REMOVAL, 2 1/4"	BITUMINOUS MATERIALS (PC)	AGGREGATE (PC)	HMA SURFACE COURSE, MIX D, N70	HMA SHOULDERS	AGG WEDGE SHOULDER, TYPE B
	SQ YD	TON	TON	TON	TON	TON
MM 0.000 - 0.012	176.0	0.06	0.3	22.2		2.0
MM 0.012 - 0.176	2405.3	0.75	3.6	303.1		
MM 0.176 - 0.492	4634.7	1.45	7.0	584.0		
MM 0.492 - 0.541	718.7	0.22	1.1	90.6		23.6
MM 0.541 - 0.730	2661.1	0.83	4.0	335.3		
MM 0.730 - 0.797	982.7	0.31	1.5	123.8		11.4
MM 0.797 - 0.965	2464.0	0.77	3.7	310.5		28.8
MM 0.965 - 1.874	13332.0	4.17	20.0	1679.8		155.6
MM 1.874 - 2.025	2214.7	0.69	3.3	279.1		25.8
MM 2.025 - 2.179	2258.7	0.71	3.4	284.6		26.4
MM 2.179 - 3.458	18758.7	5.87	28.1	2363.6		218.8
MM 3.458 - 3.557	1452.0	0.45	2.2	183.0		17.0
MM 3.557 - 3.590	571.1	0.18	0.9	72.0	7.3	5.6
ENTRANCE				10.1		
TOTALS	52629.7	16.46	79.1	6641.7	7.3	515.0

CONCRETE GUTTER											
LOCATION		GUTTER REMOVAL (SPECIAL)	CONCRETE GUTTER, TYPE A	CONCRETE GUTTER, TYPE B	CLASS SI CONCRETE	PERIMETER EROSION BARRIER	SEEDING, CLASS 2	NITROGEN FERTILIZER NUTRIENT	PHOSPHORUS FERTILIZER NUTRIENT	POTASSIUM FERTILIZER NUTRIENT	MULCH, METHOD 2
		FOOT	FOOT	FOOT	CU YD	FOOT	ACRE	POUND	POUND	POUND	ACRE
LOCATION #1	RT	12		687	4.18	757	0.07	6.3	6.3	6.3	0.07
LOCATION #1	LT		391		6.04	336	0.10	9.0	9.0	9.0	0.10
LOCATION #2	RT	289		212	5.94	444	0.07	6.3	6.3	6.3	0.07
LOCATION #2	LT	335	287		6.04	485	0.03	2.7	2.7	2.7	0.03
LOCATION #3	RT	402		315	6.62	397	0.02	1.8	1.8	1.8	0.02
LOCATION #3	LT	413	365		6.04	475	0.03	2.7	2.7	2.7	0.03
TOTALS		1451	1043	1214	34.86	2894	0.32	28.8	28.8	28.8	0.32

THERMOPLASTIC PAVEMENT MARKING - LINE 4"			
LOCATION	CENTERLINE		EDGE LINE
	SOLID YELLOW FOOT	DASHED YELLOW FOOT	SOLID WHITE FOOT
MM 0.000 - 0.39	4171		4171
MM 0.395 - 0.56	887	220	1774
MM 0.563 - 0.680		160	1236
MM 0.680 - 0.90	1183	300	2365
MM 0.904 - 1.07	1795		1795
MM 1.074 - 1.179	554	140	1109
MM 1.179 - 1.277	1035		1035
MM 1.277 - 1.341	338	90	676
MM 1.341 - 1.377		50	380
MM 1.377 - 1.556	945	240	1890
MM 1.556 - 1.752		260	2070
MM 1.752 - 1.972	1162	290	2323
MM 1.972 - 2.471	5269		5269
MM 2.471 - 2.69	1188	300	2376
MM 2.696 - 2.796		130	1056
MM 2.796 - 3.00	1093	270	2186
MM 3.003 - 3.16	1700		1700
MM 3.164 - 3.30	760	190	1521
MM 3.308 - 3.37	729		729
MM 3.377 - 3.51	750	190	1500
MM 3.519 - 3.59	750		750
SUB-TOTALS	24309	2830	37911
TOTAL	65050		

RAISED REFLECTIVE PAVEMENT MARKERS		
LOCATION	NEW 2-WAY AMBER EACH	REMOVAL EACH
	MM 0.000 - 0.39	26
MM 0.395 - 0.56	11	11
MM 0.563 - 0.68	8	8
MM 0.680 - 0.90	15	15
MM 0.904 - 1.07	11	11
MM 1.074 - 1.179	7	7
MM 1.179 - 1.277	6	6
MM 1.277 - 1.341	4	4
MM 1.341 - 1.377	2	2
MM 1.377 - 1.556	12	12
MM 1.556 - 1.752	13	13
MM 1.752 - 1.972	15	15
MM 1.972 - 2.471	33	33
MM 2.471 - 2.69	15	15
MM 2.696 - 2.79	7	7
MM 2.796 - 3.00	14	14
MM 3.003 - 3.16	11	11
MM 3.164 - 3.30	10	10
MM 3.308 - 3.37	5	5
MM 3.377 - 3.51	9	9
MM 3.519 - 3.59	5	5
TOTALS	239	239

PAVEMENT PATCHING, 17"					
LOCATION	SIZE	TYPE I	TYPE II	TYPE III	TYPE IV
		SQ YD	SQ YD	SQ YD	SQ YD
MM 0.20 NB	10' X 12'		13.3		
MM 0.20 SB	10' X 12'		13.3		
MM 0.21 SB	15' X 12'			20.0	
PROJECT LIMITS		4.0			25.0
15% CONT.			4.0	3.0	
TOTALS		4.0	30.6	23	25.0

NOT TO SCALE

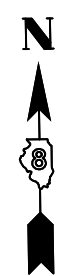
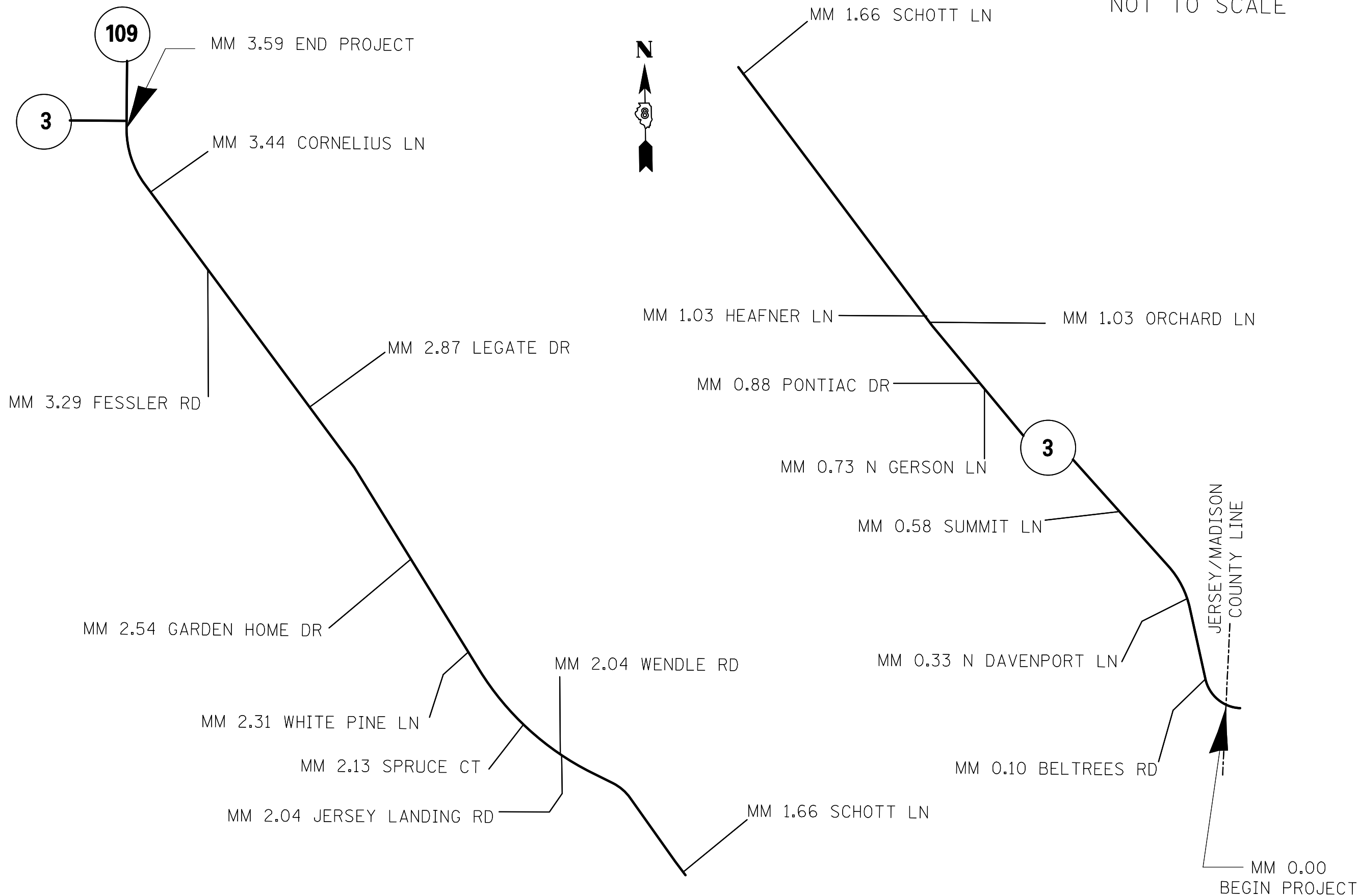

FILE NAME =	USER NAME = conoverpj	DESIGNED -	REVISED -	STATE OF ILLINOIS DEPARTMENT OF TRANSPORTATION	LINE DIAGRAM			F.A.S. RTE.	SECTION	COUNTY	TOTAL SHEETS	SHEET NO.
et:\pw\work\p\dot\conoverpj\d0351353\d876g59-shr-plan.dgn		DRAWN -	REVISED -		747	59RS-3	JERSEY	19	13			
PLOT SCALE = 100.0000' / in.		CHECKED -	REVISED -		CONTRACT NO. 76G59							
PLOT DATE = 1/28/2014		DATE -	REVISED -		SCALE: NOT TO SCALE	SHEET NO. 1 OF 1 SHEETS	MM. 0.00 TO MM. 3.73	FED. ROAD DIST. NO.	ILLINOIS	FED. AID PROJECT		

CONCRETE GUTTER - LOCATION 1

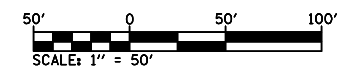
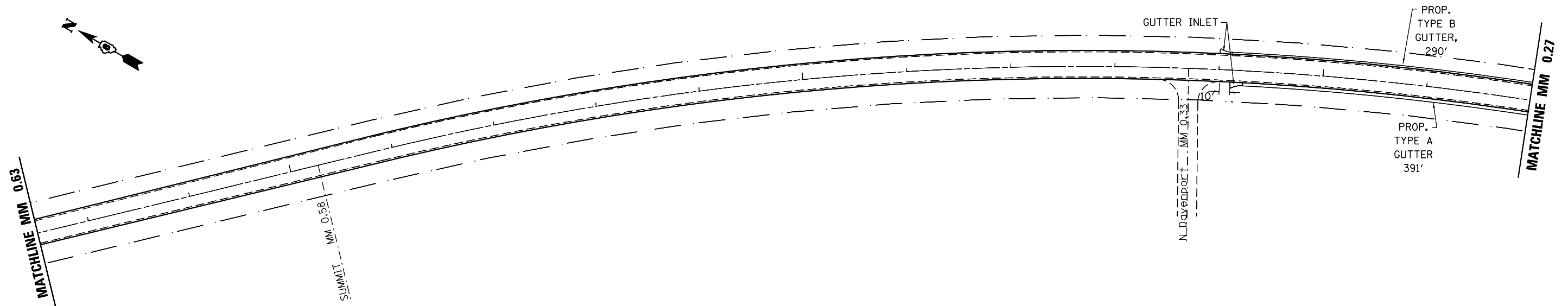

NOTE: SEE PAGE 19 FOR ENTRANCE A-A AND B-B DETAILS.

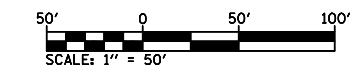
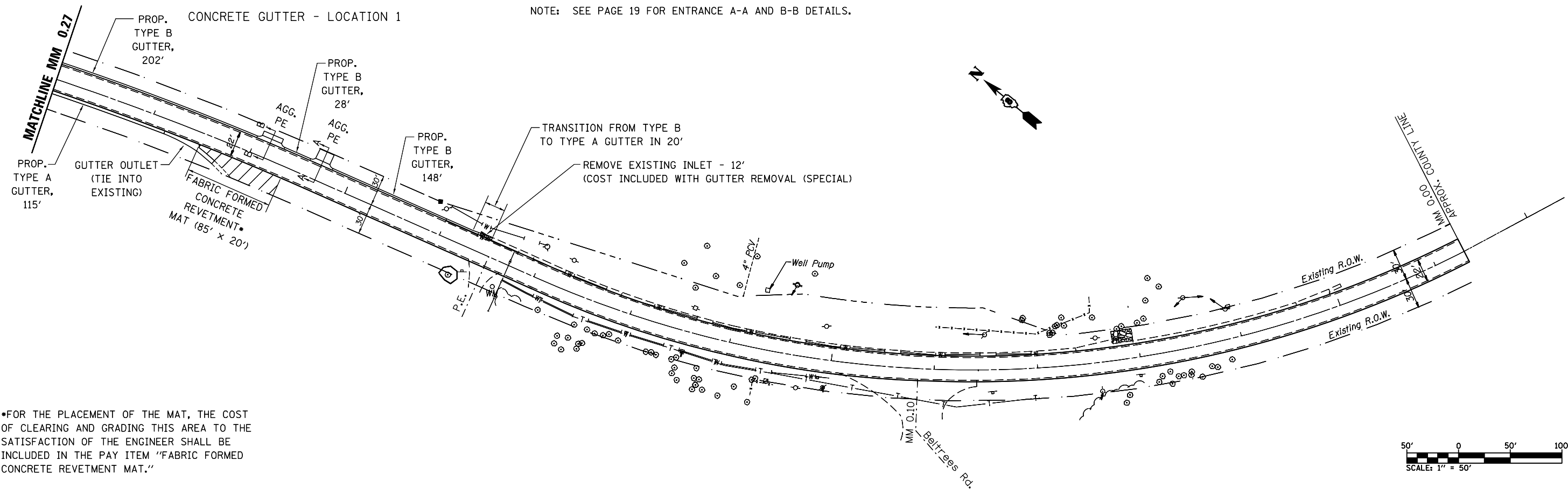

*FOR THE PLACEMENT OF THE MAT, THE COST OF CLEARING AND GRADING THIS AREA TO THE SATISFACTION OF THE ENGINEER SHALL BE INCLUDED IN THE PAY ITEM "FABRIC FORMED CONCRETE REVETMENT MAT."

FILE NAME =	USER NAME = conoverpj	DESIGNED -	REVISED -	STATE OF ILLINOIS DEPARTMENT OF TRANSPORTATION	CONCRETE GUTTER DETAILS			F.A.S. RTE.	SECTION	COUNTY	TOTAL SHEETS	SHEET NO.
et:\pwwork\pwwork\conoverpj\d0351353\d876g59-shr-plan.dgn		DRAWN -	REVISED -		747	59RS-3	JERSEY	19	14			
PLOT SCALE = 100.0000' / 1in.		CHECKED -	REVISED -		CONTRACT NO. 76G59							
PLOT DATE = 1/28/2014		DATE -	REVISED -		FED. ROAD DIST. NO.	ILLINOIS	FED. AID PROJECT					
				SCALE: 1" = 50'	SHEET NO. 2 OF 2 SHEETS	STA.	TO STA.					

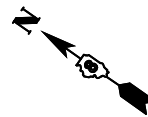

NOTE: SEE PAGE 19 FOR ENTRANCE C-C AND D-D DETAILS.

CONCRETE GUTTER - LOCATION 1

CONCRETE GUTTER - LOCATION 2

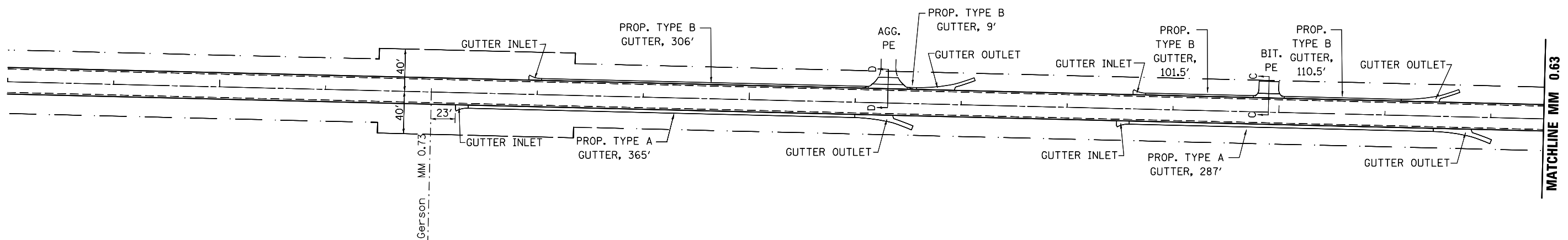

FILE NAME = e:\pwork\pwork\conoverpj\d0351353\d876g59-shr-plan.dgn	USER NAME = conoverpj	DESIGNED -	REVISED -	STATE OF ILLINOIS DEPARTMENT OF TRANSPORTATION	CONCRETE GUTTER DETAILS			F.A.S. RTE.	SECTION	COUNTY	TOTAL SHEETS	SHEET NO.
	PLOT SCALE = 100.0000' / in.	CHECKED -	REVISED -					747	59RS-3	JERSEY	19	15
PLOT DATE = 1/28/2014	DATE -	REVISED -	REVISED -		SCALE: 1" = 50'	SHEET NO. 1 OF 2 SHEETS	STA.	TO STA.	CONTRACT NO. 76G59			
					FED. ROAD DIST. NO. ILLINOIS FED. AID PROJECT							

CONCRETE GUTTER - LOCATION 1

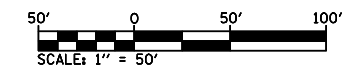
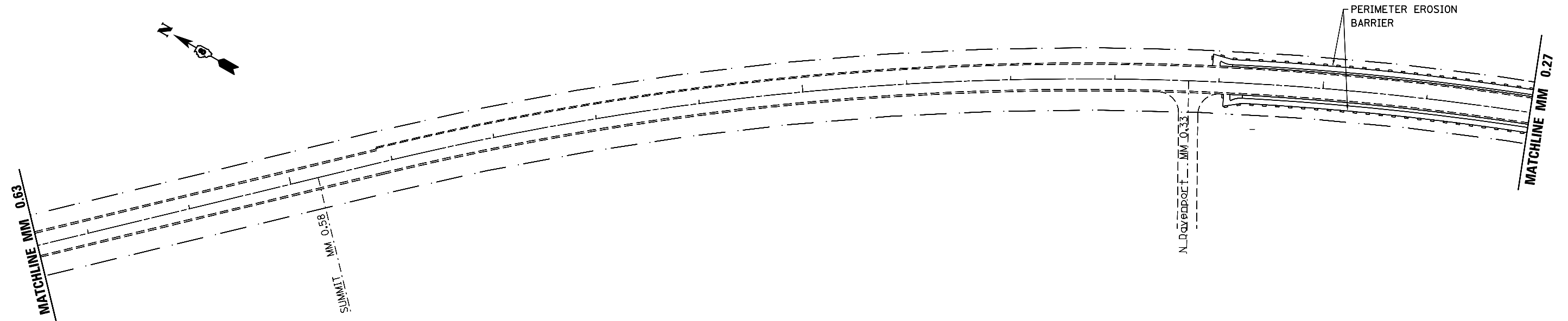

CONCRETE GUTTER - LOCATION 1

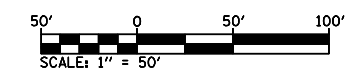
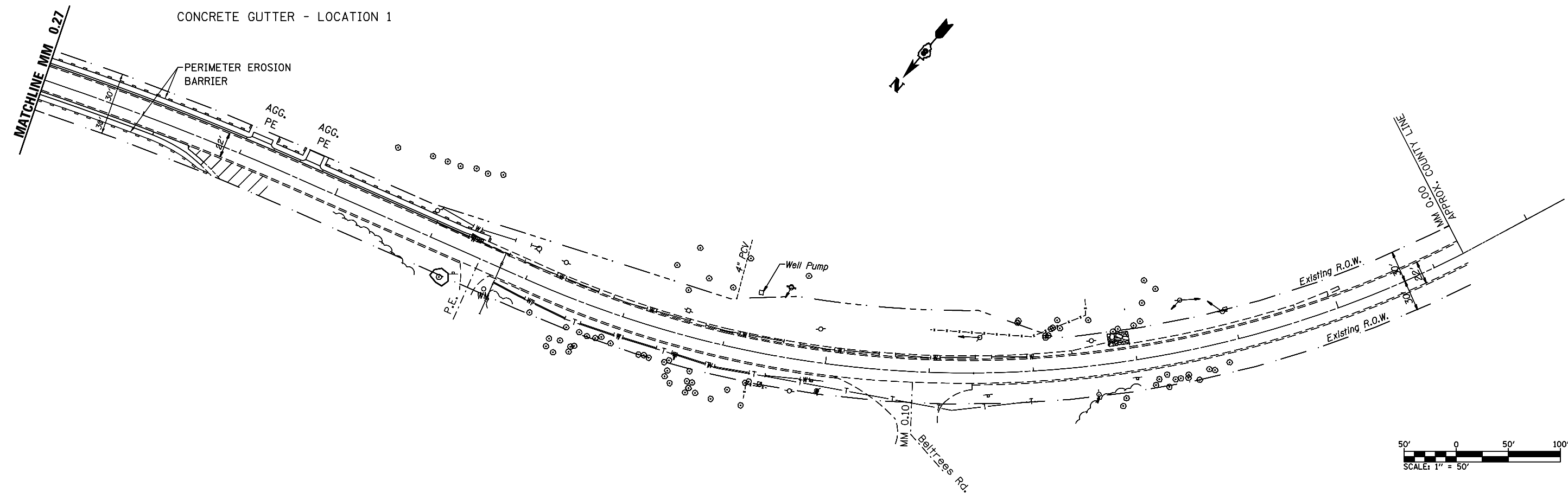

FILE NAME =	USER NAME = conoverpj	DESIGNED -	REVISED -
e:\pwork\pwork\conoverpj\d0351353\d876g59-shr-plan.dgn		DRAWN -	REVISED -
	PLOT SCALE = 100.0000' / in.	CHECKED -	REVISED -
	PLOT DATE = 1/28/2014	DATE -	REVISED -

STATE OF ILLINOIS
DEPARTMENT OF TRANSPORTATION

EROSION CONTROL PLAN

SCALE: 1" = 50' SHEET NO. 2 OF 2 SHEETS STA. TO STA.

F.A.S. RTE.	SECTION	COUNTY	TOTAL SHEETS	SHEET NO.
747	59RS-3	JERSEY	19	16
CONTRACT NO. 76G59				
FED. ROAD DIST. NO. ILLINOIS FED. AID PROJECT				

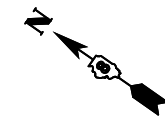

CONCRETE GUTTER - LOCATION 1

CONCRETE GUTTER - LOCATION 2

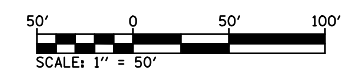
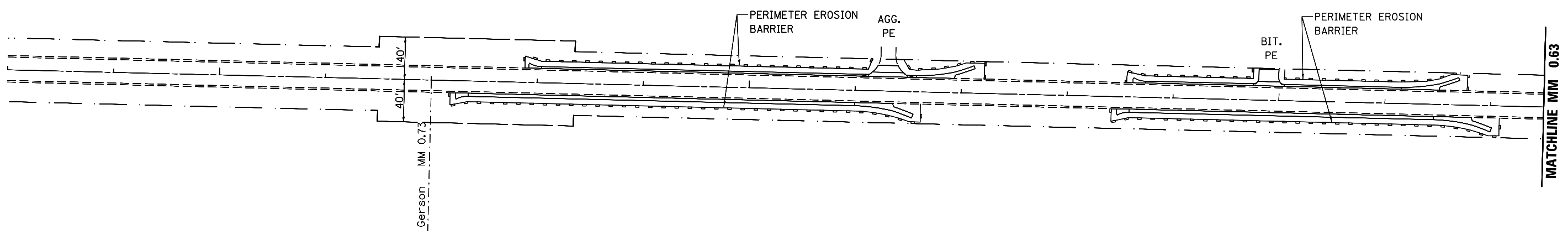

FILE NAME =	USER NAME = conoverpj	DESIGNED -	REVISED -
et:\pwork\pwork\conoverpj\d0351353\d876g59-shr-plan.dgn		DRAWN -	REVISED -
	PLOT SCALE = 100.0000' / in.	CHECKED -	REVISED -
	PLOT DATE = 1/28/2014	DATE -	REVISED -

**STATE OF ILLINOIS
DEPARTMENT OF TRANSPORTATION**

EROSION CONTROL PLAN

SCALE: 1" = 50' SHEET NO. 1 OF 2 SHEETS STA. TO STA.

F.A.S. RTE.	SECTION	COUNTY	TOTAL SHEETS	SHEET NO.
747	59RS-3	JERSEY	19	17
CONTRACT NO. 76G59				
FED. ROAD DIST. NO.	ILLINOIS FED. AID PROJECT			

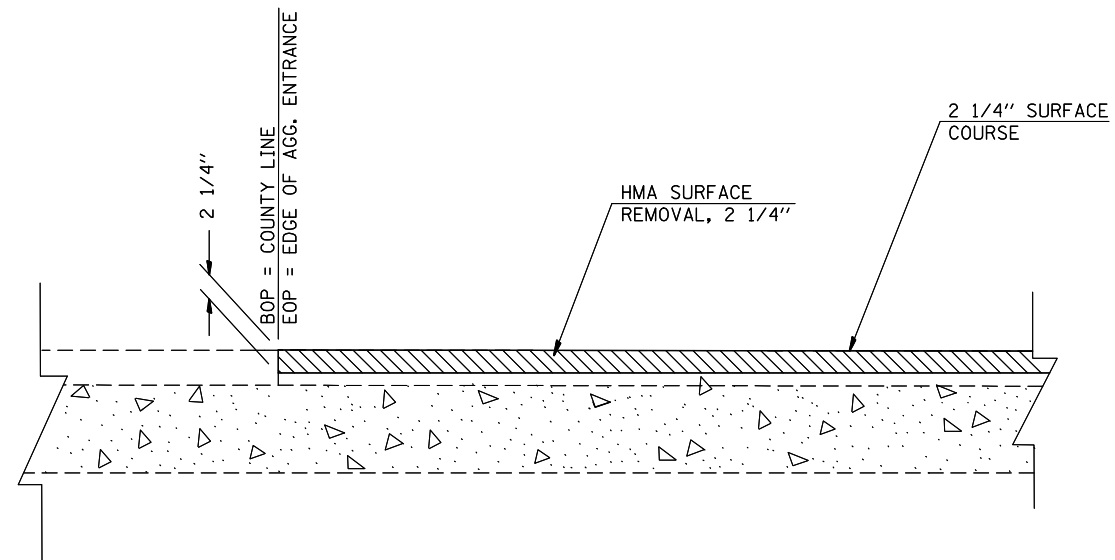

BEGINNING AND END OF PROJECT

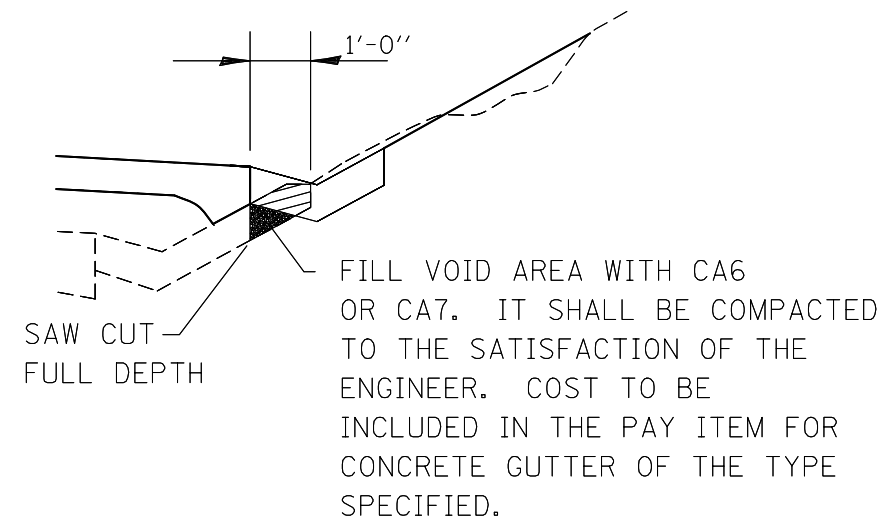

FILE NAME =	USER NAME = conoverpj	DESIGNED -	REVISED -
e:\pwork\pwork\conoverpj\d0351353\d876g59-shr-plan.dgn		DRAWN -	REVISED -
	PLOT SCALE = 100.0000' / 1in.	CHECKED -	REVISED -
	PLOT DATE = 1/28/2014	DATE -	REVISED -

STATE OF ILLINOIS
DEPARTMENT OF TRANSPORTATION

PLAN DETAILS

SCALE: SHEET NO. 1 OF 1 SHEETS STA. TO STA.

F.A.S. RTE.	SECTION	COUNTY	TOTAL SHEETS	SHEET NO.
747	59RS-3	JERSEY	19	18
FED. ROAD DIST. NO. ILLINOIS FED. AID PROJECT			CONTRACT NO. 76G59	

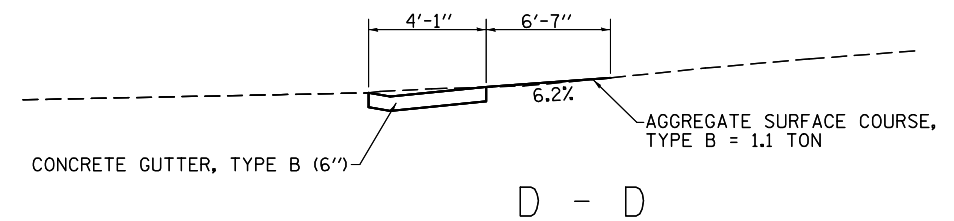
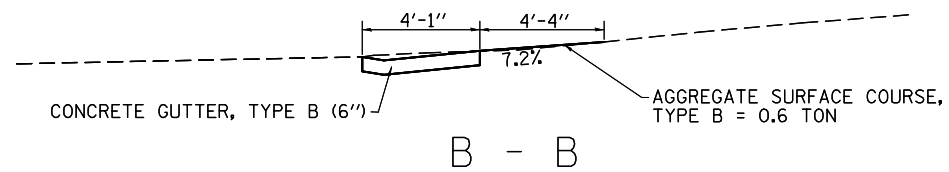
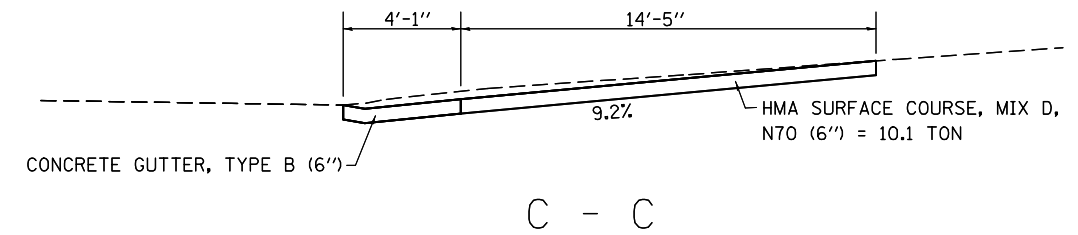
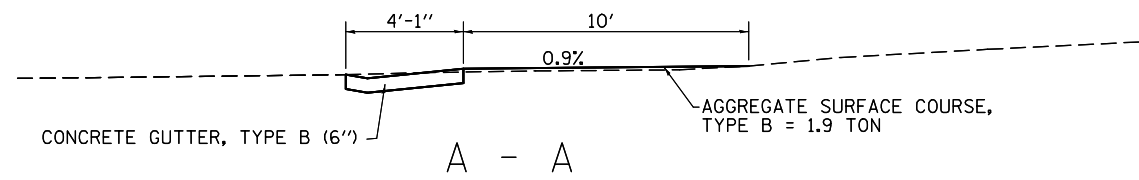

FILE NAME =	USER NAME = conoverpj	DESIGNED -	REVISED -
e:\pwork\pwork\conoverpj\d0351353\d876g59-shr-plan.dgn		DRAWN -	REVISED -
	PLOT SCALE = 100.0000' / 1in.	CHECKED -	REVISED -
	PLOT DATE = 1/28/2014	DATE -	REVISED -

STATE OF ILLINOIS
DEPARTMENT OF TRANSPORTATION

ENTRANCE DETAILS

SCALE: SHEET NO. 1 OF 1 SHEETS STA. TO STA.

F.A.S. RTE.	SECTION	COUNTY	TOTAL SHEETS	SHEET NO.
747	59RS-3	JERSEY	19	19
FED. ROAD DIST. NO. ILLINOIS FED. AID PROJECT			CONTRACT NO. 76G59	