

R = 459.11  
 T = 919.32'  
 L = 6.15'  
 E = ---  
 T.R. = ---  
 S.E. RUN = 744+85.81  
 P.C. STA. = 754+05.13  
 P.T. STA. = 754+05.13

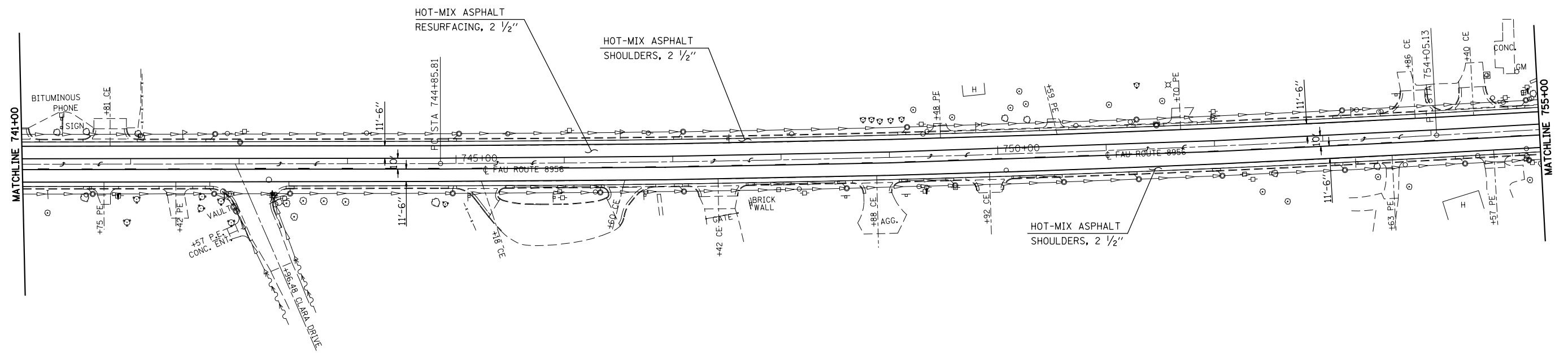

E = ---  
 T.R. = ---  
 S.E. RUN = 760+25.41  
 P.C. STA. = 760+25.41  
 P.T. STA. = 765+32.23

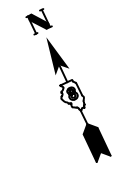
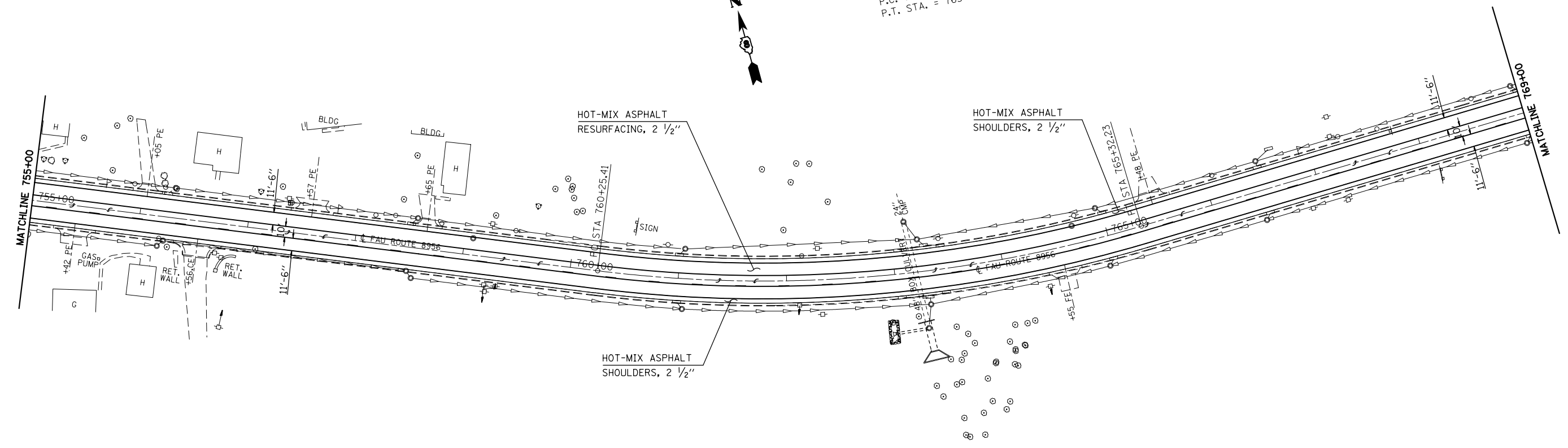

PAVEMENT MARKING SHOWN IS FOR INFORMATION ONLY.  
 SEE PAVEMENT MARKING SCHEDULE FOR QUANTITIES.

FILE NAME = c:\pwwork\pwwork\harbaugh\d0349109\d076g60-shr-plan.dgn	USER NAME = harbaughrd	DESIGNED -	REVISED -	<b>STATE OF ILLINOIS DEPARTMENT OF TRANSPORTATION</b>	<b>PLAN &amp; PAVEMENT MARKING SHEETS</b>			F.A.U. RTE. 8956	SECTION (59,60)RS-2	COUNTY MADISON	TOTAL SHEETS 27	SHEET NO. 20
	PLOT SCALE = 100.0000' / 1"	CHECKED -	REVISED -		SCALE: NA	SHEET NO. 5 OF 9 SHEETS	STA. 741+00	TO STA. 769+00	CONTRACT NO. 76G60			
	PLOT DATE = 1/31/2014	DATE -	REVISED -		FED. ROAD DIST. NO. ILLINOIS FED. AID PROJECT							