

**TYPICAL SECTION
IL ROUTE 177/127 INTERSECTION**

STA. 574+59 TO STA. 578+59
NORTH AND SOUTH LIMITS:
200' NORTH AND 200' SOUTH OF CL OF IL 177

NOTES:

THE PAVEMENT MAY REQUIRE VARIABLE MILLING AS DIRECTED BY THE RESIDENT ENGINEER TO RESTORE THE PAVEMENT PROFILE AND CROSS SLOPES FOR ADEQUATE DRAINAGE. THIS WORK SHALL BE INCLUDED IN THE COST OF BITUMINOUS SURFACE REMOVAL, 1 1/2". ADDITIONAL BINDER QUANTITY HAS ALSO BEEN ADDED TO THE PLANS TO BE USED FOR THIS CORRECTION.

THE RADII AT THE NORTHWEST AND SOUTHWEST CORNERS HAVE PCC SHOULDERS IN PLACE OF CURB AND GUTTER. THESE SHOULDERS SHALL BE MILLED AND RESURFACED WITH THE ADJOINING PAVEMENT; HOWEVER, THE EDGE LINE SHALL BE PLACED AT THE SAME LOCATION AS THE EXISTING.

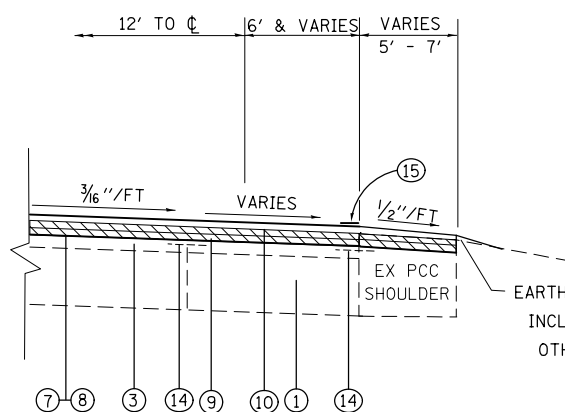

**SHOULDER DETAIL
NORTHWEST AND SOUTHWEST QUADRANTS**

SHOULDERS WERE CONSTRUCTED OF 13" PCC WITH PAVEMENT FABRIC OVER 4" CA 6 AGGREGATE. 2' EPOXY COATED BARS CONNECT THE SHOULDER TO THE PAVEMENT.

LEGEND

- ① EXISTING 9"-6"-9" PCC PAVEMENT
- ② EXISTING HMA BASE COURSE WIDENING, 9"
- ③ EXISTING HMA RESURFACING
- ④ EXISTING AGGREGATE SHOULDERS, TYPE B
- ④A EXISTING HMA SHOULDER
- ⑤ EXISTING CURB & GUTTER
- ⑥ EXISTING PCC BASE COURSE 9"
- ⑦ PROPOSED BITUMINOUS MATERIALS (PRIME COAT)
- ⑧ PROPOSED AGGREGATE (PRIME COAT)
- ⑨ PROPOSED LEVELING BINDER (MACHINE METHOD), IL-9.5FG, N70 - 3/4"
- ⑨A PROPOSED HMA BASE COURSE WIDENING, 8"
- ⑩ PROPOSED HMA SURFACE COURSE, MIX "C", N70 - 1 1/2"
- ⑫ PROPOSED HMA SHOULDERS, 8"
- ⑬ PROPOSED HMA SHOULDERS, VARIES 2 1/4" TO 1"
- ⑭ PROPOSED STRIP REFLECTIVE CRACK CONTROL TREATMENT
- ⑮ PROPOSED PAVEMENT MARKING
- ⑯ PROPOSED AGGREGATE WEDGE SHOULDER, TYPE B

 HMA SURFACE REMOVAL, 1 1/2": THIS PAY ITEM SHALL INCLUDE THE MILLING OF EXISTING PCC SHOULDER TO PREPARE FOR RESURFACING WITH THE ADJOINING PAVEMENT.

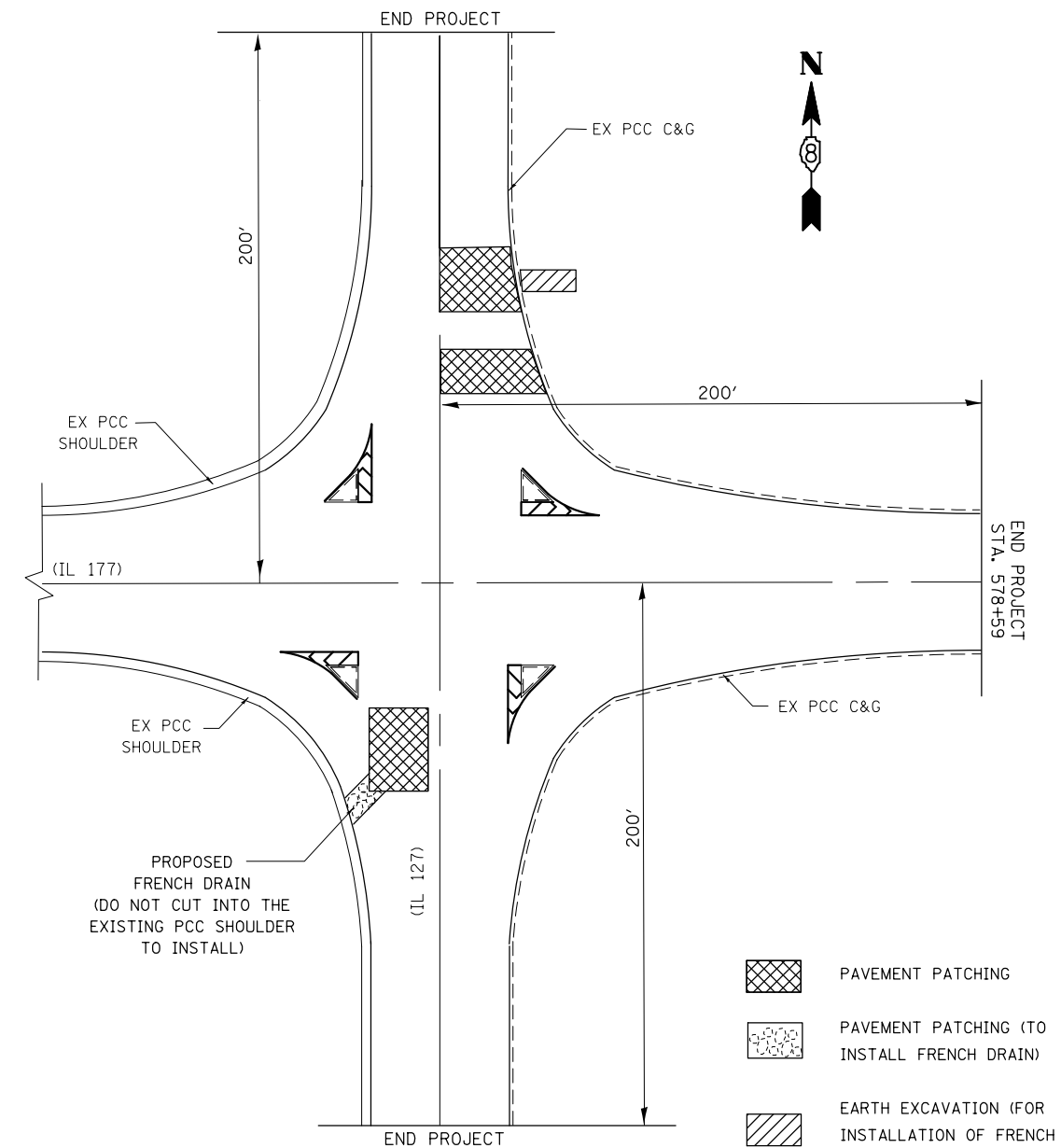

**LIMITS OF RESURFACING AT THE
IL 177/IL 127 INTERSECTION**

THE EXISTING JOINT OF THE NORTH LEG
A JOINT IS TO BE CONSTRUCTED ON THE EAST AND SOUTH LEGS

FILE NAME =	USER NAME = mlscmr	DESIGNED -	REVISED -
et:\pw\work\p\dot\mlscmr\d0345201\d87661-sht-pln.dgn		DRAWN -	REVISED -
	PLOT SCALE = 100.0000' / 1"	CHECKED -	REVISED -
	PLOT DATE = 2/6/2014	DATE -	REVISED -

**STATE OF ILLINOIS
DEPARTMENT OF TRANSPORTATION**

**TYPICAL SECTIONS /DETAILS
IL 177 /IL 127 INTERSECTION**

SCALE: SHEET NO. OF SHEETS STA. TO STA.

F.A. RTE.	SECTION	COUNTY	TOTAL SHEETS	SHEET NO.
•	(109,110)RS-1, 31-2RS	WASHINGTON	40	16
•	FAP 690/FAS 819/FAP 322	CONTRACT NO. 76G61		
FED. ROAD DIST. NO.	ILLINOIS FED. AID PROJECT			