

EXIST. CURVE CUR177B
 PI STA. 70+89.67
 $\Delta = 36^\circ 39' 44''$ (RT)
 $D = 1^\circ 45' 00''$
 $T = 1,084.76'$
 $R = 3,274.04'$
 $L = 2,094.98'$
 $E = 175.02'$
 PC STA. 60+04.91
 PT STA. 80+99.89

FOR INFORMATION ONLY

EXISTING PAVEMENT MARKING TO BE VERIFIED BY FIELD PERSONNEL

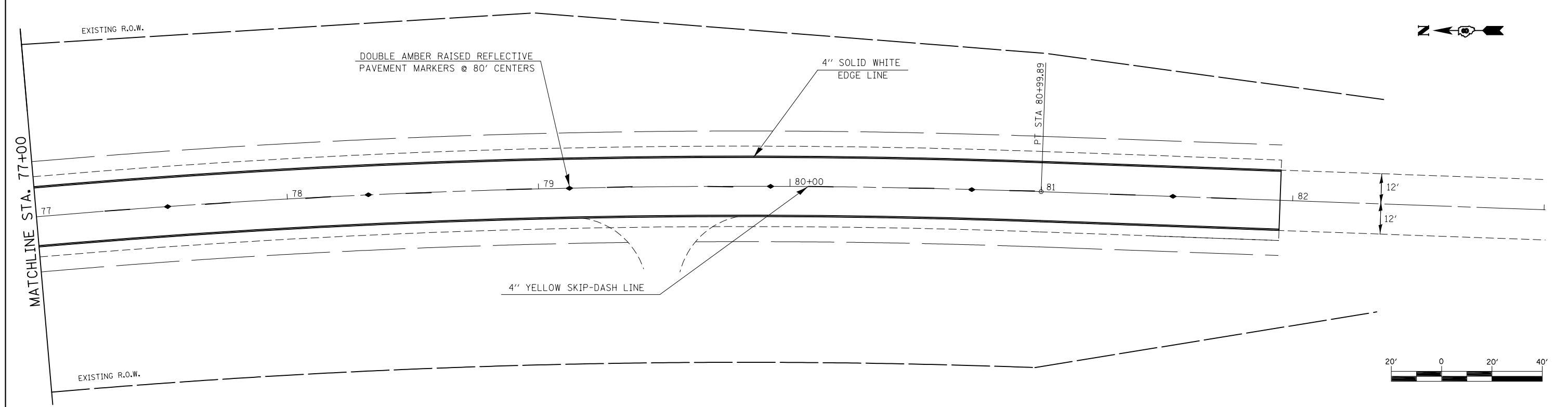

FILE NAME =	USER NAME = mlcsmr	DESIGNED -	REVISED -
et:\pwwork\pwwork\mlcsmr\d0345201\d07661-sht-pln.dgn		DRAWN -	REVISED -
	PLOT SCALE = 100.0000' / in.	CHECKED -	REVISED -
	PLOT DATE = 2/6/2014	DATE -	REVISED -

**STATE OF ILLINOIS
 DEPARTMENT OF TRANSPORTATION**

**EXISTING PAVEMENT MARKING
 WEST OF I-64 TO 0.61 MI. EAST OF I-64**

SCALE: SHEET NO. OF SHEETS STA. TO STA.

F.A. RTE.	SECTION	COUNTY	TOTAL SHEETS	SHEET NO.
*	(109,110)RS-1, 31-2RS	WASHINGTON	40	28
*FAP 690/FAS 819/FAP 322		CONTRACT NO. 76G61		
FED. ROAD DIST. NO. ILLINOIS FED. AID PROJECT				