

FOR INFORMATION ONLY

STATE OF ILLINOIS  
DEPARTMENT OF TRANSPORTATION

ROUTE NO.	SECTION	COUNTY	SHEET NO.	TOTAL SHEETS
25	B27HB	St. Clair	23	56

SHEET NO. 40  
69 SHEETS

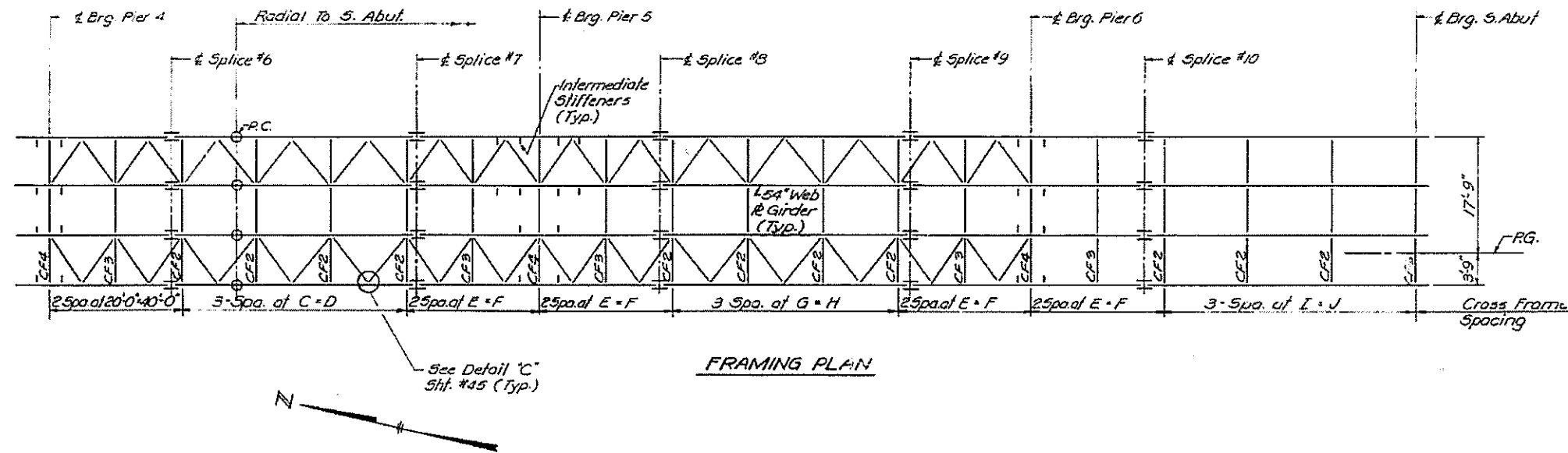
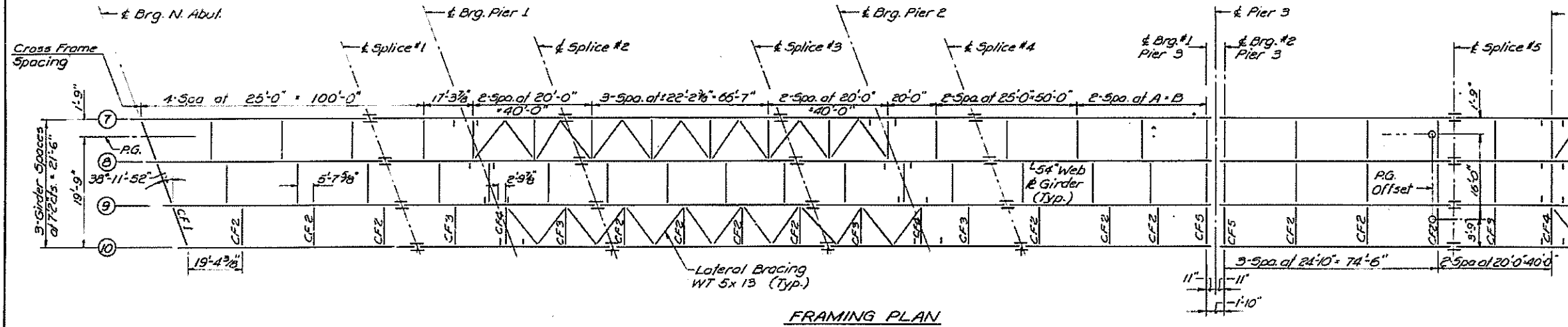

\* TOP OF WEB ELEVATIONS

Beam No.	7	8	9	10
Brig. N. Abut.	433.576	433.222	433.704	433.565
Splice #1	433.720	433.623	433.430	433.269
Brig. Pier 1	433.432	433.243	433.161	432.996
Splice #2	433.361	433.250	433.097	432.991
Splice #3	432.722	432.632	432.439	432.261
Brig. Pier 2	432.209	432.025	431.950	431.700
Splice #4	431.924	431.779	431.573	431.348
Brig. Pier 3 (Span 3)	430.720	430.572	430.560	430.428
Brig. Pier 3 (Span 4)	430.690	430.542	430.530	430.399
Splice #5	429.342	429.290	429.156	429.015
Brig. Pier 4	429.704	429.567	429.383	429.185
Splice #6	429.343	429.227	427.780	427.524
Splice #7	426.857	426.434	426.111	425.799
Brig. Pier 5	425.776	425.402	425.029	424.656
Splice #8	424.922	424.549	424.176	423.804
Splice #9	422.784	422.412	422.039	421.666
Brig. Pier 6	421.552	421.179	420.806	420.434
Splice #10	420.609	420.235	419.862	419.489
Brig. S. Abut.	418.190	417.817	417.444	417.072

\* For fabrication only, before any deflections.

Beam	A	B	C	D	E	F	G	H	I	J	Radius
7	21'-0 3/8"	43'-0 7/8"	122'-5 3/8"	67'-4 1/4"	20'-0"	40'-0"	122'-7 3/8"	67'-11 3/8"	25'-2 1/4"	75'-0 3/4"	1927.610'
8	18'-8 1/2"	37'-5"	22'-4 1/8"	67'-2 3/8"	19'-11 1/8"	39'-10 1/4"	22'-6 3/8"	67'-8 1/4"	25'-1 1/8"	75'-3 3/8"	1920.443'
9	15'-10 3/8"	31'-9 1/4"	122'-4 3/8"	67'-0 1/2"	19'-10 3/8"	39'-8 3/8"	22'-5 3/8"	67'-5 3/8"	25'-0 1/2"	75'-0 3/8"	1913.277'
10	—	—	122'-3 3/8"	66'-10 1/4"	19'-9 3/8"	39'-6 3/8"	22'-4 3/8"	67'-2 1/4"	24'-10 1/8"	74'-8 3/8"	1906.110'

LENGTHS ALONG E OF BEAMS

Note: See Sheet #41, #42, & #43 for span lengths, segment lengths and girder details.

DESIGNED: Rick Brunette  
 CHECKED: DAU KRULL  
 DRAWN: S.G. FERCHOW  
 CHECKED: J.K.

EXAMINED: [Signature]  
 PASSED: [Signature]  
 APPROVED: [Signature]

May 7 1981

RAMP-F  
 STRUCTURAL STEEL  
 F.A.I. RT. 270 SEC. 82-7HB  
 ST. CLAIR COUNTY  
 STATION 343+61.11