

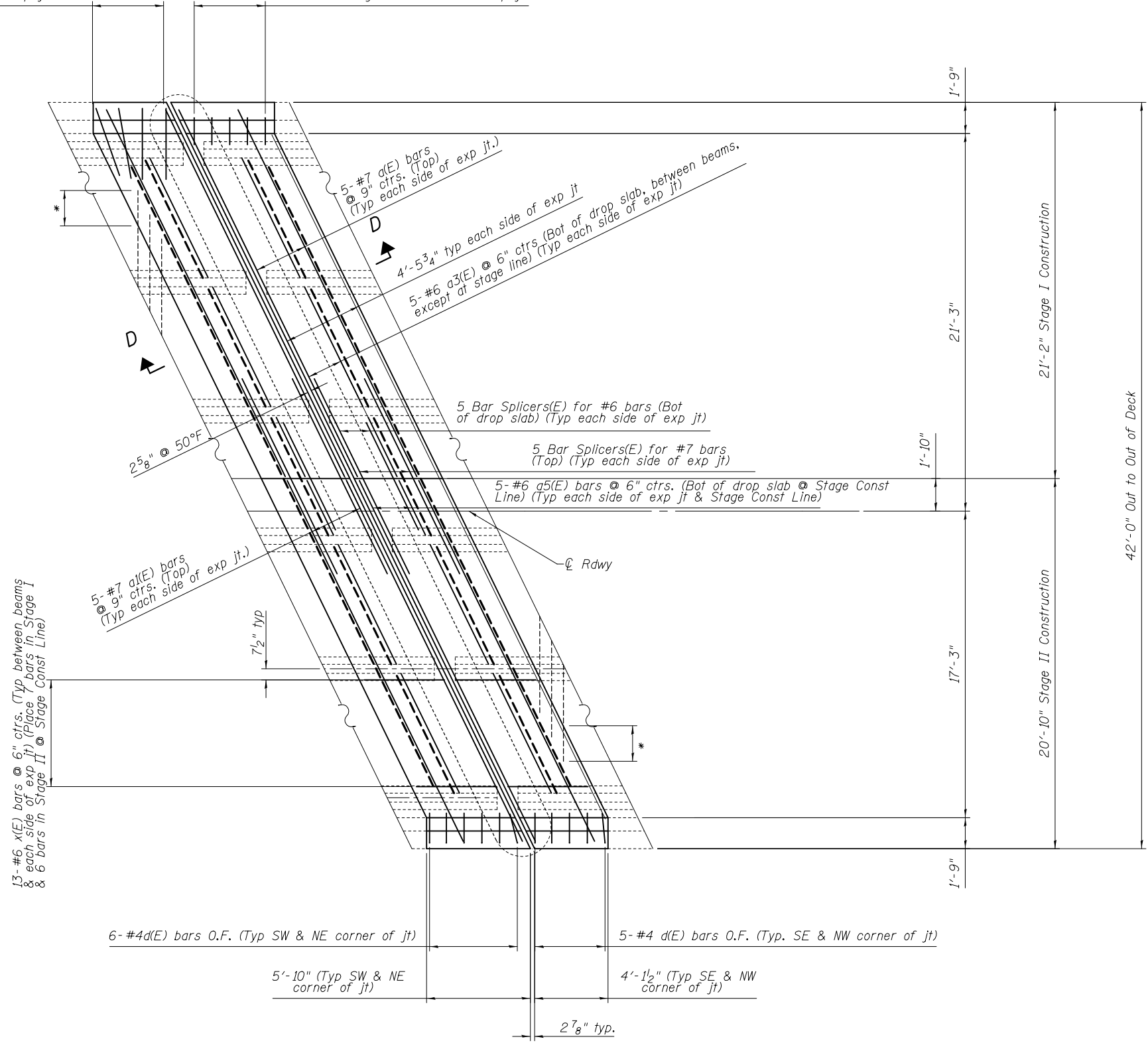

4- #6 a2(E) bars (Top) (Typ. each side of bridge & each side of exp jt)

5- #5 d1(E) bars I.F. (Typ. each side of bridge & each side of exp jt)



Note:

* Existing transverse bars extending from deck into removed area shall be cut allowing 2'-0" to extend into the removed area. In addition, these cut bars shall be cleaned, straighten, and incorporated into the new construction.

See sheet 12 of 22 for Section D-D.

CONCRETE REPLACEMENT

DESIGNED - A.Y.V.	EXAMINED	DATE -	STATE OF ILLINOIS DEPARTMENT OF TRANSPORTATION	JOINT REPLACEMENT (PIER 15) SN 014-0058	F.A.P. RTE.	SECTION	COUNTY	TOTAL SHEETS	SHEET NO.
CHECKED -	ENGINEER OF STRUCTURAL SERVICES				327	14-14B-I	CLINTON	27	15
DRAWN - A.Y.V.	PASSED	REVISOR	CONTRACT NO. 76G91						
CHECKED -	ENGINEER OF BRIDGES AND STRUCTURES	REVISOR	SHEET NO. 10 OF 22 SHEETS						
ILLINOIS FED. AID PROJECT									