

STATE OF ILLINOIS
DEPARTMENT OF TRANSPORTATION

ROUTE NO.	SECTION	COUNTY	TOTAL SHEETS	SHEET NO.
F.A. 409 14-14B	CLINTON	61	7	53 SHEETS

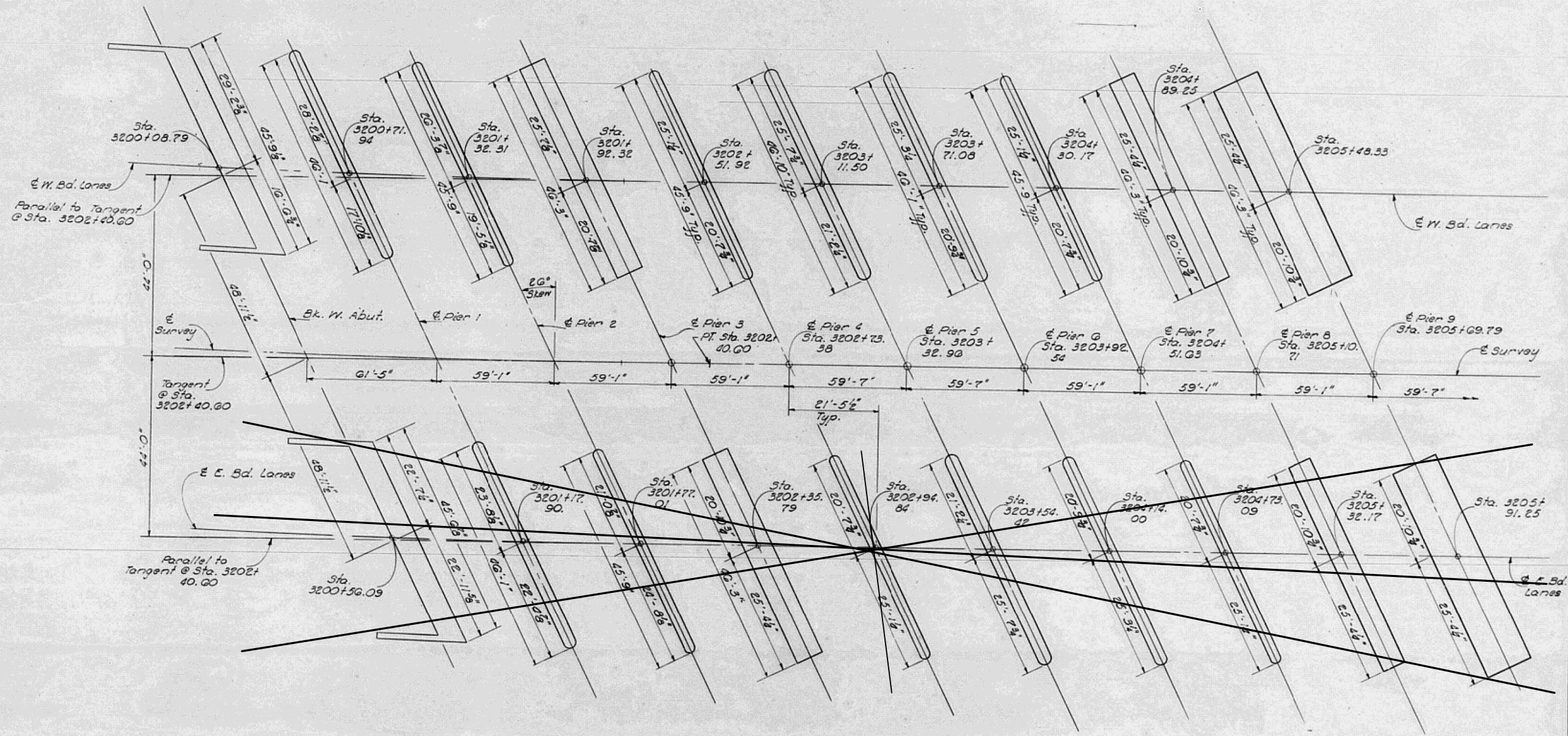

FOR INFORMATION ONLY

Note: All dimensions shown are at bottom of bent or footing.

DESIGNED	Suresh T Desai
CHECKED	Greg Boster
DRAWN	J. SCHNELLER
CHECKED	G.P.

EXAMINED
PASSED
APPROVED

[Signatures]

1973

FOOTING PLAN
F.A. RT. 409 SEC. 14-14B
CLINTON COUNTY
STA. 3200+00

DESIGNED - A.Y.V.	EXAMINED	DATE -	STATE OF ILLINOIS DEPARTMENT OF TRANSPORTATION	FOR INFORMATION ONLY - EXISTING FOOTING PLAN STRUCTURE NO. 014-0058	F.A.P. RTE.	SECTION	COUNTY	TOTAL SHEETS	SHEET NO.
CHECKED -	ENGINEER OF STRUCTURAL SERVICES	REVISED			327	14-14B-I	CLINTON	27	26
DRAWN - A.Y.V.	PASSED	REVISOR	SHEET NO. 21 OF 22 SHEETS		CONTRACT NO. 76G91				
CHECKED -	ENGINEER OF BRIDGES AND STRUCTURES	REVISOR			ILLINOIS FED. AID PROJECT				