

COUNTY: WILLIAMSON
 LOCATION: F.A.P. 331 (IL 13)
 ROUTE: 80% FEDERAL 20% STATE
 FUNDING: ROADWAY BRIDGE SAFETY
 WORK TYPE: 0001 0008 0021
 CONSTRUCTION TYPE CODE

CODE NO.	ITEM DESCRIPTION	UNIT	TOTAL QUANTITY	ROADWAY	BRIDGE	SAFETY
28000305	TEMPORARY DITCH CHECKS	FOOT	11335	11335		
28000400	PERIMETER EROSION BARRIER	FOOT	12763	12763		
28000500	INLET AND PIPE PROTECTION	EACH	191	191		
28100807	STONE DUMPED RIPRAP, CLASS A4	TON	3711	3711		
28200200	FILTER FABRIC	SQ YD	10	10		
28300400	AGGREGATE DITCH	TON	7	7		
30200650	PROCESSING MODIFIED SOIL 12"	SQ YD	110662	110662		
30201500	LIME	TON	2814	2814		
31100300	SUBBASE GRANULAR MATERIAL, TYPE A 4"	SQ YD	10121	10121		
31100700	SUBBASE GRANULAR MATERIAL, TYPE A 8"	SQ YD	83045	83045		
31100910	SUBBASE GRANULAR MATERIAL, TYPE A 12"	SQ YD	7962	7962		
31102000	SUBBASE GRANULAR MATERIAL, TYPE C	CU YD	895	895		
35100700	AGGREGATE BASE COURSE, TYPE A 8"	SQ YD	54897	54897		
40200500	AGGREGATE SURFACE COURSE, TYPE A 6"	SQ YD	2063	2063		
40200800	AGGREGATE SURFACE COURSE, TYPE B	TON	200	200		
40201000	AGGREGATE FOR TEMPORARY ACCESS	TON	5000	5000		
40600100	BITUMINOUS MATERIALS (PRIME COAT)	GALLON	45694	45694		
40600115	POLYMERIZED BITUMINOUS MATERIALS (PRIME COAT)	GALLON	7000	7000		

FILE NAME: c:\pwork\p10\dot\lavand\ba\0363010\078221-01-500-02.dgn
 USER NAME: RUSERS
 DESIGNED: KN
 DRAWN: AS
 CHECKED: -
 DATE: -
 PLOT SCALE: 2.0000 / in.
 PLOT DATE: 4/15/2014

STATE OF ILLINOIS
 DEPARTMENT OF TRANSPORTATION

SUMMARY OF QUANTITIES
 SCALE: SHEET NO. 2 OF 16 SHEETS STA. TO STA.

F.A.P. RTE. SECTION COUNTY TOTAL SHEETS NO.
 331 1(1)-318-2, N-4, TS-4, HBK-1 WILLIAMSON 733 8
 DRAWING NO. S00-02 CONTRACT NO. 78221
 ILLINOIS FED. AID PROJECT

REV. 4-16-14

PAVEMENT AND SHOULDER SCHEDULE

LOCATION			PROCESSING MODIFIED SOIL 12"	LIME	SUBBASE GRANULAR MATERIAL, TYPE A 8"	SUBBASE GRANULAR MATERIAL, TYPE A 12"	SUBBASE GRANULAR MATERIAL, TYPE C	AGGREGATE BASE COURSE, TYPE A 8"	BITUMINOUS MATERIALS (PRIME COAT) POUND	HOT-MIX ASPHALT BINDER COURSE, IL-19.0, N90	HOT-MIX ASPHALT SURFACE COURSE, MIX "C", N90	HOT-MIX ASPHALT SURFACE COURSE, MIX "D", N90	HOT-MIX ASPHALT PAVEMENT (FULL-DEPTH) 10 3/4"
STATION	TO	STATION	SQ YD	TON	SQ YD	SQ YD	CU YD	SQ YD		TON	TON	TON	SQ YD
IL 13 WESTBOUND													
480+37.10	-	492+29.77			5,586								
492+29.77	-	561+17.50			22,948								
561+17.50	-	592+90.74			12,054								
441+90	-	464+97											
468+62	-	592+91											
587+23	-	592+33											
IL 13 EASTBOUND													
479+50.00	-	492+30.25			4,553								
492+30.25	-	561+17.50			26,350								
561+17.50	-	587+77.88			8,892								
443+91	-	464+00											
467+57	-	587+78											
580+00	-	585+73											
RAMP A													
10+00.00	-	24+38.21	5550	137.4			155						3,118
RAMP B													
16+60.09	-	29+21.90	5,660	140.1			140						3,437
RAMP C													
10+00.00	-	21+48.77	5,290	130.9			126						3,293
RAMP D													
16+60.11	-	29+21.40	5,291	131.0			112						3,491
WOLF CREEK ROAD													
83+02.00	-	85+15.46	1,431	35.4									1,244
85+15.46	-	87+50.00	1,356	33.6			16						1,063
87+50.00	-	90+97.27	2,146	53.1			37						1,710
90+97.27	-	98+31.08	6,144	152.1			89						3,899
98+31.08	-	100+04.91											
101+04.91	-	100+29.15											
100+75.92	-	103+25.70	1,802	44.6			28						1,321
103+25.70	-	109+67.28	5,235	129.6			79						3,184
109+67.28	-	113+50.00	2,901	71.8			61						1,988
113+50.00	-	116+70.88	1,092	27.0			17						746
HAWKEYE COURT													
10+00.00	-	11+35.00				376		322	72	44	26		
NORTH FRONTAGE ROAD													
22+55.43	-	27+68.28	1,910	47.3			1,559	351	218	131			
27+68.28	-	28+01.14	116	2.9			100	23	13	8			
50+75.00	-	52+25.85	1,088	26.9			1,032	232	142	85			
52+25.85	-	53+83.13	1,029	25.5			1,013	228	139	83			
53+83.13	-	69+59.77	6,004	148.6			5,415	1,218	742	444			
69+59.77	-	74+40.74	359	8.9			332	75	41	24		152	
74+40.74	-	96+66.30	7,689	190.3			7,451	1,676	998	595			
96+66.30	-	97+02.92	99	2.5			99	22	14	8			
97+02.92	-	104+70.50	2,694	66.7			2,606	586	348	207			
104+70.50	-	111+62.48	2,885	71.4			2,470	556	346	207			
111+62.48	-	116.89.20	2,065	51.1			1,735	390	242	145			
116+89.20	-	122+11.66						248				154	
122+11.66	-	124+66.73	826	20.4			802	180	81	48			
124+66.73	-	128+21.17	1,556	38.5			1,038	234	123	73			
128+21.17	-	138+21.17						544				338	
COUNTRY AIRE DRIVE													
8+78.46	-	11+80.00				861		818	184	109	65		
FLEMING ROAD													
30+00.00		33+50.00				1,004		936		125	74		
SHEET TOTALS			72,218	1,787	80,383	2,241	860	27,728	6,820	3,724	2,224	645	28,494

△ REV. 4-16-14

FILE NAME *	USER NAME = coolann	DESIGNED - KN	REVISED -	STATE OF ILLINOIS	PAVEMENT AND SHOULDER SCHEDULE	F.A.P. RTE.	SECTION	COUNTY	TOTAL SHEETS	SHEET NO.
en\p\work\pav\dot\coolann\0363618\0978221-ph-024-01.dgn		DRAWN - AS	REVISED -	DEPARTMENT OF TRANSPORTATION		331	01-31R-2, N-4, TS-4, HBK-1	WILLIAMSON	733	43
	PLOT SCALE = 2.8828' / 1"	CHECKED -	REVISED -				SCH-01			
	PLOT DATE = 4/16/2014	DATE -	REVISED -							CONTRACT NO. T8221
						SCALE:	SHEET NO. 1 OF 56 SHEETS	STA.	TO STA.	

PAVEMENT AND SHOULDER SCHEDULE

LOCATION			HOT-MIX ASPHALT PAVEMENT (FULL-DEPTH) 15 1/4"	AGGREGATE SHOULDERS, TYPE A 8"	AGGREGATE SHOULDERS, TYPE B	HOT-MIX ASPHALT SHOULDERS, 4"	HOT-MIX ASPHALT SHOULDERS, 8"	HOT-MIX ASPHALT SHOULDERS, 15 1/4"	POLYMERIZED BITUMINOUS MATERIALS, (PRIME COAT) POUND	POLYMERIZED HOT-MIX ASPHALT SURFACE COURSE, MIX "E", N90 TON	HOT-MIX ASPHALT SURFACE REMOVAL, 2" SQ YD	TEMPORARY PAVEMENT SQ YD	REMARKS
STATION	TO	STATION	SQ YD	SQ YD	TON	SQ YD	SQ YD	SQ YD		TON	SQ YD	SQ YD	
IL 13 WESTBOUND													
480+37.10	-	492+29.77	3,160					2,373					INCLUDES INSIDE SHOULDER PAVEMENT
492+29.77	-	561+17.50	11,916					10,941					INCLUDES INSIDE SHOULDER PAVEMENT
561+17.50	-	592+90.74	6,383					5,314					INCLUDES INSIDE SHOULDER PAVEMENT AND RAISED MEDIAN CROSSOVER
441+90	-	464+97							2,768	688	6,146		
468+62	-	592+91							14,915	3,710	33,141		
587+23	-	592+33							612	59	524		LEFT TURN LANE
IL 13 EASTBOUND													
479+50.00	-	492+30.25	2,490					2,102					INCLUDES INSIDE SHOULDER PAVEMENT
492+30.25	-	561+17.50	13,689					12,424					INCLUDES INSIDE SHOULDER PAVEMENT
561+17.50	-	587+77.88	4,403					4,500					INCLUDES INSIDE SHOULDER PAVEMENT
443+91	-	464+00							2,411	598	5,342		
467+57	-	587+78							14,425	3,589	32,055		
580+00	-	585+73							688	63	565		
RAMP A													
10+00.00	-	24+38.21		699			2,030						
RAMP B													
16+60.09	-	29+21.90		659			1,831						
RAMP C													
10+00.00	-	21+48.77		582			1,652						
RAMP D													
16+60.11	-	29+21.40		576			1,466						
WOLF CREEK ROAD													
83+02.00	-	85+15.46											
85+15.46	-	87+50.00					206						
87+50.00	-	90+97.27					490						
90+97.27	-	98+31.08					1,175						
98+31.08	-	100+04.91											
101+04.91	-	100+29.15										5	STRUCTURE 100-0099 BACKFILL FOR ISLAND REMOVAL
100+75.92	-	103+25.70					364						
103+25.70	-	109+67.28					1,035						
109+67.28	-	113+50.00					802						
113+50.00	-	116+70.88					220						
HAWKEYE COURT													
10+00.00	-	11+35.00											
NORTH FRONTAGE ROAD													
22+55.43	-	27+68.28										360	TEMP PAVEMENT IN STAGE 1 CONSTRUCTION
27+68.28	-	28+01.14		24									
50+75.00	-	52+25.85		49									
52+25.85	-	53+83.13											
53+83.13	-	69+59.77		1,170									
69+59.77	-	74+40.74		374	2								
74+40.74	-	96+66.30		3,294									
96+66.30	-	97+02.92											
97+02.92	-	104+70.50		1,177									
104+70.50	-	111+62.48											
111+62.48	-	116+89.20											
116+89.20	-	122+11.66			5								
122+11.66	-	124+66.73		174		171							
124+66.73	-	128+21.17		145		145							
128+21.17	-	138+21.17			10								
COUNTRY AIRE DRIVE													
8+78.46	-	11+80.00		108									
FLEMING ROAD													
30+00.00	-	33+50.00		261									
SHEET TOTALS			42,041	9,292	17	316	11,271	37,654	35,619	8,707	77,773	365	

FILE NAME =	USER NAME = colson	DESIGNED - KN	REVISED -	STATE OF ILLINOIS DEPARTMENT OF TRANSPORTATION	PAVEMENT AND SHOULDER SCHEDULE	F.A.P. RTE.	SECTION	COUNTY	TOTAL SHEETS	SHEET NO.
D:\pwork\pwork\colson\0363618\047823\pav-sch-02.dgn		DRAWN - AS	REVISED -			33	(1-3R-2, N-4, TS-4, HBK-1)	WILLIAMSON	733	44
PLOT SCALE = 2.0000 / 1"		CHECKED -	REVISED -			DRAWING NO. SCH-02		CONTRACT NO. 78221		
PLOT DATE = 4/10/2014		DATE -	REVISED -			SCALE: SHEET NO. 2 OF 56 SHEETS		STA. TO STA.		

△ REV. 4-16-14

(1-3R-2, N-4, TS-4, HBK-1)

PAVEMENT AND SHOULDER SCHEDULE

LOCATION			PROCESSING MODIFIED SOIL 12"	LIME TON	SUBBASE GRANULAR MATERIAL, TYPE A 8"	SUBBASE GRANULAR MATERIAL, TYPE A 12"	SUBBASE GRANULAR MATERIAL, TYPE C CU YD	AGGREGATE BASE COURSE, TYPE A 8"	BITUMINOUS MATERIALS (PRIME-COAT) POUND	HOT-MIX ASPHALT BINDER COURSE, IL-19.0, N90 TON	HOT-MIX ASPHALT SURFACE COURSE, MIX "C", N90 TON	HOT-MIX ASPHALT SURFACE COURSE, MIX "D", N90 TON	HOT-MIX ASPHALT PAVEMENT (FULL-DEPTH) 10 3/4" SQ YD
STATION	TO	STATION	SQ YD		SQ YD	SQ YD		SQ YD					
DONNA DRIVE													
85+21.41	-	100+00.00	6566	162.5				6,446	3,992	871	520		
100+00.00	-	132+78.62	12866	318.4				12,368	7,377	1,666	994		
132+78.62	-	144+16.11							2,218			357	
SARA LANE													
8+20.00	-	10+00.00				508		487	243	64	38		
MAIN STREET SOUTH													
1+00.00	-	3+55.00	798	19.8			15		306				584
3+55.00	-	5+85.00	497	15.0			20						314
MAIN STREET NORTH													
0+00.00	-	15+07.50	5,439	134.6					3,618				4,423
0+65.22	-	0+75.76											
PLAZA DRIVE EAST													
126+47.01	-	126+72.01				79		77	41	9	5		
126+72.01	-	127+83.42				381		322	184	42	25		
SAMUEL ROAD													
6+00.00	-	10+90.00				1933		1,874		188	112		
15+42.43	-	17+24.52				966		946	328	105	62		
17+88.53	-	19+70.77				1029		993	328	113	67		
BRIGGS ROAD													
6+26.09	-	9+36.00	1,681	41.6				1,633	558	187	112		
10+00.00	-	11+48.74	723	17.9				714	268	79	47		
11+48.74	-	13+22.78	530	13.1				515	313	69	44		
BRIGGS ROAD SPUR													
100+00.00	-	102+70.00				825		794	486	105	63		
SHEET TOTALS			29,100	723	0	5,721	35	27,189	20,260	3,497	2,089	357	5,321
SHEET TOTALS FROM PVMT SCH 01-02			72,218	1,787	80,383	2,241	860	27,728	6,820	3,724	2,224	645	28,494
SHEET TOTALS FROM DWY SCH-22					2,003				486				
SHEET TOTALS FROM DWY SCH-23					658				16				
PROJECT TOTALS			101,318	2,510	83,045	7,962	895	54,897	27,583	7,222	4,313	1,002	33,815

△ REV. 4-16-14

FILE NAME =	USER NAME = colenn	DESIGNED - KH	REVISED -	STATE OF ILLINOIS DEPARTMENT OF TRANSPORTATION	PAVEMENT AND SHOULDER SCHEDULE	F.A.P. RTE.	SECTION	COUNTY	TOTAL SHEETS	SHEET NO.
ca:\pwork\pvd\colenn\8363810\097021-sh4-SCH-03.dgn		DRAWN - AS	REVISED -			331	(1-3R-2, H-4, TS-4, HBK-1)	WILLIAMSON	733	45
	PLOT SCALE = 2.8888 * / in.	CHECKED -	REVISED -				SCH-03			CONTRACT NO. 78221
	PLOT DATE = 4/28/2014	DATE -	REVISED -							ILLINOIS FED. AID PROJECT

SCALE: SHEET NO. 3 OF 56 SHEETS STA. TO STA.

(1-3R-2, H-4, TS-4, HBK-1)

PAVEMENT AND SHOULDER SCHEDULE

LOCATION			HOT-MIX ASPHALT PAVEMENT (FULL-DEPTH) 1 1/4"	AGGREGATE SHOULDERS, TYPE A 8"	AGGREGATE SHOULDERS, TYPE B	HOT-MIX ASPHALT SHOULDERS, 4"	HOT-MIX ASPHALT SHOULDERS, 6"	HOT-MIX ASPHALT SHOULDERS, 15 1/4"	POLYMERIZED BITUMINOUS MATERIALS, (PRIME COAT) POUND	POLYMERIZED HOT-MIX ASPHALT SURFACE COURSE, MIX "E", NSO	HOT-MIX ASPHALT SURFACE REMOVAL, 2"	TEMPORARY PAVEMENT	REMARKS
STATION	TO	STATION	SQ YD	SQ YD	TON	SQ YD	SQ YD	SQ YD		TON	SQ YD	SQ YD	
DONNA DRIVE													
85+21.41	-	100+00.00		1,965									
100+00.00	-	132+78.62		4,507									
132+78.62	-	144+16.11			117								
SARA LANE													
8+20.00	-	10+00.00											
MAIN STREET SOUTH													
1+00.00	-	3+55.00					201						
3+55.00	-	5+85.00					154						
MAIN STREET NORTH													
0+00.00	-	15+07.50											
0+65.22	-	0+75.76										25	BACKFILL FOR ISLAND REMOVAL
PLAZA DRIVE EAST													
126+47.01	-	126+72.01				12							
126+72.01	-	127+83.42				18							
SAMUEL ROAD													
6+00.00	-	10+90.00		213		431							
15+42.43	-	17+24.52		83		167							
17+88.53	-	19+70.77		77		164							
BRIGGS ROAD													
6+26.09	-	9+36.00		239		236							
10+00.00	-	11+48.74				126							
11+48.74	-	13+22.78										350	TEMP PAVEMENT IN STAGE 1 CONSTRUCTION
BRIGGS ROAD SPUR													
100+00.00	-	102+70.00										270	TEMP PAVEMENT IN STAGE 1 CONSTRUCTION
SHEET TOTALS			0	7,084	117	1,154	355	0	0	0	0	645	
SHEET TOTALS FROM PVMT SCH 01-02			42,041	9,292	17	316	11,271	37,654	35,819	8,707	77,773	365	
SHEET TOTALS FROM DWY SCH-22													
SHEET TOTALS FROM DWY SCH-23													
PROJECT TOTALS			42,041	16,376	135	1,470	11,626	37,654	35,819	8,707	77,773	1,010	

△ REV. 4-16-14

FILE NAME *	USER NAME = ccolema	DESIGNED - KN	REVISED -	STATE OF ILLINOIS DEPARTMENT OF TRANSPORTATION	PAVEMENT AND SHOULDER SCHEDULE	F.A.P. RTE. 33R	SECTION d-31R-2, N-4, TS-4, HBK-1	COUNTY WILLIAMSON	TOTAL SHEETS 733	SHEET NO. 46
as\pvc\work\pvc\col\cma\09363618\097821-1-11-SCH-04.dgn		DRAWN - AS	REVISED -							
	PLOT SCALE = 2.0000' / 1" =	CHECKED -	REVISED -							
	PLOT DATE = 4/16/2014	DATE -	REVISED -							
						SCALE:	SHEET NO. 4 OF 56 SHEETS	STA.	TO STA.	ILLINOIS FED. AID PROJECT

d-31R-2, N-4, TS-4, HBK-1

DRIVEWAY SCHEDULE

LOCATION		ENTRANCE TYPE	EXISTING SURFACE TYPE	PROPOSED APRON SURFACE TYPE	PROPOSED SURFACE TYPE	SUBBASE GRANULAR MATERIAL TYPE A		AGGREGATE SURFACE COURSE, TYPE A 6"	BITUMINOUS MATERIALS (PRIME/COAT) POUNDS	INCIDENTAL HOT-MIX ASPHALT SURFACING TON	PORTLAND CEMENT CONCRETE DRIVEWAY PAVEMENT, 6 INCH SQ YD	PORTLAND CEMENT CONCRETE DRIVEWAY PAVEMENT, 7 INCH SQ YD	COMBINATION CONCRETE CURB & GUTTER, TYPE B-6.12 FOOT	REMARKS
						4" SQ YD	8" SQ YD							
WOLF CREEK ROAD														
84+42.69		RT	PE	AGGREGATE	CONCRETE	AGGREGATE		24			24			
84+87.46		RT	FE	AGGREGATE	CONCRETE	AGGREGATE		25				23		
112+12.26		LT	PE	BITUMINOUS		BITUMINOUS		56	25	6				
114+33.96		RT	PE	BITUMINOUS		BITUMINOUS		31	14	3				
115+14.44		RT	PE	BITUMINOUS		BITUMINOUS		37	17	4				
116+40.56		RT	PE	AGGREGATE		AGGREGATE			49					
116+50.69		LT	PE	AGGREGATE		AGGREGATE		21	26					
HAWKEYE COURT														
10+74.84		RT	PE	AGGREGATE		CONCRETE		41			41			
11+10.16		LT	PE	CONCRETE		CONCRETE		39			39			
NORTH FRONTAGE ROAD														
58+96.17		RT	FE	NONE		AGGREGATE	106	8		99				33.0
58+96.17		LT	FE	NONE	CONCRETE	AGGREGATE	138	42		97			97	
79+00.00		RT	CE	BITUMINOUS		BITUMINOUS		264		29				
84+33.49		RT	CE	NONE		BITUMINOUS		167	75	19				
93+96.17		RT	FE	NONE		AGGREGATE	116			116				
102+46.17		RT	FE	NONE		AGGREGATE	115			115				
112+03.57		RT	CE	OIL/CHIP		BITUMINOUS		155	60	15				97.5
112+49.21		RT	CE	CONCRETE		CONCRETE		167				348		98.1
113+03.61		RT	CE	CONCRETE		CONCRETE		70				60		44.0
113+98.87		RT	CE	BITUMINOUS		BITUMINOUS		60	21	5				59.0
114+09.54		LT	FE	AGGREGATE		AGGREGATE			41					
114+75.63		RT	CE	BITUMINOUS		BITUMINOUS		33	11	3				33.5
115+01.40		LT	PE	CONCRETE		CONCRETE		77			77			
122+78.63		LT	PE	AGGREGATE	BITUMINOUS	AGGREGATE		26	10	3				
124+23.34		LT	PE	AGGREGATE	BITUMINOUS	AGGREGATE		21	10	3				
COUNTRY AIRE DRIVE														
10+86.82		LT	PE	CONCRETE		CONCRETE		41			41			
DONNA DRIVE														
85+59.07		RT	CE	AGGREGATE		AGGREGATE				144				
90+00.00		RT	FE	NONE		AGGREGATE	98			98				
90+00.00		LT	CE	BITUMINOUS		BITUMINOUS		398	179	44				
92+00.00		LT	CE	NONE		BITUMINOUS		141	63	16				
105+00.00		RT	FE	NONE		AGGREGATE	71			71				
105+00.00		LT	FE	NONE		AGGREGATE	132			132				
118+70.96		RT	CE	AGGREGATE		AGGREGATE				222				
120+97.76		RT	CE	AGGREGATE		AGGREGATE				219				
122+83.61		RT	PE	CONCRETE		CONCRETE		60			60			
SHEET TOTALS							777	2,003	1,556	486	151	282	528	365.1

△ REV. 4-16-14

FILE NAME -	USER NAME - coleen	DESIGNED - KN	REVISED -	STATE OF ILLINOIS DEPARTMENT OF TRANSPORTATION	DRIVEWAY SCHEDULE	F.A.P. RYE 331	SECTION (1-31R-2, N-4, TS-4, HBK-1)	COUNTY WILLIAMSON	TOTAL SHEETS 733	SHEET NO. 63
en:\pwr_work\pwsdot\colem\08363618\097821\1-sch-21.dgn		DRAWN - AS	REVISED -							
	PLOT SCALE - 2:8000 1/8" = 1'	CHECKED -	REVISED -							
	PLOT DATE - 4/18/2014	DATE -	REVISED -							
						SCALE:	SHEET NO. 21 OF 56 SHEETS	STA.	TO STA.	
						ILLINOIS FED. AID PROJECT				

DRIVEWAY SCHEDULE

LOCATION		ENTRANCE TYPE	EXISTING SURFACE TYPE	PROPOSED APRON SURFACE TYPE	PROPOSED SURFACE TYPE	SUBBASE GRANULAR MATERIAL TYPE A		AGGREGATE SURFACE COURSE, TYPE A 6"	BITUMINOUS MATERIALS (PRIME COAT) POUNDS	INCIDENTAL HOT-MIX ASPHALT SURFACING TON	PORTLAND CEMENT CONCRETE DRIVEWAY PAVEMENT, 6 INCH SQ YD	PORTLAND CEMENT CONCRETE DRIVEWAY PAVEMENT, 7 INCH SQ YD	COMBINATION CONCRETE CURB & GUTTER, TYPE B-6.12 FOOT	REMARKS
						4" SQ YD	8" SQ YD							
SARA LANE														
9+13.08		RT	PE	CONCRETE	CONCRETE		37				37			
MAIN STREET NORTH														
3+80.00		RT	CE	AGGREGATE	CONCRETE		97					87	45.0	
7+15.26		RT	PE	AGGREGATE	CONCRETE	AGGREGATE	25	9			25			
7+53.26		LT	PE	AGGREGATE	CONCRETE	AGGREGATE	21	9			21			
7+54.45		RT	PE	CONCRETE	CONCRETE		21				21			
8+70.67		LT	PE	AGGREGATE	CONCRETE		23				23			
8+83.22		RT	PE	AGGREGATE	CONCRETE	AGGREGATE	21	1			21			
9+24.46		RT	PE	CONCRETE	CONCRETE	CONCRETE	32				32			
9+93.03		LT	PE	AGGREGATE	CONCRETE	AGGREGATE	21	2			21			
10+28.00		RT	PE	AGGREGATE	CONCRETE	AGGREGATE	21	8			21			
11+21.23		RT	PE	AGGREGATE	CONCRETE	AGGREGATE	28	2			28			
11+58.11		LT	PE	AGGREGATE	CONCRETE	AGGREGATE	21	34			21			
11+91.19		RT	PE	BITUMINOUS	CONCRETE		36				24			
12+26.69		LT	PE	AGGREGATE	CONCRETE	AGGREGATE	21	14			21			
12+58.51		RT	PE	AGGREGATE	CONCRETE		41				41			
12+69.25		LT	PE	AGGREGATE	CONCRETE	AGGREGATE	29	16			29			
14+08.40		RT	PE	AGGREGATE	CONCRETE	AGGREGATE	37	16			37			
BRIGGS ROAD														
7+62.64		LT	PE	AGGREGATE	BITUMINOUS	AGGREGATE	27	37	16	4				
11+99.24		RT	FE	DIRT		AGGREGATE		63						
SAMUEL ROAD														
9+54.91		RT	PE	AGGREGATE		AGGREGATE		56						
DONNA DRIVE/CLARK STREET														
124+00		LT	PE	DIRT		AGGREGATE	100	100						
SHEET TOTALS						0	658	368	16	4	422	87	45.0	
TOTALS FROM DWY SCH-21						777	2,003	1,556	486	151	282	528	365.1	
PROJECT TOTALS						777	2,662	1,924	503	155	705	615	411.0	

NOTES:

1. FOR ADDITIONAL QUANTITY FOR SUBBASE GRANULAR MATERIAL, TYPE A 8" SEE DRAWING NO. SCH-03.
2. FOR ADDITIONAL QUANTITY FOR BITUMINOUS MATERIALS (PRIME COAT) SEE DRAWING NO. SCH-03.
3. FOR ADDITIONAL QUANTITY FOR AGGREGATE (PRIME COAT) SEE DRAWING NO. SCH-03.

△ REV. 4-16-14

FILE NAME =	USER NAME =	DESIGNED - KN	REVISED -	STATE OF ILLINOIS DEPARTMENT OF TRANSPORTATION	DRIVEWAY SCHEDULE	F.A.P. RTE.	SECTION	COUNTY	TOTAL SHEETS	SHEET NO.
\\psu-work\psu\dot\col\m\093636\B\09782	1-est-SCH-22.dgn	DRAWN - AS	REVISED -			33	11-31R-2, N-4, TS-4, HBR-1	WILLIAMSON	733	64
	PLOT SCALE = 2.8888' / 1"	CHECKED -	REVISED -				DRAWING NO. SCH-22			CONTRACT NO. 78221
	PLOT DATE = 4/10/2014	DATE -	REVISED -							(ILLINOIS) FED. AID PROJECT
				SCALE:	SHEET NO. 22 OF 56 SHEETS	STA.	TO STA.			

FINAL	DATE
CHECKED	
DESIGNED	
PLANNED	
NOTED	
REVISIONS	
NO.	

DATE	
BY	
DESIGNED	
PLANNED	
NOTED	
REVISIONS	
NO.	

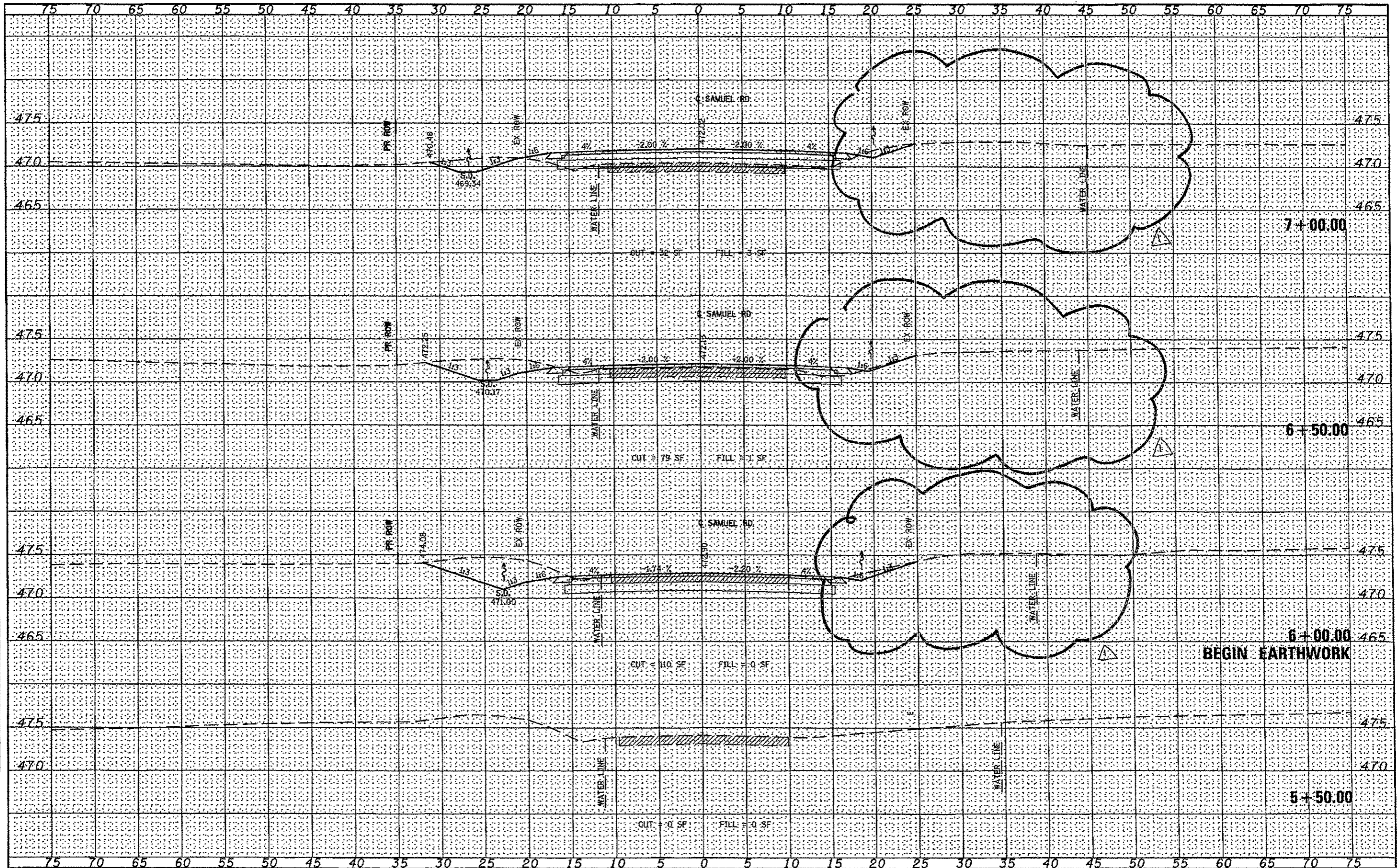

FILE NAME =	USER NAME = colem	DESIGNED - KN	REVISED -	STATE OF ILLINOIS DEPARTMENT OF TRANSPORTATION	PROPOSED CROSS SECTIONS SAMUEL RD NORTH	SCALE: SHEET NO. 1 OF 6 SHEETS STA. 5+50.00 TO STA. 7+00.00	F.A.P. RTE. SECTION COUNTY TOTAL SHEETS SHEET NO. 331 11-31R-2, N-4, TS-4, HBK-1 WILLIAMSON 733 699 DRAWING NO. XS-299 78221 [ILLINOIS] FED. AID PROJECT
		DRAWN - AS	REVISED -				
		CHECKED -	REVISED -				
		DATE -	REVISED -				

△ REV. 4-16-14