

LEGEND	
(A)	EXISTING HMA PAVEMENT
(B)	PAVED SHOULDER REMOVAL
(1)	HOT-MIX ASPHALT SURFACE COURSE, MIX C, N90, 1 1/2"
(2)	HOT-MIX ASPHALT BINDER COURSE, IL-19.0, N90, 2 1/2"
(3)	HOT-MIX ASPHALT SHOULDERS, 4"
(4)	AGGREGATE BASE COURSE, TYPE A 8"
(5)	HOT-MIX ASPHALT SHOULDERS, 15 1/4"
(6)	PIPE UNDERDRAINS, 4"
(7)	PROCESSING LIME STABILIZED SOIL MIXTURE 12"
(8)	COMBINATION CONCRETE CURB AND GUTTER, TYPE B-6.24
(9)	PORTLAND CEMENT CONCRETE SIDEWALK 6 INCH
(10)	SUBBASE GRANULAR MATERIAL, TYPE C
(11)	AGGREGATE SHOULDERS, TYPE A 8"
(12)	HOT-MIX ASPHALT SURFACE COURSE, MIX D, N90, 2 1/2"
(13)	PORTLAND CEMENT CONCRETE SIDEWALK 4 INCH
(14)	CONCRETE GUTTER, TYPE A
(15)	HOT-MIX ASPHALT SHOULDERS, 8"
(16)	CONCRETE MEDIAN SURFACE, 4 INCH
(17)	PAVED DITCH, TYPE A-15
(18)	NOT USED
(19)	STEEL PLATE BEAM GUARDRAIL, TYPE A, 6 FOOT POSTS
(20)	HOT-MIX ASPHALT PAVEMENT (FULL DEPTH), 15 1/4"
(21)	SUBBASE GRANULAR MATERIAL, TYPE A 8"
(22)	HOT-MIX ASPHALT PAVEMENT (FULL DEPTH), 10 3/4"
(23)	AGGREGATE SHOULDERS, TYPE B
(24)	CONCRETE MEDIAN, TYPE SB-6.24
(25)	SUBBASE GRANULAR MATERIAL, TYPE A 12"
(26)	COMBINATION CONCRETE CURB AND GUTTER, TYPE M-6.24
(27)	CONCRETE MEDIAN, TYPE SB-6.06
(28)	HOT-MIX ASPHALT REMOVAL, 2"
(29)	HOT-MIX ASPHALT SURFACE COURSE, MIX E, N90, 2"

CURBED SECTION

STA 104+95.83 TO STA 105+95.00
STA 115+15.00 TO STA 116+89.20

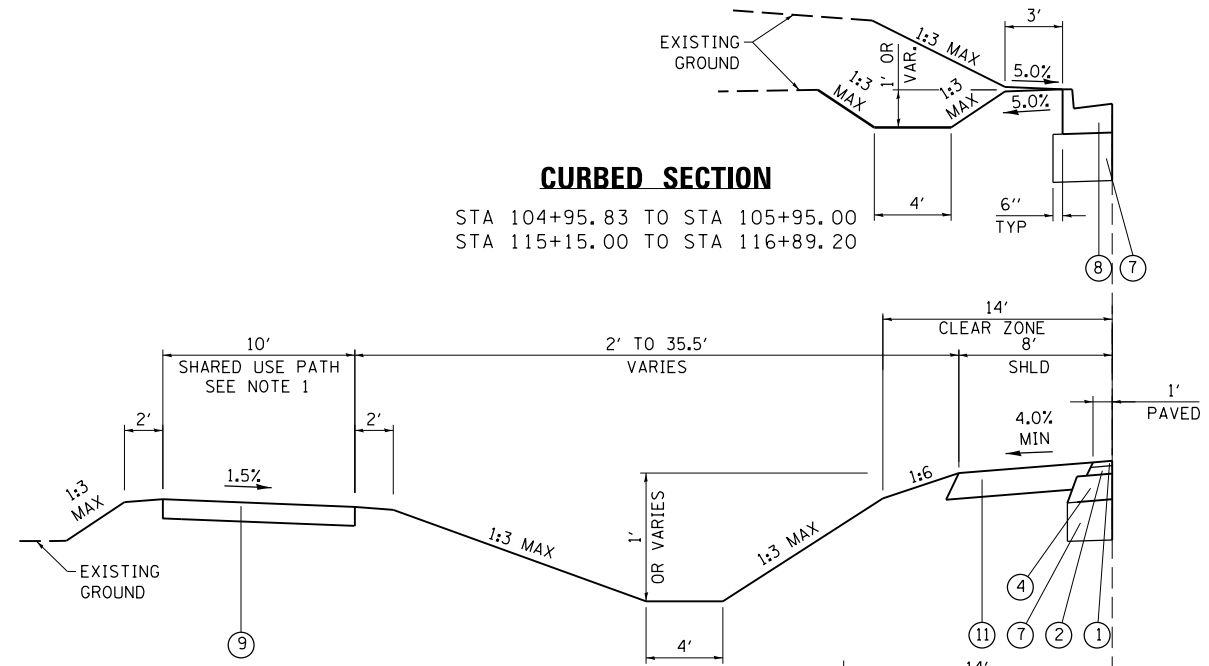

OPEN SHOULDER SECTION WITH SHARED USE PATH

STA 68+87.81 TO STA 69+59.77
STA 74+40.74 TO STA 75+15.00
STA 85+45.00 TO STA 97+02.92

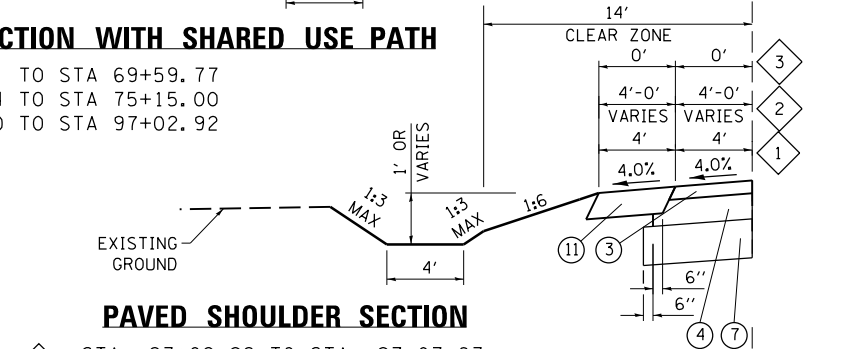

PAVED SHOULDER SECTION

- 1 STA 97+02.92 TO STA 97+07.87
STA 122+11.66 TO STA 127+68.32
- 2 STA 127+68.32 TO STA 127+85.00
- 3 STA 127+85.00 TO STA 128+21.17

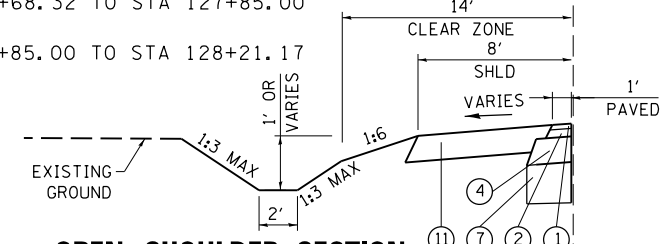

OPEN SHOULDER SECTION

STA 97+07.87 TO STA 97+95.00
STA 101+80.00 TO STA 104+95.83

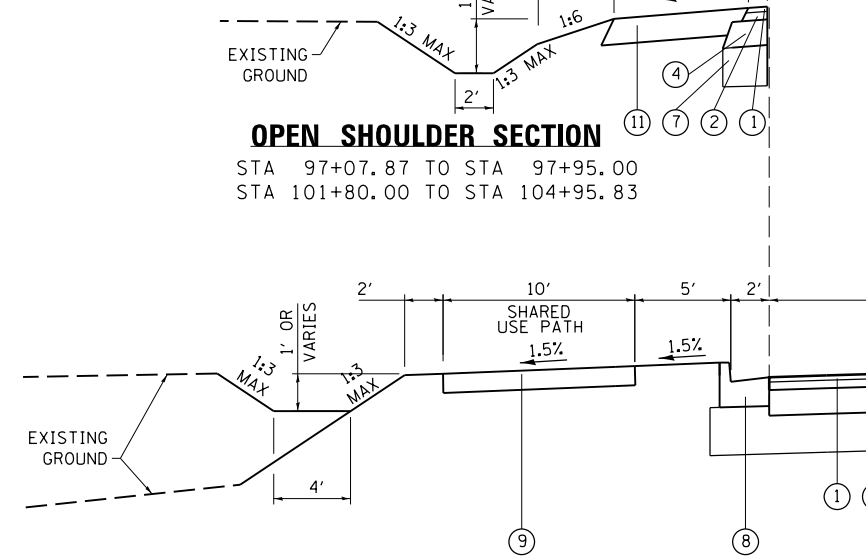

CURBED SECTION WITH SHARED USE PATH

STA 62+90.00 TO STA 68+87.81

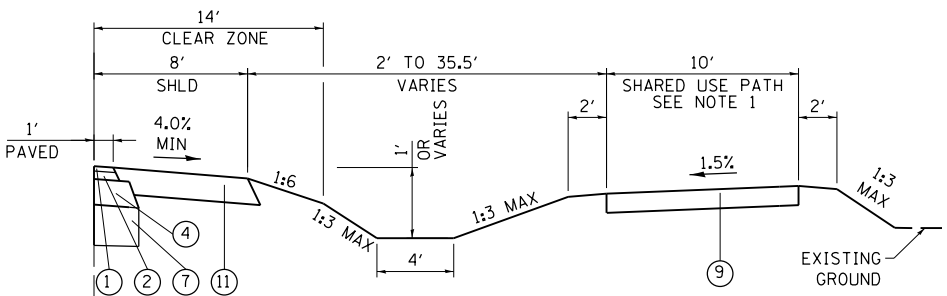

OPEN SHOULDER SECTION WITH SHARED USE PATH

STA 96+66.30 TO STA 97+95.00
STA 101+80.00 TO STA 104+95.83

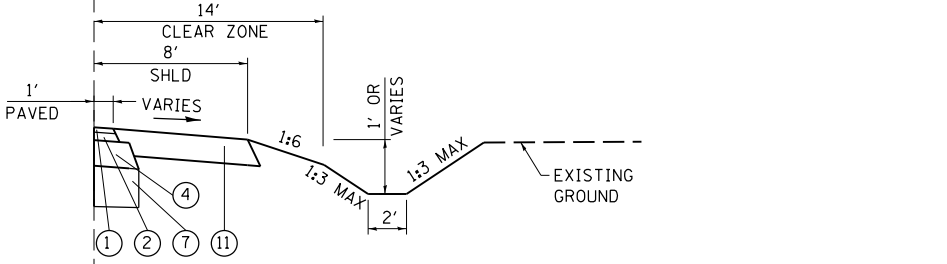

OPEN SHOULDER SECTION

STA 27+68.28 TO STA 28+01.14
STA 62+90.00 TO STA 69+59.77
STA 74+40.74 TO STA 75+15.00
STA 85+45.00 TO STA 96+66.30

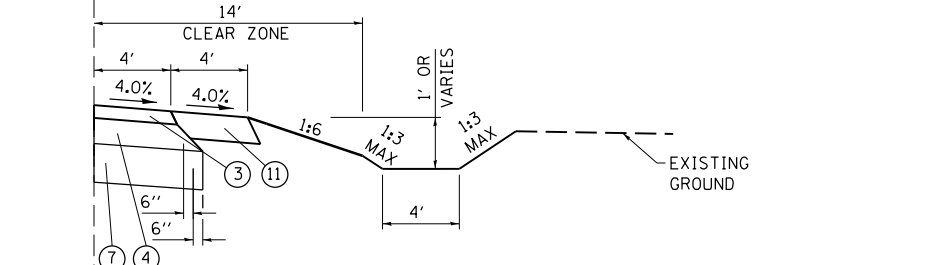

PAVED SHOULDER SECTION

STA 122+11.66 TO STA 124+66.73

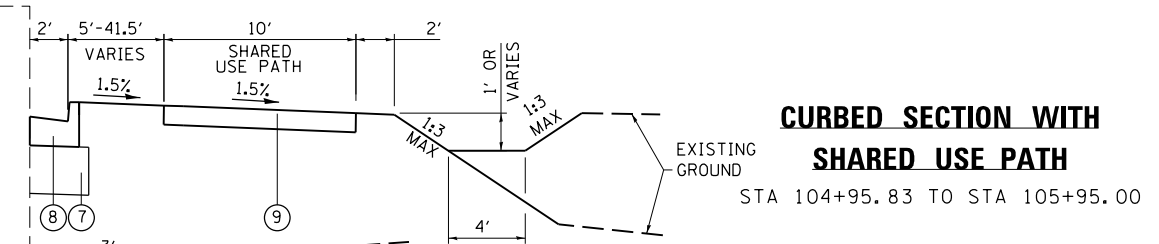

CURBED SECTION WITH SHARED USE PATH

STA 104+95.83 TO STA 105+95.00

**NORTH FRONTAGE ROAD
NORMAL CROWN**

STA 22+55.43 TO STA 28+01.14
STA 62+90.00 TO STA 69+59.77
STA 74+40.70 TO STA 75+15.00
STA 85+45.00 TO STA 97+95.00
STA 101+80.00 TO STA 105+95.00
STA 115+15.00 TO STA 116+89.20
STA 122+11.66 TO STA 128+21.17

CURBED SECTION

STA 22+55.43 TO STA 27+68.28
STA 115+15.00 TO STA 116+89.20
STA 124+66.73 TO STA 128+21.17

NOTES:

- INDEPENDENT SHARED USE PATH ALIGNMENT AND PROFILE NORTH FRONTAGE RD STA 69+12.88 TO STA 106+11.79.
- FOR SPECIAL DITCH PROFILES, SEE ROADWAY, DRAINAGE AND UTILITY PLANS.
- FOR CROSS SLOPE TRANSITION TO MATCH EXISTING, SEE INTERSECTION DETAILS.

FILE NAME =	USER NAME = \$USER\$	DESIGNED - CK	REVISED -	STATE OF ILLINOIS DEPARTMENT OF TRANSPORTATION	PROPOSED TYPICAL SECTIONS NORTH FRONTAGE ROAD	F.A.P. RTE.	SECTION	COUNTY	TOTAL SHEETS	SHEET NO.
et:\pw\work\p\dot\lavenderba\d0363618\078221-sht-typical-10.dgn		DRAWN - AS	REVISED -			331	(1-3)R-2, N-4, TS-4, HBK-1	WILLIAMSON	733	32
PLOT SCALE = 10.0000' / in.		CHECKED -	REVISED -			DRAWING NO.	TS-10	CONTRACT NO.	78221	
PLOT DATE = 1/31/2014		DATE -	REVISED -			SCALE: NA	SHEET NO. 10 OF 20 SHEETS	STA.	TO STA.	ILLINOIS FED. AID PROJECT