

| | | |
|------|----------|------|
| PLAN | SURVEYED | DATE |
| | PLOTTED | BY |
| | ALIGNED | |
| | CHECKED | |
| | FILED | |
| | NO. | |

| | | |
|---------|-----------|------|
| PROFILE | SURVEYED | DATE |
| | PLOTTED | BY |
| | GRADES | |
| | CHECKED | |
| | STRUCTURE | |
| | NOTATIONS | |
| | CHP | |
| | NO. | |

NOTES:

1. FOR ADDITIONAL REMOVAL ITEMS, SEE PAVEMENT MARKING AND SIGNING DRAWINGS AND SCHEDULE DRAWINGS.
2. FOR ADDITIONAL BRIDGE, LIGHTING AND INTERSECTION GRADING, SEE GENERAL BRIDGE PLANS, LIGHTING DETAILS AND INTERSECTION DETAILS.
3. EASTBOUND LANE CALLOUTS USE WESTBOUND LANE ALIGNMENT FOR STATION/OFFSET.
4. FOR CLARITY, ONLY VARIABLE DEPTH DITCHES ARE SHOWN ON THE PROFILE. REFER TO THE TYPICAL SECTIONS AND CROSS SECTIONS FOR DEPENDENT DITCH INFORMATION.
5. FOR ADDITIONAL GRADING DETAILS, SEE INTERCHANGE GRADING PLANS.

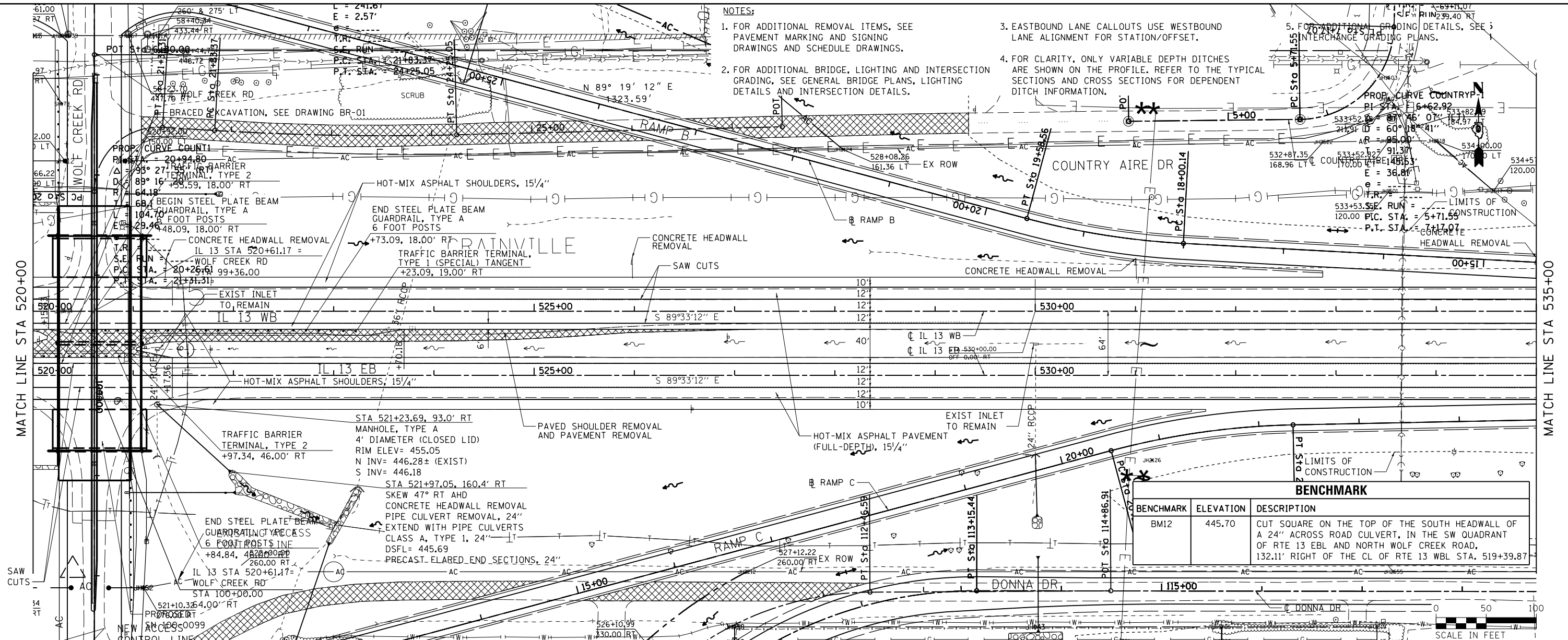

| BENCHMARK | | |
|-----------|-----------|--|
| BENCHMARK | ELEVATION | DESCRIPTION |
| BM12 | 445.70 | CUT SQUARE ON THE TOP OF THE SOUTH HEADWALL OF A 24" ACROSS ROAD CULVERT, IN THE SW QUADRANT OF RTE 13 EBL AND NORTH WOLF CREEK ROAD, 132.11' RIGHT OF THE CL OF RTE 13 WBL STA. 519+39.87 |

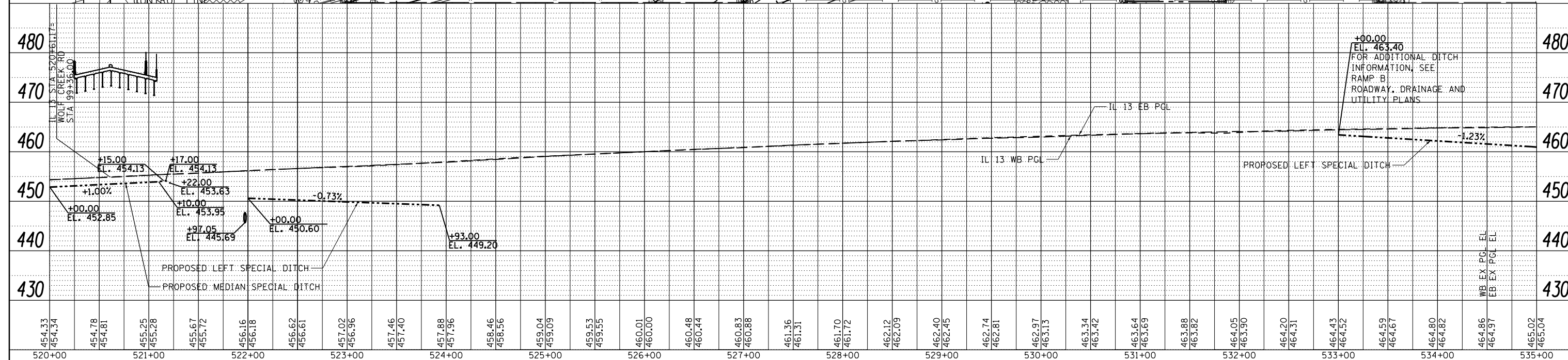

| | | | | | | | |
|--|-------------|------------|-----------|---|---|-----------------------------------|---------------------------|
| FILE NAME = | USER NAME = | DESIGNED - | REVISED - | STATE OF ILLINOIS DEPARTMENT OF TRANSPORTATION | ROADWAY, DRAINAGE AND UTILITY PLAN AND PROFILE IL 13 | SECTION COUNTY TOTAL SHEETS | SHEET NO. CONTRACT NO. |
| c:\pwork\pwork\lavenderba\d8363618\0978221-sht-plnprf-04.dgn | KS | KN | - | | | | |
| PLOT SCALE = 100.0000' / in. | AS | AS | - | | | | |
| PLOT DATE = 1/31/2014 | - | - | - | | | | |

| | | | |
|--------|--------------------------|----------------------------------|---------------------------|
| SCALE: | SHEET NO. 4 OF 69 SHEETS | STA. 520+00.00 TO STA. 535+00.00 | ILLINOIS FED. AID PROJECT |
|--------|--------------------------|----------------------------------|---------------------------|