

DATE	
BY	
REVISIONS	
ALIGNED	CHECKED
PLANNED	CHECKED
NOTE BOOK	
NO.	
CADD FILE NAME	

DATE	
BY	
REVISIONS	
GRADES	CHECKED
STRUCTURE	NOTATION
NO.	

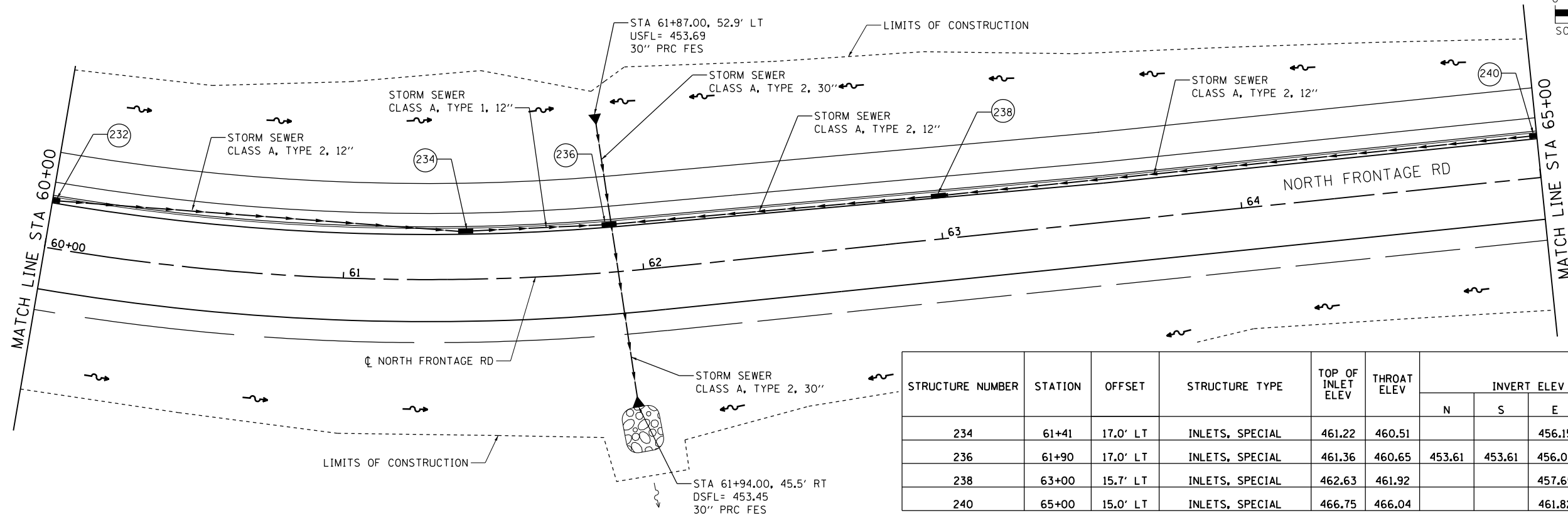

STRUCTURE NUMBER	STATION	OFFSET	STRUCTURE TYPE	TOP OF INLET ELEV	THROAT ELEV	INVERT ELEV				REMARKS
						N	S	E	W	
234	61+41	17.0' LT	INLETS, SPECIAL	461.22	460.51			456.15	456.25	
236	61+90	17.0' LT	INLETS, SPECIAL	461.36	460.65	453.61	453.61	456.09	455.59	
238	63+00	15.7' LT	INLETS, SPECIAL	462.63	461.92			457.65	457.54	
240	65+00	15.0' LT	INLETS, SPECIAL	466.75	466.04			461.82	461.72	

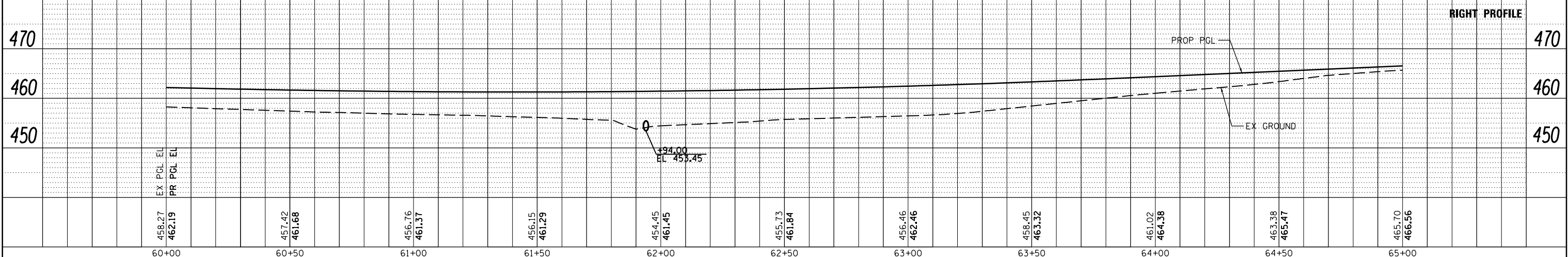
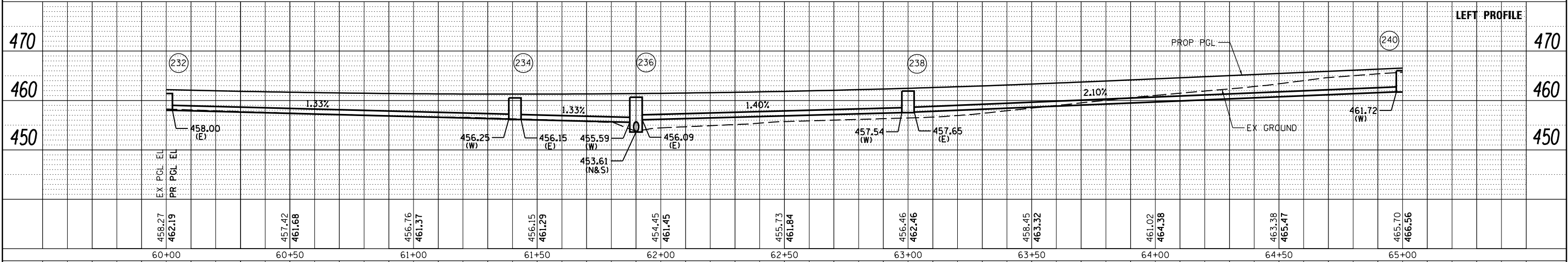

FILE NAME =	USER NAME = *USER*	DESIGNED - KN	REVISIONS -	STATE OF ILLINOIS DEPARTMENT OF TRANSPORTATION	STORM SEWER DETAIL SHEET NORTH FRONTAGE ROAD	F.A.P. RTE.	SECTION	COUNTY	TOTAL SHEETS	SHEET NO.
cd:\pwork\pwork\lavenderba\d0363618\0978221-sht-drain-06.dgn		CHECKED - AS	REVISIONS -			331	(1-3)R-2, N-4, TS-4, HBK-1	WILLIAMSON	733	249
PLOT SCALE = 48.0796' / in.		DRAWN -	REVISIONS -			DRAWING NO. DU-09		CONTRACT NO. 78221		
PLOT DATE = 1/31/2014		CHECKED -	REVISIONS -			SCALE:	SHEET NO. 9 OF 20 SHEETS	STA. 60+00.00 TO STA. 65+00.00	ILLINOIS FED. AID PROJECT	