

LEGEND

① - THERMOPLASTIC PAVEMENT MARKING - LETTERS AND SYMBOLS	⑤ - PREFORMED PLASTIC PAVEMENT MARKING, TYPE B - LETTERS AND SYMBOLS
② - THERMOPLASTIC PAVEMENT MARKING - LINE 4"	⑥ - PREFORMED PLASTIC PAVEMENT MARKING, TYPE B - LINE 4"
③ - THERMOPLASTIC PAVEMENT MARKING - LINE 12"	⑦ - PREFORMED PLASTIC PAVEMENT MARKING, TYPE B - LINE 8"
④ - THERMOPLASTIC PAVEMENT MARKING - LINE 24"	⑧ - PREFORMED PLASTIC PAVEMENT MARKING, TYPE B - LINE 12"
Ⓐ - DENOTES STANDARD SIGN PANELS (SEE NOTE 1)	⑨ - PREFORMED PLASTIC PAVEMENT MARKING, TYPE B - LINE 24"
Ⓝ - DENOTES NON-STANDARD SIGN PANELS (SEE NOTE 1)	Ⓜ - RAISED REFLECTIVE PAVEMENT MARKERS
Ⓟ - EXISTING SIGN TO BE REMOVED	■ - PROPOSED SIGNS

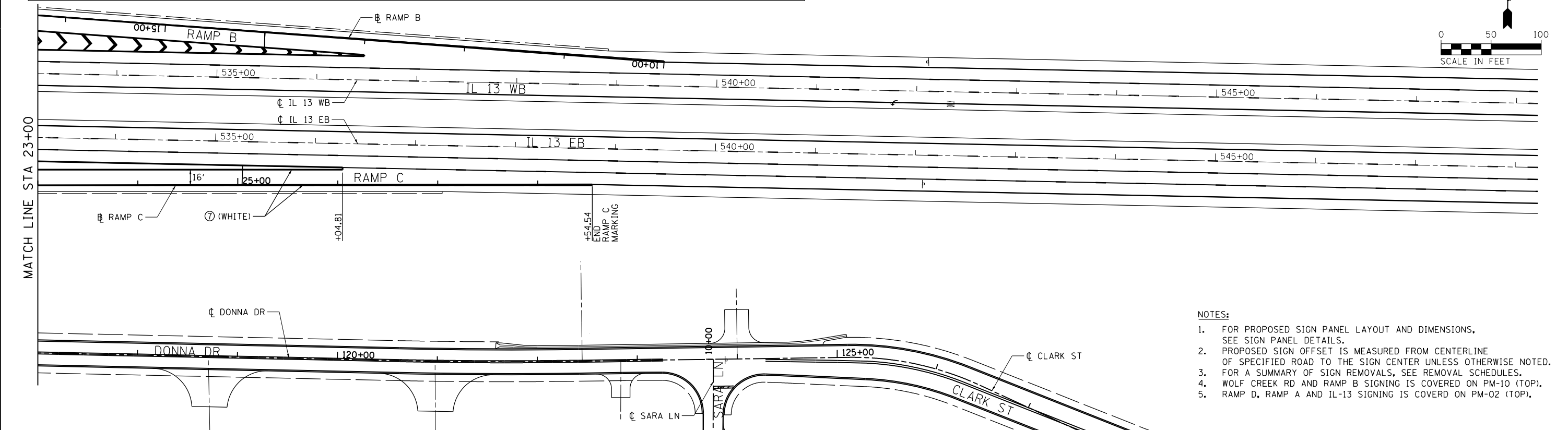
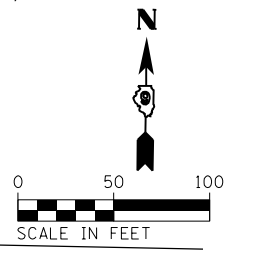

- NOTES:**
- FOR PROPOSED SIGN PANEL LAYOUT AND DIMENSIONS, SEE SIGN PANEL DETAILS.
 - PROPOSED SIGN OFFSET IS MEASURED FROM CENTERLINE OF SPECIFIED ROAD TO THE SIGN CENTER UNLESS OTHERWISE NOTED.
 - FOR A SUMMARY OF SIGN REMOVALS, SEE REMOVAL SCHEDULES.
 - WOLF CREEK RD AND RAMP B SIGNING IS COVERED ON PM-10 (TOP).
 - RAMP D, RAMP A AND IL-13 SIGNING IS COVERED ON PM-02 (TOP).

FILE NAME =	USER NAME = #USER#	DESIGNED - KN	REVISED -	STATE OF ILLINOIS DEPARTMENT OF TRANSPORTATION	PAVEMENT MARKING AND SIGNING PLANS RAMP C	F.A.P. RTE.	SECTION	COUNTY	TOTAL SHEETS	SHEET NO.
c:\pwwork\pwwork\lavenderba\0363618\078221-sht-pmk-07.dgn		DRAWN - AS	REVISED -			331	(1-3)R-2, N-4, TS-4, HBK-1	WILLIAMSON	733	318
PLOT SCALE = 1/32" = 1/32" / in.		CHECKED -	REVISED -			DRAWING NO.	PM-07	CONTRACT NO.	78221	
PLOT DATE = 1/31/2014		DATE -	REVISED -			SCALE:	SHEET NO. 7 OF 28 SHEETS	STA. 10+00 TO STA. 28+54.54	ILLINOIS FED. AID PROJECT	