

LEGEND	
① - THERMOPLASTIC PAVEMENT MARKING - LETTERS AND SYMBOLS	⑤ - PREFORMED PLASTIC PAVEMENT MARKING, TYPE B - LETTERS AND SYMBOLS
② - THERMOPLASTIC PAVEMENT MARKING - LINE 4"	⑥ - PREFORMED PLASTIC PAVEMENT MARKING, TYPE B - LINE 4"
③ - THERMOPLASTIC PAVEMENT MARKING - LINE 12"	⑦ - PREFORMED PLASTIC PAVEMENT MARKING, TYPE B - LINE 8"
④ - THERMOPLASTIC PAVEMENT MARKING - LINE 24"	⑧ - PREFORMED PLASTIC PAVEMENT MARKING, TYPE B - LINE 12"
Ⓐ - DENOTES STANDARD SIGN PANELS (SEE NOTE 1)	⑨ - PREFORMED PLASTIC PAVEMENT MARKING, TYPE B - LINE 24"
Ⓝ-1 - DENOTES NON-STANDARD SIGN PANELS (SEE NOTE 1)	Ⓞ - RAISED REFLECTIVE PAVEMENT MARKERS
□ - EXISTING SIGN TO BE REMOVED	● - PROPOSED SIGNS

- NOTES:**
- FOR PROPOSED SIGN PANEL LAYOUT AND DIMENSIONS, SEE SIGN PANEL DETAILS.
 - PROPOSED SIGN OFFSET IS MEASURED FROM CENTERLINE OF SPECIFIED ROAD TO THE SIGN CENTER UNLESS OTHERWISE NOTED.
 - FOR A SUMMARY OF SIGN REMOVALS, SEE REMOVAL SCHEDULES.
 - SIGNING FOR DONNA DR COVERED ON PM-22 (TOP).

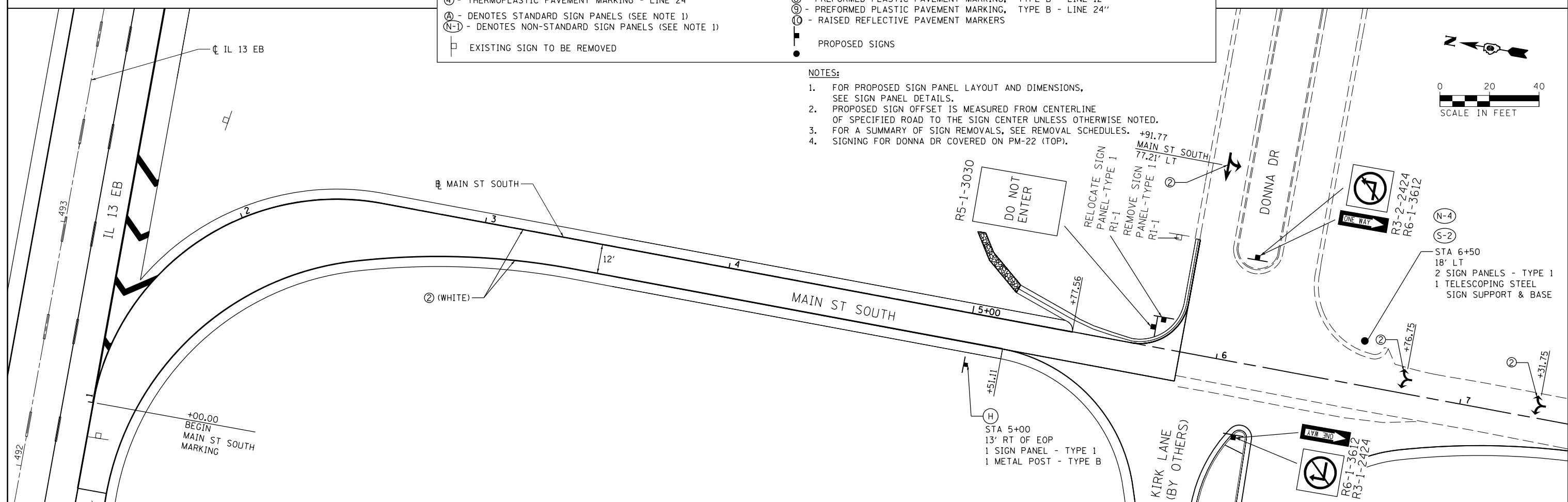
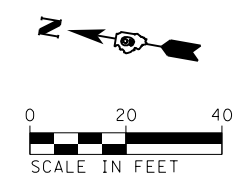

FILE NAME =	USER NAME = sUSER*	DESIGNED - KN	REVISED -
ei:\pwork\pwork\lavenderba\d0363618\078221-sht\pmk-23.dgn		DRAWN - AS	REVISED -
	PLOT SCALE = 40.0000' / in.	CHECKED -	REVISED -
	PLOT DATE = 1/31/2014	DATE -	REVISED -

**STATE OF ILLINOIS
DEPARTMENT OF TRANSPORTATION**

**PAVEMENT MARKING AND SIGNING PLANS
SARA LN / MAIN STREET SOUTH**

SCALE: SHEET NO. 23 OF 28 SHEETS STA. 1+00 TO STA. 7+31.75

F.A.P. RTE.	SECTION	COUNTY	TOTAL SHEETS	SHEET NO.
331	(1-3)R-2, N-4, TS-4, HBK-1	WILLIAMSON	733	334
DRAWING NO.	PM-23	CONTRACT NO.	78221	
ILLINOIS FED. AID PROJECT				