

Notes:  
 See sheet 12 of 27 for Detail A and View B-B.  
 Approach slab and parapet concrete shall be paid for as Concrete Superstructure.  
 Approach footing concrete shall be paid for as Concrete Structures.  
 Reinforcement shall be paid for as Reinforcement Bars, Epoxy Coated.  
 For v(E) bar details, see sheet 10 of 27.  
 The approach footing maximum applied service bearing pressure (Qmax) = 2.0 ksf.  
 Cost of excavation for approach footing included with Concrete Structures.  
 For Granular Backfill For Structures and drainage treatment details, see sheet 2 of 27.  
 For additional parapet details, see sheet 10 of 27.

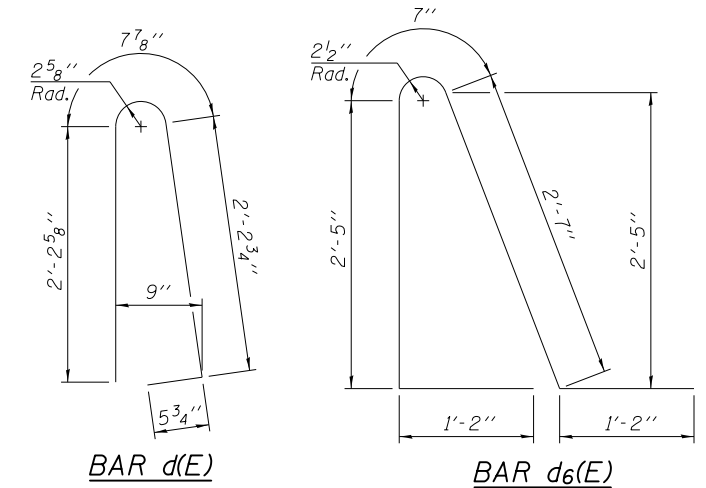
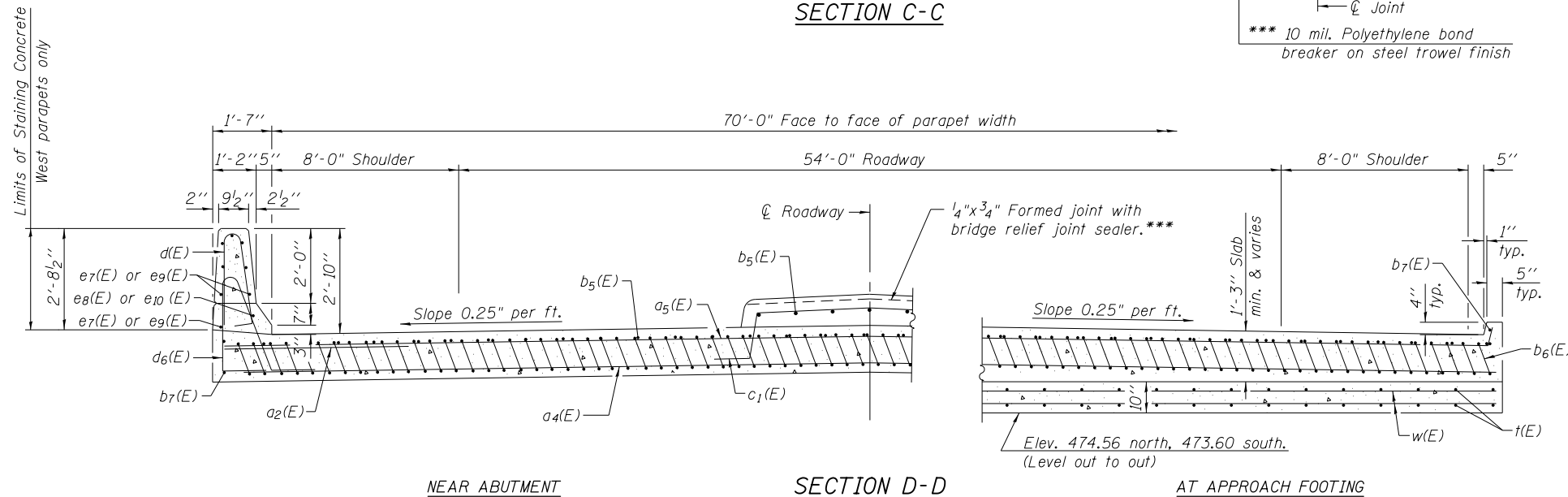

\* Tilt #9 b6(E) bars as required to maintain clearance.  
 \*\*\* Cost included with Concrete Superstructure.

**TWO APPROACHES  
 BILL OF MATERIAL**

Bar	No.	Size	Length	Shape
a2(E)	60	#6	6'-6"	—
a4(E)	184	#5	38'-1"	—
a5(E)	150	#4	25'-10"	—
b5(E)	132	#4	29'-8"	—
b6(E)	346	#9	29'-9"	—
b7(E)	6	#4	14'-8"	—
c1(E)	62	#5	10'-4"	—
d(E)	85	#5	5'-7"	—
d6(E)	85	#5	7'-11"	—
e7(E)	38	#4	14'-8"	—
e8(E)	3	#8	14'-8"	—
e9(E)	1	#4	29'-8"	—
e10(E)	1	#8	29'-8"	—
t(E)	292	#4	9'-8"	—
w(E)	160	#5	37'-5"	—
Concrete Superstructure		Cu. Yd.	228.3	
Concrete Structures		Cu. Yd.	44.3	
Bridge Deck Grooving		Sq. Yd.	400	
Protective Coat		Sq. Yd.	504.7	
Reinforcement Bars, Epoxy Coated		Pound	58,740	
Staining Concrete Structures		Sq. Ft.	81	

