

TYPE A GUTTER OUTLET

NOT TO SCALE

NOTES:

- FOR CURB OUTLET REINFORCEMENT BAR INFORMATION, SEE STANDARD 606001 AND STANDARD 606006.
- CURB OUTLET TO BE PAID FOR AS CLASS S1 CONCRETE (OUTLET) FOR ENTIRE LIMITS AS SHOWN IN DETAIL.

LOCATION	A	B	C
WOLF CREEK RD STA 116+67 RT	+64.32 11.2' RT	+70.70 17.5' RT	+70.17 11.1' RT
NORTH FRONTAGE RD STA 128+17 RT	+14.45 13.1' RT	+19.94 17.4' RT	+20.36 12.7' RT

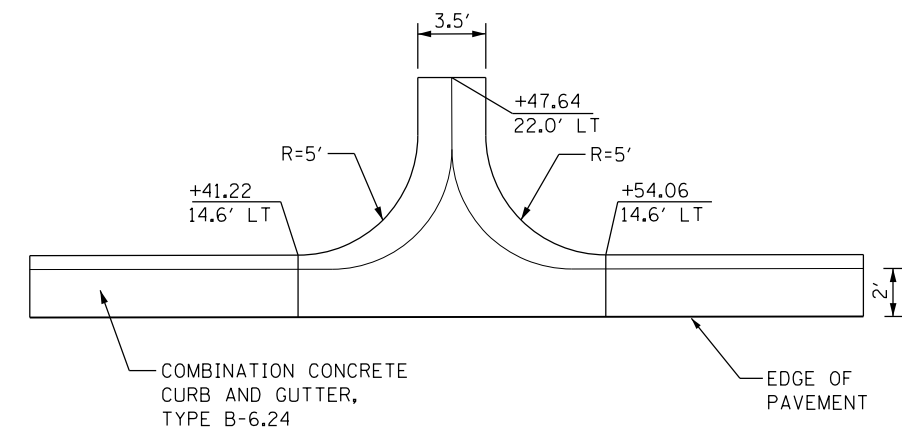

NORTH FRONTAGE RD CURB OUTLET

STA 106+47 LT
NOT TO SCALE

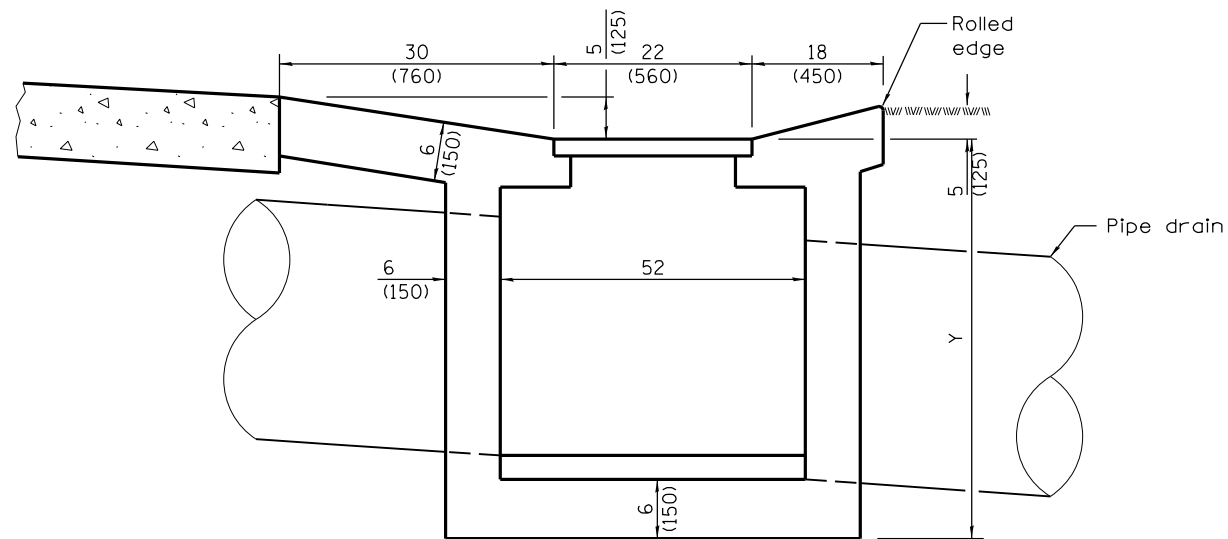

SECTION D-D

Y = 50

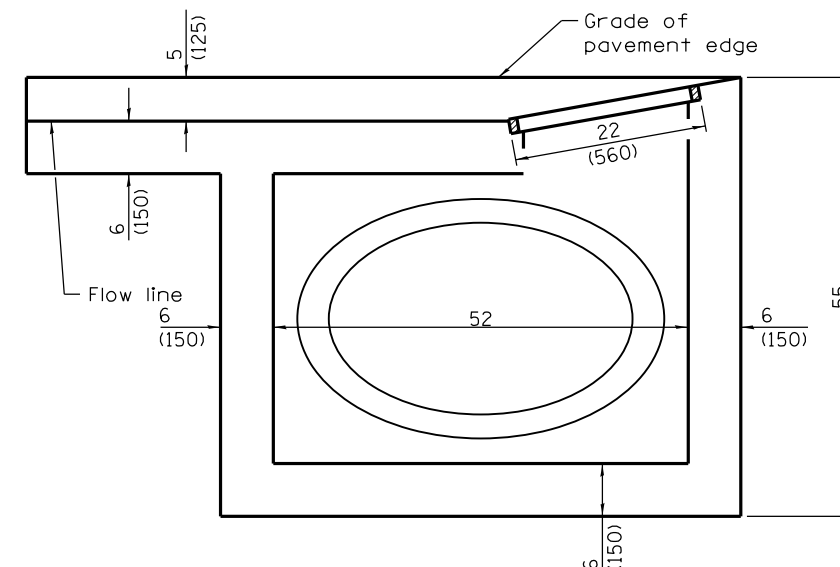

SECTION F-F

Notes:

- See Highway Standard 606106-04 for more details

FILE NAME =	USER NAME = \$USER\$	DESIGNED - KN	REVISED -	STATE OF ILLINOIS DEPARTMENT OF TRANSPORTATION	ROADWAY DETAILS MISCELLANEOUS	F.A.P. RTE.	SECTION	COUNTY	TOTAL SHEETS	SHEET NO.
c:\pwork\pwork\lavenderba\d0363618\0978221-sht-details-rd-02.dgn		DRAWN - AS	REVISED -			331	(1-3)R-2, N-4, TS-4, HKB-1	WILLIAMSON	712	388
PLOT SCALE = 2,0036 1/16"		CHECKED -	REVISED -			DRAWING NO.	RD-02	CONTRACT NO.	78221	
PLOT DATE = 1/31/2014		DATE -	REVISED -			SCALE:	SHEET NO. 2 OF 6 SHEETS	STA.	TO STA.	ILLINOIS FED. AID PROJECT