

DATE	
BY	
FINAL SURVEY	
PLOTTED	
NOTE BOOK	
NO.	

DATE	
BY	
ORIGINAL SURVEY	
PLOTTED	
NOTE BOOK	
NO.	

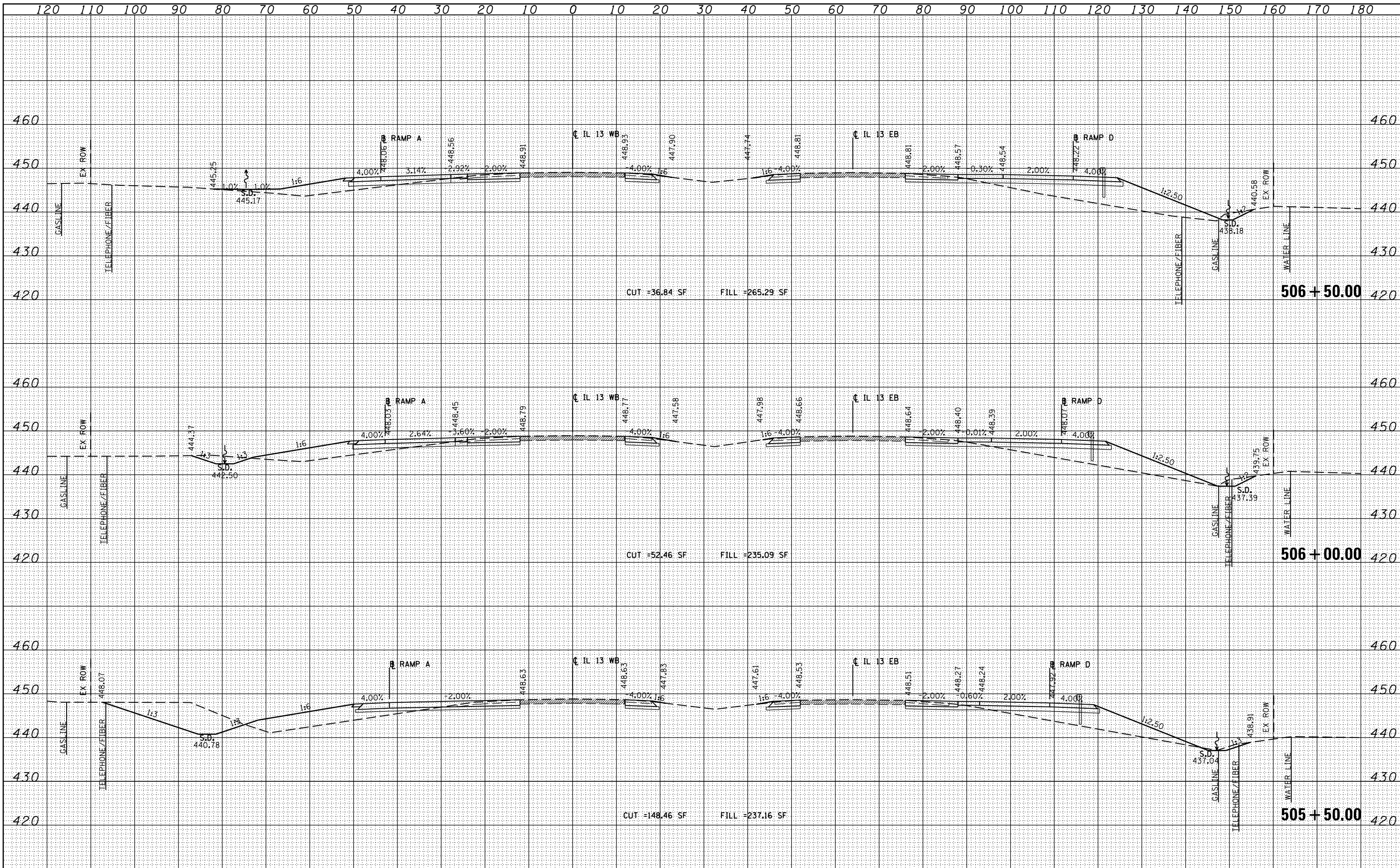

FILE NAME =
 ct:\pw_work\p\wdot\lavenderba\d0363618\0978221-ht-xssht-IL13.dgn

USER NAME = *USER*
 USER*
 PLOT SCALE = 20.0000' / in.
 PLOT DATE = 1/31/2014

DESIGNED - KN
 DRAWN - AS
 CHECKED -
 DATE -

REVISED -
 REVISED -
 REVISED -
 REVISED -

STATE OF ILLINOIS
 DEPARTMENT OF TRANSPORTATION

PROPOSED CROSS SECTIONS
 ILLINOIS ROUTE 13

SCALE: SHEET NO. 20 OF 84 SHEETS STA. 505+50.00 TO STA. 506+50.00

F.A.P. RTE.	SECTION	COUNTY	TOTAL SHEETS	SHEET NO.
331	(1-3)R-2, N-4, TS-4, HBK-1	WILLIAMSON	733	420
DRAWING NO. XS-020			78221	
ILLINOIS FED. AID PROJECT				