

BY	DATE
FILED	SURVEYED
NO.	PLOTTED
	TEMPLATE
	NOTE BOOK
	AREAS CHECKED

BY	DATE
ORIGINAL	SURVEYED
NO.	PLOTTED
	TEMPLATE
	NOTE BOOK
	AREAS CHECKED

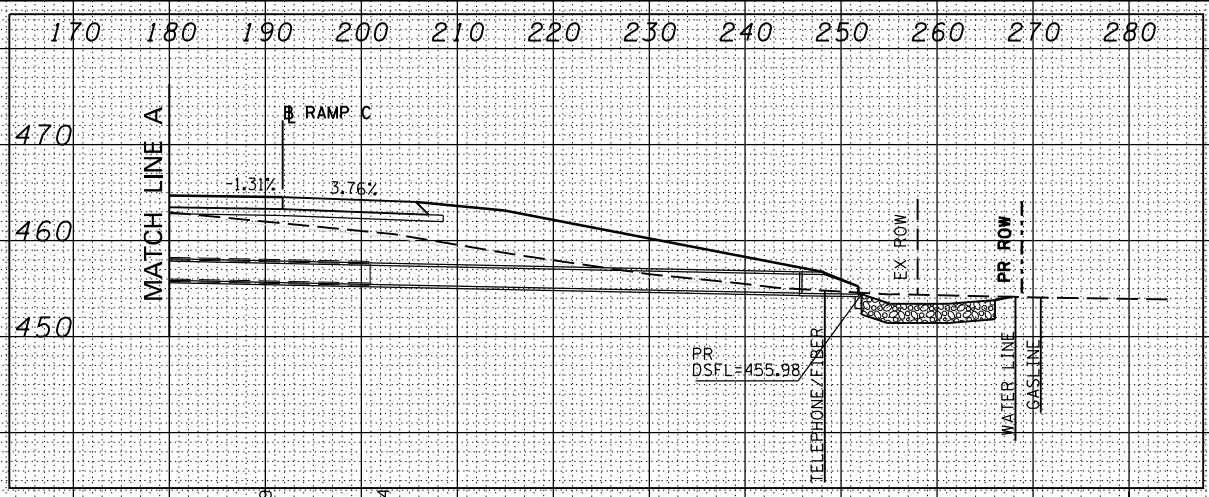
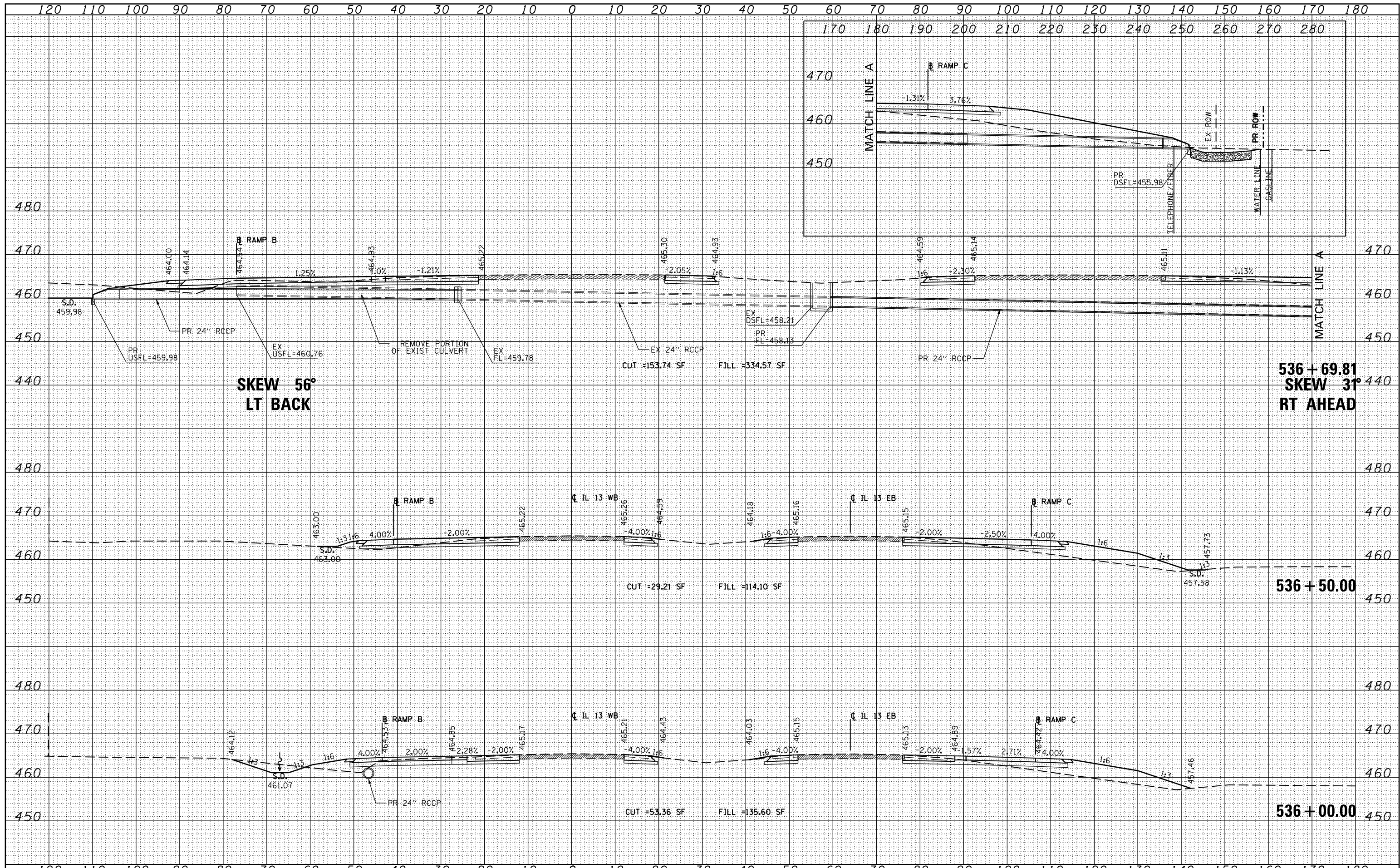

FILE NAME =	USER NAME = #USER#	DESIGNED - KN	REVISED -	<b>STATE OF ILLINOIS</b> <b>DEPARTMENT OF TRANSPORTATION</b>	<b>PROPOSED CROSS SECTIONS</b> <b>ILLINOIS ROUTE 13</b>		F.A.P. RTE.	SECTION	COUNTY	TOTAL SHEETS	SHEET NO.
c:\pwwork\pwwork\lavender\ba\d0363618\0978221-ht-xssht-IL13.dgn		DRAWN - AS	REVISED -		331	(1-3)R-2, N-4, TS-4, HBK-1	WILLIAMSON	733	442		
		CHECKED -	REVISED -		DRAWING NO.	XS-042					
		DATE -	REVISED -		SCALE:	SHEET NO. 42 OF 84 SHEETS	STA. 536+00.00 TO STA. 536+69.81	ILLINOIS FED. AID PROJECT			