

DATE	
BY	
FINAL SURVEY	SURVEYED
NOTE BOOK	PLOTTED
NO.	TEMPLATE
	AREAS CHECKED

DATE	
BY	
ORIGINAL SURVEY	SURVEYED
NOTE BOOK	PLOTTED
NO.	TEMPLATE
	AREAS CHECKED

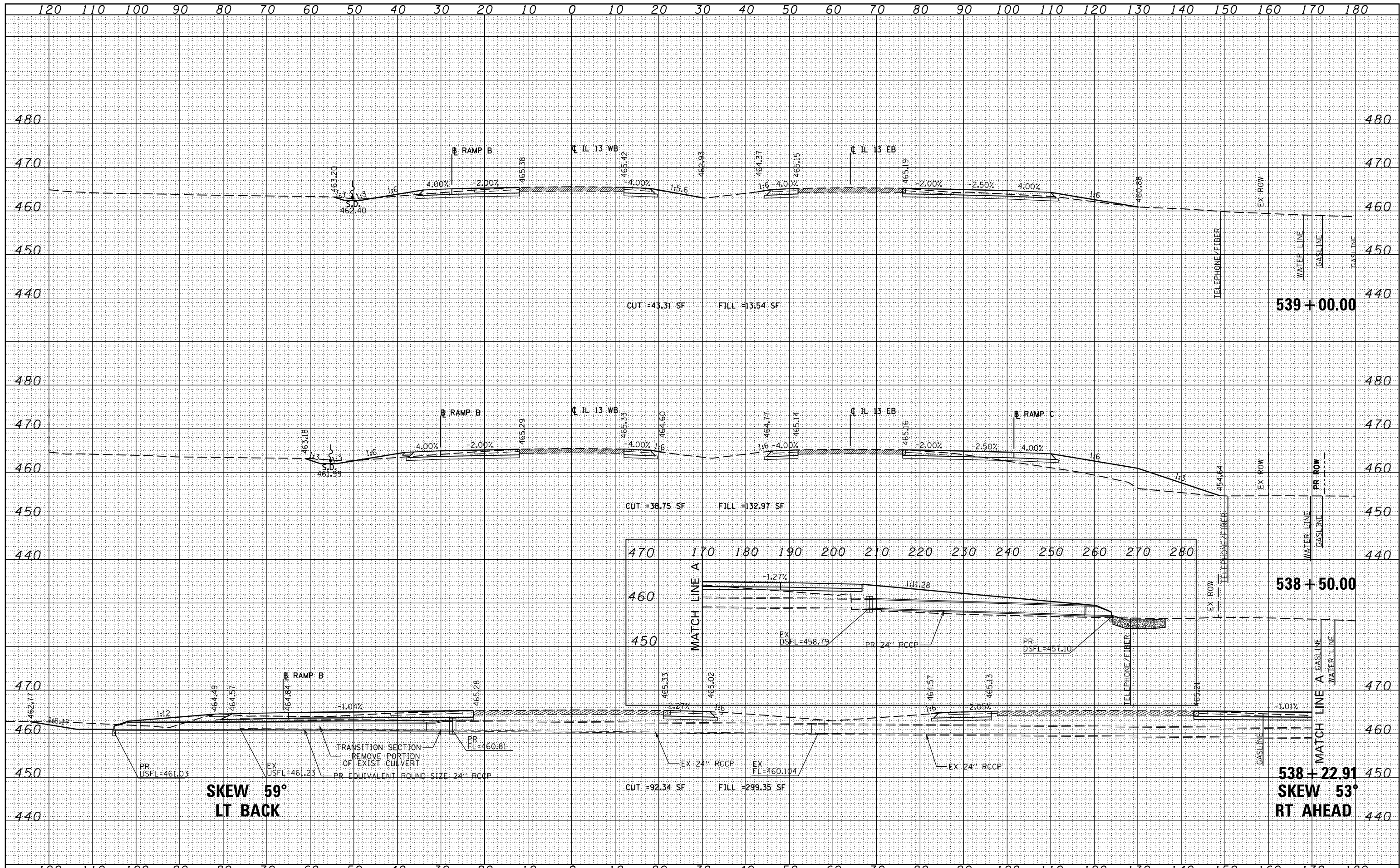

FILE NAME = c:\pwwork\pwwork\lavender\ba\d0363618\0978221-ht-xssht-IL13.dgn
 USER NAME = #USER#
 DESIGNED - KN
 DRAWN - AS
 CHECKED -
 DATE -
 PLOT SCALE = 20.0000' / 1"
 PLOT DATE = 1/31/2014

REVISIONS:
 REVISIONS -
 REVISIONS -
 REVISIONS -
 REVISIONS -

STATE OF ILLINOIS
 DEPARTMENT OF TRANSPORTATION

PROPOSED CROSS SECTIONS
 ILLINOIS ROUTE 13
 SCALE: SHEET NO. 44 OF 84 SHEETS STA. 538+22.91 TO STA. 539+00.00

F.A.P. RTE.	SECTION	COUNTY	TOTAL SHEETS	SHEET NO.
331 (1-3)R-2, N-4, TS-4, HBK-1	WILLIAMSON	733	444	
DRAWING NO. XS-044			78221	
ILLINOIS FED. AID PROJECT				