

DATE	
BY	
FINAL SURVEY	SURVEYED
NOTE BOOK	PLOTTED
NO.	TEMPLATE
	AREAS CHECKED

DATE	
BY	
ORIGINAL SURVEY	SURVEYED
NOTE BOOK	PLOTTED
NO.	TEMPLATE
	AREAS CHECKED

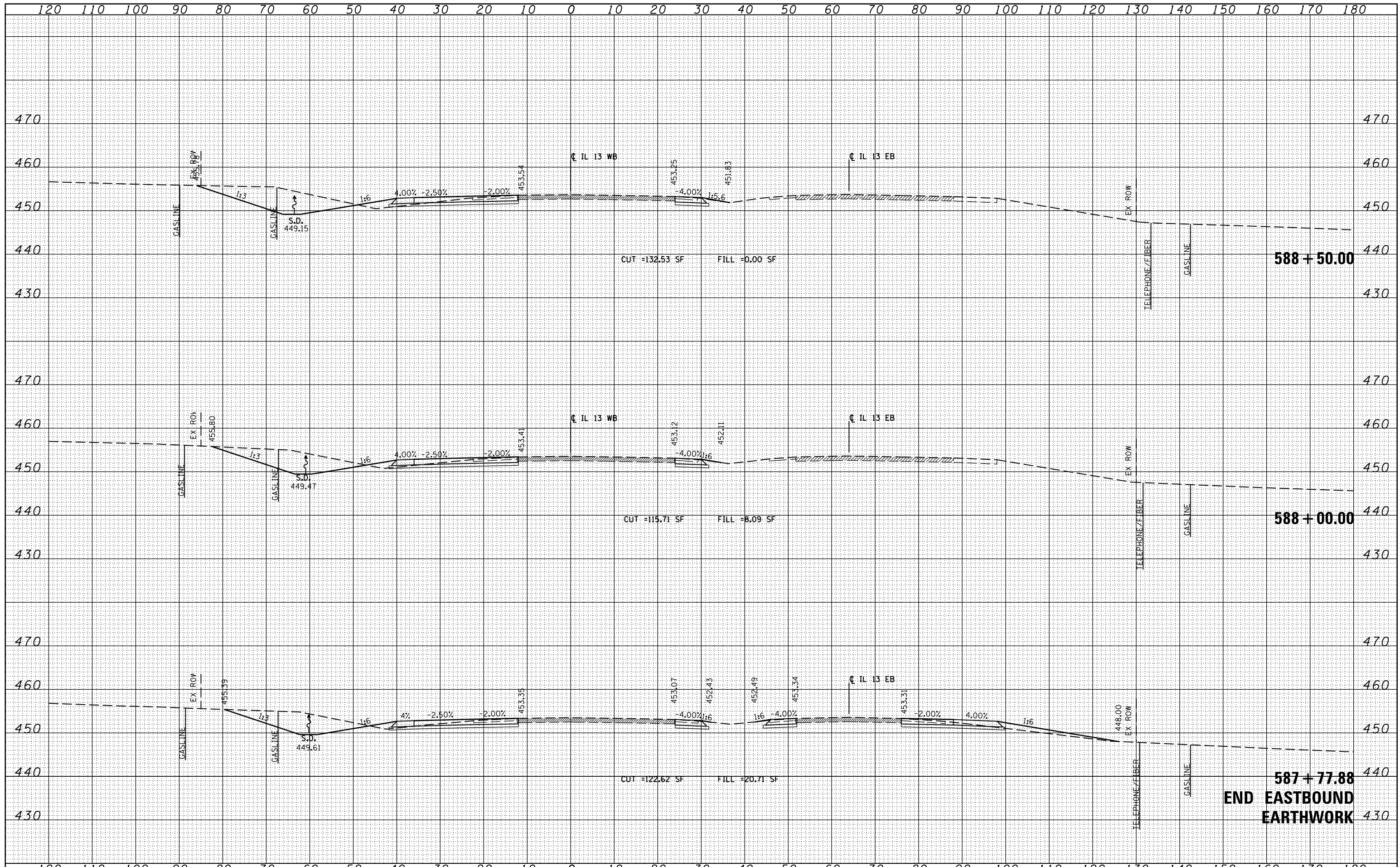

FILE NAME =	USER NAME = #USER*	DESIGNED - KN	REVISED -	STATE OF ILLINOIS DEPARTMENT OF TRANSPORTATION	PROPOSED CROSS SECTIONS ILLINOIS ROUTE 13			F.A.P. RTE.	SECTION	COUNTY	TOTAL SHEETS	SHEET NO.
ct:\pw_work\pwwdot\lavender-ba\d0363618\0978221-ht-xssht-IL13.dgn		DRAWN - AS	REVISED -		331	(1-3)R-2, N-4, TS-4, HBK-1	WILLIAMSON	733	480			
PLOT SCALE = 20.0000' / 1"		CHECKED -	REVISED -		DRAWING NO.	XS-080			78221			
PLOT DATE = 1/31/2014		DATE -	REVISED -		SCALE:	SHEET NO. 80 OF 84 SHEETS	STA. 587+77.88 TO STA. 588+50.00	ILLINOIS FED. AID PROJECT				