

DATE	
BY	
SURVEYED	
PLOTTED	
TEMPLATE	
NO. BOOK	
AREAS CHECKED	
AREAS CHECKED	

DATE	
BY	
SURVEYED	
PLOTTED	
TEMPLATE	
NO. BOOK	
AREAS CHECKED	
AREAS CHECKED	

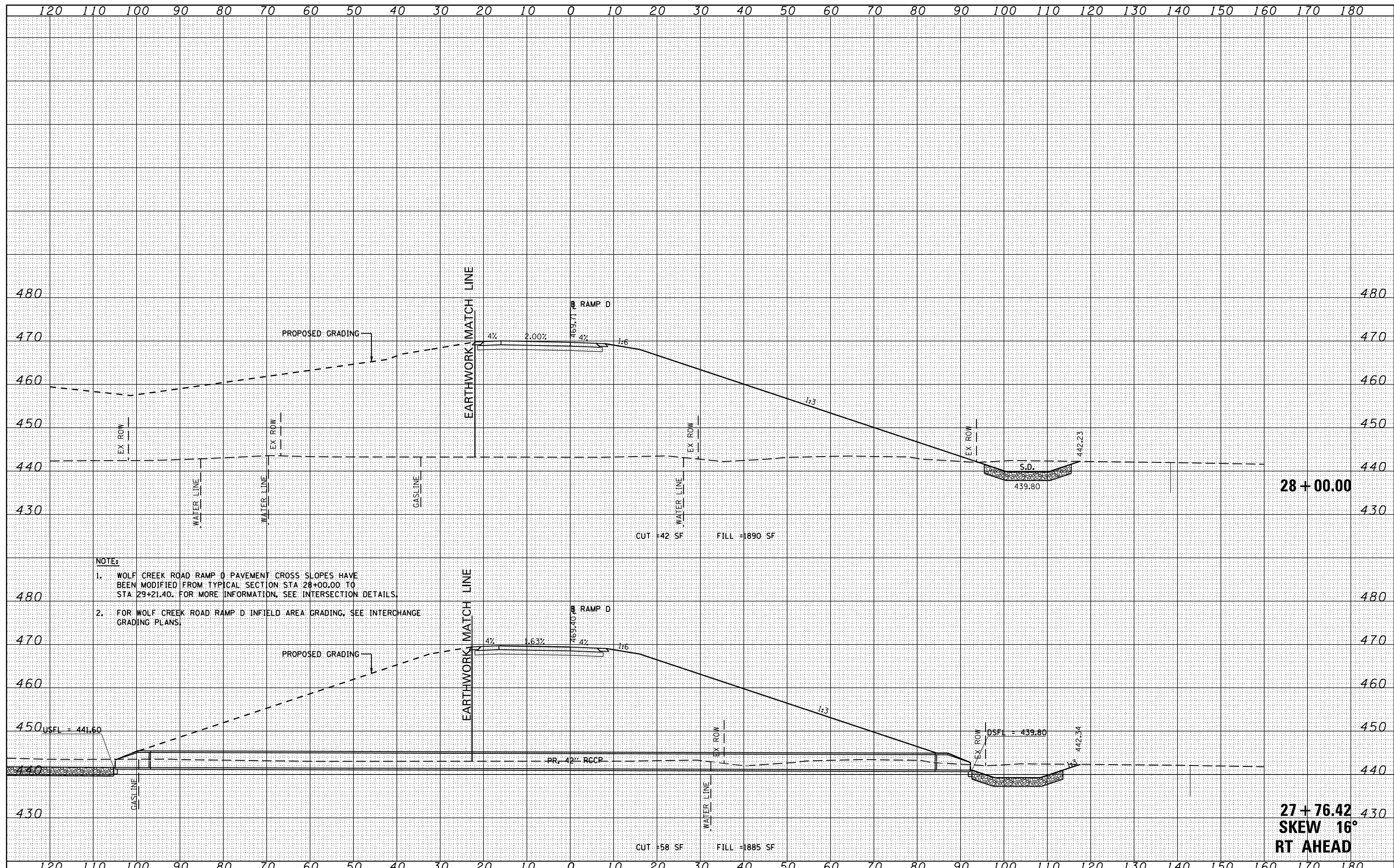

NOTE:
 1. WOLF CREEK ROAD RAMP D PAVEMENT CROSS SLOPES HAVE BEEN MODIFIED FROM TYPICAL SECTION STA 28+00.00 TO STA 29+21.40. FOR MORE INFORMATION, SEE INTERSECTION DETAILS.
 2. FOR WOLF CREEK ROAD RAMP D INFIELD AREA GRADING, SEE INTERCHANGE GRADING PLANS.

FILE NAME = c:\pw\work\p\wdot\lavenderba\d0363618\0978221\ht-xssht-WolfRampD.dgn	USER NAME = susers	DESIGNED - KN	REVISED -	STATE OF ILLINOIS DEPARTMENT OF TRANSPORTATION	PROPOSED CROSS SECTIONS WOLF CREEK ROAD RAMP D	F.A.P. RTE. 331	SECTION (1-3)R-2, N-4, TS-4, HBK-1	COUNTY WILLIAMSON	TOTAL SHEETS 733	SHEET NO. 524	
PLOT SCALE = 20.0000' / in.	CHECKED -	REVISIED -	SCALE:			SHEET NO. 10 OF 11 SHEETS	STA. 27+79.71 TO STA. 28+00.00	DRAWING NO. XS-124	ILLINOIS FED. AID PROJECT		
PLOT DATE = 1/31/2014	DATE -	REVISIED -									