

DATE	
BY	
FINISHED SURVEY	
PLOTTED	
TEMPLATE	
NOTE BOOK	
AREAS CHECKED	
NO.	

DATE	
BY	
ORIGINAL SURVEY	
PLOTTED	
TEMPLATE	
NOTE BOOK	
AREAS CHECKED	
NO.	

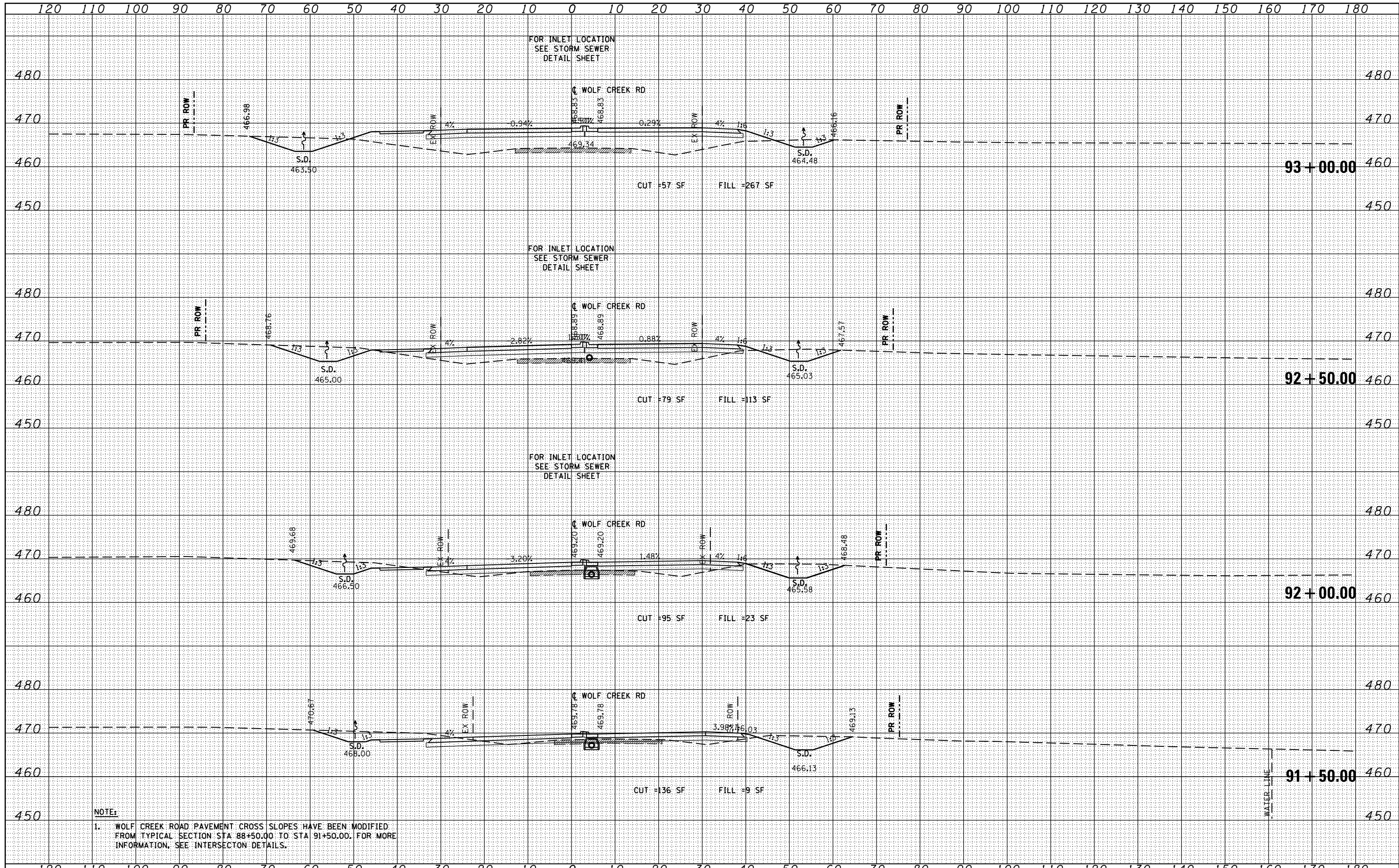

**NOTE:**  
 1. WOLF CREEK ROAD PAVEMENT CROSS SLOPES HAVE BEEN MODIFIED FROM TYPICAL SECTION STA 88+50.00 TO STA 91+50.00. FOR MORE INFORMATION, SEE INTERSECTION DETAILS.

FILE NAME =	USER NAME = susers	DESIGNED - KN	REVISED -	<b>STATE OF ILLINOIS</b> <b>DEPARTMENT OF TRANSPORTATION</b>	<b>PROPOSED CROSS SECTIONS</b> <b>WOLF CREEK ROAD</b>	F.A.P. RTE.	SECTION	COUNTY	TOTAL SHEETS	SHEET NO.
ca:\pw-work\p1dot\lavenderba\0363618\0978221-1\ht-wsht-Wolf.dgn		DRAWN - AS	REVISED -			331	(1-3)R-2, N-4, TS-4, HBK-1	WILLIAMSON	733	532
		CHECKED -	REVISED -			DRAWING NO.	XS-132			78221
		DATE - 1/31/2014	REVISED -			ILLINOIS FED. AID PROJECT				

SCALE: SHEET NO. 7 OF 30 SHEETS STA. 91+50.00 TO STA. 93+00.00