

Bench Mark: BM12 Cut square on top of the south headwall of a 24" across road culvert, in the SW quadrant of Rte 13 EBL and North Wolf Creek Road, 132.11' right of the C of Rte 13 WBL @ Sta. 519+39.87, Elev. 445.70.

Existing Structure: None.

Traffic to be detoured.

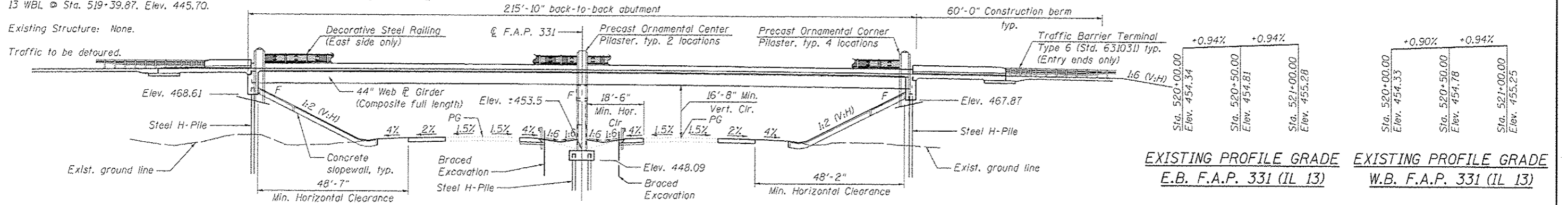

EXISTING PROFILE GRADE E.B. F.A.P. 331 (IL 13)  
 EXISTING PROFILE GRADE W.B. F.A.P. 331 (IL 13)

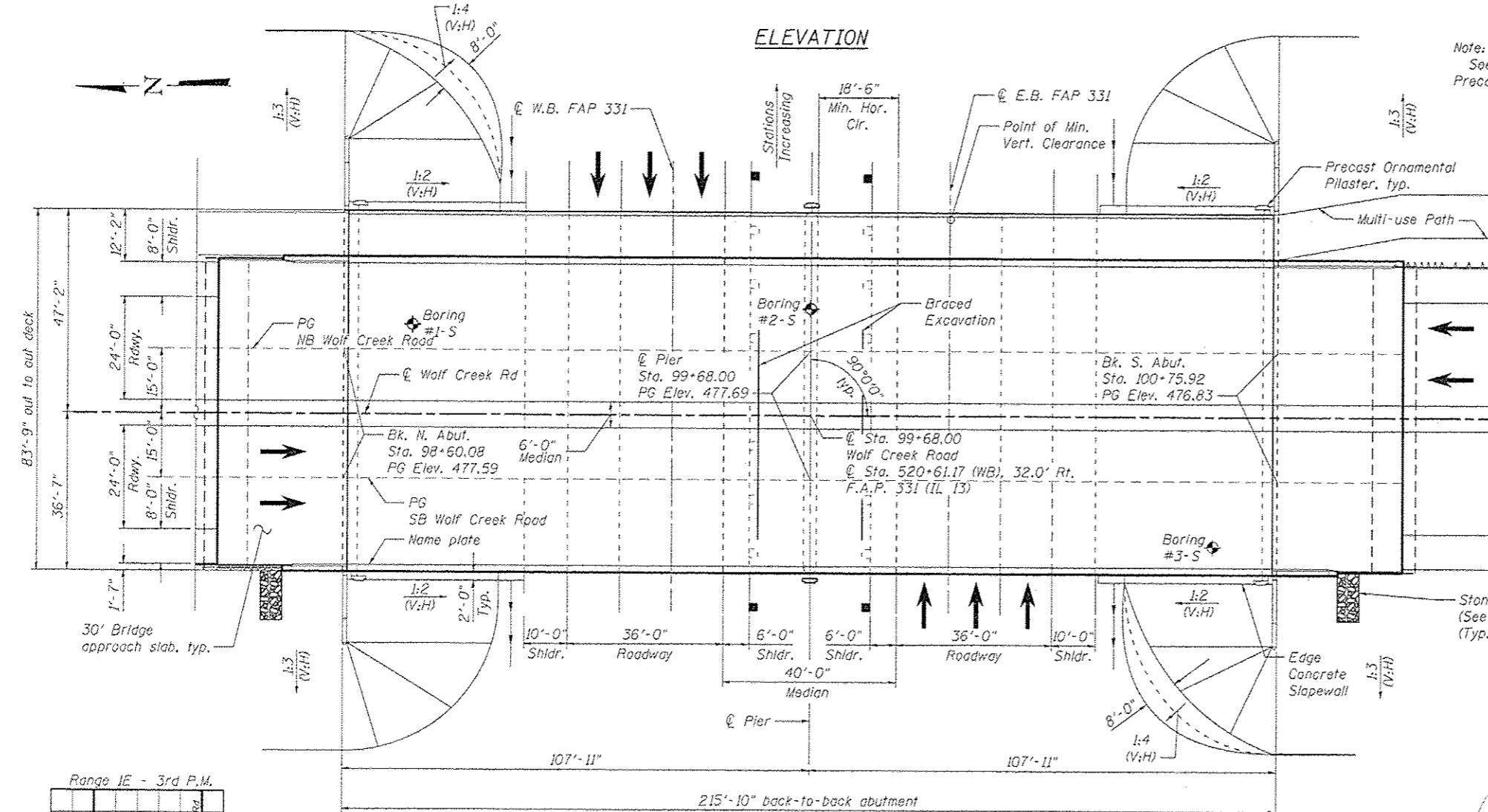

**ELEVATION**

**PLAN**

Note: See Roadway drawings for Precast Ornamental Pilaster and riprap details.

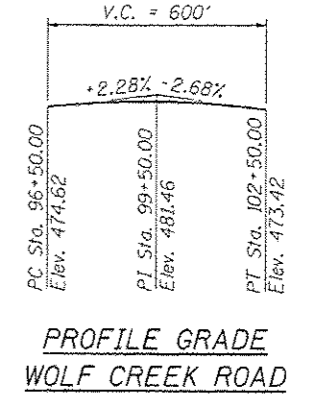

PROFILE GRADE WOLF CREEK ROAD

**APPROVED**  
For Structural Adequacy Only

*Michael J. Cooper*  
Engineer of Bridges & Structures



Michael J. Cooper  
Licensed Structural Engineer  
State of Illinois No. 081007297

GENERAL PLAN & ELEVATION  
 WOLF CREEK ROAD  
 OVER F.A.P. 331 (IL 13)  
 SEC (1-3) HBK-1  
 WILLIAMSON COUNTY  
 STATION 99+68.00  
 STRUCTURE NO. 100-0099

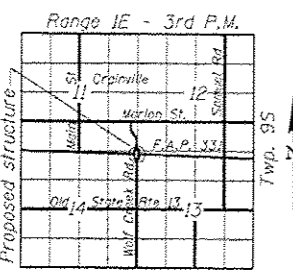

LOCATION SKETCH

**LOADING HL-93**  
Allow 50#/sq. ft. for future wearing surface.

**DESIGN SPECIFICATIONS**  
2012 AASHTO LRFD Bridge Design Specifications 6th edition

**DESIGN STRESSES**  
FIELD UNITS  
 $f'_c = 3,500$  psi  
 $f_y = 60,000$  psi (Reinforcement)  
 $f_y = 50,000$  psi (M270 Grade 50)

**SEISMIC DATA**  
 Seismic Performance Zone (SPZ) = 2  
 Design Spectral Acceleration at 1.0 sec. ( $S_{D1}$ ) = 0.264g  
 Design Spectral Acceleration at 0.2 sec. ( $S_{D5}$ ) = 0.727g  
 Soil Site Class = C

FILE NAME = 1020099-178221-201-CPE.dgn	USER NAME = mfox	DESIGNED - DF	REVISIONS -	STATE OF ILLINOIS DEPARTMENT OF TRANSPORTATION	GENERAL PLAN AND ELEVATION	SHEET NO. 1 OF 27 SHEETS
CH2MHILL	PLOT SCALE = 32,000 1/4 in.	CHECKED - JE	REVISIONS -			
	PLOT DATE = 2/27/2014	DRAWN - AK	REVISIONS -			
		CHECKED - JE	REVISIONS -			
				F.A.P. RTE. SECTION COUNTY TOTAL SHEETS SHEET NO.		
				331 (1-3)R-2, N-4, TS-4, HBK-1 WILLIAMSON 733 358		
				DRAWING NO. BR-01 CONTRACT NO. 78221		
				ILLINOIS FED. AID PROJECT		