

PLAN	SURVEYED	BY	DATE
	PLOTTED		
	AT		
	INSTRUMENT		
	NO.		
	NOTE BOOK		
	NO.		
	CADD FILE NAME		

PROFILE	SURVEYED	BY	DATE
	PLOTTED		
	GRADES CHECKED		
	STRUCTURE		
	NOT AT THIS OFFICE		
	NO.		
	NOTE BOOK		
	NO.		

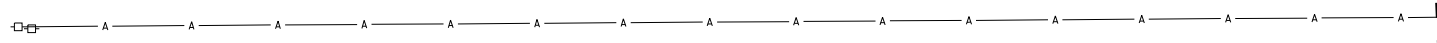

NOTE: EARTHWORK WILL NOT BE PERFORMED FROM LT. STA. 993+60 TO LT. STA. 994+61. PLACE AGGREGATE SHOULDERS, TYPE B, AS SHOWN ON THE CROSS SECTIONS.

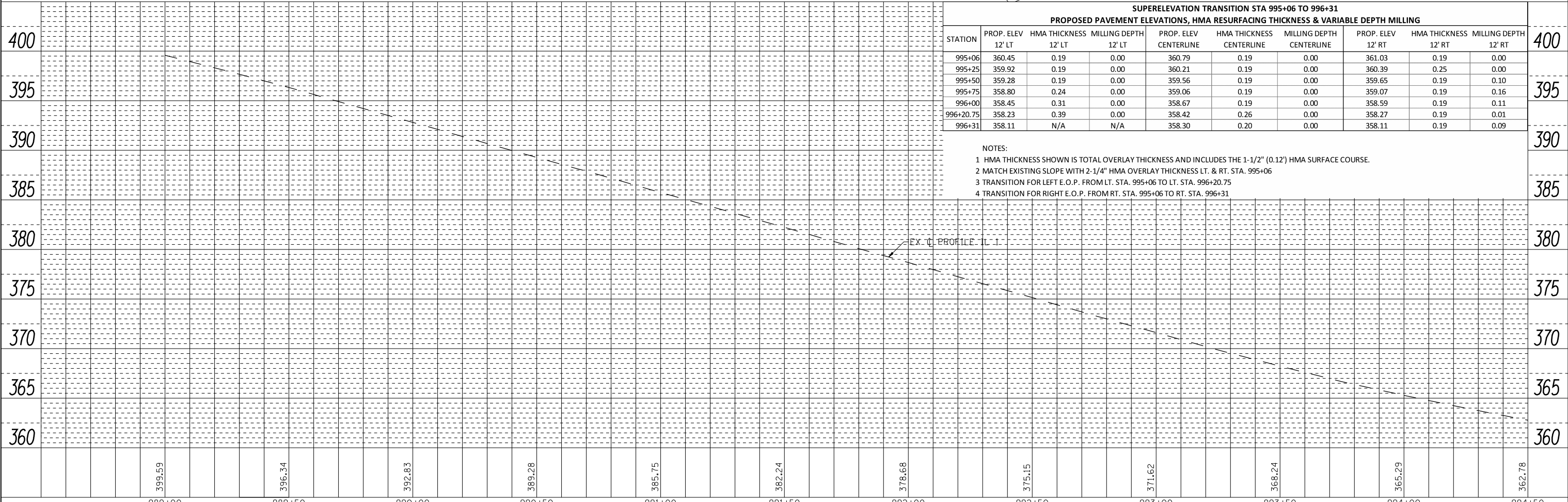
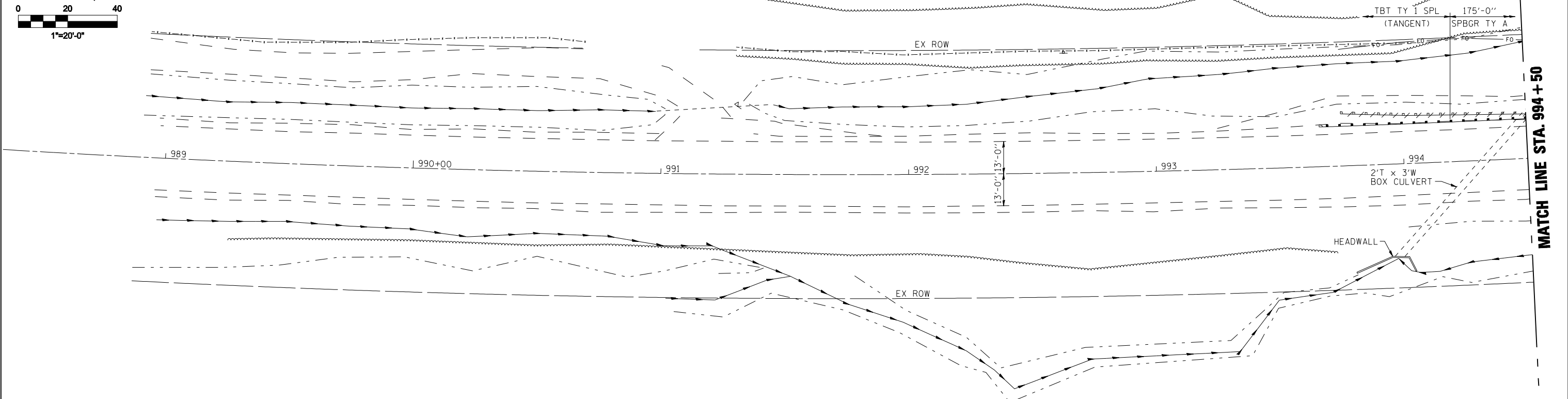

- NOTES:
 1 HMA THICKNESS SHOWN IS TOTAL OVERLAY THICKNESS AND INCLUDES THE 1-1/2" (0.12') HMA SURFACE COURSE.
 2 MATCH EXISTING SLOPE WITH 2-1/4" HMA OVERLAY THICKNESS LT. & RT. STA. 995+06
 3 TRANSITION FOR LEFT E.O.P. FROM LT. STA. 995+06 TO LT. STA. 996+20.75
 4 TRANSITION FOR RIGHT E.O.P. FROM RT. STA. 995+06 TO RT. STA. 996+31

PRINT DRIVER = I:\D.L.B. & J.P.L.
 PLOT DATE = 1/22/2014 5:19:30 PM
 PLOT SCALE = 1"=20' (HORIZ) 1"=5' (VERT)
 PLOT FILE NAME = D:\7823-INT-210-01.dgn



USER NAME = kah	DESIGNED - JMS/NHP	REVISED -
ESCA PROJECT NO. 1035.03	DRAWN - HAS	REVISED -
SCALEs: (HORIZ) 1"=20' (VERT) 1"=5'	CHECKED - RDP	REVISED -
PLOT DATE = 1/22/2014 5:19:30 PM	DATE - 11/13	REVISED -

**STATE OF ILLINOIS
DEPARTMENT OF TRANSPORTATION**

FAP 782 (IL 1) PLAN & PROFILE
 SCALE: AS SHOWN SHEET NO. 1 OF 3 SHEETS STA. 989+00 TO STA. 994+50

F.A.P. RTE. 782	SECTION 115B-1	COUNTY HARDIN	TOTAL SHEETS 70	SHEET NO. 14
FED. ROAD DIST. NO.		ILLINOIS FED. AID PROJECT		
		CONTRACT NO. 78263		