

EAST EDGE OF SHOULDER

Location	Station	Offset (ft.)	Theoretical Grade Elevations
N. end N. appr. slab	996+22.75	-16.00	358.13
A1	996+39.99	-16.00	358.01
A2	996+49.99	-16.00	357.94
S. end N. appr. slab	996+59.99	-16.00	357.88

EAST EDGE OF ROADWAY

Location	Station	Offset (ft.)	Theoretical Grade Elevations
N. end N. appr. slab	996+26.75	-12.00	358.16
A1	996+43.99	-12.00	358.06
A2	996+53.99	-12.00	358.00
S. end N. appr. slab	996+63.99	-12.00	357.93

☐ ROADWAY & PROFILE GRADE

Location	Station	Offset (ft.)	Theoretical Grade Elevations
N. end N. appr. slab	996+45.99	0.00	358.24
A1	996+55.99	0.00	358.17
A2	996+65.99	0.00	358.11
S. end N. appr. slab	996+75.99	0.00	358.05

STAGE CONSTRUCTION LINE

Location	Station	Offset (ft.)	Theoretical Grade Elevations
N. end N. appr. slab	996+46.49	0.50	358.23
A1	996+56.49	0.50	358.16
A2	996+66.49	0.50	358.10
S. end N. appr. slab	996+76.49	0.50	358.04

WEST EDGE OF ROADWAY

Location	Station	Offset (ft.)	Theoretical Grade Elevations
N. end N. appr. slab	996+57.99	12.00	357.97
A1	996+67.99	12.00	357.91
A2	996+77.99	12.00	357.85
S. end N. appr. slab	996+87.99	12.00	357.79

WEST EDGE OF SHOULDER

Location	Station	Offset (ft.)	Theoretical Grade Elevations
N. end N. appr. slab	996+61.99	16.00	357.86
A1	996+71.99	16.00	357.80
A2	996+81.99	16.00	357.74
S. end N. appr. slab	996+91.99	16.00	357.69

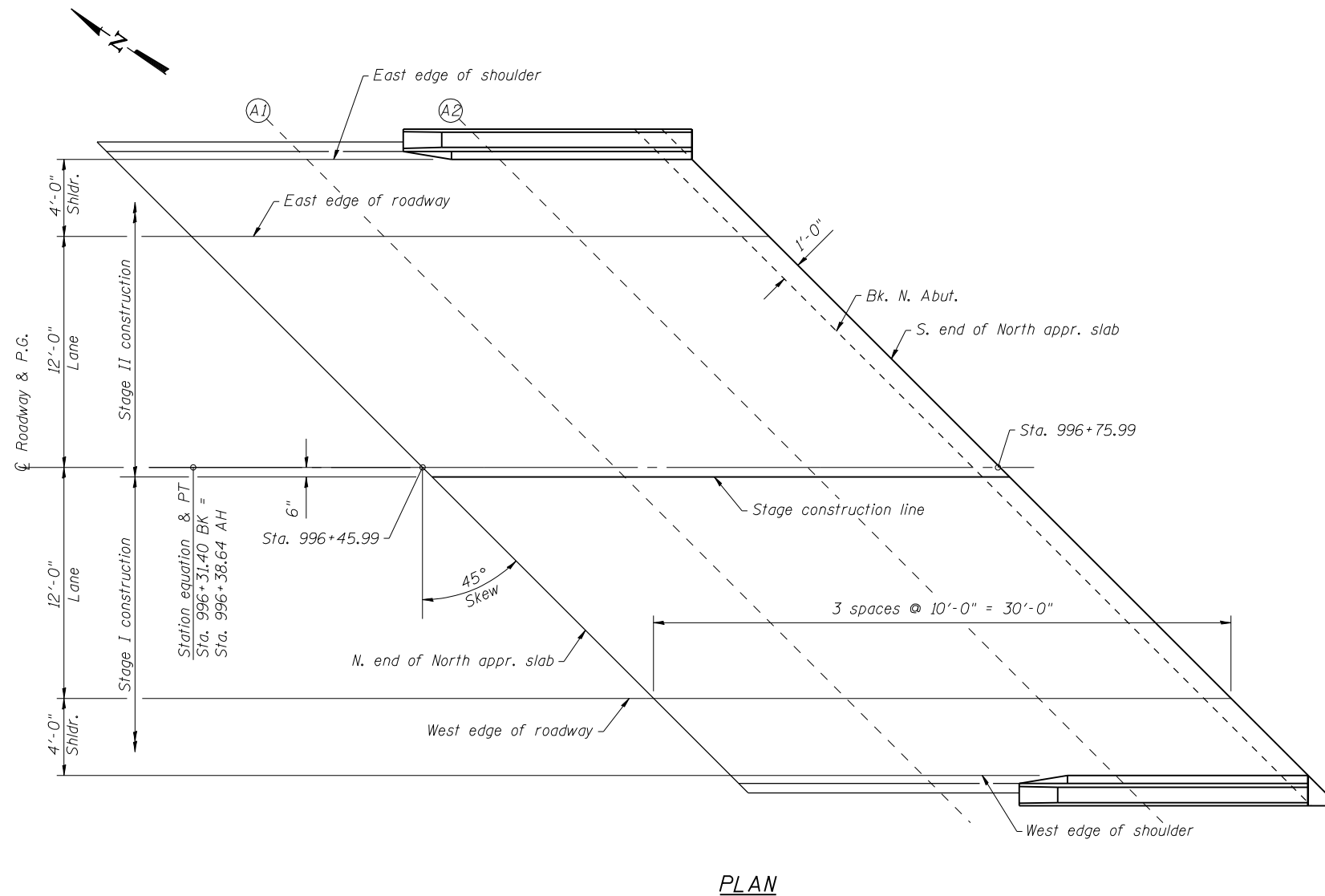

PLAN

PRINT DRIVER = LUD-ER-BAR-JUL
 ESCA PROJECT NO. 1035.03
 PLOT SCALE = 0.25" = 1' / IN.
 PLOT DATE = 1/22/2014 5:22:28 PM



USER NAME = kah	DESIGNED - SHL 07/13	REVISED -
ESCA PROJECT NO. 1035.03	CHECKED - RDP 09/13	REVISED -
PLOT SCALE = 0.25" = 1' / IN.	DRAWN - JPC 07/13	REVISED -
PLOT DATE = 1/22/2014 5:22:28 PM	CHECKED - SHL 08/13	REVISED -

**STATE OF ILLINOIS
DEPARTMENT OF TRANSPORTATION**

**TOP OF NORTH APPROACH SLAB ELEVATIONS
STRUCTURE NO. 035-0017**

SHEET NO. 7 OF 29 SHEETS

F.A.P. RTE. 782	SECTION 115B-1	COUNTY HARDIN	TOTAL SHEETS 70	SHEET NO. 30
CONTRACT NO. 78263			ILLINOIS FED. AID PROJECT	