

EAST EDGE OF SHOULDER

Location	Station	Offset (ft.)	Theoretical Grade Elevations
N. end S. appr. slab	997+88.61	-16.00	357.32
A3	997+98.61	-16.00	357.30
A4	998+08.61	-16.00	357.28
S. end S. appr. slab	998+18.61	-16.00	357.27

EAST EDGE OF ROADWAY

Location	Station	Offset (ft.)	Theoretical Grade Elevations
N. end S. appr. slab	997+92.61	-12.00	357.39
A3	998+02.61	-12.00	357.37
A4	998+12.61	-12.00	357.36
S. end S. appr. slab	998+22.61	-12.00	357.34

☐ ROADWAY & PROFILE GRADE

Location	Station	Offset (ft.)	Theoretical Grade Elevations
N. end S. appr. slab	998+04.61	0.00	357.56
A3	998+14.61	0.00	357.54
A4	998+24.61	0.00	357.53
S. end S. appr. slab	998+34.61	0.00	357.52

STAGE CONSTRUCTION LINE

Location	Station	Offset (ft.)	Theoretical Grade Elevations
N. end S. appr. slab	998+05.11	0.50	357.55
A3	998+15.11	0.50	357.53
A4	998+25.11	0.50	357.52
S. end S. appr. slab	998+35.11	0.50	357.51

WEST EDGE OF ROADWAY

Location	Station	Offset (ft.)	Theoretical Grade Elevations
N. end S. appr. slab	998+16.61	12.00	357.35
A3	998+26.61	12.00	357.34
A4	998+36.61	12.00	357.33
S. end S. appr. slab	998+46.61	12.00	357.32

WEST EDGE OF SHOULDER

Location	Station	Offset	Theoretical Grade Elevations
N. end S. appr. slab	998+20.61	16.00	357.26
A3	998+30.61	16.00	357.25
A4	998+40.61	16.00	357.24
S. end S. appr. slab	998+50.61	16.00	357.24

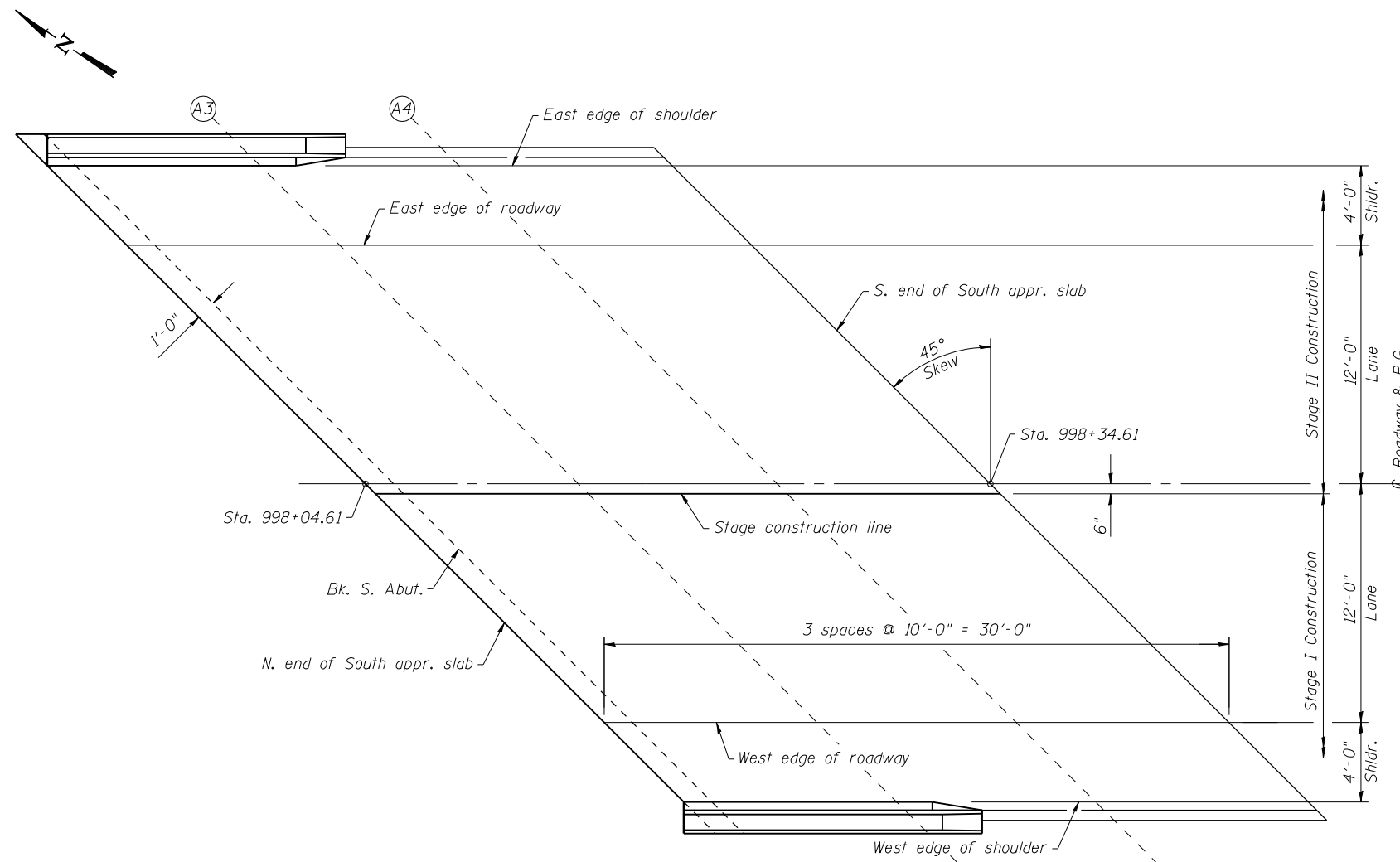

PLAN

PRINT DRIVER = LUD-ER-BAR-JUL
 ESCA PROJECT NO. 1035.03
 PLOT SCALE = 0.2" = 1' / IN.
 PLOT DATE = 1/22/2014 5:22:34 PM



USER NAME = kah	DESIGNED - SHL 07/13	REVISED -
ESCA PROJECT NO. 1035.03	CHECKED - RDP 09/13	REVISED -
PLOT SCALE = 0.2" = 1' / IN.	DRAWN - JPC 07/13	REVISED -
PLOT DATE = 1/22/2014 5:22:34 PM	CHECKED - SHL 08/13	REVISED -

**STATE OF ILLINOIS
 DEPARTMENT OF TRANSPORTATION**

**TOP OF SOUTH APPROACH SLAB ELEVATIONS
 STRUCTURE NO. 035-0017**

SHEET NO. 8 OF 29 SHEETS

F.A.P. RTE. 782	SECTION 115B-1	COUNTY HARDIN	TOTAL SHEETS 70	SHEET NO. 31
CONTRACT NO. 78263			ILLINOIS FED. AID PROJECT	