

Notes:  
 Pour steps monolithically with cap.  
 For details of piles see sheet 23 of 29.  
 For details of Bar Splicers see sheet 24 of 29.  
 Space reinforcement in cap to miss anchor bolts.

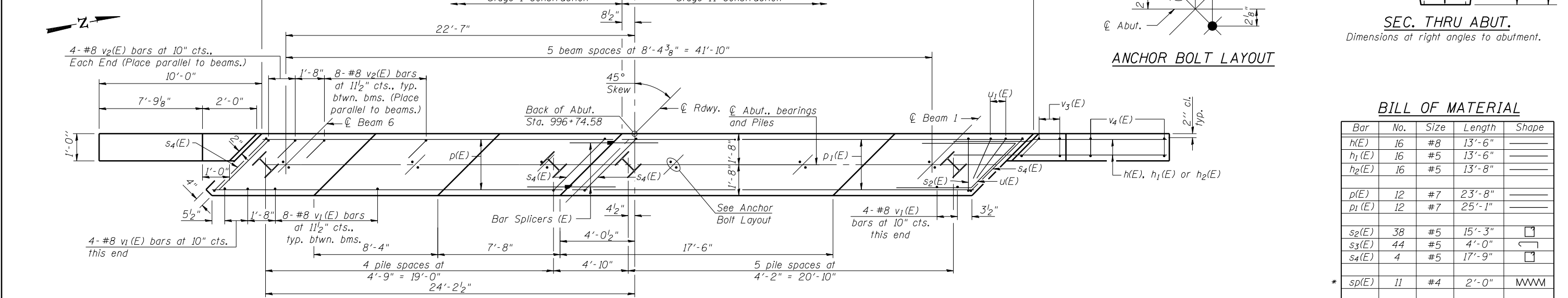
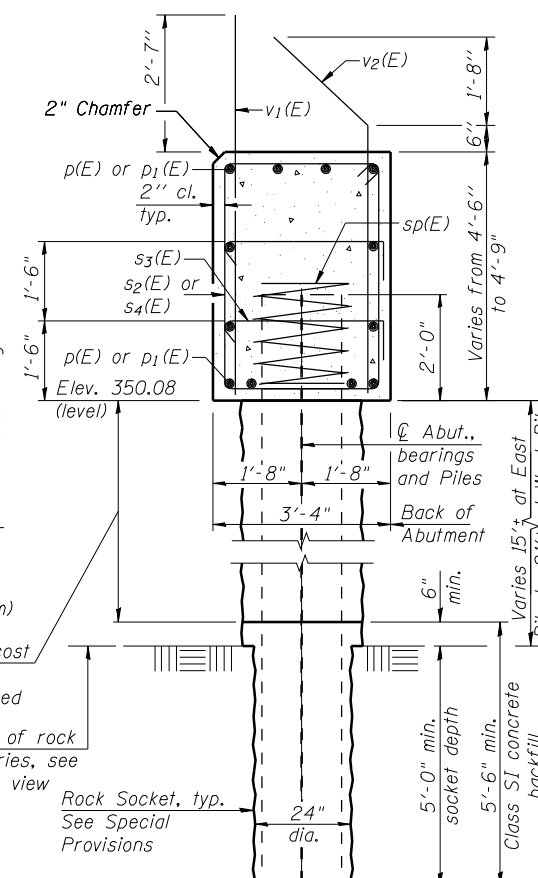
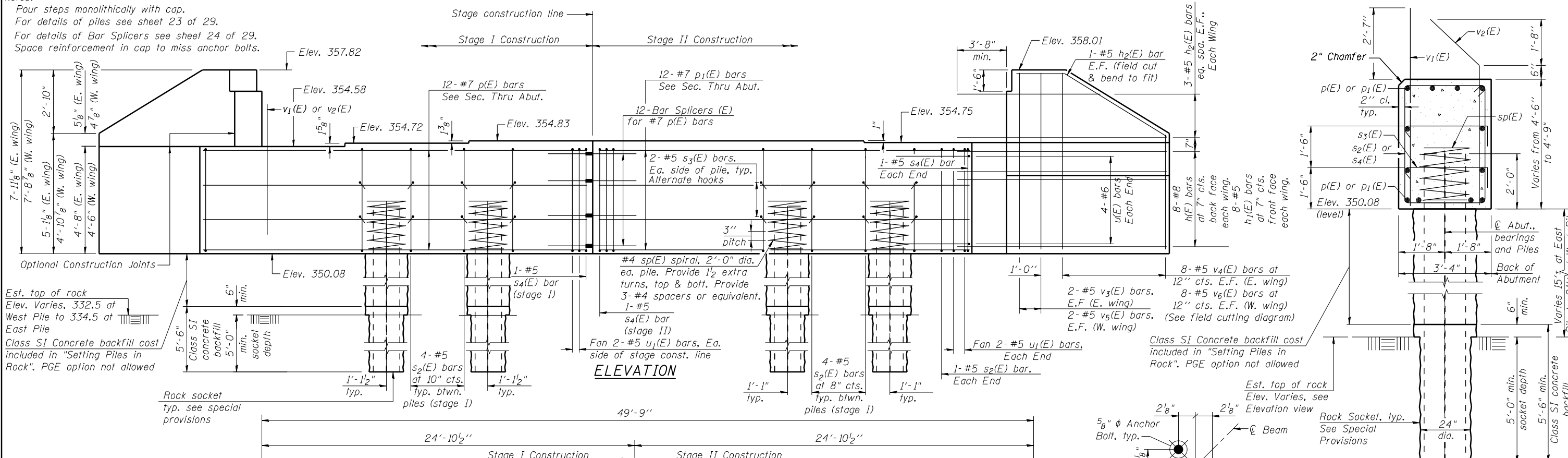

**BILL OF MATERIAL**

Bar	No.	Size	Length	Shape
h(E)	16	#8	13'-6"	—
h1(E)	16	#5	13'-6"	—
h2(E)	16	#5	13'-8"	—
p(E)	12	#7	23'-8"	—
p1(E)	12	#7	25'-1"	—
s2(E)	38	#5	15'-3"	□
s3(E)	44	#5	4'-0"	□
s4(E)	4	#5	17'-9"	□
* sp(E)	11	#4	2'-0"	WWM
u(E)	8	#6	11'-9"	—
u1(E)	8	#5	9'-2"	—
v1(E)	48	#8	5'-11"	—
v2(E)	48	#8	6'-2"	—
v3(E)	8	#5	7'-7"	—
v4(E)	16	#5	12'-4"	—
v5(E)	8	#5	7'-5"	—
v6(E)	16	#5	12'-0"	—
Concrete Structures			Cu. Yd.	33.3
Reinforcement Bars, Epoxy Coated			Pound	5760
Furnishing Steel Piles HP14x73			Foot	264
Setting Piles in Rock			Each	11

\*Length is height of spiral.

**PILE DATA**  
 Type: HP14x73  
 Nominal Required Bearing: 578 kips  
 Factored Resistance Available: 318 kips  
 Est. Length: \*\*  
 No. Production Piles: 11  
 No. Test Piles: 0

\*\*Varies, 23' at East Pile to 25' at West Pile

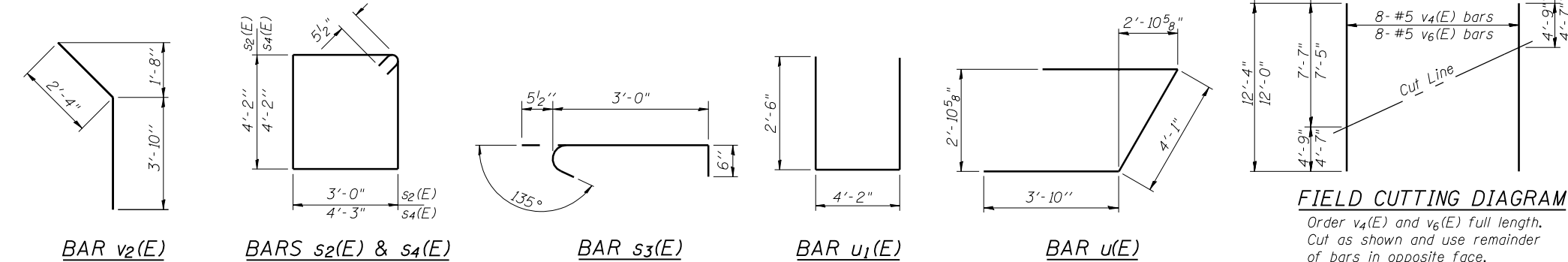

USER NAME = kah	DESIGNED - SHL	08/13	REVISED -
ESCA PROJECT NO. 1035.03	CHECKED - RDP	09/13	REVISED -
PLOT SCALE = 0/2' = 1/4" IN.	DRAWN - HAS	08/13	REVISED -
PLOT DATE = 1/22/2014	CHECKED - SHL	08/13	REVISED -

**STATE OF ILLINOIS  
 DEPARTMENT OF TRANSPORTATION**

**NORTH ABUTMENT  
 STRUCTURE NO. 035-0017**

SHEET NO. 18 OF 29 SHEETS

F.A.P. RTE.	SECTION	COUNTY	TOTAL SHEETS	SHEET NO.
782	115B-1	HARDIN	70	41
CONTRACT NO. 78263			ILLINOIS FED. AID PROJECT	