

F.A.P. RTE.	SECTION	COUNTY	TOTAL SHEETS	SHEET NO.
782	115B-1	HARDIN	70	1
FED. ROAD DIST. NO.	ILLINOIS	CONTRACT NO. 78263		

### INDEX OF SHEETS

#### SHEET NO. DESCRIPTION

- ROADWAY PLANS**
- COVER SHEET
  - GENERAL NOTES AND STANDARDS
  - 8. SUMMARY OF QUANTITIES
  - 12. TYPICAL SECTIONS
  - SCHEDULES OF QUANTITIES
  - 16. FAP 782 (IL 1) PLAN AND PROFILE
  - 18. STAGE CONSTRUCTION PLAN AND DETAILS
  - EROSION CONTROL PLAN
  - SEEDING AND MULCHING DETAILS
  - STEP CONSTRUCTION ON EXISTING FILL DETAILS
  - BUTT JOINT DETAIL
  - FLARED TRAFFIC BARRIER TERMINAL DETAIL
- STRUCTURE PLANS**
- GENERAL PLAN & ELEVATION
  - GENERAL DATA
  - STAGE CONSTRUCTION DETAILS
  - TEMPORARY CONCRETE BARRIER FOR STAGE CONSTRUCTION
  - 29. TOP OF SLAB ELEVATIONS
  - TOP OF NORTH APPROACH SLAB ELEVATIONS
  - TOP OF SOUTH APPROACH SLAB ELEVATIONS
  - SUPERSTRUCTURE
  - SUPERSTRUCTURE DETAILS
  - DRAINAGE SCUPPER, DS-II
  - DIAPHRAGM DETAILS
  - BRIDGE APPROACH SLAB DETAILS
  - STEEL FRAMING PLAN
  - STEEL FRAMING DETAILS
  - BEARING DETAILS
  - NORTH ABUTMENT
  - SOUTH ABUTMENT
  - PIER 1
  - PIER 2
  - COFFERDAM DETAILS
  - HP PILE DETAILS
  - BAR SPLICER ASSEMBLY AND MECHANICAL SPLICER DETAILS
  - CANTILEVER FORMING BRACKETS FOR SUPERSTRUCTURES WITH W27 BEAMS AND SMALLER BORING LOGS
- EXISTING STRUCTURE PLANS**  
**SN 035-0002**
- EXISTING STRUCTURE PLANS - FOR INFORMATION ONLY
- CROSS SECTIONS**
- FAP 782 (IL 1) CROSS SECTIONS

STATE OF ILLINOIS  
DEPARTMENT OF TRANSPORTATION  
DIVISION OF HIGHWAYS

# PROPOSED HIGHWAY PLANS

FAP ROUTE 782 (IL 1)  
SECTION 115B-1  
PROJECT ACF-0782 (013)  
HARDIN COUNTY

C - 99 - 051 - 11

BRIDGE REPLACEMENT  
OVER ROCK CREEK

R9E, 3RD PM

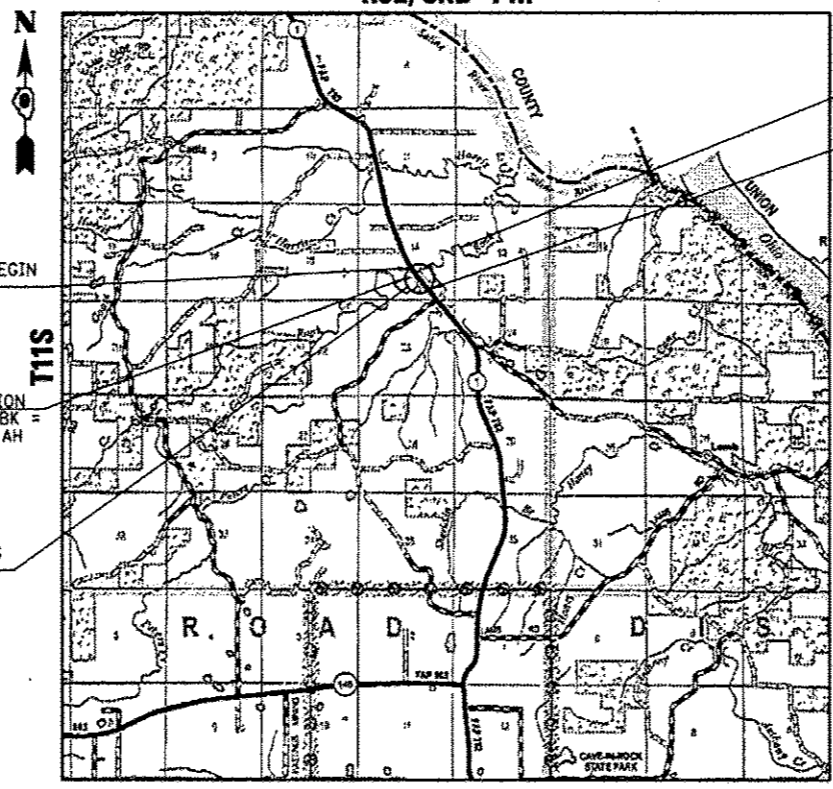
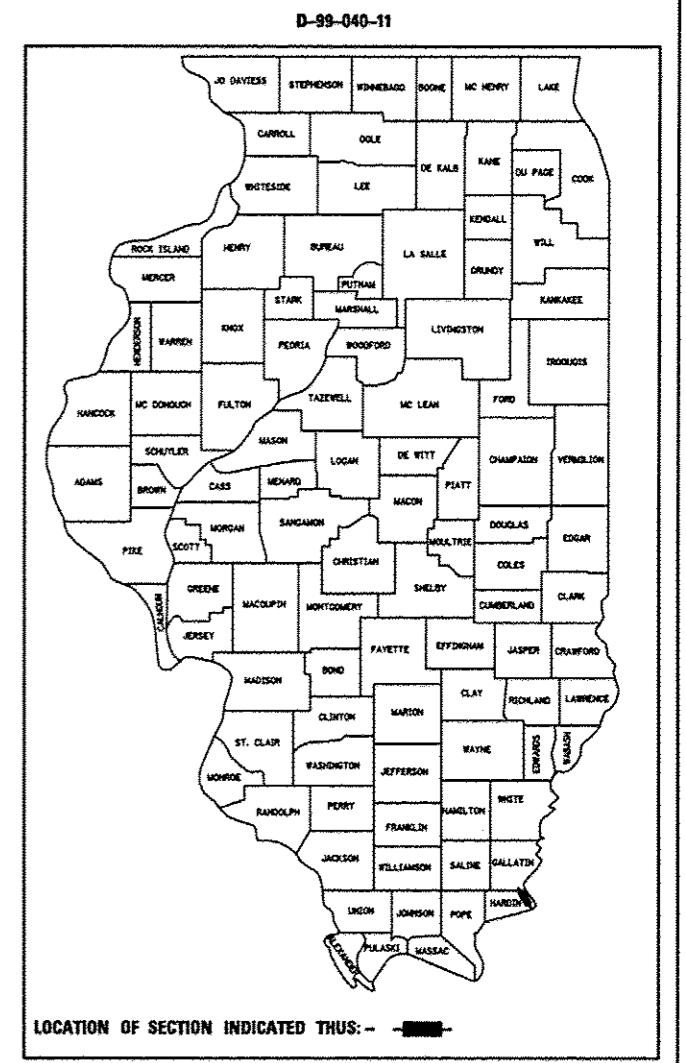

ROCK CREEK  
IMPROVEMENTS END  
STA. 999+70

DESIGN  
DESIGNATION  
N.A.

FUNCTIONAL CLASSIFICATION: MINOR ARTERIAL (NON URBAN)  
DESIGN SPEED: 55 mph  
POSTED SPEED: 55 mph  
ADT: 1,328 (2011)  
PV: 78%  
TRUCKS: 22%  
TOWNSHIP: ROAD DISTRICT NO. 1

STATE OF ILLINOIS  
DEPARTMENT OF TRANSPORTATION  
DIVISION OF HIGHWAYS

SUBMITTED Jan 28 2014  
Jeffrey L. Keem  
DEPUTY DIRECTOR OF HIGHWAYS, REGION ENGINEER

March 21 2014  
John D. Baranzelle, P.E.  
ENGINEER OF DESIGN AND ENVIRONMENT

March 21 2014  
Omer Osman, P.E.  
DIRECTOR OF HIGHWAYS, CHIEF ENGINEER

J.U.L.I.E.  
JOINT UTILITY LOCATION INFORMATION FOR EXCAVATION  
1-800-892-0123  
OR 811

DISTRICT 9 NO. (618) 549-2171  
PROJECT ENGINEER: DAVID PICHE  
CONTRACT NO. 78263



Richard D. Payne  
DATE: 1/22/2014  
ILLINOIS PROFESSIONAL LICENSE NO. 37421  
(EXPIRATION DATE: 11-30-15)

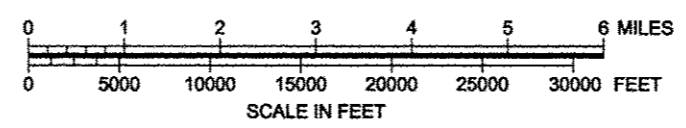

GROSS LENGTH = 456.76 FT. = 0.087 MI.  
NET LENGTH = 456.76 FT. = 0.087 MI.

PRINTED BY THE AUTHORITY  
OF THE STATE OF ILLINOIS