

ELEVATION
(Looking South)

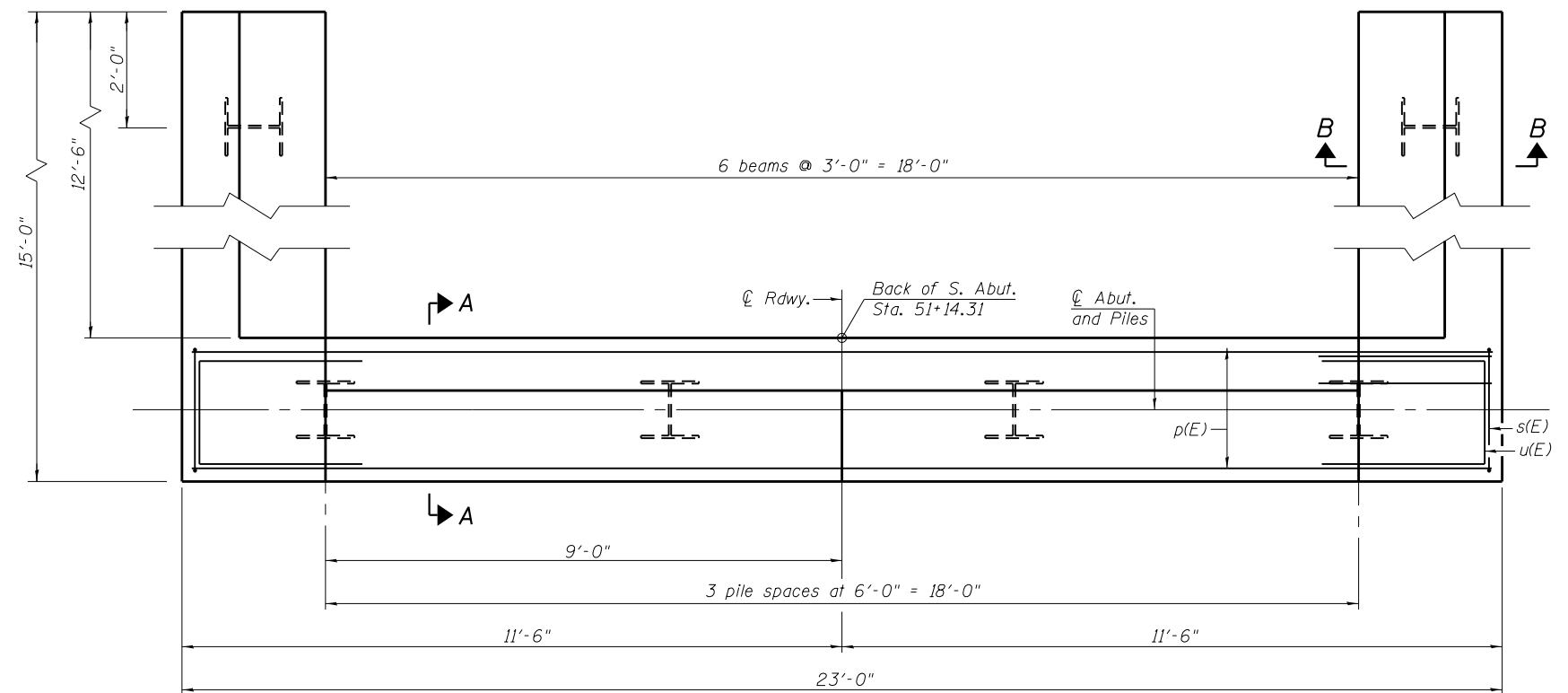

PLAN

Notes
Cast top of wingwall flush with exterior beam face after beams have been erected.
For Abutment Sections and Details, see Sheet 10 of 12.
2'-6" x 2'-6" x 1'-9 1/2" Abutment Corners to be included with Concrete Superstructures

**BILL OF MATERIAL
SOUTH ABUTMENT**

Bar	No.	Size	Length	Shape
d(E)	26	#5	6'-3"	┌
d1(E)	26	#5	4'-1"	┌
d2(E)	6	#6	6'-9"	┌
d3(E)	6	#6	4'-7"	┌
h(E)	6	#5	17'-8"	—
h1(E)	40	#5	12'-2"	—
n(E)	52	#6	6'-3"	┌
p(E)	24	#5	22'-8"	—
p1(E)	20	#6	12'-2"	—
s(E)	22	#5	23'-5"	┌
s1(E)	26	#5	9'-7"	┌
u(E)	20	#5	7'-3"	┌
u1(E)	6	#5	6'-6"	┌
u2(E)	6	#6	9'-10"	┌
v(E)	38	#5	4'-5"	—
v1(E)	16	#5	4'-5"	—
v2(E)	52	#6	8'-4"	—
Structure Excavation		Cu. Yd.	90	
Concrete Structures		Cu. Yd.	34.1	
Reinforcement Bars, Epoxy Coated		Pound	4,400	
Furnishing Steel Piles, HP 12x63		Foot	149	
Driving Piles		Foot	149	
Concrete Encasement		Cu. Yd.	2.1	

For details of piles and Concrete Encasement, see sheet 11 of 12.

PILE DATA

Type: HP 12x63
Nominal Required Bearing: 444k
Factored Resistance Available: 244k
Est. Length: 21.5 ft. (Wingwall)
Est. Length: 26.5 ft. (Cap)
No. Production Piles: 6
No. Test Piles: 0