

O.R.	SECTION	COUNTY	TOTAL SHEETS	SHEET NO.
163	34B-2	JOHNSON	37	1
ILLINOIS			CONTRACT NO. 78267	

STATE OF ILLINOIS

DEPARTMENT OF TRANSPORTATION

DIVISION OF HIGHWAYS

**PROPOSED
HIGHWAY PLANS**

O.R. 163 OFF U.S. ROUTE 45 (F.A.P. 881)
SECTION 34B-2
PROJECT NO. ACF-0881 (019)
STRUCTURE REPLACEMENT OVER POND CREEK
JOHNSON COUNTY

C-99-055-11

INDEX OF SHEETS

- 1 COVER SHEET
- 2 GENERAL NOTES AND MIXTURE REQUIREMENTS
- 3-4 SUMMARY OF QUANTITIES
- 5-6 TYPICAL SECTIONS
- 7 SCHEDULE OF QUANTITIES
- 8 PLAN AND PROFILE SHEET
- 9-10 CONSTRUCTION STAGING / MAINTENANCE OF TRAFFIC SHEETS
- 11 EROSION CONTROL PLAN
- 12 RIGHT OF WAY PLANS
- 13-24 STRUCTURAL PLANS
- 25 DISTRICT DETAILS
- 26-37 ROADWAY CROSS SECTIONS

IDOT HIGHWAY STANDARDS

000001-06	701001-02
001001-02	701006-05
001006	701301-04
280001-07	701326-04
406201-01	701901-02
515001-03	B.L.R. 21-9
630001-10	B.L.R. 27-1
631011-09	
635006-03	
635011-02	
60101-01	

HIGHWAY CLASSIFICATION / TRAFFIC DATA

O.R. 163 OFF F.A.P. RTE. 881 (U.S. RTE. 45)
FUNCTIONAL CLASS: LOCAL ROAD (NON-URBAN)
DESIGN SPEED: 25 MPH
POSTED SPEED: 25 MPH
ADT: 10 (2014), 15 (2034)
DHV: 2 (2014)
0.0% TRUCKS

TOWNSHIP : BURNSIDE

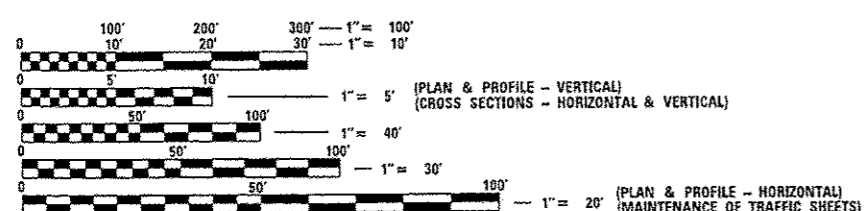

FULL SIZE PLANS HAVE BEEN PREPARED USING STANDARD ENGINEERING SCALES. REDUCED SIZED PLANS WILL NOT CONFORM TO STANDARD SCALES. IN MAKING MEASUREMENTS ON REDUCED PLANS, THE ABOVE SCALES MAY BE USED.

J.U.L.I.E.
JOINT UTILITY LOCATION INFORMATION FOR EXCAVATION
1-800-892-0123
OR 811

PROJECT MANAGER: DAVID PICHE, P.E. (618) 351-5227

CONTRACT NO. 78267

D-99-044-11



LOCATION OF SECTION INDICATED THUS: - [black rectangle] -

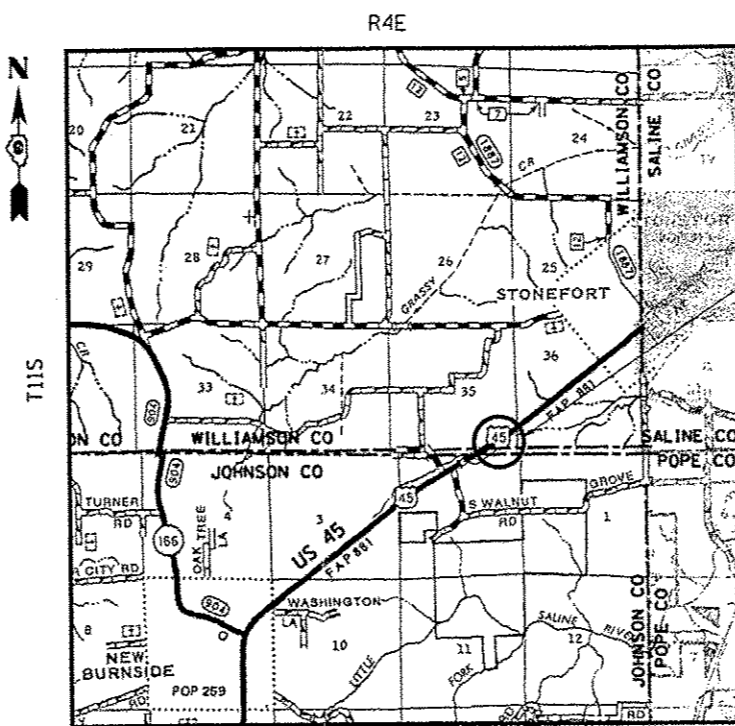

LOCATION MAP



NET LENGTH = 225.14 FT. = 0.043 MILE

PROP. S.N. 044-0062
44' LONG SINGLE SPAN PRECAST PRESTRESSED CONCRETE DECK BEAM BRIDGE (17" DEPTH) CARRYING O.R. 163 OVER POND CREEK STA. 50+91.81, 0.50% GRADE, 0° SKEW ROADWAY IMPROVEMENTS, O.R. 163 STA. 50+14.86 TO STA. 52+40.00 CHANNEL REGRADING, POND CREEK STA. 828+00.00 TO STA. 830+00.00

STATE OF ILLINOIS
DEPARTMENT OF TRANSPORTATION
DIVISION OF HIGHWAYS

SUBMITTED Jan 21 2014
Jeffrey S. Keiser
DEPUTY DIRECTOR OF HIGHWAYS, REGION ENGINEER

March 21 2014
John D. Baranzelli, P.E.
acting ENGINEER OF DESIGN AND ENVIRONMENT

March 21 2014
Omer Osman, P.E.
DIRECTOR OF HIGHWAYS, CHIEF ENGINEER

SIGNATURE: Brian M. Bond
DATE SIGNED: 12/4/13
LICENSE EXPIRATION DATE: 11/30/15

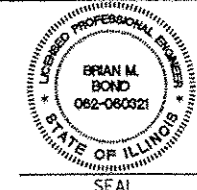

PRINTED BY THE AUTHORITY
OF THE STATE OF ILLINOIS

CMT
CRAWFORD, MURPHY & TILLY, INC.
CONSULTING ENGINEERS
License No. 184-000613