

SN 035-7030  
 PROPOSED PRECAST SINGLE  
 12' X 8' BOX CULVERT  
 50' END TO END BARREL  
 32' CLEAR WIDTH, 0° SKEW  
 @ IL 34 STA. 974+75

PROPOSED CAST-IN-PLACE  
 REINFORCED CONCRETE HEADWALL,  
 WINGWALLS, AND APRON (TYP.)

SN 035-7020  
 EXISTING 12' X 8' BOX CULVERT  
 32' END TO END BARREL  
 31'-6" CLEAR WIDTH, 0° SKEW  
 @ IL 34 STA. 974+75

DATE	
BY	
PLAN	
SURVEYED	
PLOTTED	
NOTE BOOK	
NO.	
ALIGNED	
CHECKED	
FILE NAME	

DATE	
BY	
PROFILE	
SURVEYED	
PLOTTED	
NOTE BOOK	
NO.	
GRADES CHECKED	
STRUCTURE	
NOTATIONS CHECKED	

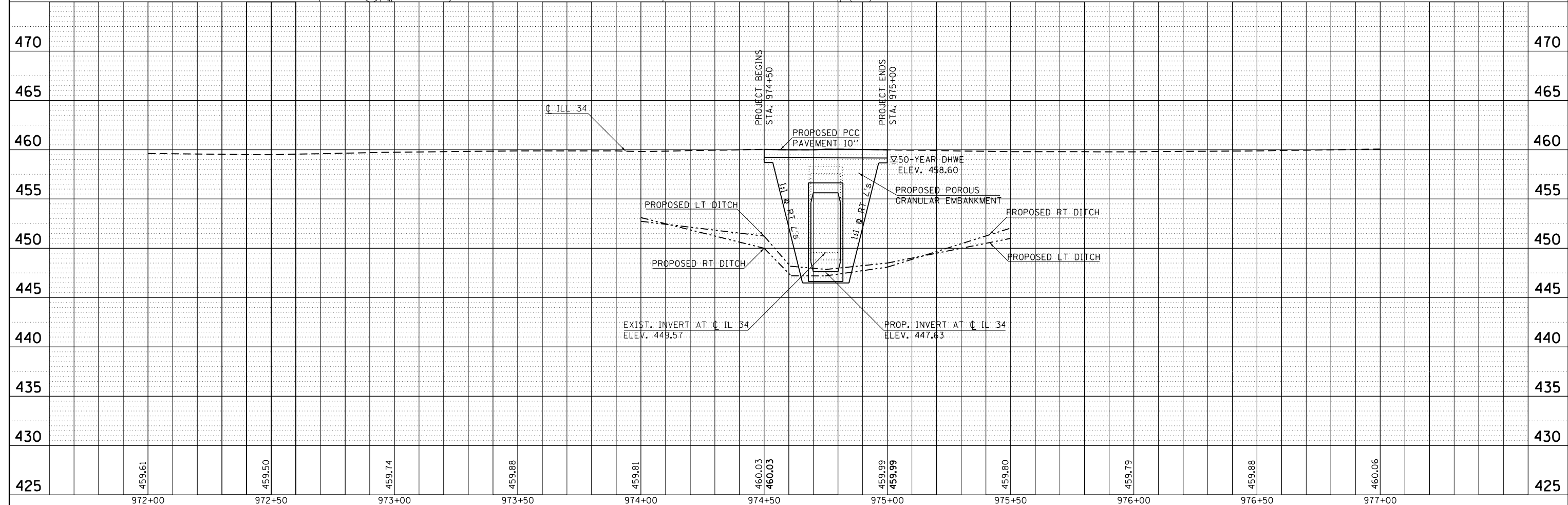
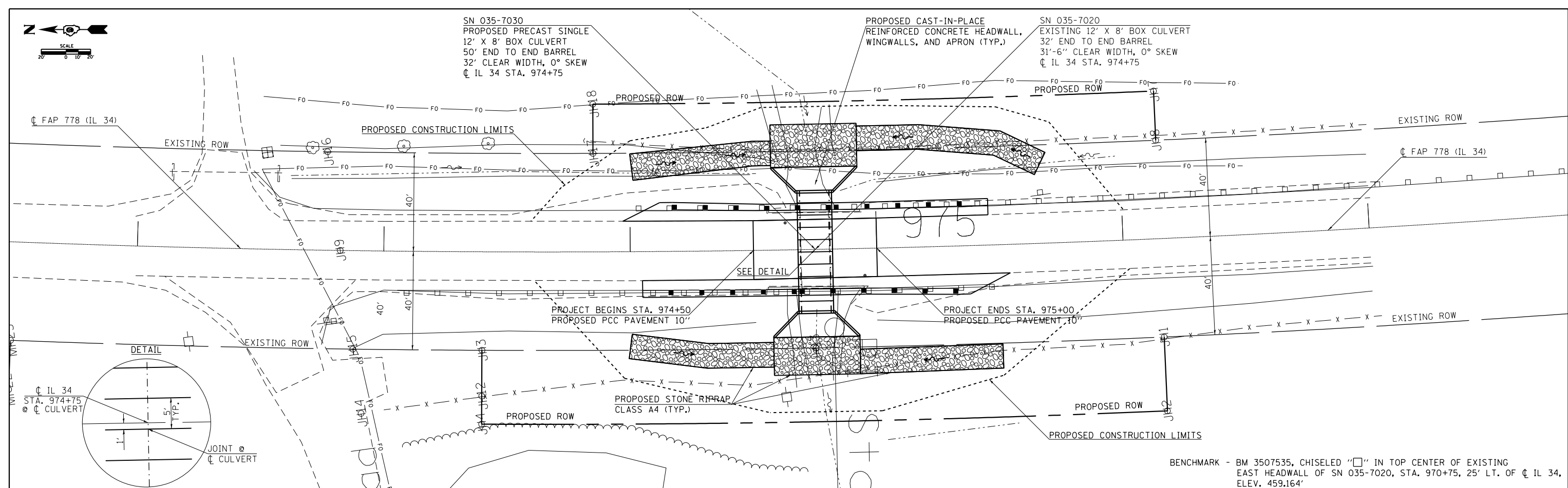

FILE NAME =	USER NAME = portercw	DESIGNED -	REVISED -	<b>STATE OF ILLINOIS DEPARTMENT OF TRANSPORTATION</b>	<b>PLAN &amp; PROFILE</b>				F.A.P. RTE.	SECTION	COUNTY	TOTAL SHEETS	SHEET NO.
c:\pwork\pwork\portercw\d0322720\78316\sh-1-plan.dgn		DRAWN -	REVISED -		778	4B-2	HARDIN	19	6				
Default		CHECKED -	REVISED -		SCALE: SHEET OF SHEETS STA. TO STA.				CONTRACT NO. 78316				
		DATE -	REVISED -		ILLINOIS FED. AID PROJECT								