

STATE OF ILLINOIS
DEPARTMENT OF TRANSPORTATION
DIVISION OF HIGHWAYS

**PROPOSED
HIGHWAY PLANS**

IL ROUTE 34 (FAP 869)
SECTION 104RS-3
PROJECT: ACF-0869 (042)
TYPE of IMPROVEMENT: PAVEMENT REPLACEMENT
SALINE COUNTY

C-99-025-14

F.A.P. RTE.	SECTION	COUNTY	TOTAL SHEETS	SHEET NO.
869	104RS-3	SALINE	21	1
		ILLINOIS	CONTRACT NO. 78401	

FOR INDEX OF SHEETS, SEE SHEET NO. 2

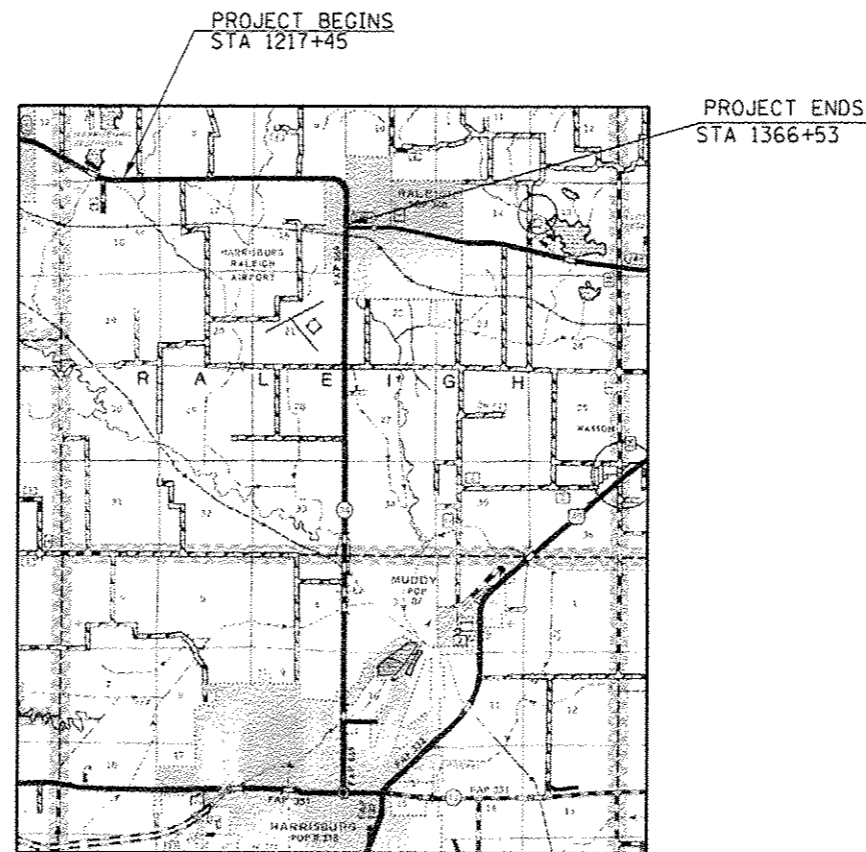
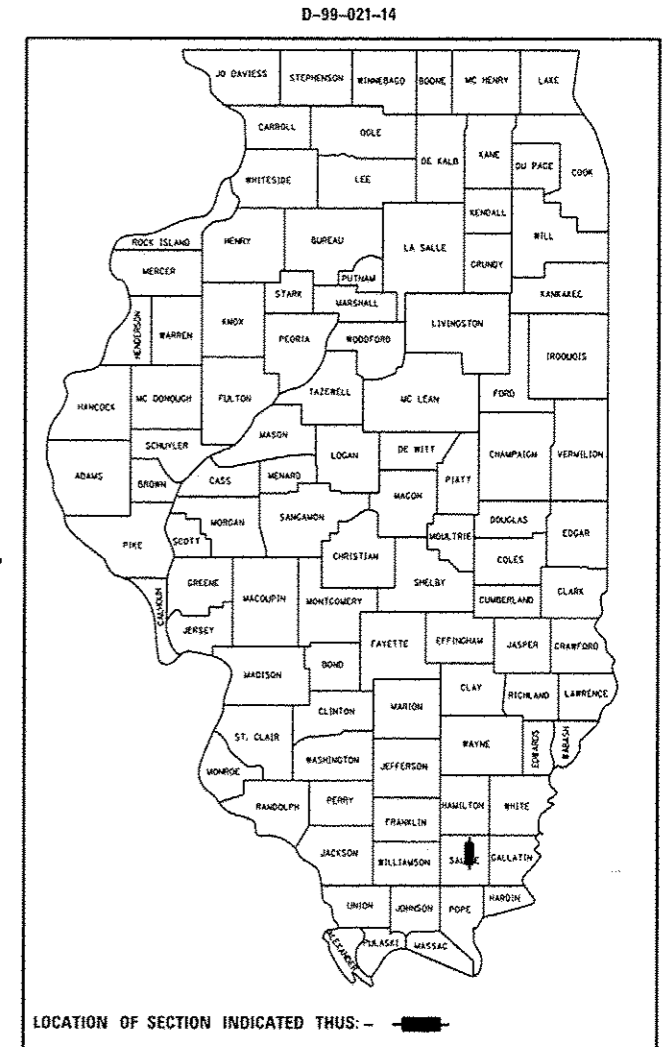

GROSS LENGTH = 14,908 FT. = 2.823 MILE

J.U.I.E.
JOINT UTILITY LOCATION INFORMATION FOR EXCAVATION
1-800-892-0123
OR 811

PROJECT ENGINEER: T. WAYNE HALSTEAD
PROJECT MANAGER: DAVID PICHE

CONTRACT NO. 78401

STATE OF ILLINOIS
DEPARTMENT OF TRANSPORTATION
DIVISION OF HIGHWAYS

SUBMITTED Jan 28 20 14

Arthur J. Keim
DEPUTY DIRECTOR OF HIGHWAYS, REGION ENGINEER

March 21 20 14
John D. Baranzelli, P.E.
ENGINEER OF DESIGN AND ENVIRONMENT

March 21 20 14
Omer Osman, P.E.
DIRECTOR OF HIGHWAYS, CHIEF ENGINEER

PRINTED BY THE AUTHORITY
OF THE STATE OF ILLINOIS

INDEX OF SHEETS

SHEET NO.	DESCRIPTION
1	COVER SHEET
2	INDEX OF SHEETS, HIGHWAY STANDARDS, GENERAL NOTES
3	MIXTURE REQUIREMENTS AND SIGNATURE SHEET
4-6	SUMMARY OF QUANTITIES
7, 8	TYPICAL SECTIONS
9	SCHEDULES
10-15	PLAN LAYOUT
16	SIDE ROAD AND ENTRANCE DETAIL
17	DETOUR SIGNING SHEET
18, 19	TRAFFIC CONTROL & PROTECTION (SPECIAL)
20	STANDARD DETAILS: TEMP HOT-MIX ASPHALT TRANSITIONS
21	STANDARD DETAILS: UNEVEN LANES SIGN

HIGHWAY STANDARDS

000001-06
001006
442201-03
482011-03
642001-02
642006
701001-02
701006-05
701011-04
701201-04
701301-04
701306-03
701311-03
701326-04
701336-06
701901-03
780001-04
781001-03

GENERAL NOTES

THE THICKNESS OF BITUMINOUS MIXTURE SHOWN ON THE PLANS IS THE NOMINAL THICKNESS. DEVIATIONS FROM THE NOMINAL THICKNESS WILL BE PERMITTED WHEN SUCH DEVIATION OCCURS DUE TO IRREGULARITIES IN THE EXISTING SURFACE OR BASE ON WHICH THE BITUMINOUS MIXTURE IS PLACED.

FACTORS USED FOR ESTIMATING PLAN QUANTITIES ARE AS FOLLOWS AND SHALL NOT BE USED FOR THE BASIS OF FINAL QUANTITIES EXCEPT FOR QC/OA OF BITUMINOUS MIXTURES:

ALL HOT-MIX ASPHALT.....2.016 TONS/CU. YD.

ALL AGGREGATE.....2.05 TONS/CU. YD.

BITUMINOUS MATERIALS (PRIME COAT)

ON PAVEMENT...0.09 GALS/SQ. YD.

AGGREGATE (PRIME COAT).....0.0015 TONS/SQ. YD.

WEIGHT OF EARTH TO DETERMINE LIME.....2835 LB/CU. YD.

THE QUANTITY OF SHORT TERM PAVEMENT MARKING SHOWN IN THE PLANS WAS BASED ON ONE APPLICATION EACH FOR THE HMA SURFACE COURSE AND HMA BINDER AT THE RESURFACING LIMITS.

PRIOR TO PLACEMENT OF THE FINAL PAVEMENT MARKINGS, THE RESIDENT ENGINEER SHALL CONTACT THE BUREAU OF OPERATIONS AND ARRANGE FOR INSPECTION AND APPROVAL OF THE PAVEMENT MARKING LAYOUT.

THE CONTRACTOR SHALL STAMP STATIONING IN THE PROPOSED FULL DEPTH PAVEMENT OR HMA RESURFACING AT 300 FT. INTERVALS ON ALTERNATING SIDES OF THE PAVEMENT AND AS DIRECTED BY THE ENGINEER. THE STATION SYMBOL STAMPS USED SHALL BE FURNISHED BY THE CONTRACTOR. THEY SHALL BE 5 1/2" TALL OF A DESIGN APPROVED BY THE ENGINEER AND SHALL REMAIN THE PROPERTY OF THE CONTRACTOR.

UNLESS OTHERWISE DIRECTED BY THE ENGINEER, HMA RESURFACING SHALL BE PLACED IN A SEQUENCE THAT WILL MINIMIZE THE TIME THE CENTER -LINE EDGE IS EXPOSED TO TRAFFIC.

QUANTITIES SHOWN IN THE PLANS FOR PATCHING ARE ESTIMATES. THE ACTUAL AMOUNT OF PATCHING REQUIRED SHALL BE DETERMINED BY THE ENGINEER IN THE FIELD. THE PATCHING SURVEY DATE WAS ON 1/14/14

RECLAIMED ASPHALT PAVEMENT (RAP WILL NOT BE ALLOWED FOR USE AS AGGREGATE IN AGGREGATE WEDGE SHOULDERS, TYPE B.

THE SPACING ON THE RAISED REFLECTIVE PAVEMENT MARKERS SHALL BE REDUCED TO 40' FROM STATION 1335+00 TO 1352+50.

THE QUANTITY FOR THE MATERIAL TRANSFER DEVICE IS FOR EVERYTHING EXCEPT THE HMA SHOULDER, 12' AND INCIDENTAL HMA SURFACING.

THE CONTRACTOR HAS THE OPTION OF SUBSTITUTING SUBBASE GRANULAR MATERIAL, TYPE A, 14" FOR PROCESSING MODIFIED SOIL 14" AT NO ADDITIONAL COMPENSATION WILL BE ALLOWED.

THE ENGINEER IS TO CONTACT SCOTT STOKES WITH D9 TRAFFIC NEAR THE END OF THE PROJECT TO INSTALL NEW CHEVRONS AROUND THE CURVE ON IL 34.

COMMITMENT:

THERE IS A L.O.U. BETWEEN IDOT AND SALINE COUNTY, THE RE SHALL REVIEW AND COMPLY WITH THE CONTENTS OF THIS UNDERSTANDING. HARCO ROAD TO BE SIGNED AS A DETOUR FOR N.B. IL 34 TRAFFIC DURING STAGE II WORK ONLY. THIS DETOUR SHALL ONLY BE USED FOR 40 CONSECUTIVE CALENDER DAYS. HARCO ROAD HAS A 20 TON LOAD RESTRICTION.

FILE NAME :	USER NAME : halsteadw	DESIGNED -	REVISED -	STATE OF ILLINOIS DEPARTMENT OF TRANSPORTATION	INDEX OF SHEETS, HIGHWAY STDS, & GENERAL NOTES	F.A.P. RTE.	SECTION	COUNTY	TOTAL SHEETS	SHEET NO.	
c:\p\work\p10dot\halsteadw\0373650\78481-Design.dgn	DRAWN -	REVISED -	869			ID4RS-3	SALINE	21	2		
PLOT SCALE = 100.0000' / 1" =	CHECKED -	REVISED -	CONTRACT NO. 78401								
Default	DATE -	REVISED -	ILLINOIS FED. AID PROJECT								
						SCALE:	SHEET	OF	SHEETS	STA.	TO STA.

MIXTURE REQUIREMENTS

Location(s):	Hot-Mix Asphalt Surface Course
Mixture Use(s):	Polymer Hot-Mix Asphalt Surface Course, Mix D, N90
AC/PG:	SBS PG76-22
RAP % (Max):	See Special Provisions
Design Air Voids:	4.0 %, 90 Gyration Design
Mixture Composition: (Gradation Mixture)	IL-9.5 mm
Friction Aggregate:	D Surface

Location(s):	Hot-Mix Asphalt Binder Course (Lower Lifts), Hot-Mix Asphalt Shoulder
Mixture Use(s):	Hot-Mix Asphalt Binder Course, N90, IL-19.0 Fine Grade
AC/PG:	PG64-22
RAP % (Max):	See Special Provision
Design Air Voids:	4.0 %, 90 Gyration Design
Mixture Composition: (Gradation Mixture)	IL-19.0 mm Face Grade
Friction Aggregate:	None

Location(s):	Hot-Mix Asphalt Binder Course (Top Lift)
Mixture Use(s):	Polymer Hot-Mix Asphalt Binder Course, N90, IL-19.0.0mm Fine Grade
AC/PG:	SBS PG76-22
RAP % (Max):	See Special Provisions
Design Air Voids:	4.0 %, 90 Gyration Design
Mixture Composition: (Gradation Mixture)	IL-19.0 Fine Grade
Friction Aggregate:	None

Location(s):	Incidental Hot-Mix Asphalt Surfacing
Mixture Use(s):	Hot-Mix Asphalt Surface Course, Mix C, N90
AC/PG:	PG64-22
RAP % (Max):	See Special Provisions
Design Air Voids:	4.0 %, 90 Gyration Design
Mixture Composition: (Gradation Mixture)	IL-9.5mm
Friction Aggregate:	C Surface

Prepared By:	<i>Joe Zambicini</i> DISTRICT STUDIES & PLANS ENGINEER
Examined By:	<i>John G.</i> DISTRICT LAND ACQUISITION ENGINEER
Examined By:	<i>Carmie Nelson</i> DISTRICT PROGRAM DEVELOPMENT ENGINEER
Examined By:	<i>Carl M.</i> DISTRICT OPERATIONS ENGINEER
Examined By:	<i>Chris</i> DISTRICT PROJECT IMPLEMENTATION ENGINEER
Examined By:	<i>Daryl J. Wenzel</i> DISTRICT CONSTRUCTION ENGINEER
Examined By:	<i>Bruce</i> DISTRICT MATERIALS ENGINEER

FILE NAME *	USER NAME * Dahmer,ja	DESIGNED -	REVISED -
c:\pwwork\pwwork\dahmer,ja\d0373650\784	01-Design.dgn	DRAWN -	REVISED -
Default	PLOT SCALE * 1/8"=1'-0" / in.	CHECKED -	REVISED -
	PLOT DATE * 1/22/2014	DATE -	REVISED -

**STATE OF ILLINOIS
DEPARTMENT OF TRANSPORTATION**

**SIGNATURE SHEET
& MIX REQUIREMENTS**

F.A.P. RTE.	SECTION	COUNTY	TOTAL SHEETS	SHEET NO.
869	104RS-3	SALINE	21	3
				CONTRACT NO. 78401
ILLINOIS FED. AID PROJECT				

SCALE: SHEET OF SHEETS STA. TO STA.

SUMMARY OF QUANTITIES

CODE NUMBER	ITEM DESCRIPTION	UNIT	80% FED 20% STATE
			STP
			FAP 869 IL 34
			ROADWAY 0004
20101400	NITROGEN FERTILIZER NUTRIENT	POUND	315
20101500	PHOSPHORUS FERTILIZER NUTRIENT	POUND	315
20101600	POTASSIUM FERTILIZER NUTRIENT	POUND	315
20200100	EARTH EXCAVATION	CU YD	4365
25000200	SEEDING, CLASS 2	ACRE	3.5
25000700	AGRICULTURAL GROUND LIMESTONE	TON	7
25100115	MULCH, METHOD 2	ACRE	3.5
28000250	TEMPORARY EROSION CONTROL SEEDING	POUND	3500
30200750	PROCESSING MODIFIED SOIL 14"	SQ YD	27884
30201500	LIME	TON	769
40201000	AGGREGATE FOR TEMPORARY ACCESS	TON	430
X4060115	POLYMERIZED BITUMINOUS MATERIALS (PRIME COAT)	POUND	51563
40600982	HOT-MIX ASPHALT SURFACE REMOVAL - BUTT JOINT	SQ YD	566
40600990	TEMPORARY RAMP	SQ YD	51

SUMMARY OF QUANTITIES - CONT

80% FED 20% STATE
RURAL
FAP 869
IL 34
ROADWAY
0004

CODE NUMBER	ITEM DESCRIPTION	UNIT	QUANTITY
40603243	POLYMERIZED HOT-MIX ASPHALT BINDER COURSE, IL-19.0, FG, N90	TON	3190
40603545	POLYMERIZED HOT-MIX ASPHALT SURFACE COURSE, MIX "D", N90	TON	2096
40702001	HOT-MIX ASPHALT PAVEMENT (FULL-DEPTH), 16"	SQ YD	25957
40800050	INCIDENTAL HOT-MIX ASPHALT SURFACING	TON	103
44000100	PAVEMENT REMOVAL	SQ YD	21534
44000164	HOT-MIX ASPHALT SURFACE REMOVAL, 3 3/4"	SQ YD	25106
44201789	CLASS D PATCHES, TYPE II, 12 INCH	SQ YD	518
44201794	CLASS D PATCHES, TYPE III, 12 INCH	SQ YD	90
48102100	AGGREGATE WEDGE SHOULDER, TYPE B	TON	12
48203045	HOT-MIX ASPHALT SHOULDERS, 12"	SQ YD	3316
64200116	SHOULDER RUMBLE STRIPS, 16 INCH	FOOT	3245
67000400	ENGINEER'S FIELD OFFICE, TYPE A	CAL MD	6
67100100	MOBILIZATION	L SUM	1
70100450	TRAFFIC CONTROL AND PROTECTION, STANDARD 701201	L SUM	1

SUMMARY OF QUANTITIES - CONT

80% FED 20% STATE
RURAL
FAP 869 IL 34
ROADWAY 0004

CODE NUMBER	ITEM DESCRIPTION	UNIT	QUANTITY
70100460	TRAFFIC CONTROL AND PROTECTION, STANDARD 701306	L SUM	1
70100500	TRAFFIC CONTROL AND PROTECTION, STANDARD 701326	L SUM	1
70100600	TRAFFIC CONTROL AND PROTECTION, STANDARD 701336	L SUM	1
70103815	TRAFFIC CONTROL SURVEILLANCE	CAL DA	40
70106800	CHANGEABLE MESSAGE SIGN	CAL MO	2
70300100	SHORT TERM PAVEMENT MARKING	FOOT	2982
70301000	WORK ZONE PAVEMENT MARKING REMOVAL	SQ FT	994
* 78001110	PAINT PAVEMENT MARKING - LINE 4"	FOOT	46149
* 78100100	RAISED REFLECTIVE PAVEMENT MARKER	EACH	209
78300100	PAVEMENT MARKING REMOVAL	SQ FT	5228
78300200	RAISED REFLECTIVE PAVEMENT MARKER REMOVAL	EACH	201
X0326697	CENTER LINE - RUMBLE STRIP - 8"	FOOT	1750
X2020110	GRADING AND SHAPING SHOULDERS	UNIT	288
X7010216	TRAFFIC CONTROL AND PROTECTION, (SPECIAL)	L SUM	1
Z0016702	DETOUR SIGNING	L SUM	1
Z0034105	MATERIAL TRANSFER DEVICE	TON	28525

* SPECIALTY ITEM

FILE NAME :	USER NAME : halsteadw	DESIGNED -	REVISED -	STATE OF ILLINOIS DEPARTMENT OF TRANSPORTATION	SUMMARY OF QUANTITIES	F.A.P. RTE.	SECTION	COUNTY	TOTAL SHEETS	SHEET NO.
e:\pwork\pwork\halsteadw\0373650\78401-Design.dgn		DRAWN -	REVISED -			869	104RS-3	SALINE	21	6
Default	PLOT SCALE = 100.0000' / 1"	CHECKED -	REVISED -		SCALE:					
	PLOT DATE = 1/28/2014	DATE -	REVISED -		SHEET	OF	SHEETS	STA.	TO	STA.
										ILLINOIS FED. AID PROJECT
										CONTRACT NO. 7B401

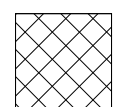
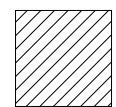
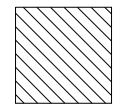
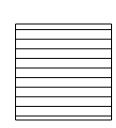
-  PAVEMENT REMOVAL
-  EARTH EXCAVATION
-  PROCESSED MODIFIED SOIL
-  GRADING AND SHAPING SHOULDERS

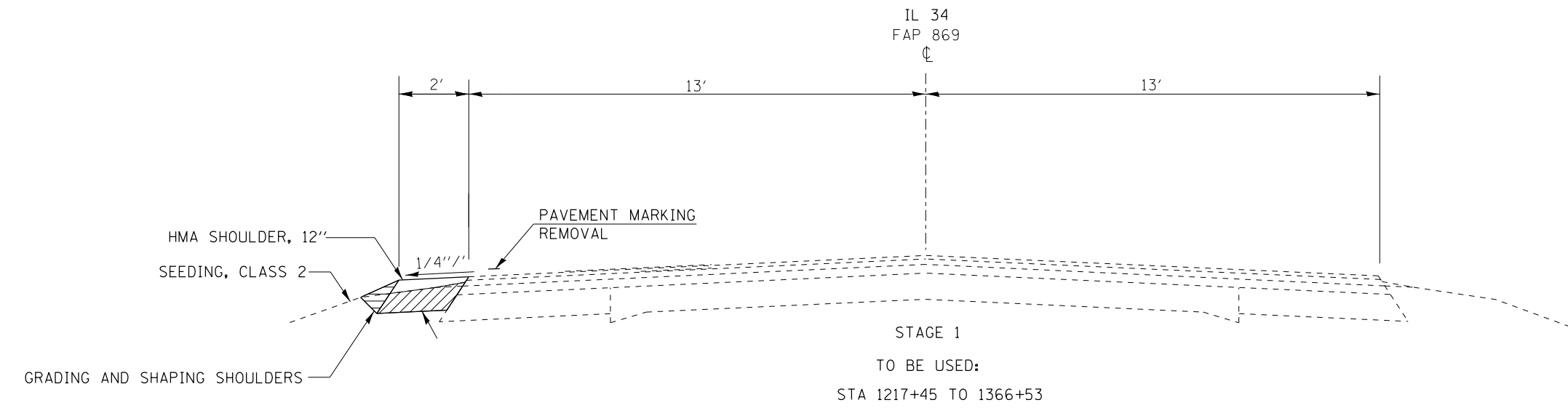
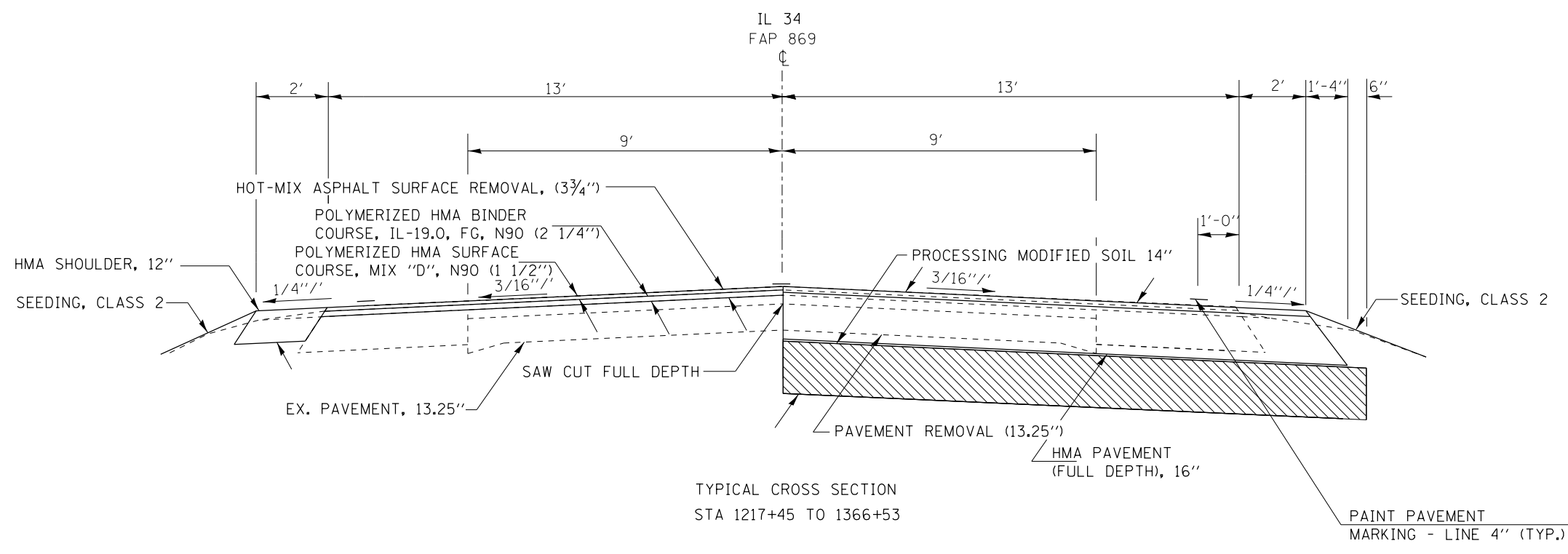

ALL SECTIONS LOOKING UP STATION

FILE NAME =	USER NAME = halsteadtw	DESIGNED -	REVISED -	STATE OF ILLINOIS DEPARTMENT OF TRANSPORTATION	TYPICAL SECTIONS				F.A.P. RTE.	SECTION	COUNTY	TOTAL SHEETS	SHEET NO.		
		DRAWN -	REVISED -		SCALE:	SHEET	OF	SHEETS	STA.	TO STA.	869	104RS-3	SALINE	21	7
		CHECKED -	REVISED -						CONTRACT NO. 78401						
Default	PLOT DATE = 1/28/2014	DATE -	REVISED -		ILLINOIS FED. AID PROJECT										

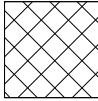
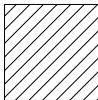
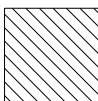
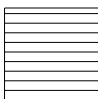
-  PAVEMENT REMOVAL
-  EARTH EXCAVATION
-  PROCESSED MODIFIED SOIL
-  GRADING AND SHAPING SHOULDERS

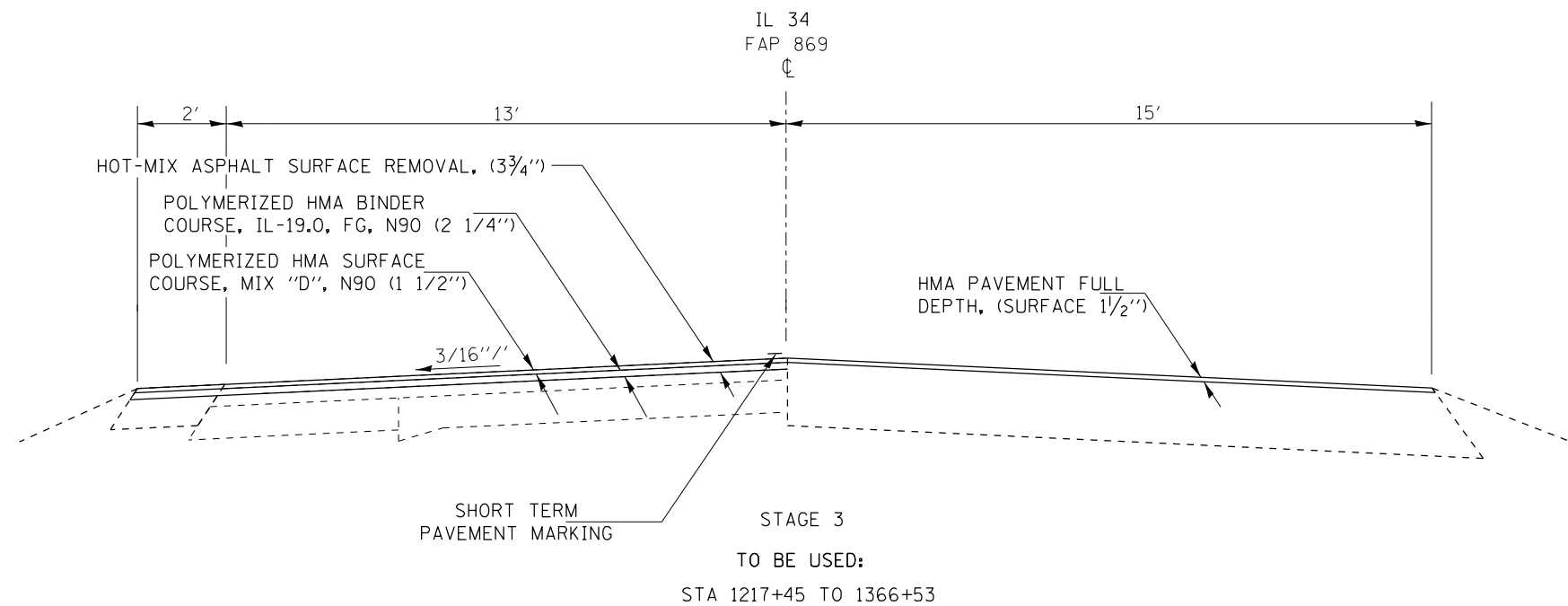
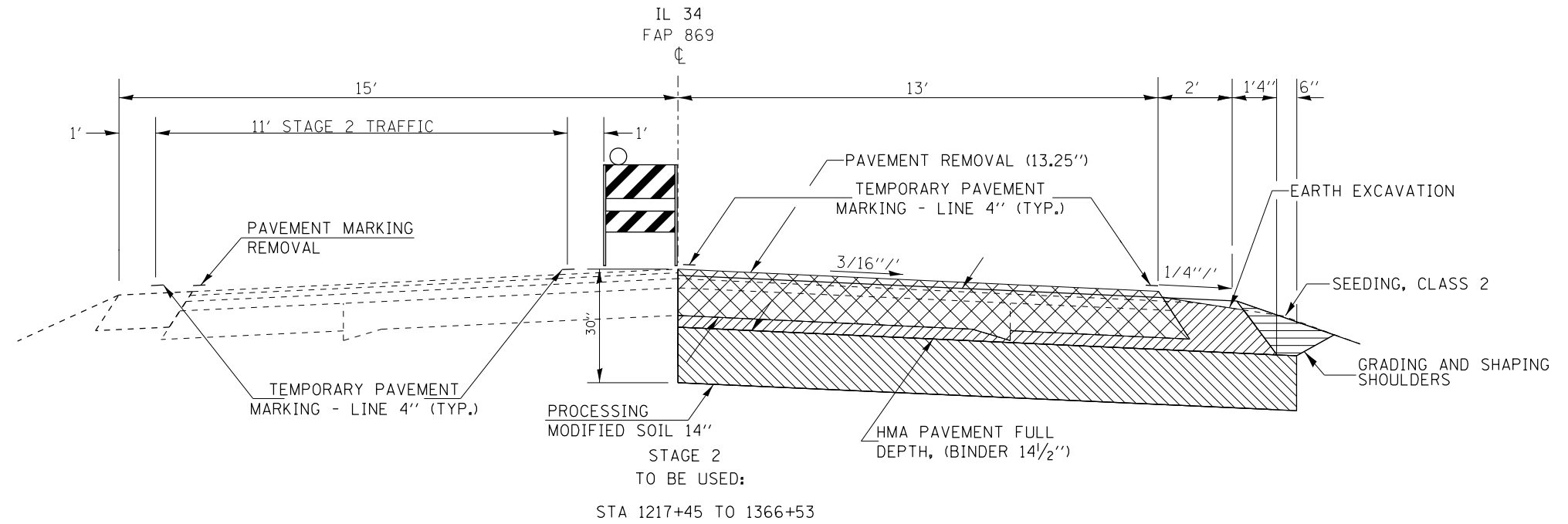

ALL SECTIONS LOOKING UP STATION

FILE NAME =	USER NAME = halsteadtw	DESIGNED -	REVISED -	STATE OF ILLINOIS DEPARTMENT OF TRANSPORTATION	TYPICAL SECTIONS				F.A.P. RTE.	SECTION	COUNTY	TOTAL SHEETS	SHEET NO.		
c:\pwork\pwork\halsteadtw\d0373650\78401-Design.dgn		DRAWN -	REVISED -		SCALE:	SHEET	OF	SHEETS	STA.	TO STA.	869	104RS-3	SALINE	21	8
Default	PLOT SCALE = 100.0000' / in.	CHECKED -	REVISED -												
	PLOT DATE = 1/28/2014	DATE -	REVISED -												

ILLINOIS FED. AID PROJECT

PAVEMENT MARKING & MISC

STATION TO STATION				PAINT PAVT MARKING - LINE 4''			TEMP PAVT MARKING - LINE 4'' (INFO ONLY)	PAVEMENT MARKING REMOVAL	SHLDR RUMBLE STRIPS, 16 INCH	CENTER LINE - RUMBLE STRIP - 8''	SHORT TERM PAVEMENT MARKING	WORKZONE PAVEMENT MARKING REMOVAL
				4 INCH WHITE	4 INCH YELLOW	4 INCH SKIP-DASH						
	1209+00	TO	1267+72			1,469						
	1273+95	TO	1310+64			918						
	1318+52	TO	1328+55			251						
	1329+82	TO	1340+21			260						
	1347+60	TO	1366+53			474						
CENTER LINE	1217+45	TO	1366+53				29,816			2,982		994
CENTER LINE	1209+00	TO	1215+00				600					
CENTER LINE	1366+53	TO	1368+28				175					
LEFT (EL)	1217+45	TO	1366+53	14,908			14,908	14,908				
LEFT (NPZ)	1217+45	TO	1219+00			155						
LEFT (NPZ)	1246+97	TO	1255+31			834						
LEFT (NPZ)	1267+72	TO	1285+51			1,779						
LEFT (NPZ)	1310+64	TO	1329+82			1,918						
LEFT (NPZ)	1340+21	TO	1358+32			1,811						
RIGHT (EL)	1217+45	TO	1366+53	14,908			14,908					
RIGHT (NPZ)	1235+78	TO	1245+12			934						
RIGHT (NPZ)	1256+58	TO	1273+95			1,737						
RIGHT (NPZ)	1300+30	TO	1318+52			1,822						
RIGHT (NPZ)	1328+55	TO	1347+60			1,905						
RIGHT (NPZ)	1365+87	TO	1366+53			66						
LEFT	1335+00	TO	1352+50					1,774				
RIGHT	1335+00	TO	1352+50					1,726				
CENTER LINE	1335+00	TO	1352+50						1,750			
SUB-TOTALS				29,816	12,961	3,372	59,632	5,228	3,500	1,750	2,982	994

EXISTING CULVERTS

LOCATION	EXISTING FILL HEIGHT OVER CULVERT	APPROVED FOR MTD CROSSING	NOTES
	FOOT		
IL 34			
SN 083-7013 (STA 1229+22)	2	YES	16" HMA PAVEMENT WITH ±8" OF PROCESSED MODIFIED SOIL
SN 083-7014 (STA 1252+50)	1	YES	±12" HMA PAVEMENT ONLY
SN 083-7015 (STA 1262+14)	4.7	YES	NORMAL TYPICAL SECTION
SN 083-7016 (STA 1295+60)	5	YES	NORMAL TYPICAL SECTION
SN 083-7017 (STA 1337+17)	2.6	YES	NORMAL TYPICAL SECTION
SN 083-7018 (STA 1360+24)	0.7	YES	±8.5" HMA PAVEMENT ONLY



CONVEYOR BELT CROSSING
STA. 1216+52.7

C.E. STA 1217+21
AGG

PROJECT BEGINS
STA. 1217+45

CL IL 34
FAP 869

HARRISBURG LAKE RD
STA 1224+55 (EXIST HMA)
(13.5 TONS INC. HMA SURF.)

1215+00

1220+00

1225+00

C.E. STA 1217+11
PCC

F.E. STA 1228+00

SN 083-7013
(STA 1229+22)



CL IL 34
FAP 869

F.E. STA 1245+14

1230+00

1235+00

1240+00

1245+00

F.E. STA 1238+14

F.E. STA 1239+09

F.E. STA 1242+37

FILE NAME =	USER NAME = halsteadtw	DESIGNED -	REVISED -
c:\pw\work\p\dot\halsteadtw\d0373650\78401-Design.dgn		DRAWN -	REVISED -
Default	PLOT SCALE = 100.0000' / in.	CHECKED -	REVISED -
	PLOT DATE = 1/28/2014	DATE -	REVISED -

STATE OF ILLINOIS
DEPARTMENT OF TRANSPORTATION

PLAN SHEET

SCALE: SHEET OF SHEETS STA. 1215+00 TO STA. 1245+00

F.A.P. RTE.	SECTION	COUNTY	TOTAL SHEETS	SHEET NO.
869	104RS-3	SALINE	21	10
CONTRACT NO. 78401				
ILLINOIS FED. AID PROJECT				

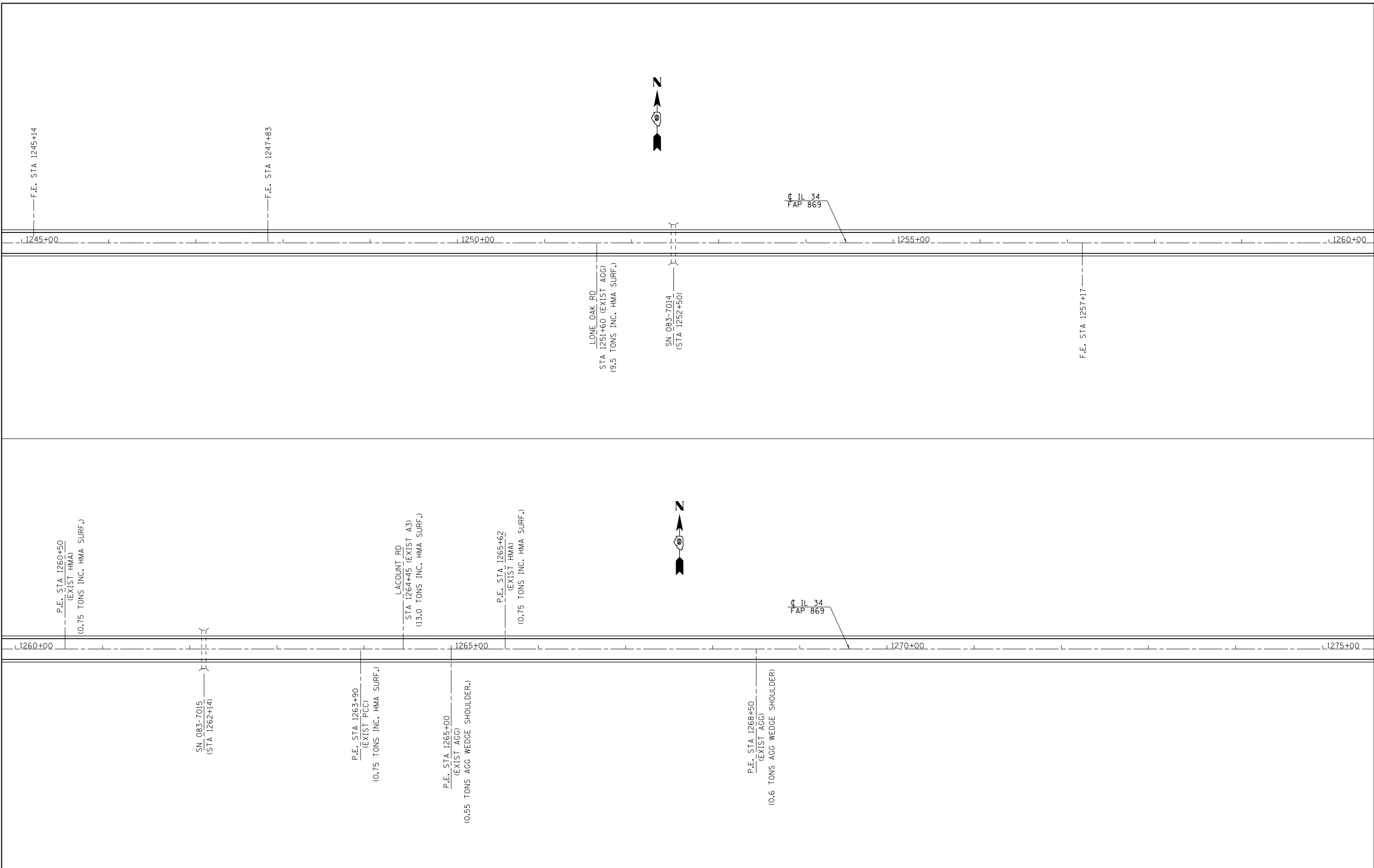

FILE NAME =	USER NAME = halsteadtw	DESIGNED -	REVISED -
c:\pw\work\p\dot\halsteadtw\d0373650\78401-Design.dgn		DRAWN -	REVISED -
Default	PLOT SCALE = 100.0000' / in.	CHECKED -	REVISED -
	PLOT DATE = 1/28/2014	DATE -	REVISED -

**STATE OF ILLINOIS
DEPARTMENT OF TRANSPORTATION**

PLAN SHEET

SCALE: SHEET OF SHEETS STA. 1245+00 TO STA. 1275+00

F.A.P. RTE.	SECTION	COUNTY	TOTAL SHEETS	SHEET NO.
869	104RS-3	SALINE	21	11
CONTRACT NO. 78401				
ILLINOIS FED. AID PROJECT				

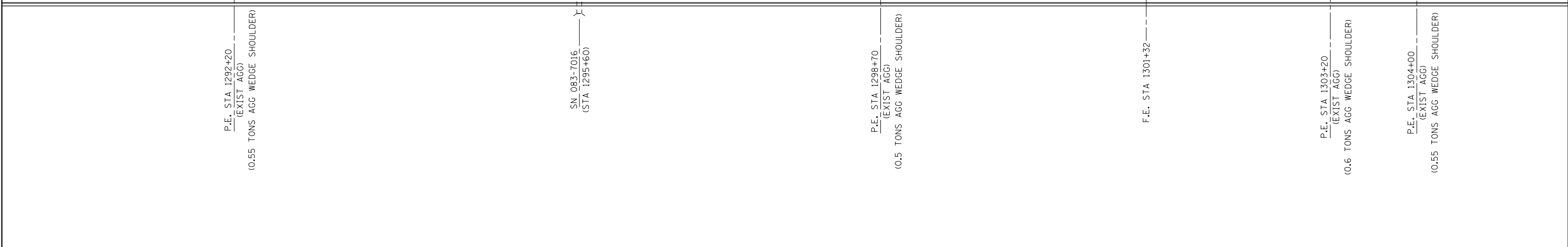
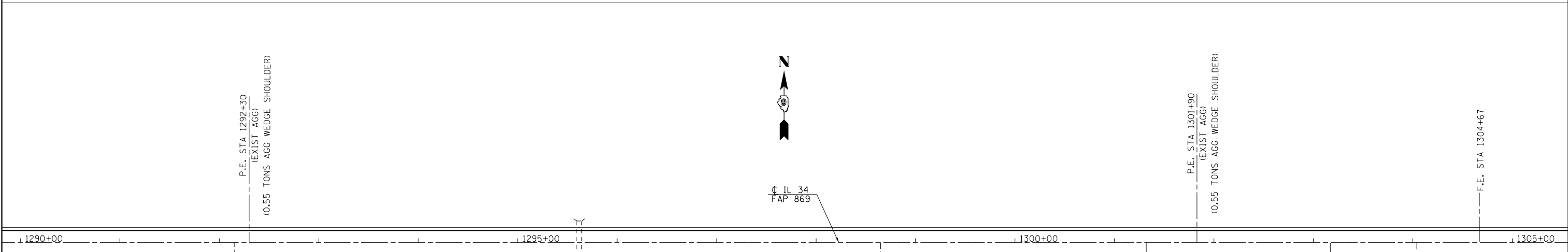
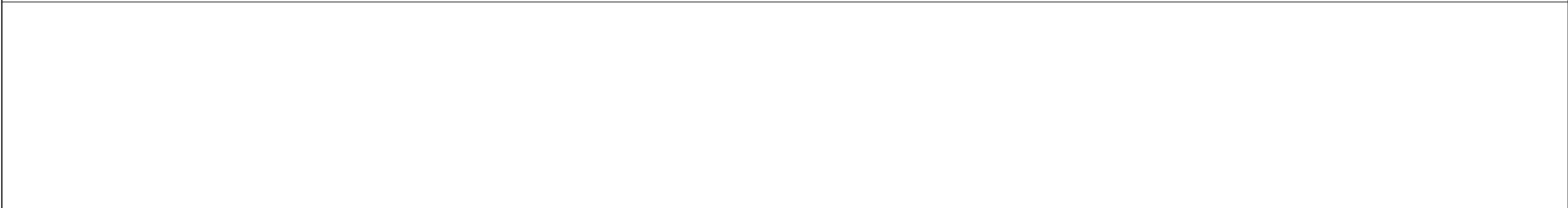
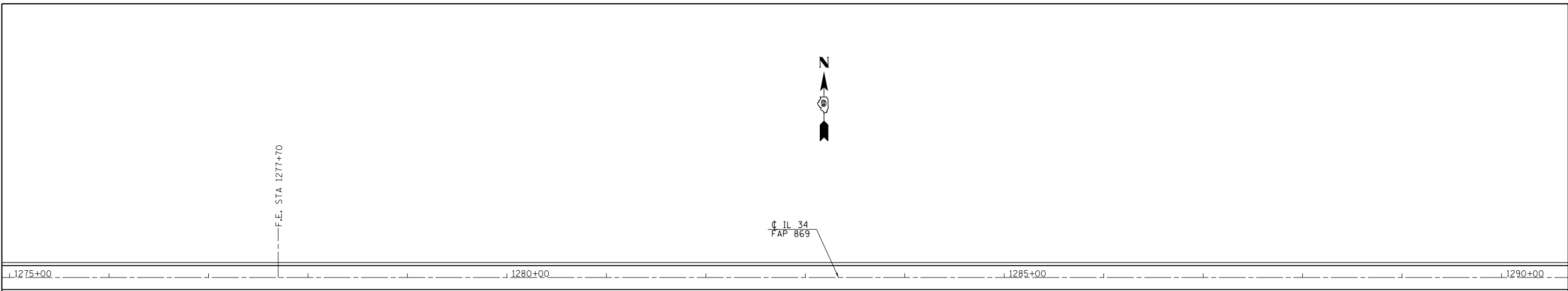

FILE NAME =	USER NAME = halsteadtw	DESIGNED -	REVISED -
Default	Default	DRAWN -	REVISED -
	PLOT SCALE = 100.0000' / 1in.	CHECKED -	REVISED -
	PLOT DATE = 1/28/2014	DATE -	REVISED -

**STATE OF ILLINOIS
DEPARTMENT OF TRANSPORTATION**

PLAN SHEET

SCALE: SHEET OF SHEETS STA. 1275+00 TO STA. 1305+00

F.A.P. RTE.	SECTION	COUNTY	TOTAL SHEETS	SHEET NO.
869	104R5-3	SALINE	21	12
CONTRACT NO. 78401				
ILLINOIS FED. AID PROJECT				

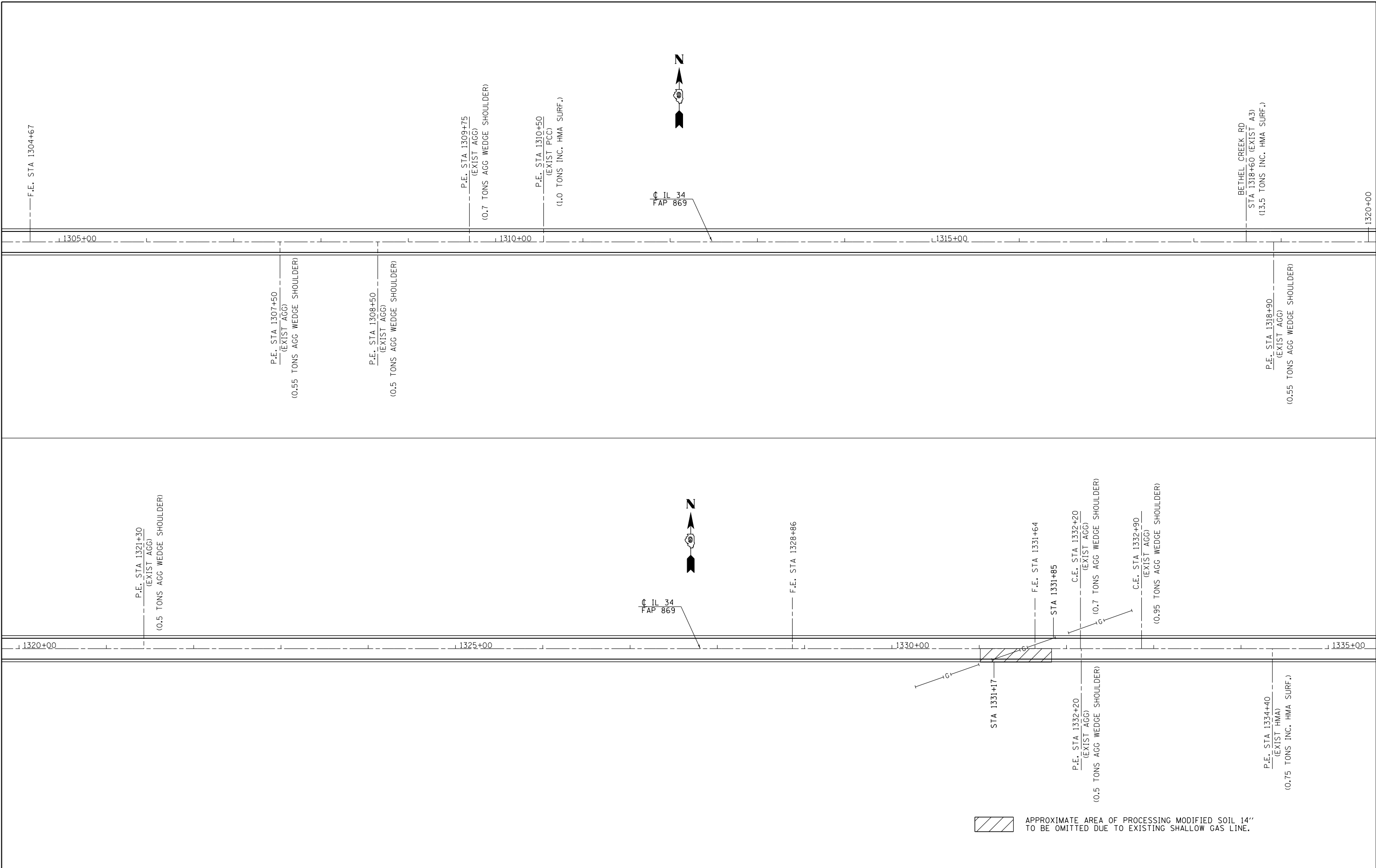

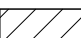
 APPROXIMATE AREA OF PROCESSING MODIFIED SOIL 14" TO BE OMITTED DUE TO EXISTING SHALLOW GAS LINE.

FILE NAME =	USER NAME = halsteadtw	DESIGNED -	REVISED -
Default	Default	DRAWN -	REVISED -
	PLOT SCALE = 100.0000' / in.	CHECKED -	REVISED -
	PLOT DATE = 1/28/2014	DATE -	REVISED -

**STATE OF ILLINOIS
DEPARTMENT OF TRANSPORTATION**

PLAN SHEET			
SCALE:	SHEET	OF	SHEETS
			STA. 1305+00 TO STA. 1335+00

F.A.P. RTE.	SECTION	COUNTY	TOTAL SHEETS	SHEET NO.
869	104R5-3	SALINE	21	13
CONTRACT NO. 78401				
ILLINOIS FED. AID PROJECT				

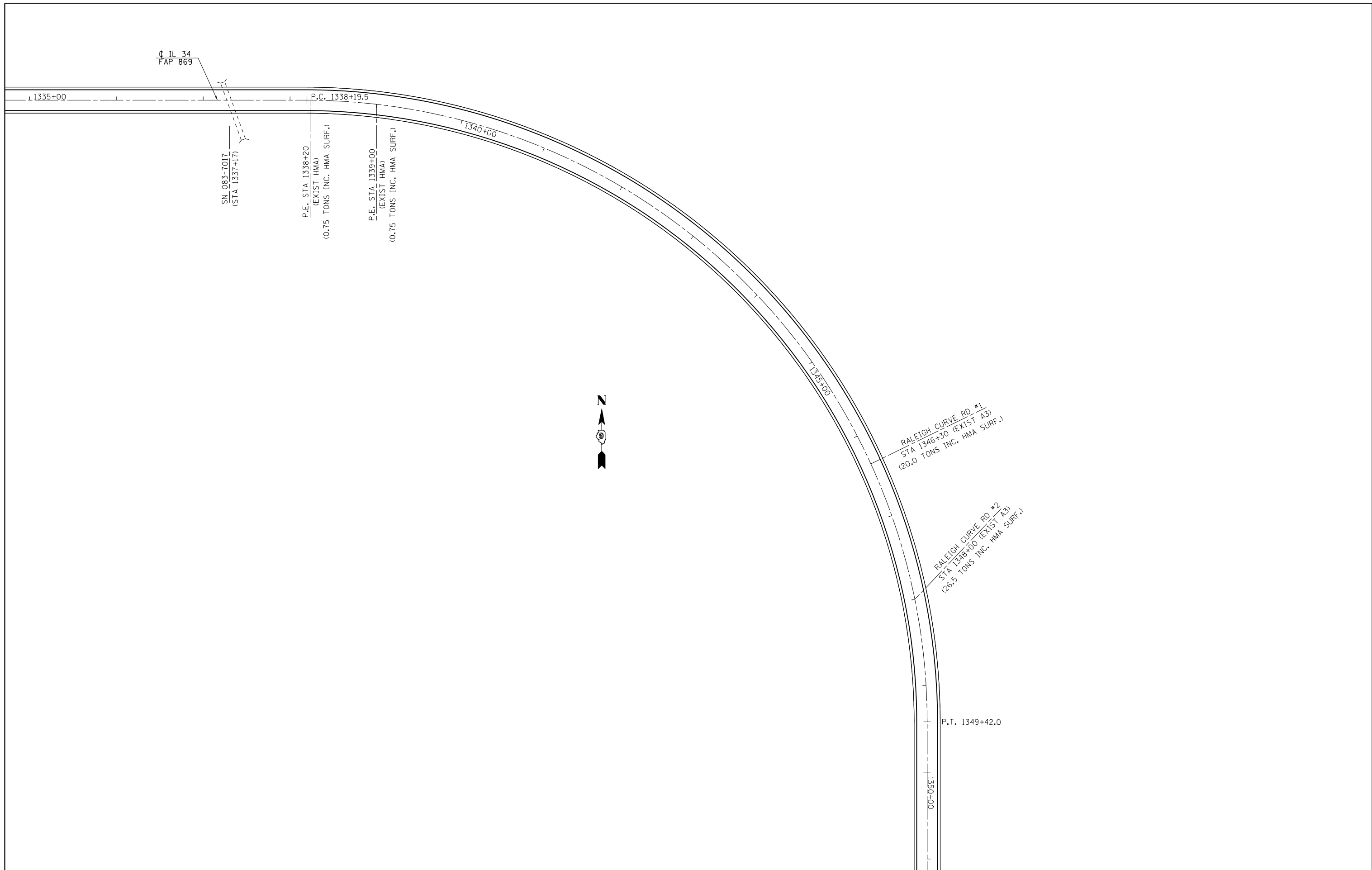

FILE NAME =	USER NAME = halsteadtw	DESIGNED -	REVISED -
c:\pw\work\p\dot\halsteadtw\d0373650\78401-Design.dgn		DRAWN -	REVISED -
Default	PLOT SCALE = 100.0000' / in.	CHECKED -	REVISED -
	PLOT DATE = 1/28/2014	DATE -	REVISED -

**STATE OF ILLINOIS
DEPARTMENT OF TRANSPORTATION**

PLAN SHEET

SCALE: SHEET OF SHEETS STA. 1335+00 TO STA. 1351+00

F.A.P. RTE.	SECTION	COUNTY	TOTAL SHEETS	SHEET NO.
869	104RS-3	SALINE	21	14
CONTRACT NO. 78401				
ILLINOIS FED. AID PROJECT				

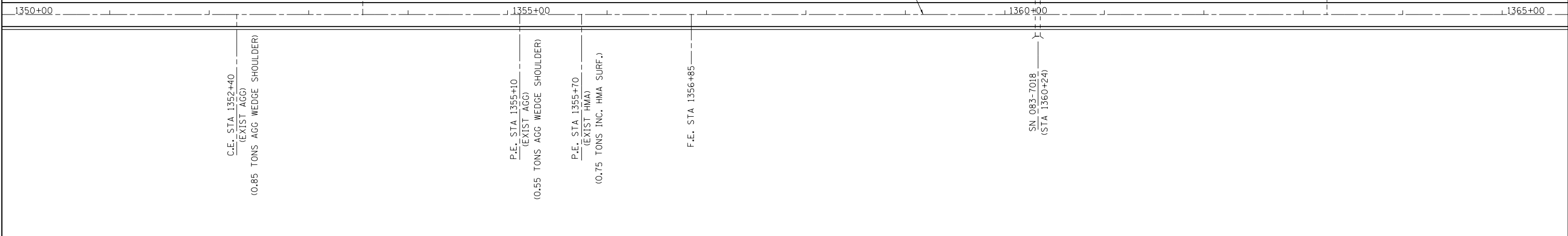
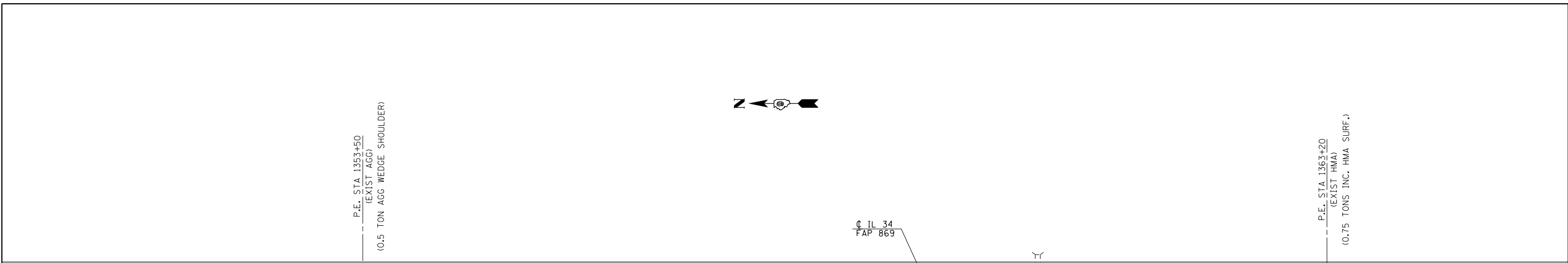

FILE NAME =	USER NAME = halsteadtw	DESIGNED -	REVISED -
c:\pw\work\p\dot\halsteadtw\d0373650\78401-Design.dgn		DRAWN -	REVISED -
Default	PLOT SCALE = 100.0000' / in.	CHECKED -	REVISED -
	PLOT DATE = 1/28/2014	DATE -	REVISED -

**STATE OF ILLINOIS
DEPARTMENT OF TRANSPORTATION**

PLAN SHEET

SCALE: SHEET OF SHEETS STA. 1350+00 TO STA. 1380+00

F.A.P. RTE.	SECTION	COUNTY	TOTAL SHEETS	SHEET NO.
869	104RS-3	SALINE	21	15
CONTRACT NO. 78401				
ILLINOIS FED. AID PROJECT				

SIDEROAD AND ENTRANCE DETAILS

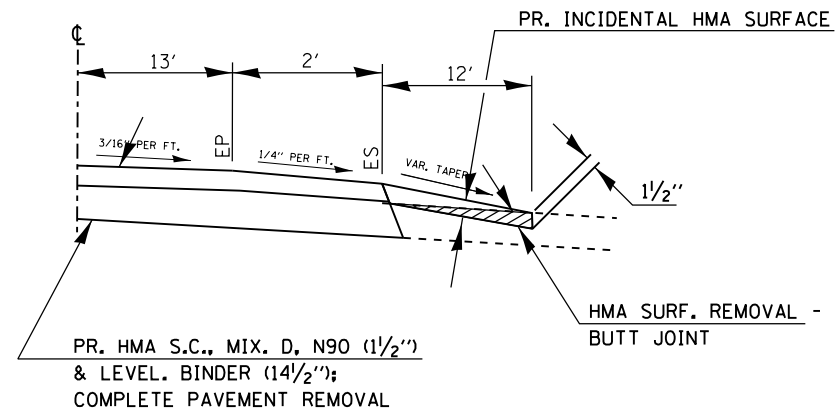

SIDE ROAD SEC. B-B
EX. BIT. OR CONC. SURFACE

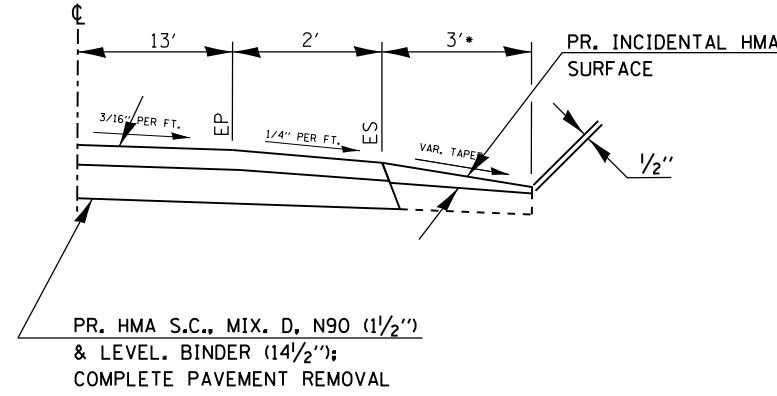

PE OR CE SEC. A-A
EX. BIT. OR CONC. SURFACE
•OR END OF BIT. APRON

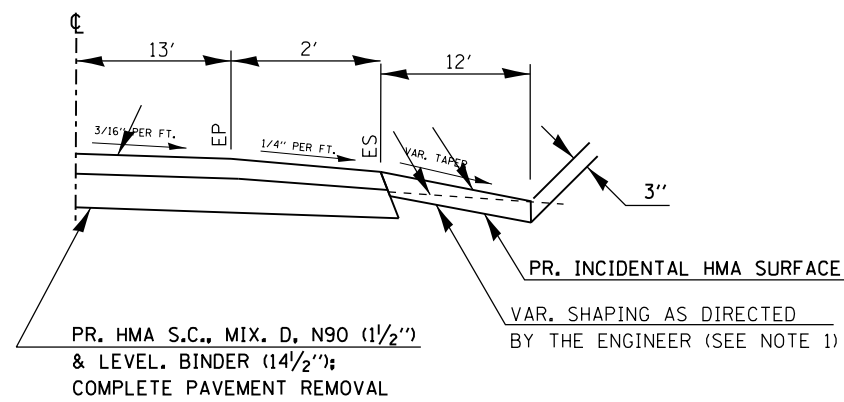

SIDE ROAD SEC. B-B
EX. AGGREGATE SURFACE
EX. OIL & CHIP SURFACE

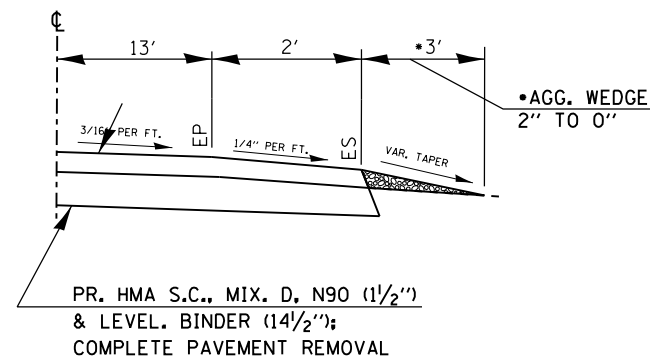

PE, CE SEC. A-A
EX. AGGREGATE SURFACE
WITH BIT. APRON
•SEE ENTRANCE SCHEDULE
FOR QUANTITY.

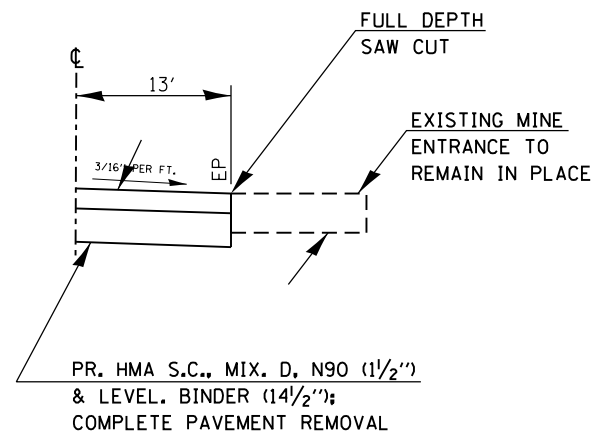

MINE ENTRANCE SEC. C-C

NOTES

- VARIABLE SHAPING IS INCLUDED IN THE COST OF INCIDENTAL HMA SURFACE.
- SHAPING AT FIELD ENTRANCES IS INCLUDED IN THE COST OF GRADING AND SHAPING SHOULDERS.

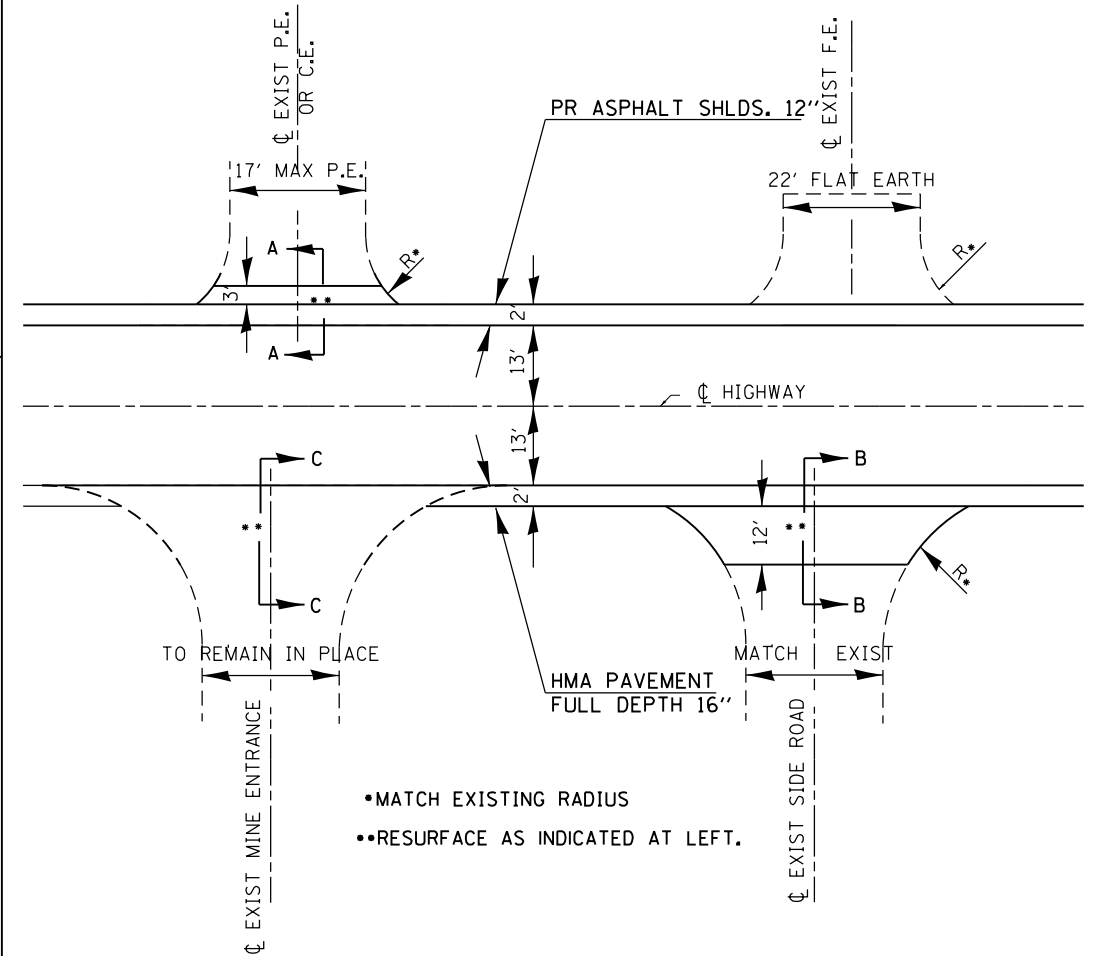

- MATCH EXISTING RADIUS
- RESURFACE AS INDICATED AT LEFT.

FILE NAME =	USER NAME = halsteadtw	DESIGNED -	REVISED -
ei:\pw\work\p\idot\halsteadtw\d0373650\78401-Design.dgn		DRAWN -	REVISED -
	PLOT SCALE = 100.0000' / 1in.	CHECKED -	REVISED -
	PLOT DATE = 1/28/2014	DATE -	REVISED -

STATE OF ILLINOIS
DEPARTMENT OF TRANSPORTATION

SIDE ROAD AND ENTRANCE DETAIL

SCALE: SHEET OF SHEETS STA. TO STA.

F.A.P. RTE.	SECTION	COUNTY	TOTAL SHEETS	SHEET NO.
869	104RS-3	SALINE	21	16
CONTRACT NO. 78401				
ILLINOIS FED. AID PROJECT				

DETOUR SIGNING

SIGN DETAIL

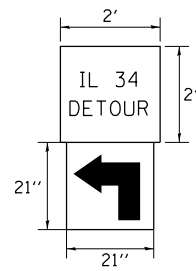

NOTES:

1. THE CONTRACTOR HAS THE OPTION OF USING METAL POSTS INSTEAD OF WOOD.
2. ALL SIGNS SHALL BE BLACK ON ORANGE. THE POSTS SHALL BE PLACED 12 FEET FROM THE EDGE OF PAVEMENT OR AS DIRECTED BY THE ENGINEER.
3. THE COST OF FURNISHING, REMOVING, AND INSTALLING, ALL SIGNS, CMS, AND HARDWARE AS SHOWN ON THIS SHEET, SHALL BE INCLUDED IN THE COST OF DETOUR SIGNING.
4. SIGNS SHALL BE REMOVED ON COMPLETION OF STAGE II AT THE DIRECTION OF THE ENGINEER. THIS WORK SHALL BE COMPLETED ACCORDING TO SECTION 724 OF THE STANDARD SPECIFICATIONS. THE SIGNS AND POSTS SHALL BECOME THE PROPERTY OF THE CONTRACTOR.
5. THE RELOCATING, MAINTENANCE OR REPLACEMENT OF SIGNS SHALL BE PAID FOR IN ACCORDANCE WITH ARTICLE 109.04.
6. EXACT SIGN PLACEMENT WILL BE DETERMINED BY THE ENGINEER.
7. THE DISTRICT 9 OPERATIONS ENGINEER SHALL BE CONTACTED 10 DAYS PRIOR TO THE ERECTION OF SIGNS.

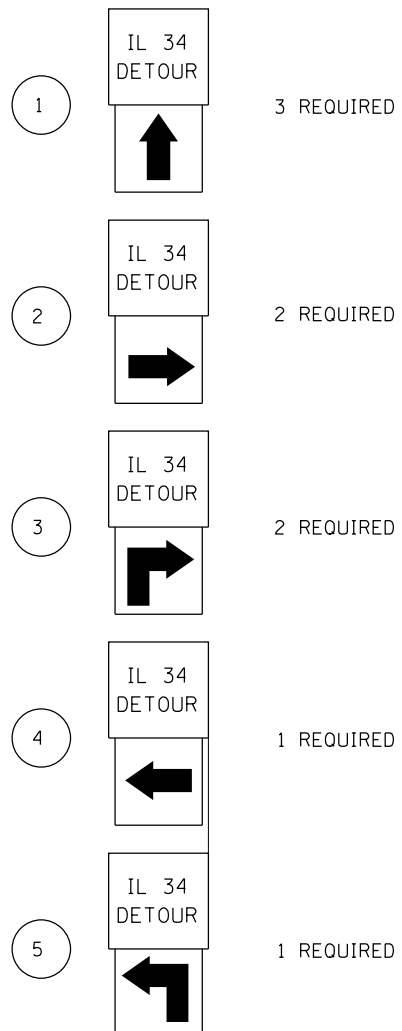

MESSAGE BOARD 2

TRUCKS OVER 20 TONS	USE IL 13 WEST
---------------------------	----------------------

MESSAGE BOARD 1

IL 34 CLOSED 6 MI AHD.	DETOUR IL 13 WEST
------------------------------	-------------------------

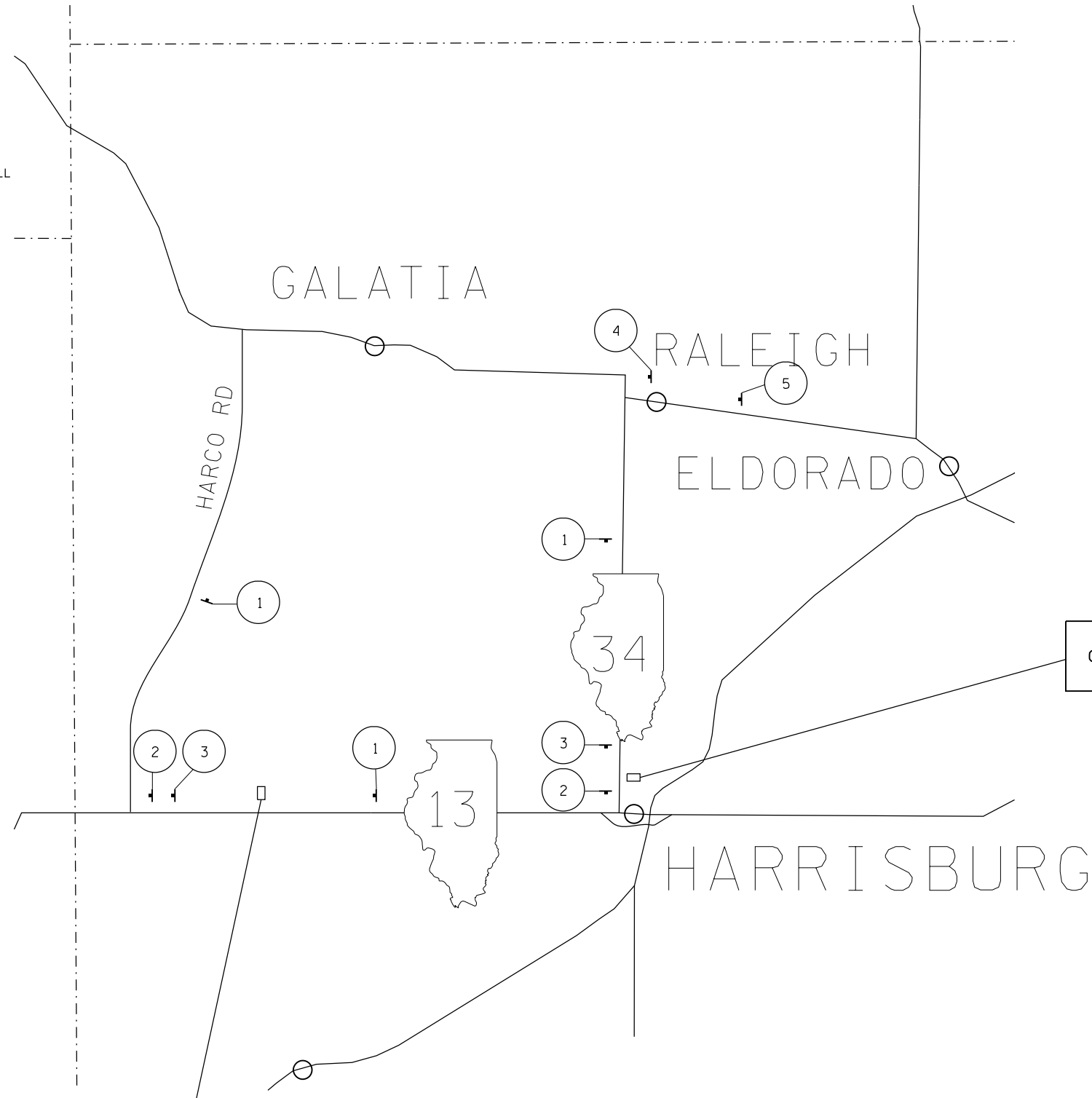

FILE NAME =	USER NAME = halsteadtw	DESIGNED -	REVISED -	STATE OF ILLINOIS DEPARTMENT OF TRANSPORTATION	DETOUR SIGNING				F.A.P. RTE.	SECTION	COUNTY	TOTAL SHEETS	SHEET NO.
		DRAWN -	REVISED -						869	104RS-3	SALINE	21	17
		PLOT SCALE = 100.0000' / in.	CHECKED -		REVISED -					CONTRACT NO. 78401			
		PLOT DATE = 1/28/2014	DATE -		REVISED -	SCALE:	SHEET NO.	OF SHEETS	STA.	TO STA.	ILLINOIS FED. AID PROJECT		

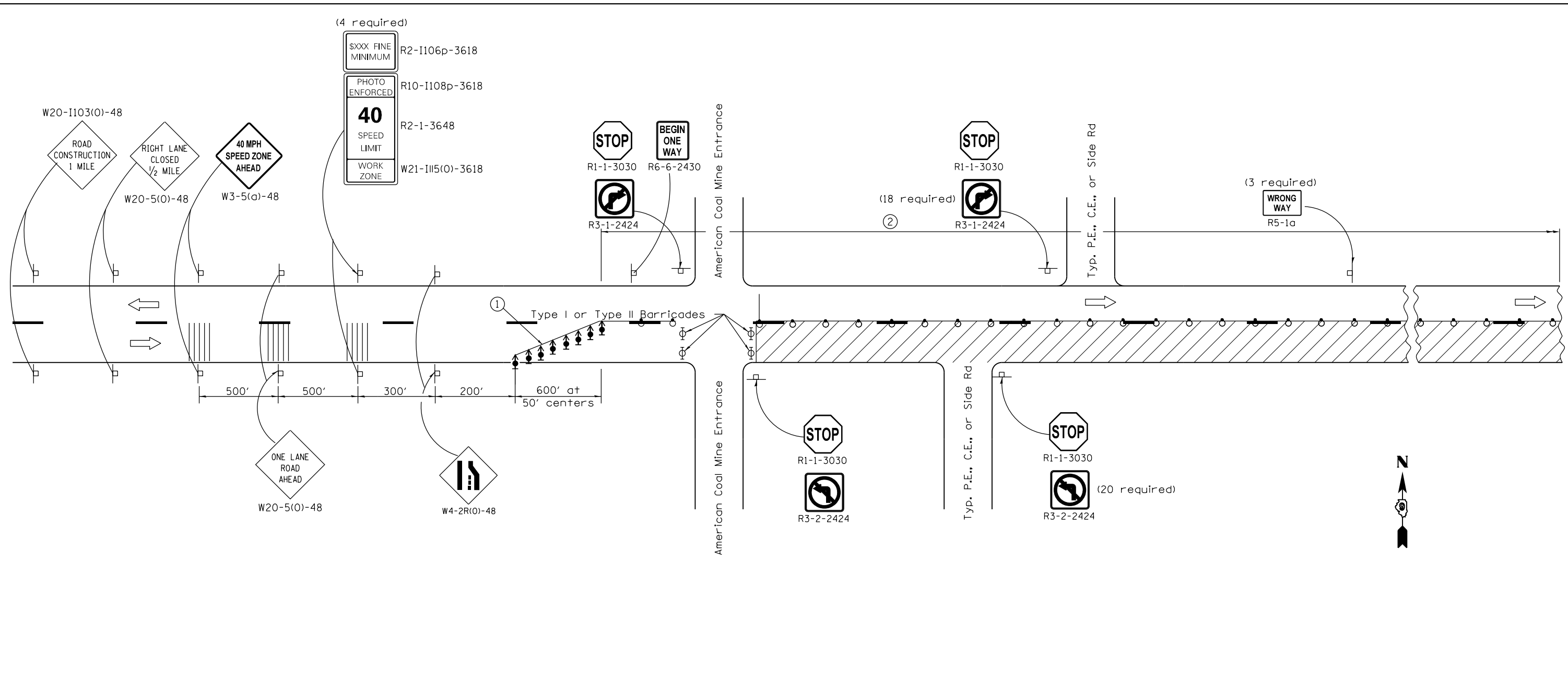

SYMBOLS

- Work area
- Sign on portable or permanent support
- Direction indicator barricade with steady burn monodirectional light
- Barricade or drum with flashing light
- Type III barricade with flashing lights
- Type II barricade, drum, or vertical barricade with steady burn monodirectional light
- Temporary rumble strip

- ① ReflectORIZED temporary pavement marking tape shall be placed throughout the taper and along-side the work area where the closure time is greater than fourteen days. The edge line shall be white for right lane closures and yellow for left lane closures.
- ② Type II barricade, drum, or vertical barricade with steady burn monodirectional light at 100' spacings.
- ③ The Work Zone speed limit and wrong way signs shall be spaced evenly through the closure limits.

GENERAL NOTES

Sheet 1 of 2

All dimensions are in inches (millimeters) unless otherwise shown.

A check barricade shall be placed in the middle of the closed lane and at the shoulder at 1000' (300 m) centers.

Prior to placement of the signs for TRAFFIC CONTROL AND PROTECTION, (SPECIAL) the Resident Engineer should contact the Bureau of Operations and arrange for inspection and approval of the layout.

TRAFFIC CONTROL AND PROTECTION, (SPECIAL)

FILE NAME =	USER NAME = halsteadtw	DESIGNED -	REVISED -	STATE OF ILLINOIS DEPARTMENT OF TRANSPORTATION	TRAFFIC CONTROL AND PROTECTION (SPECIAL)				F.A.P. RTE.	SECTION	COUNTY	TOTAL SHEETS	SHEET NO.	
Default	ct:\pw\work\p\dot\halsteadtw\d0373650\78401-Design.dgn	DRAWN -	REVISED -		SCALE:	SHEET	OF	SHEETS	STA.	TO STA.	869	104RS-3	SALINE	21 18
	PLOT SCALE = 100.0000' / in.	CHECKED -	REVISED -		CONTRACT NO. 78401									
	PLOT DATE = 1/28/2014	DATE -	REVISED -		ILLINOIS FED. AID PROJECT									

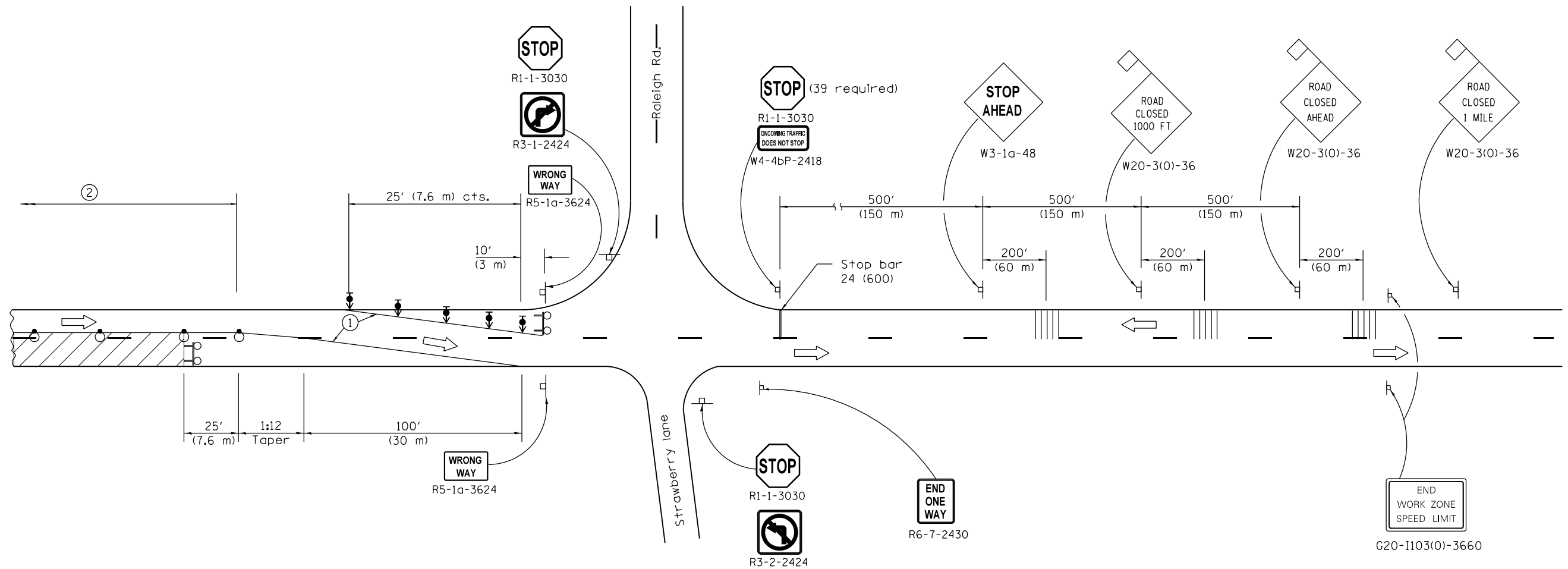

SYMBOLS

- Work area
- Sign on portable or permanent support
- Direction indicator barricade with steady burn monodirectional light
- Barricade or drum with flashing light
- Type III barricade with flashing lights
- Type II barricade, drum, or vertical barricade with steady burn monodirectional light
- Temporary rumble strip

- ① ReflectORIZED temporary pavement marking tape shall be placed throughout the taper and along-side the work area where the closure time is greater than fourteen days. The edge line shall be white for right lane closures and yellow for left lane closures.
- ② Type II barricade, drum, or vertical barricade with steady burn monodirectional light at 100' spacings.
- ③ The Work Zone speed limit and wrong way signs shall be spaced evenly through the closure limits.

GENERAL NOTES

Sheet 2 of 2

All dimensions are in inches (millimeters) unless otherwise shown.

A check barricade shall be placed in the middle of the closed lane and at the shoulder at 1000' (300 m) centers.

Prior to placement of the signs for TRAFFIC CONTROL AND PROTECTION, (SPECIAL) the Resident Engineer should contact the Bureau of Operations and arrange for inspection and approval of the layout.

TRAFFIC CONTROL AND PROTECTION, (SPECIAL)

FILE NAME =	USER NAME = halsteadw	DESIGNED -	REVISED -	STATE OF ILLINOIS DEPARTMENT OF TRANSPORTATION	TRAFFIC CONTROL AND PROTECTION (SPECIAL)				F.A.P. RTE.	SECTION	COUNTY	TOTAL SHEETS	SHEET NO.		
Default	ct:\pw\work\p\dot\halsteadw\d0373650\78401-Design.dgn	DRAWN -	REVISED -		SCALE:	SHEET	OF	SHEETS	STA.	TO STA.	869	104RS-3	SALINE	21	19
	PLOT SCALE = 100.0000' / in.	CHECKED -	REVISED -						CONTRACT NO. 78401						
	PLOT DATE = 1/28/2014	DATE -	REVISED -						ILLINOIS FED. AID PROJECT						

TEMPORARY HOT-MIX ASPHALT TRANSITIONS

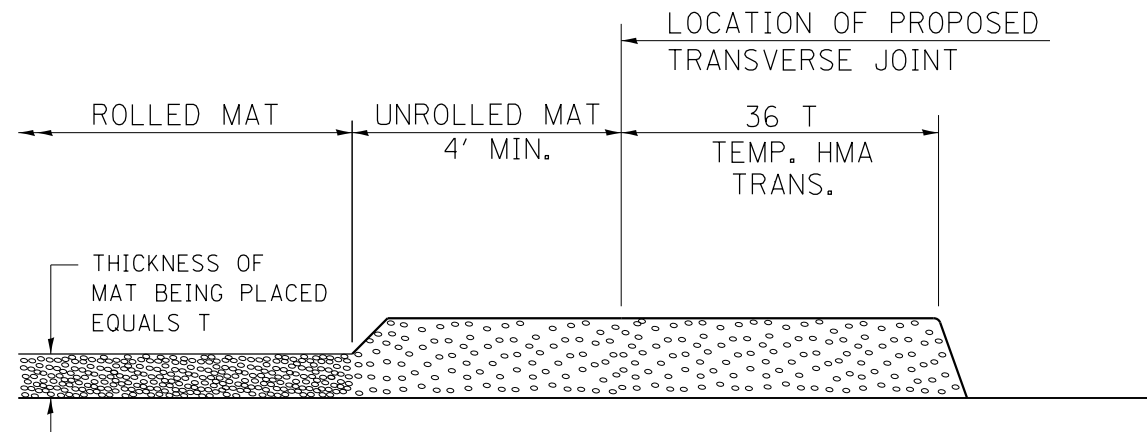

STEP I

1. PLACE HOT-MIX ASPHALT MAT, LENGTH 36 TIMES THE THICKNESS OF THE MAT BEING PLACED PAST THE PROPOSED TRANSVERSE JOINT LOCATION USING NORMAL OPERATING PROCEDURES. EXTREME CARE SHOULD BE TAKEN TO MAINTAIN ENOUGH MATERIAL IN FRONT OF THE SCREED TO MAINTAIN REQUIRED PAVING DEPTH.

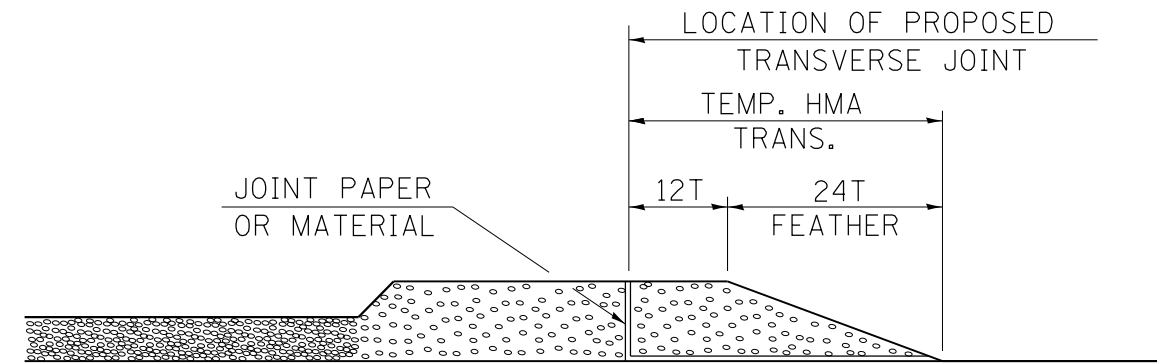

STEP III

1. JOINT PAPER OR OTHER PRESELECTED JOINT MATERIAL IS THEN PLACED IN THE CLEARED AREA AND THE EXCESS ASPHALT USED TO HAND FORM A TRANSITION TO THE DIMENSIONS SHOWN ABOVE.
2. NOTE THAT IN CONSTRUCTING THE TRANSITION, THE MAT DEPTH IS CONTINUED AS PART OF THE TRANSITION BEFORE FORMING THE FEATHER.

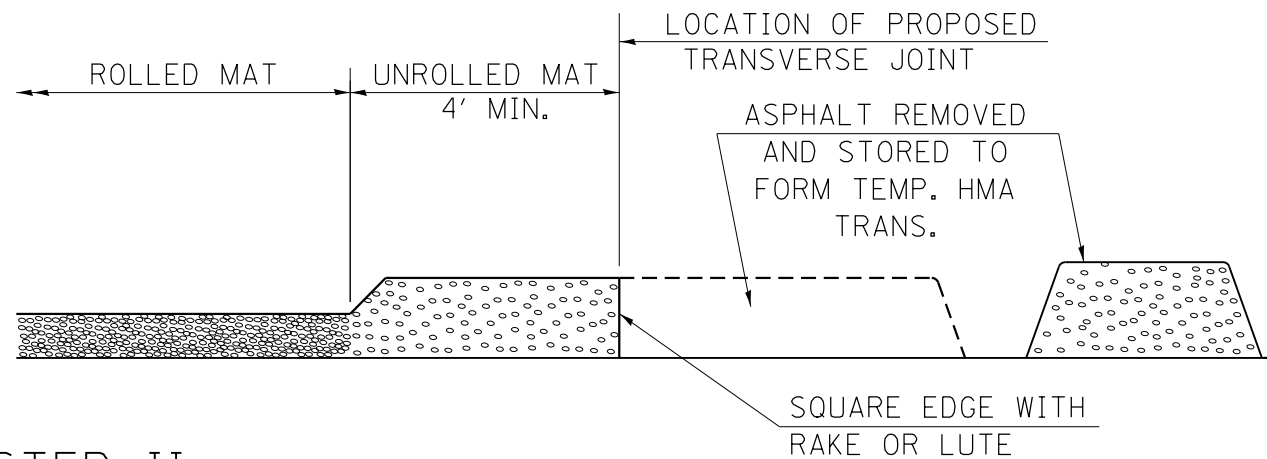

STEP II

1. MOVE THE PAVER OUT OF THE WAY AND REMOVE THE ASPHALT FROM THE AREA OF THE PROPOSED TEMPORARY HOT-MIX ASPHALT TRANSITION.
2. SQUARE UP THE END OF THE MAT WITH A RAKE OR LUTE.
3. NOTE THAT THE MAT WITHIN 4' OF THE END OF JOINT IS NOT TO BE ROLLED AT THIS TIME.

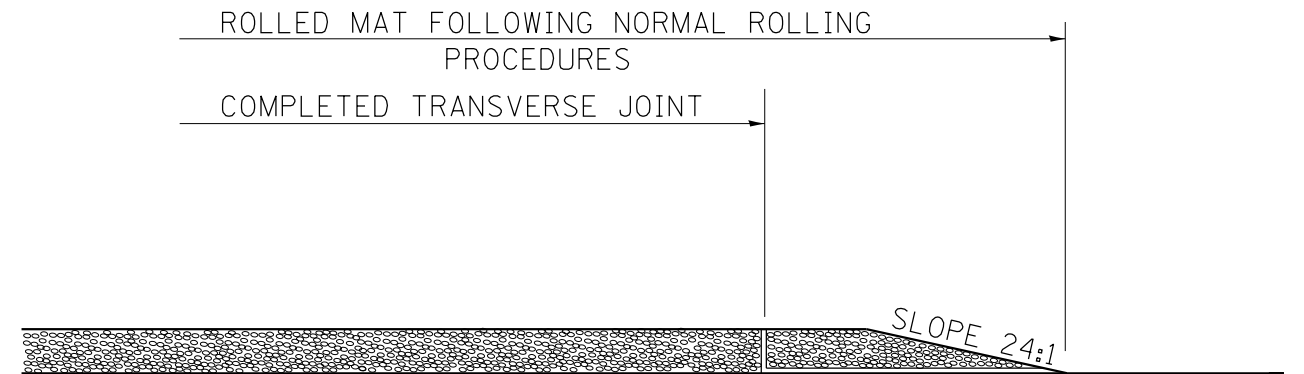

STEP IV

1. COMPLETE TEMPORARY TRANSITION BY ROLLING.
2. TO RESUME PAVING, AT THE JOINT, REMOVE TEMPORARY TRANSITION AND DISPOSE OF THE MATERIAL ACCORDING TO ART. 202.03 OF THE STD. SPECS. (COST INCLUDED IN THE CONTRACT).
3. CONSTRUCTING THE TEMPORARY TRANSITIONS WILL NOT BE PAID FOR SEPARATELY IN ACCORDANCE WITH ARTICLE 406.14 OF THE STANDARD SPECIFICATIONS.

REVISIONS

REDRAWN	2-15-89
REVISED	8-16-94
REVISED	01-09-07
RESIZED	05-8-08

STD. 9-26

UNEVEN LANES SIGN

W8-11 (48'' x 48'')

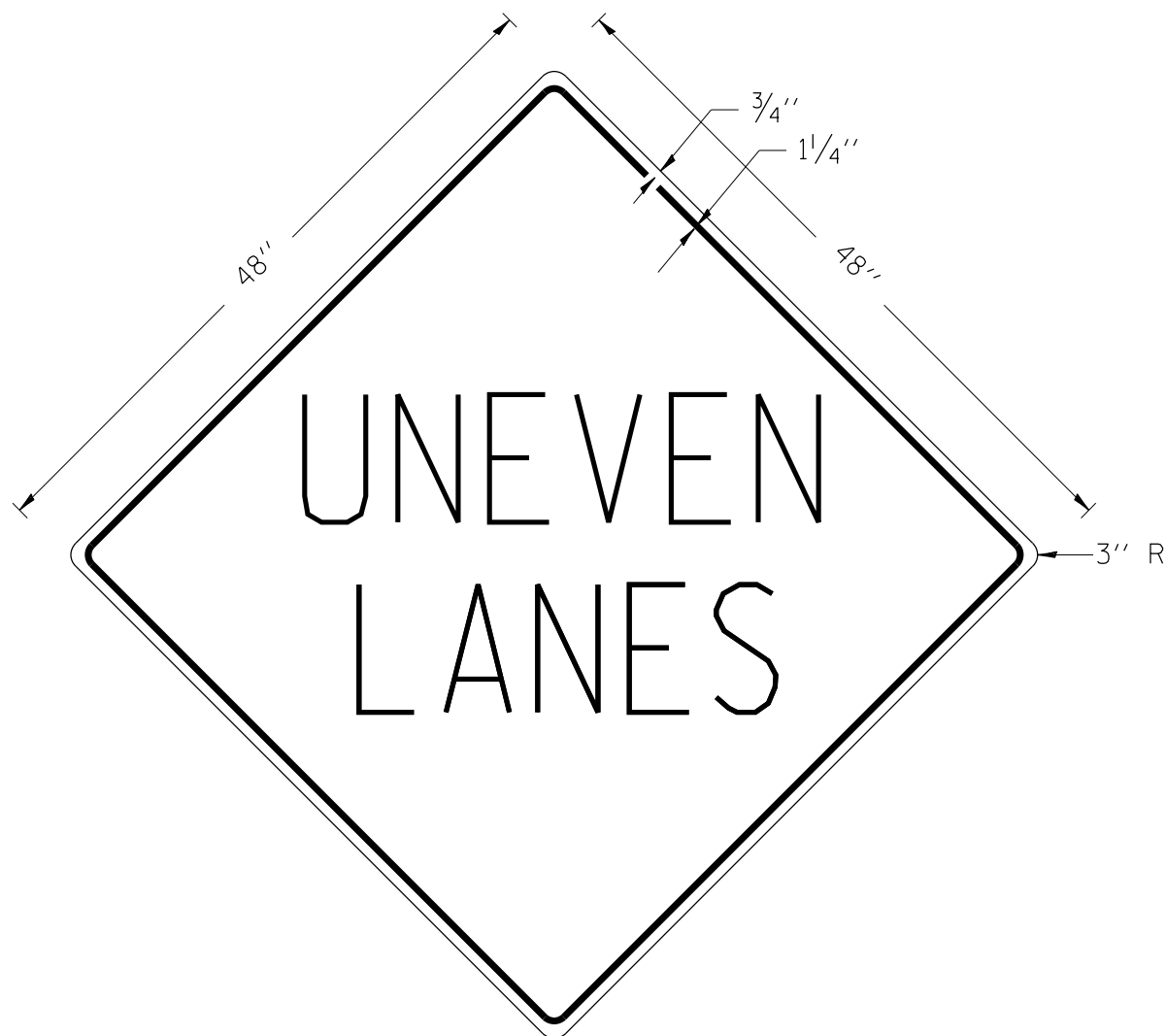

COLORS:

LEGEND AND BORDER - BLACK NON-REFLECTORIZED
 BACKGROUND - ORANGE REFLECTORIZED

NOTE: PRIOR TO ALLOWING TRAFFIC ON ANY PORTION OF THE ROADWAY THAT HAS BEEN COLDMILLED OR BEFORE RESURFACING OPERATIONS BEGIN, THE CONTRACTOR SHALL HAVE ERECTED "UNEVEN PAVEMENT" SIGNS THAT CONFORM TO THE ABOVE DETAILS. A MINIMUM OF ONE SIGN AT EACH END OF THE IMPROVEMENT WILL BE REQUIRED. THE CONTRACTOR SHALL MAINTAIN THE "UNEVEN PAVEMENT" SIGNS UNTIL THE RESURFACING OPERATIONS ARE COMPLETED.

IF AT ANY TIME THE SIGNS ARE IN PLACE BUT NOT APPLICABLE, THEY SHALL BE TURNED FROM THE VIEW OF MOTORISTS OR COVERED AS DIRECTED BY THE ENGINEER.

THE COST OF FURNISHING, ERECTING, MAINTAINING, AND REMOVING THE REQUIRED SIGNS SHALL BE INCLUDED IN THE CONTRACT.

STD. 9-41

FILE NAME =	USER NAME = halsteadtw	DESIGNED -	REVISED -	STATE OF ILLINOIS DEPARTMENT OF TRANSPORTATION	UNEVEN LANES SIGN			F.A.P. RTE.	SECTION	COUNTY	TOTAL SHEETS	SHEET NO.
et:\pw\work\p\idot\halsteadtw\d0373650\78401-Design.dgn	DRAWN -	REVISED -	869					104RS-3	SALINE	21	21	
PLOT SCALE = 100.0000' / in.	CHECKED -	REVISED -	CONTRACT NO. 78401									
PLOT DATE = 1/28/2014	DATE -	REVISED -	SCALE:		SHEET	OF	SHEETS	STA.	TO	STA.	ILLINOIS FED. AID PROJECT	