

GENERAL NOTES:

- Fasteners shall be ASTM A325 Type 1, mechanically galvanized bolts (in painted areas and ASTM A325 Type 3 in unpainted areas). Bolts 7/8" in. ϕ , holes 15/16" in. ϕ , unless otherwise noted.
- Calculated weight of Structural Steel = 56,120 pounds
- No field welding is permitted except as specified in the contract documents.
- Reinforcement bars designated (E) shall be epoxy coated.
- If the Contractor elects to use cantilever forming brackets on the exterior beams or girders, the brackets shall be placed at the same locations as required for the hardwood blocks in Article 503.06(b) of the Standard Specifications. If additional cantilever forming brackets are required, hardwood blocking shall be wedged between the exterior and first interior beam at each of these additional bracket locations.
- Bearing seat surfaces shall be constructed or adjusted to the designated elevations within a tolerance of 1/8 inch (0.01 ft.). Adjustment shall be made either by grinding the surface or by shimming the bearings.
- The Organic Zinc Rich Primer / Epoxy / Urethane Paint System shall be used for painting of new structural steel except where otherwise noted. The entire system shall be shop applied, with the exception of the exterior surface and the bottom of the bottom flange of fascia beams, masked off connection surfaces, field installed fasteners and damaged areas shall be touched up in the field. The color of the final finish coat for all interior steel surfaces shall be Gray, Munsell No. 5B 7/1. The color of the final finish coat for the exterior and bottom flange of the fascia beams shall be Reddish Brown, Munsell No. 2.5YR 3/4.
- Layout of the slope protection system may be varied to suit ground conditions in the field as directed by the Engineer.

TOTAL BILL OF MATERIAL

ITEM	UNIT	SUPER	SUB	TOTAL
Stone Riprap, Class A4	Sq. Yds.	-	440	440
Filter Fabric	Sq. Yds.	-	440	440
Removal of Existing Structures	Each	0.5	0.5	1
Structure Excavation	Cu. Yds.	-	190.8	190.8
Concrete Structures	Cu. Yds.	20.5	41.6	62.1
Concrete Superstructure	Cu. Yds.	217.3	-	217.3
Bridge Deck Grooving	Sq. Yds.	415	-	415
Protective Coat	Sq. Yds.	571	-	571
Furnishing and Erecting Structural Steel	L. Sum	1	-	1
Stud Shear Connectors	Each	1,422	-	1,422
Reinforcement Bars, Epoxy Coated	Pounds	48,050	7,060.0	55,110
Aluminum Rolling, Type L	Foot	61	-	61
Furnishing Metal Shell Piles 14" x 0.250"	Foot	-	480	480
Driving Piles	Foot	-	480	480
Test Pile Metal Shells	Each	-	2	2
Name Plates	Each	1	-	1
Anchor Bolts, 1"	Each	24	-	24
Geocomposite Wall Drain	Sq. Yds.	-	70	70
Granular Backfill for Structures	Cu. Yds.	-	122.4	122.4
Pipe Underdrains for Structures, 4"	Foot	-	124	124

INDEX OF SHEETS

S-01	General Plan and Elevation
S-02	General Notes and Total Bill of Materials
S-03	Top of Slab Elevations
S-04	Top of Slab Elevations
S-05	Top of Approach Slab Elevations
S-06	Superstructure Details
S-07	Integral Abutment Diaphragm Details
S-08	Superstructure Details
S-09	Superstructure Details
S-10	Bridge Approach Slab Details
S-11	Bridge Approach Slab Details
S-12	Bridge Rolling Details
S-13	Steel Beam Framing Plan
S-14	Steel Beam Elevation & Details
S-15	West Abutment
S-16	East Abutment
S-17	Metal Shell Pile Details
S-18	Soil Boring Logs
S-19	Soil Boring Logs

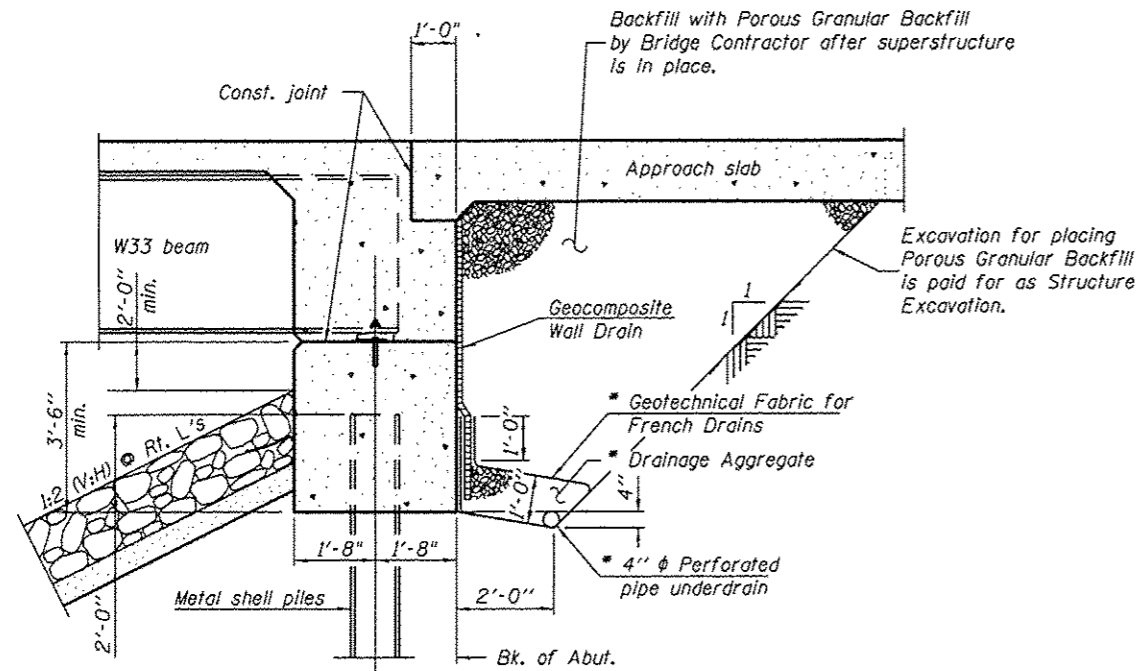

SECTION THRU INTEGRAL ABUTMENT
(Horiz. dim. @ Rt. L's)

* Included in the cost of Pipe Underdrains for Structures.

Note: All drainage system components shall extend to 2'-0" from the end of each wingwall except an outlet pipe shall extend until intersecting with the side slopes. The pipes shall drain into concrete headwalls. (See Article 601.05 of the Standard Specifications and Highway Standard 601101).

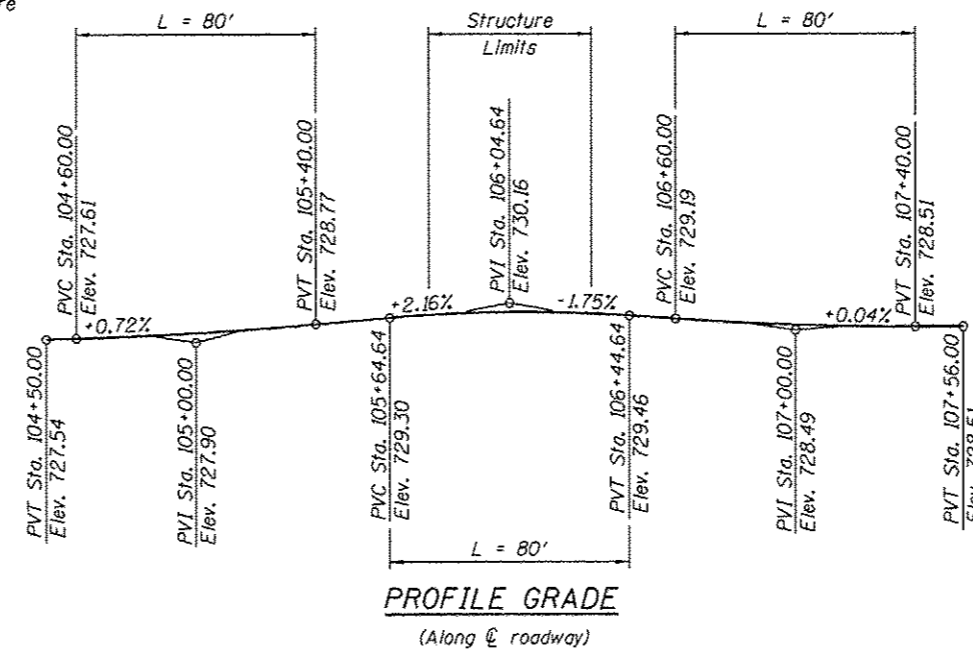

PROFILE GRADE
(Along E roadway)

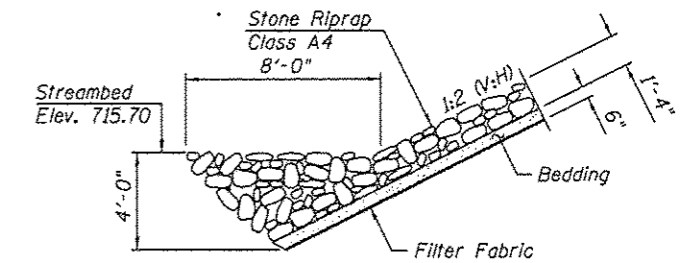

SECTION A-A

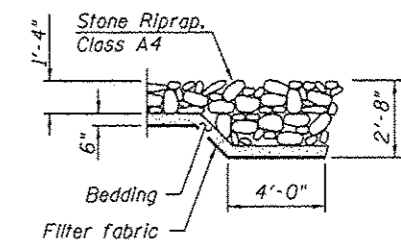

SECTION B-B

COMPANY NAME: Kevin M. Arft
PROJECT CONTACT: City of Rockford
DATE: 2/18/2014 10:53 PM
FILE NAME: 86130054-bgen.dgn
PLOT DRIVER: pdf.plt
PLOT TABLE: Struct.tbl

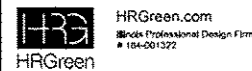

USER NAME = whoad	DESIGNED - KMA	REVISED -
PLOT SCALE =	CHECKED - RDC	REVISED -
PLOT DATE = 2/18/2014	DRAWN - WJH	REVISED -
	CHECKED - 2/18/14	REVISED -

STATE OF ILLINOIS
DEPARTMENT OF TRANSPORTATION

GENERAL NOTES AND TOTAL BILL OF MATERIALS
STRUCTURE NO. 101-6148

SHEET NO. S-02 OF S-19 SHEETS

F.A. RTE. 3259	SECTION 11-00590-00-BR	COUNTY WINNEBAGO	TOTAL SHEETS 32	SHEET NO. 12
CONTRACT NO. 85607				
ILLINOIS FED. AID PROJECT				