

NOT PLOTTED TO SCALE

ROUTE NO.	SECTION	COUNTY	TOTAL SHEETS	SHEET NO.
355	10-00149-02-RS	LIVINGSTON	5	3

PROJECT NO. RS-0355(122)

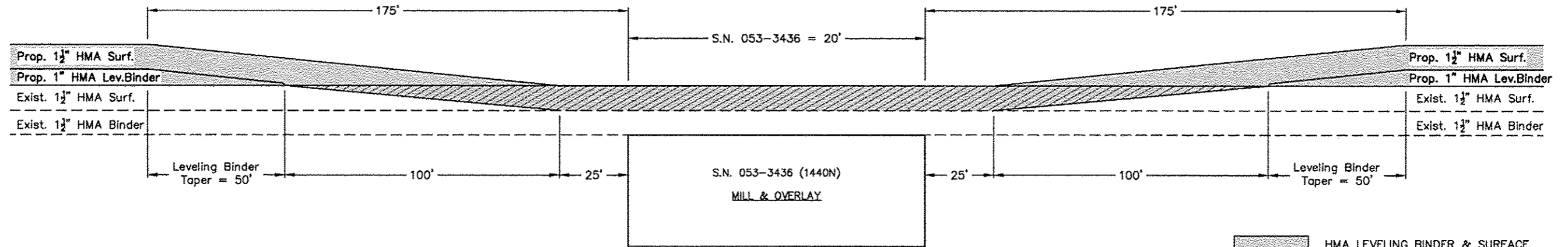

TRANSITION WITH MILL & OVERLAY AT BRIDGES (NTS)

- HMA LEVELING BINDER & SURFACE
TOTAL DEPTH = 2 1/2"
- HMA SURFACE REMOVAL, VARIABLE DEPTH
- HMA SURFACE REMOVAL, DECK

SCHEDULE OF PAINT PAVEMENT MARK 4"				
LOCATION		NO PASSING ZONE		SKIP DASH
STATION TO	STATION	NBL	SBL	¢
-0+30	to 5+56		586	147
5+56	to 43+12			939
43+12	to 52+49	937		234
52+49	to 53+32	83	83	*
53+32	to 60+61		729	182
60+61	to 190+14			3,238
190+14	to 195+93	579		145
195+93	to 201+84			148
201+84	to 207+60		576	144
207+60	to 263+43			1,396
263+43	to 269+21	578		145
269+21	to 274+96			144
274+96	to 280+72		576	144
280+72	to 422+80			3,552
* Double NPZ, No Skip Dash				
TOTALS		1,157	1,881	9,237
TOTAL PAY QUANTITY 12,275 FOOT				

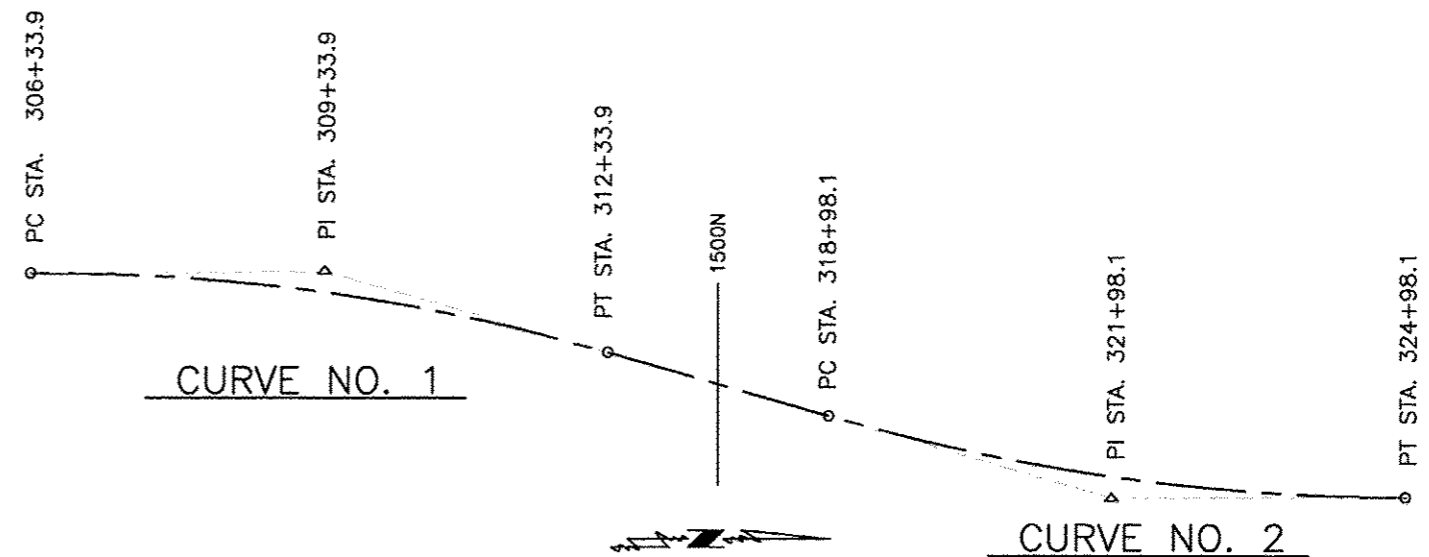

CURVE DATA								
CURVE NO.	DELTA ANGLE	TANGENT LENGTH	RADIUS	Dc	SE TRANS L	L	E	SE RATE
1	01° 05' 00"	300.01'	31733.06'	00° 10' 50"	N/A	600.00'	1.42'	N/A
2	01° 05' 00"	300.01'	31733.06'	00° 10' 50"	N/A	600.00'	1.42'	N/A