

PLAN	SURVEYED	DATE
	DESIGNED	
	DRAWN	
	CHECKED	
	NOTED	
	DATE	

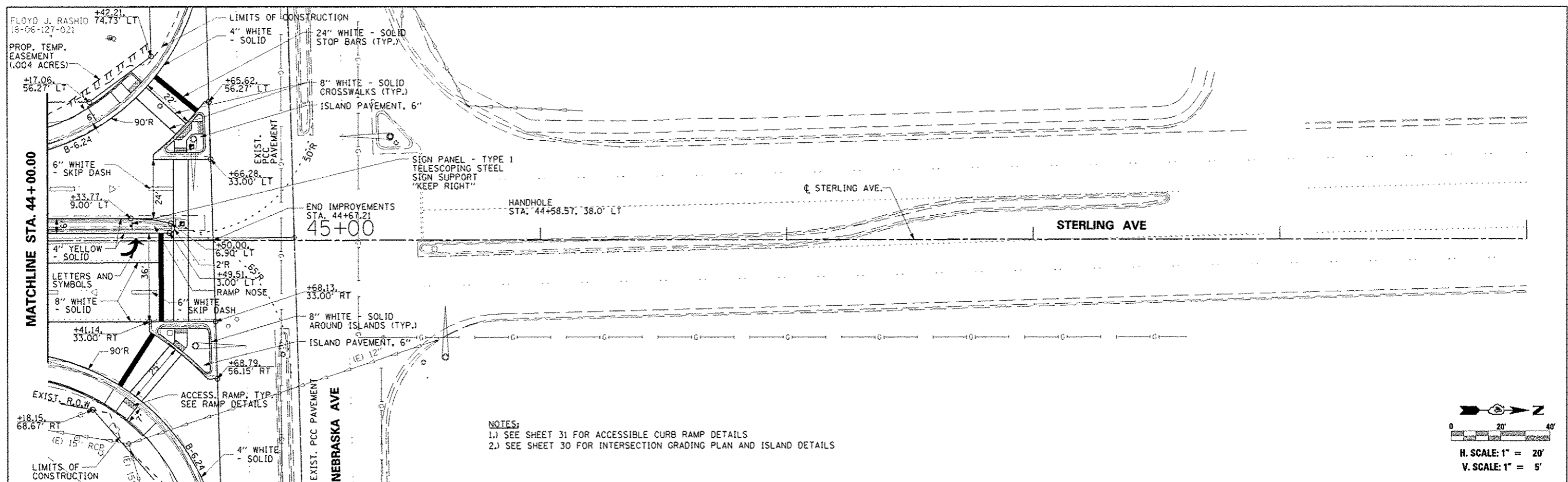

NOTES:
 1.) SEE SHEET 31 FOR ACCESSIBLE CURB RAMP DETAILS
 2.) SEE SHEET 30 FOR INTERSECTION GRADING PLAN AND ISLAND DETAILS

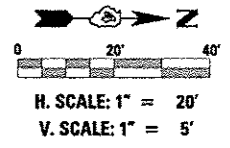

PROFILE	DATE

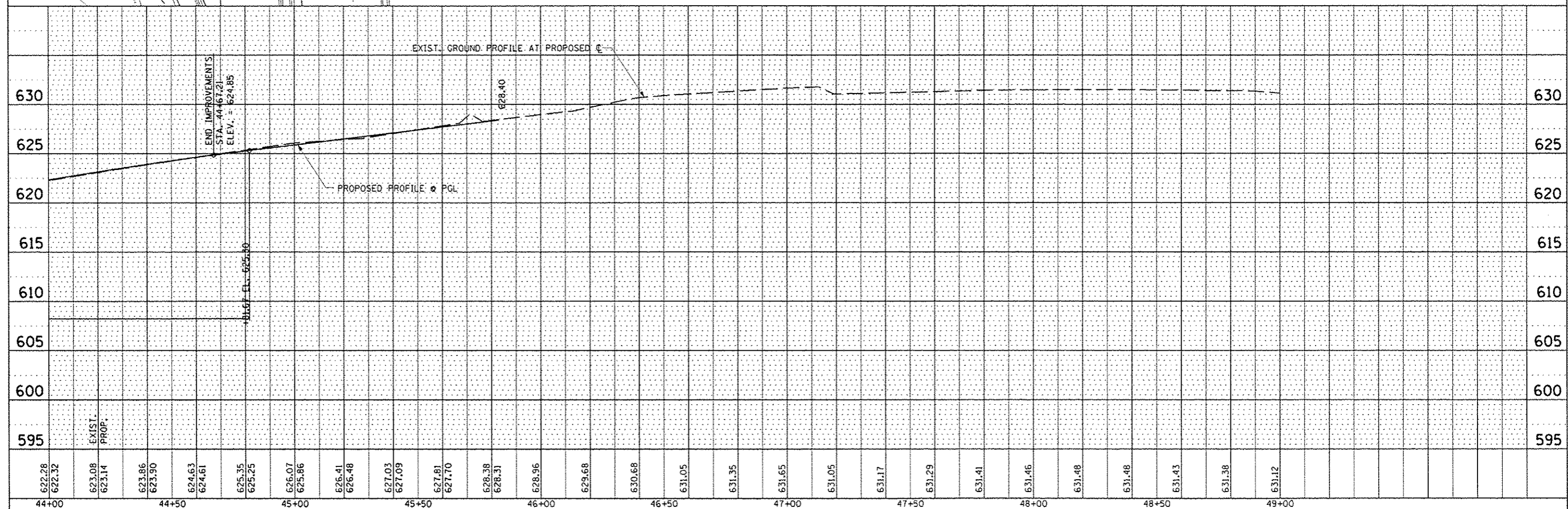

FILE NAME	USER NAME = *USER*	DESIGNED - JLH	REVISED -	STATE OF ILLINOIS DEPARTMENT OF TRANSPORTATION	STERLING AVENUE PLAN & PROFILE		F.A.U. RTE. 6586	SECTION 05-00010-00-PV	COUNTY PEORIA	TOTAL SHEETS 86	SHEET NO. 23
FILE NO.	PLOT SCALE = 1"=20'	DRAWN - JLH	REVISED -		SCALE: 1"=20'	SHEET NO. OF SHEETS	STA. 44+00.00 TO STA. 49+00.00	STERLING AVENUE		CONTRACT NO. 89385	
	PLOT DATE = *DATE*	CHECKED - JLH	REVISED -					FED ROAD DIST NO. 4		ILLINOIS FED. AID PROJECT M-5314 (001)	
		DATE - JAN 2014	REVISED -								