

QUANTITIES OF CONCRETE

All Entrances:

Section B-B to C-C = 0.19 cu. yd./ft.

Section (A-A to B-B) + (C-C to D-D) = 0.88 cu. yd.

NOTE

Welded wire fabric shall be installed at mid-depth from Section A-A to D-D. (58 lbs./100 sq. ft.)

Welded wire fabric will not be paid for separately but shall be included in the cost for CLASS SI CONCRETE (OUTLET).

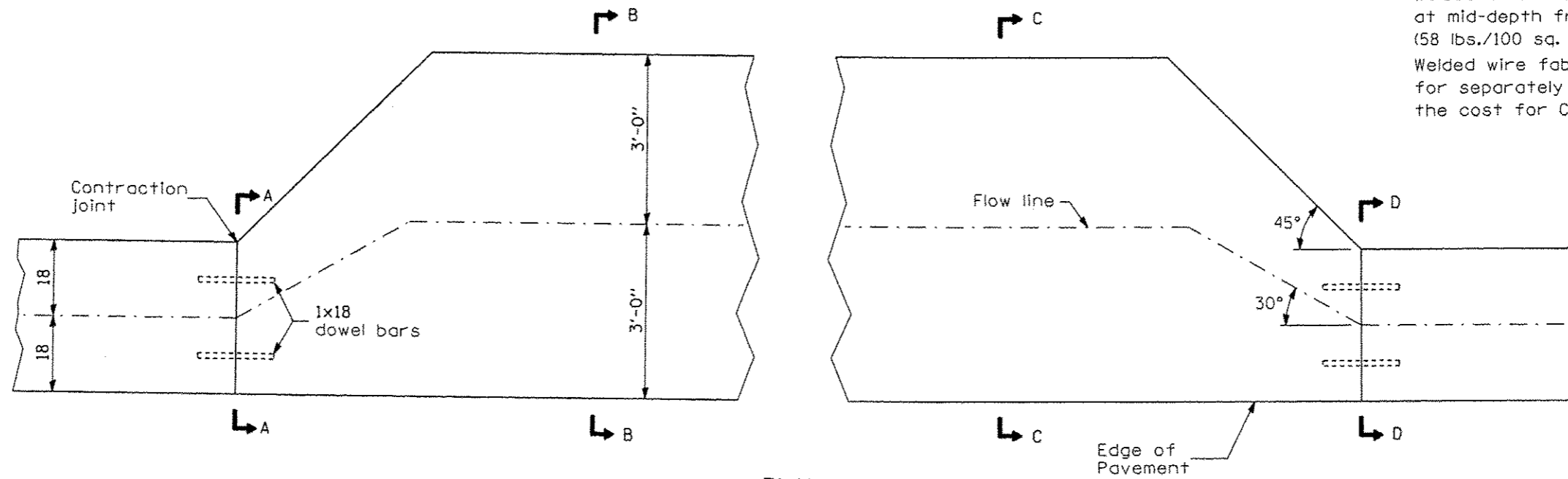

PLAN

ENTRANCE

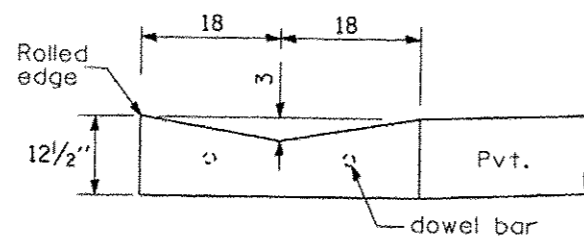

SECTIONS A-A & D-D

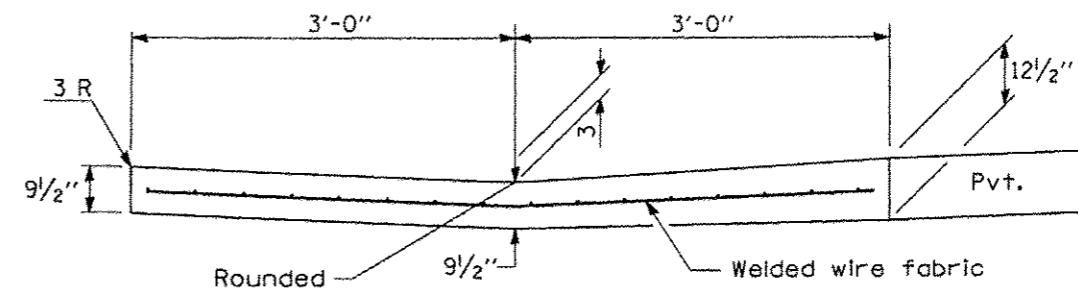

SECTIONS B-B & C-C

TYPE A GUTTER (SPECIAL)  
(INLET, OUTLET & ENTRANCE)



JOB = 2298	DESIGNED - NAK	REVISED -
FILE NAME = 2298Outlet.dgn	DRAWN - TSH	REVISED -
PLOT SCALE = 2.476 FL / IN.	CHECKED - NAK	REVISED -
PLOT DATE = 11/12/2013	DATE = 9/7/2012	REVISED -

LOGAN COUNTY  
CH 2 IMPROVEMENTS

GUTTER DETAILS

SCALE:	SHEET NO. OF SHEETS	STA. TO STA.	RTE.	SECTION	COUNTY	TOTAL SHEETS	SHEET NO.
			CH 2	11-00311-02-RS	LOGAN	37	30
			FED. ROAD DIST. NO.		ILLINOIS FED. AID PROJECT	CONTRACT NO. 03014	