

DATE	
BY	
NO.	
PLAN	
NO.	
NO.	
NO.	
NO.	
NO.	
NO.	

DATE	
BY	
NO.	
PROFILE	
NO.	
NO.	
NO.	
NO.	
NO.	
NO.	

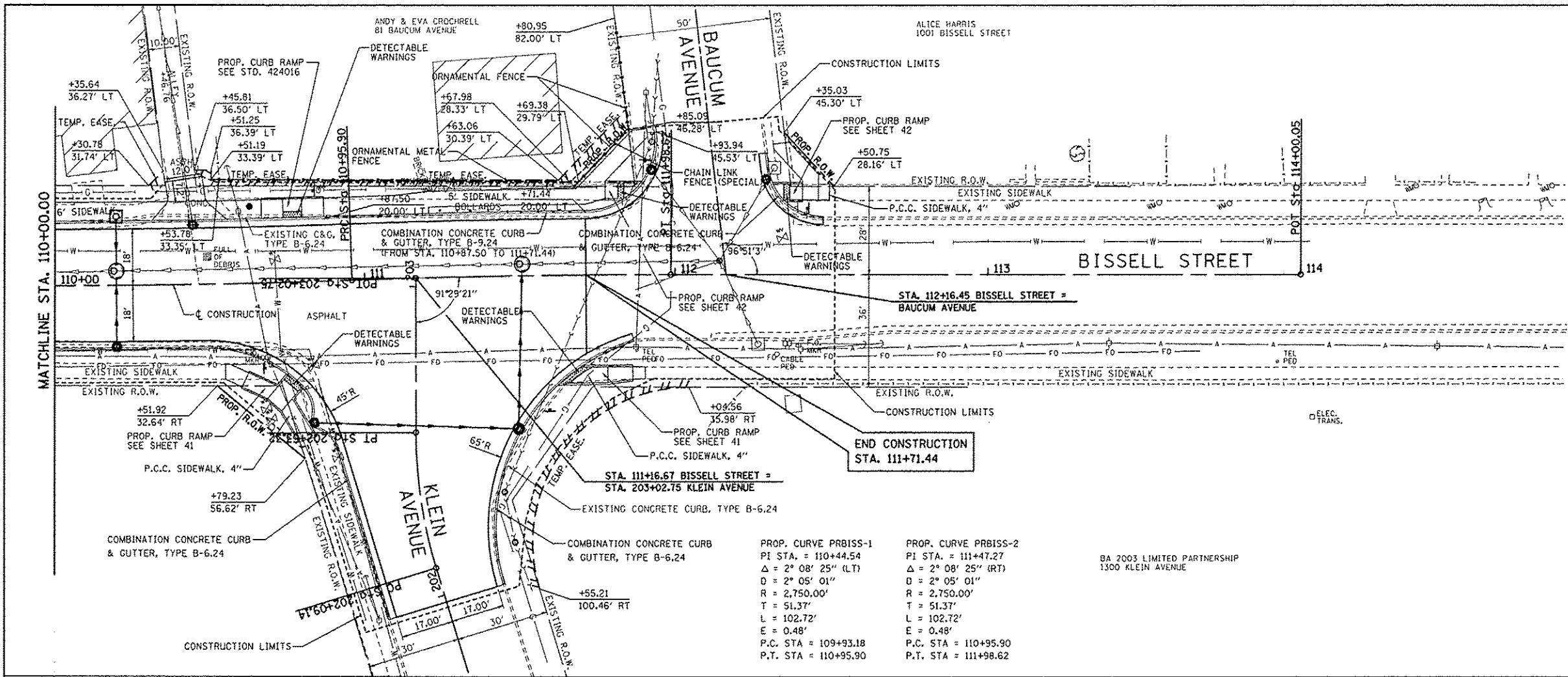

PROP. CURVE PRBISS-1  
 PI STA. = 110+44.54  
 $\Delta = 2^\circ 08' 25''$  (LT)  
 $D = 2^\circ 05' 01''$   
 $R = 2,750.00'$   
 $T = 51.37'$   
 $L = 102.72'$   
 $E = 0.48'$   
 P.C. STA. = 109+93.18  
 P.T. STA. = 110+95.90

PROP. CURVE PRBISS-2  
 PI STA. = 111+47.27  
 $\Delta = 2^\circ 08' 25''$  (RT)  
 $D = 2^\circ 05' 01''$   
 $R = 2,750.00'$   
 $T = 51.37'$   
 $L = 102.72'$   
 $E = 0.48'$   
 P.C. STA. = 110+95.90  
 P.T. STA. = 111+98.62

BA 2003 LIMITED PARTNERSHIP  
 1300 KLEIN AVENUE

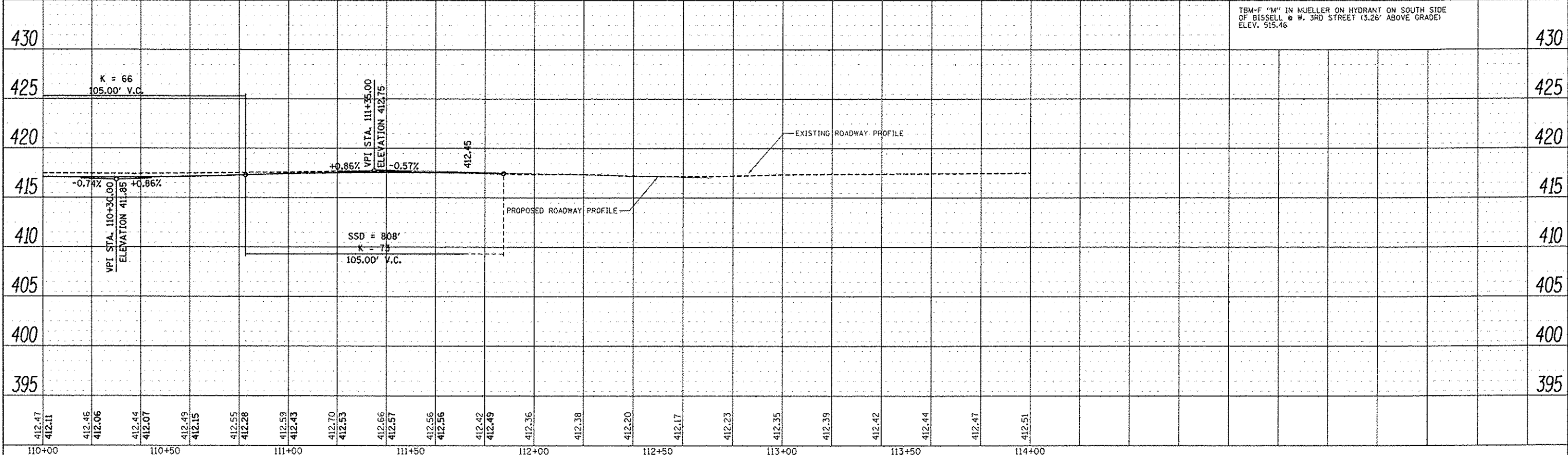
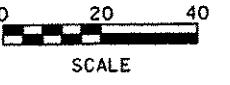

TEM-F "M" IN MUELLER ON HYDRANT ON SOUTH SIDE OF BISSELL @ W. 3RD STREET (3.26' ABOVE GRADE) ELEV. 515.46

FILE NAME	USER NAME = romash	DESIGNED - SAS	REVISED -	<b>CITY OF MADISON BISSELL STREET</b>	<b>PLAN &amp; PROFILE</b>	F.A.U. RTE.	SECTION	COUNTY	TOTAL SHEETS	SHEET NO.	
#FILE#	PLT SCALE = #SCALE#	DRAWN - SAS	REVISED -			9104	10-00058-00-PV	MADISON	53	25	
	PLT DATE = 2/19/2014	CHECKED - BFK	REVISED -			CONTRACT NO. 97530					
		DATE - 12/20/13	REVISED -			ILLINOIS FED. AID PROJECT					