

BY	DATE

BY	DATE

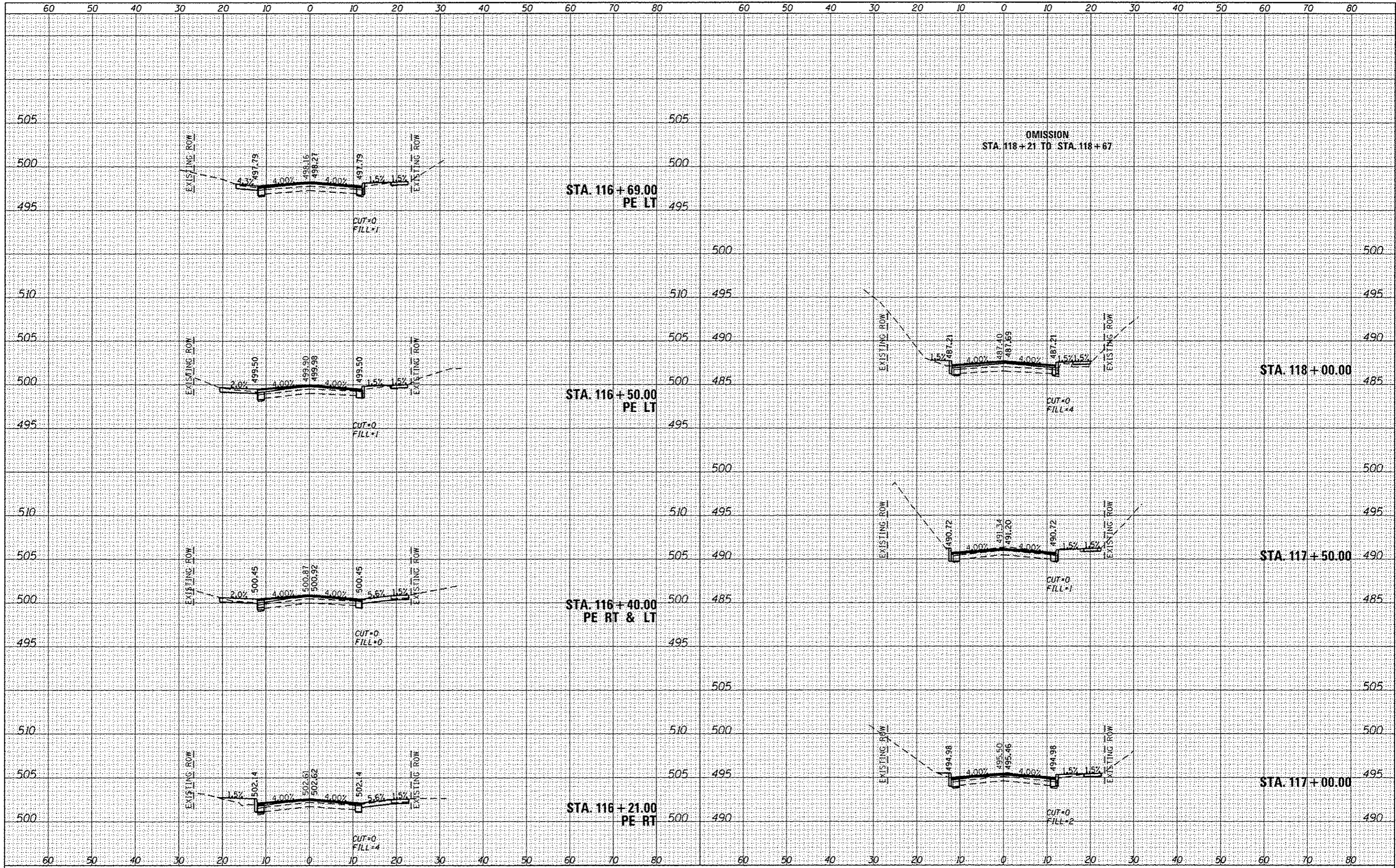

FILE NAME *	USER NAME	DESIGNED	REVISED
D011009-ah-1-sec.dgn	brandon-atermann	-	-
	PLOT TIME	DRAWN	REVISED
	1:36:43 PM	-	-
	PLOT SCALE	CHECKED	REVISED
	20,0000' / 1"	-	-
	PLOT DATE	DATE	REVISED
	2/3/2014	-	-

**STATE OF ILLINOIS
DEPARTMENT OF TRANSPORTATION**

CROSS SECTIONS

SCALE: 1"=10' SHEET 6 OF 11 SHEETS STA. 116+21.00 TO STA. 118+50.00

F.A.U. R.T.E.	SECTION	COUNTY	TOTAL SHEETS	SHEET NO.
8887	11-00100-00-RS	MADISON	42	37
W UNION ST. RESURFACING CONTRACT NO. 97553				
CITY OF EDWARDSVILLE ILLINOIS FED. AID PROJECT				