

ROUTE	SECTION	COUNTY	TOTAL SHEETS	SHEET NO.
TR 3	10-01183-00-BR	ALEXANDER	12	2
PROJECT NO. BROS-0003(125)			CONTRACT NO. 98521	

B.M. - Dbl. Nails in Power Pole
 66' Lt. Sta. 26+82
 Elev. 383.00

Existing Structure - Precast reinforced concrete deck beams on concrete caps with timber piling.
 3 Span - 26.4' W x 78.0' L

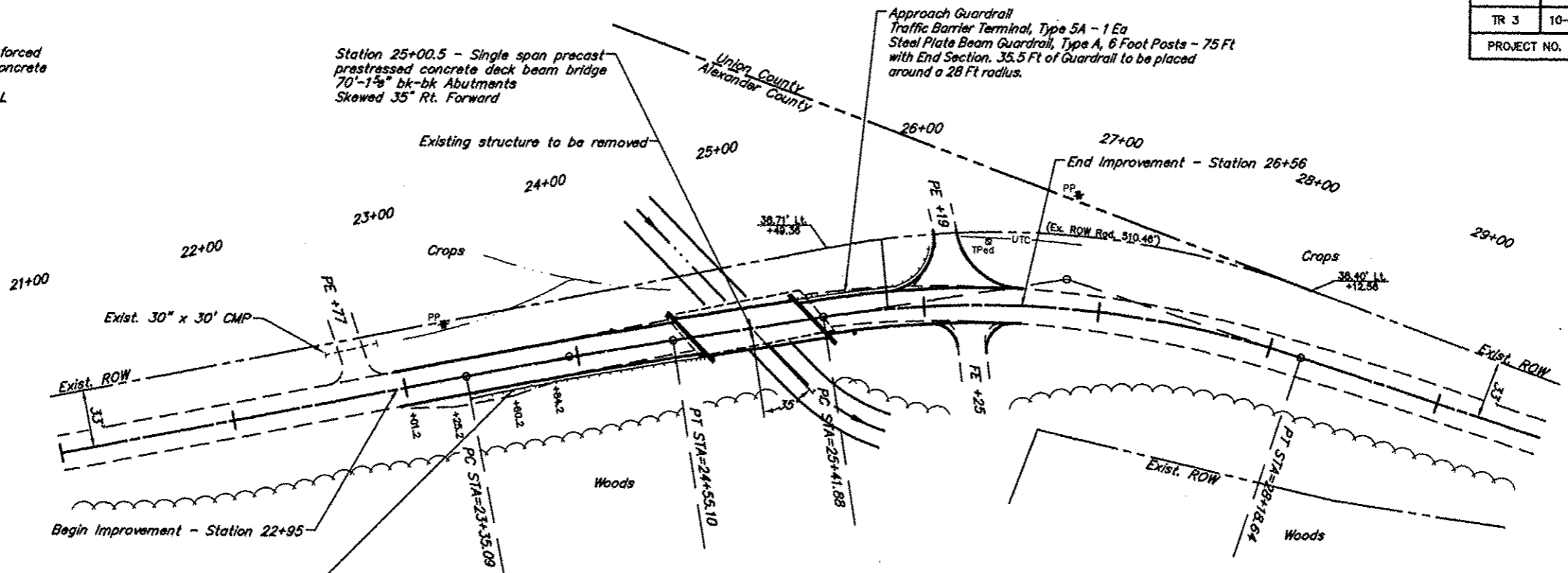

Approach Guardrail
 Traffic Barrier Terminal, Type 1 (Special) Tangent - 1 Ea
 Steel Plate Beam Guardrail, Type A, 6 Foot Posts - 75 Ft
 Traffic Barrier Terminal, Type 5A - 1 Ea
 See Std. 630301 for shoulder widening details.

CURVE DATA

PI Sta = 23+95.10
 $\Delta = 2^{\circ}00'00''$ T = 60.01'
 $D = 1^{\circ}40'00''$ L = 120.00'
 $R = 3,437.97'$ E = 0.52'
 S.E. = 0.0156'/Ft
 Attain Sta. 22+95.0 to Sta. 23+48.8
 Maintain SE through bridge to Sta. 25+41.9

CURVE DATA

PI Sta = 26+82.94
 $\Delta = 27^{\circ}17'42''$ T = 141.06'
 $D = 9^{\circ}51'44''$ L = 276.76'
 $R = 580.97'$ E = 16.88'
 S.E. = 0.040'/Ft
 Attain Sta. 25+41.9 to Sta. 25+83.8
 Remove Sta. 27+94.7 to Sta. 28+36.6

SCALES:
 1" = 80' HOR
 1" = 10' VER

