

MAR 14, 2014 12:16 PM ST02101547  
 pw:\SPL-SR036\hanson.don\hanson Projects\Documents\3\Jobs\13A0013\13A0013D\Airport\Broweth\c4c0b5-22x-34f

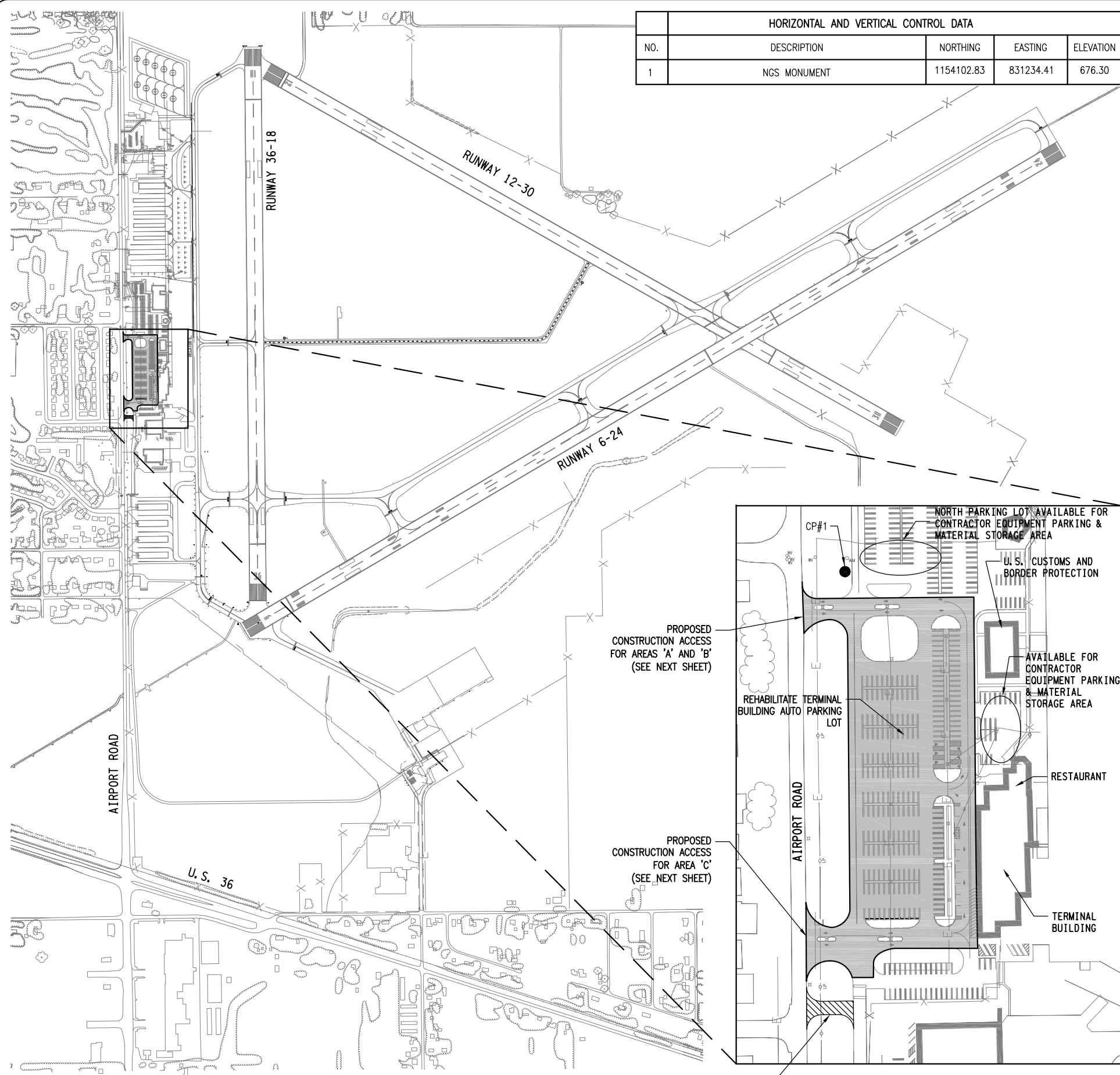

HORIZONTAL AND VERTICAL CONTROL DATA				
NO.	DESCRIPTION	NORTHING	EASTING	ELEVATION
1	NGS MONUMENT	1154102.83	831234.41	676.30

**LEGEND**

- █ EXISTING BUILDING
- ▨ PROPOSED IMPROVEMENTS
- X- EXISTING FENCE
- SS- EXISTING STORM SEWER
- W- EXISTING WATERLINE
- >- EXISTING SANITARY
- T- EXISTING TELEPHONE
- FO- EXISTING FIBER OPTIC
- G- EXISTING GAS
- E- EXISTING ELECTRIC
- /○ EXISTING STORM INLET/MAHOLE
- /X EXISTING LIGHT POLE/POLE-MOUNTED LIGHT

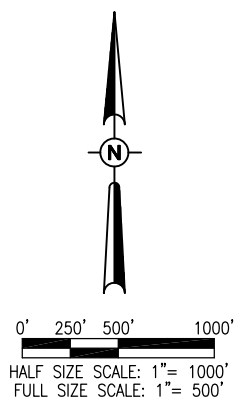

**SCOPE OF WORK**

THIS PROJECT CONSISTS OF THE REHABILITATION OF APPROXIMATELY 15,200 SQ. YARDS OF PAVEMENT IN THE TERMINAL AUTO PARKING LOT. THE REHABILITATION WILL CONSIST OF 3" BITUMINOUS PAVEMENT MILLING AND THE CONSTRUCTION OF A 3" ULTRA-THIN WHITETOPPING (UTW) PCC OVERLAY. ASSOCIATED WORK SHALL INCLUDE CRACK CLEANING AND SEALING; REMOVAL, REPAIR AND/OR REPLACEMENT OF CONCRETE CURB, SHOULDER ADJUSTMENT AND PAVEMENT MARKING.

**NOTIFICATION TO THE PUBLIC:**

THE AIRPORT WILL NOTIFY THE PUBLIC OF ANTICIPATED CONSTRUCTION IN AN EFFORT TO REDUCE OR ELIMINATE THE NEED FOR TOWING, HOWEVER THE CONTRACTOR SHALL BE REQUIRED TO PROCURE TOWING SERVICES FOR ANY VEHICLE THAT REMAINS IN THE PARKING AREA AT THE TIME OF CONSTRUCTION. THE COST OF THE TOWING SERVICES SHALL BE INCIDENTAL TO THE CONTRACT AND NO ADDITIONAL COMPENSATION WILL BE ALLOWED. THE CONTRACTOR AND/OR THE TOWING SERVICE SHALL ACCEPT THE LIABILITY FOR THE VEHICLE RELOCATION, AND THE AIRPORT (PARK DISTRICT), CONSULTANT, STATE OF ILLINOIS, AND THE FEDERAL AVIATION ADMINISTRATION SHALL BE INDEMNIFIED. THE VEHICLES SHALL BE RELOCATED TO THE CONTRACTOR EQUIPMENT PARKING & MATERIAL STORAGE AREA, AS SHOWN ON THIS SHEET.

**MATERIAL CERTIFICATION**

MATERIALS TO BE INCORPORATED INTO THE PROJECT CANNOT BE USED WITHOUT PRIOR APPROVAL. ALL MATERIALS TO BE USED IN THE PROJECT MUST BE SUBMITTED TO THE RESIDENT ENGINEER FOR APPROVAL. USE OF MATERIALS WITHOUT PRIOR APPROVAL AND ULTIMATELY DETERMINED TO BE UNACCEPTABLE BY THE ILLINOIS DIVISION OF AERONAUTICS ARE SUBJECT TO REMOVAL AND/OR NON-PAYMENT. ALL SHOP DRAWINGS SHALL BE ACCOMPANIED BY DOCUMENTATION INDICATING COMPLIANCE WITH BUY AMERICAN PREFERENCE.

**CERTIFIED PAYROLLS**

THE RESIDENT ENGINEER CANNOT FORWARD CONSTRUCTION REPORTS TO THE ILLINOIS DIVISION OF AERONAUTICS FOR PROCESSING UNTIL ALL CERTIFIED PAYROLLS FOR THE PERIOD HAVE BEEN RECEIVED.

**EROSION CONTROL**

THIS PROJECT WILL DISTURB LESS THAN 1 ACRE OF LAND, THEREFORE NO N.P.D.E.S. PERMIT WILL BE REQUIRED.

**UTILITY NOTE**

THE LOCATION, SIZE, AND TYPE OF MATERIAL OF EXISTING UNDERGROUND AND/OR ABOVEGROUND UTILITIES INDICATED ON THE PLANS ARE NOT REPRESENTED AS BEING ACCURATE, SUFFICIENT OR COMPLETE. NEITHER THE OWNER NOR THE ENGINEER ASSUMES ANY RESPONSIBILITY WHATSOEVER IN RESPECT TO THE ACCURACY, COMPLETENESS, OR SUFFICIENCY OF THE INFORMATION. THERE IS NO GUARANTEE, EITHER EXPRESSED OR IMPLIED, THAT THE LOCATIONS, SIZE AND TYPE OF MATERIAL OF EXISTING UNDERGROUND UTILITIES INDICATED ARE REPRESENTATIVE OF THOSE TO BE ENCOUNTERED IN THE CONSTRUCTION. IT SHALL BE THE CONTRACTOR'S RESPONSIBILITY TO DETERMINE THE ACTUAL LOCATION OF ALL SUCH FACILITIES, INCLUDING SERVICE CONNECTIONS TO UNDERGROUND UTILITIES. PRIOR TO CONSTRUCTION, THE CONTRACTOR SHALL NOTIFY THE UTILITY COMPANIES OF HIS OPERATIONAL PLANS AND SHALL OBTAIN FROM THE RESPECTIVE UTILITY COMPANIES DETAILED INFORMATION AND ASSISTANCE RELATIVE TO THE LOCATION OF THEIR FACILITIES AND THE WORKING SCHEDULE OF THE COMPANIES FOR REMOVAL OR ADJUSTMENT WHERE REQUIRED. IN THE EVENT AN UNEXPECTED UTILITY INTERFERENCE IS ENCOUNTERED DURING CONSTRUCTION, THE CONTRACTOR SHALL IMMEDIATELY NOTIFY THE UTILITY COMPANY OF JURISDICTION. THE OWNER'S REPRESENTATIVE AND/OR THE RESIDENT ENGINEER SHALL ALSO BE IMMEDIATELY NOTIFIED. ANY DAMAGE TO SUCH MAINS AND SERVICES SHALL BE RESTORED TO SERVICE AT ONCE AND PAID FOR BY THE CONTRACTOR AT NO ADDITIONAL COST TO THE CONTRACT. ALL UTILITY CABLES AND LINES SHALL BE LOCATED BY THE RESPECTIVE UTILITY. CONTACT JULIE (JOINT UTILITY LOCATION INFORMATION FOR EXCAVATORS) FOR UTILITY INFORMATION, PHONE: 1-800-892-0123. CONTACT THE FAA (FEDERAL AVIATION ADMINISTRATION) FOR ASSISTANCE IN LOCATING FAA CABLES AND UTILITIES. LOCATION OF FAA POWER, CONTROL, AND COMMUNICATION CABLES SHALL BE COORDINATED WITH AND/OR LOCATED BY THE FAA. ALSO CONTACT AIRPORT DIRECTOR/MANAGER AND AIRPORT PERSONNEL FOR ASSISTANCE IN LOCATING UNDERGROUND AIRPORT CABLES AND/OR UTILITIES. ALSO COORDINATE WORK WITH ALL ABOVEGROUND UTILITIES.

**HAUL ROUTE**

THE CONTRACTOR WILL USE AIRPORT ROAD AS HIS ACCESS TO THE PROPOSED CONSTRUCTION SITE. THE CONTRACTOR WILL COORDINATE WITH THE APPROPRIATE AUTHORITIES IN ORDER TO USE AIRPORT ROAD.

**EMPLOYEE PARKING**

THE CONTRACTOR'S EMPLOYEES WILL PARK THEIR PERSONAL VEHICLES IN THE NORTH PARKING LOT. THE CONTRACTOR WILL TRANSPORT HIS EMPLOYEES TO THE PROPOSED CONSTRUCTION SITE. ONLY CONTRACTOR VEHICLES WILL BE ALLOWED ON THE PROPOSED CONSTRUCTION SITE.

**EQUIPMENT PARKING**

THE CONTRACTOR WILL BE ALLOWED TO PARK HIS EQUIPMENT WITHIN THE LIMITS OF THE PROPOSED CONSTRUCTION. IF THERE IS NO AVAILABLE SPACE WITHIN THE PROPOSED CONSTRUCTION, THEN HE WILL PARK IN THE NORTH PARKING LOT AT A LOCATION DESIGNATED BY THE AIRPORT DIRECTOR.

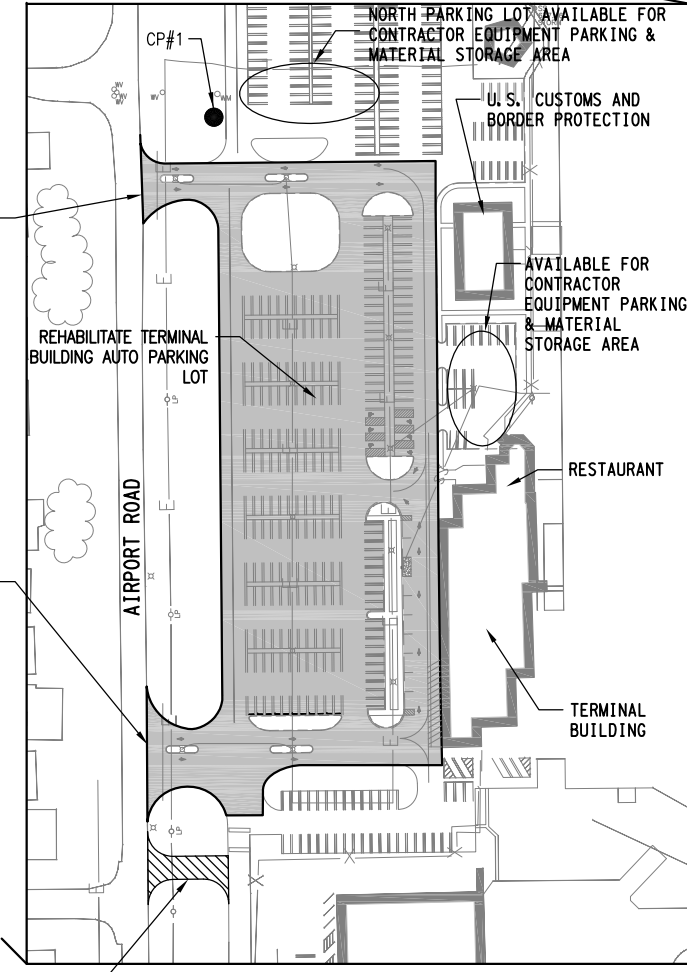

**PROJECT DETAIL**

SCALE: 1" = 100'

DE075

REVISION	DATE

**DECATUR AIRPORT**  
**DECATUR, ILLINOIS**

IL PROJ: DEC-4271

Hanson Proj. No. 13A0013	FILENAME C-003-PL.dwg	DATE 02/28/14
Scale 1" = 500'		
LAYOUT	JRH	02/07/14
DRAWN	JRH	02/07/14
REVIEWED	JDW	02/18/14

**HANSON**  
 Hanson Professional Services Inc. 2014  
 1525 South Sixth Street  
 Springfield, Illinois 62703-2886  
 Ph: (217) 788-2450 Fax: (217) 788-2503  
 www.hanson-inc.com  
 Offices Nationwide

**REHABILITATE TERMINAL AUTO PARKING LOT**

**PROJECT LAYOUT**