

STATE OF ILLINOIS  
DEPARTMENT OF TRANSPORTATION  
**PROPOSED  
HIGHWAY PLANS**

FAP 308 (IL 84)  
SECTION: (107(B-1&VB-1))BP  
PROJECT: NHPP-TL49(711)  
TYPE of IMPROVEMENT: BRIDGE PAINTING  
WHITESIDE COUNTY

F.A.P. RTE.	SECTION	COUNTY	TOTAL SHEETS	SHEET NO.
308	(107(B-1&VB-1))BP	WHITESIDE	10	1
		ILLINOIS	CONTRACT NO. 64T87	

D-92-061-25

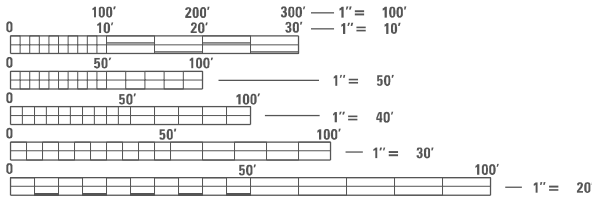
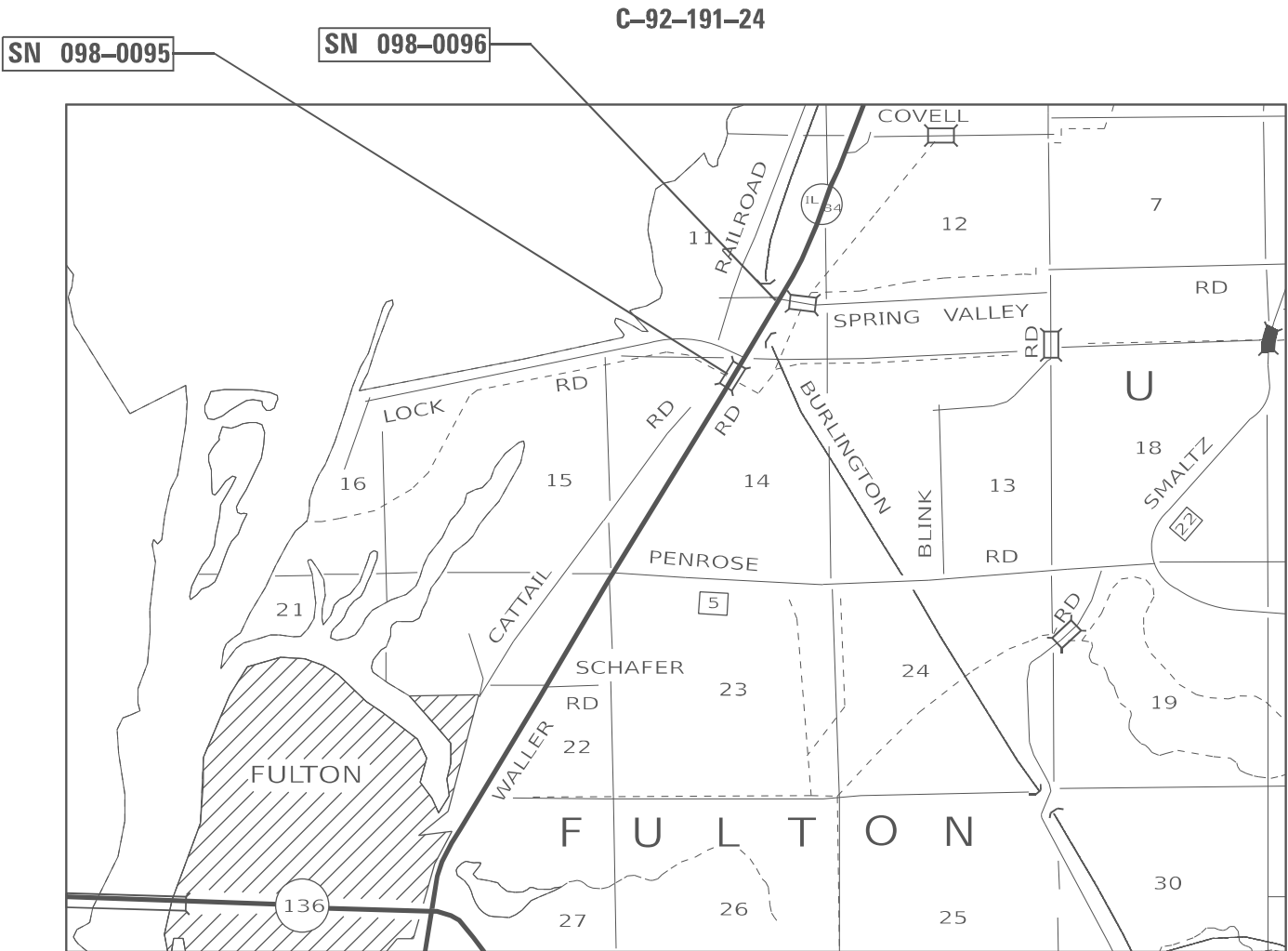
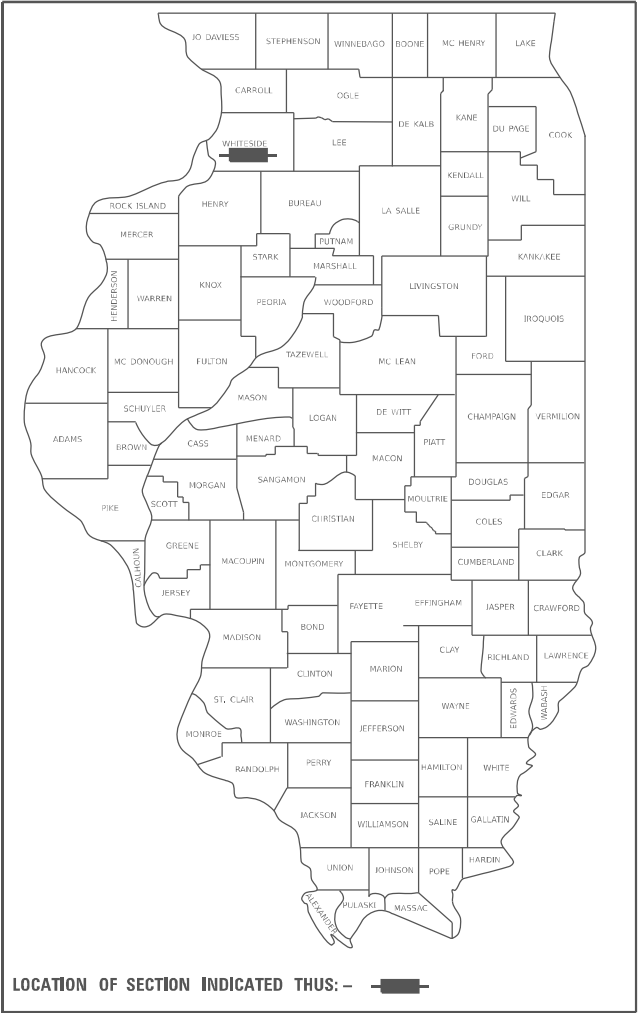

FULL SIZE PLANS HAVE BEEN PREPARED USING STANDARD  
ENGINEERING SCALES, REDUCED SIZED PLANS WILL NOT  
CONFORM TO STANDARD SCALES. IN MAKING MEASUREMENTS  
ON REDUCED PLANS, THE ABOVE SCALES MAY BE USED.

J.U.L.I.E.  
JOINT UTILITY LOCATION INFORMATION FOR EXCAVATION  
1-800-892-0123  
OR 811

PROJECT ENGINEER: DAVID DOSS (815) 284-5416  
PROJECT MANAGER: DERRICK LOPEZ (815) 284-5398

CONTRACT NO. 64T87

STATE OF ILLINOIS  
DEPARTMENT OF TRANSPORTATION

SUBMITTED February 24 20 25  
Julia Thompson  
REGIONAL ENGINEER

March 21 20 25  
Scott A. Etkin  
ENGINEER OF DESIGN AND ENVIRONMENT

March 21 20 25  
Gregory J. Perry  
DIRECTOR OF HIGHWAYS PROJECT IMPLEMENTATION

PRINTED BY THE AUTHORITY  
OF THE STATE OF ILLINOIS

# INDEX OF SHEETS

1	COVER SHEET
2	INDEX OF SHEETS / STATE STANDARDS / GENERAL NOTES
3	SUMMARY OF QUANTITIES
4	EXISTING ROADWAY TYPICAL
5	STAGING TYPICALS (SN 098-0095 AND SN 098-0096)
6-7	TRAFFIC CONTROL & PROTECTION, STANDARD 70I32I(SPECIAL) FOR SN 098-0095
8-9	TRAFFIC CONTROL & PROTECTION, STANDARD 70I32I(SPECIAL) FOR SN 098-0096
10	BSNF CONSTRUCTION NOTES

# GENERAL NOTES

LOCATION'S I& 2 - SN's 098-0095 & 098-0096

THE CONTRACTOR SHALL SEED ALL DISTURBED AREAS WITHIN THE PROJECT LIMITS. SEEDING CLASS 2A SHALL BE USED. THIS WORK WILL BE INCLUDED IN THE CONTRACT UNIT PRICE PER LUMP SUM FOR CLEANING AND PAINTING STEEL BRIDGE NO.1& NO.2

FERTILIZER SHALL BE APPLIED TO ALL DISTURBED AREAS AND INCORPORATED INTO THE SEEDBED PRIOR TO SEEDING OR PLACEMENT OF SOD AT THE RATE SPECIFIED IN SECTIONS 250 AND 252 OF THE STANDARD SPECIFICATIONS. THIS WORK SHALL BE INCLUDED IN THE COST OF CLEANING AND PAINTING STEEL BRIDGE NO.1.

MULCH METHOD IISHALL BE APPLIED OVER ALL SEEDED AREAS. THIS SHALL BE INCLUDED IN THE COST OF THE CLEANING AND PAINTING STEEL BRIDGE NO.1. & NO.2

LOCATION'S I& 2 - SN's 098-0095 & 098-0096

ALL BORROW/WASTE/USE SITES MUST BE APPROVED BY THE DEPARTMENT PRIOR TO REMOVING ANY MATERIAL FROM THE PROJECT OR INITIATING ANY EARTHMOVING ACTIVITIES, INCLUDING TEMPORARY STOCKPILING OUTSIDE THE LIMITS OF CONSTRUCTION.

TEMPORARY IMPACT ATTENUATORS WILL BE MEASURED AS EACH FOR EACH ATTENUATOR SUPPLIED ON THE JOB AS SPECIFIED IN THE PLANS, AND SHALL INCLUDE THE COST OF RENTING/OWNING THE ATTENUATOR FOR THE TIME REQUIRED ON THE JOB PLUS HAULING TO AND FROM THE PROJECT SITE, AS WELL AS ONE PLACEMENT AND REMOVAL FROM THE ROADWAY. THIS SHALL BE PAID FOR AT THE CONTRACT UNIT PRICE PER EACH FOR IMPACT ATTENUATORS, TEMPORARY OF THE TYPE SPECIFIED.

RELOCATE TEMPORARY IMPACT ATTENUATOR WILL BE PAID FOR AS EACH AND WILL BE PAID FOR EACH TIME THE ATTENUATOR IS REQUIRED BY STAGING TO BE PICKED UP AND MOVED TO A DIFFERENT LOCATION ON THE PROJECT, WHETHER IT IS TO ANOTHER LOCATION ON THE ROADWAY OR TO A STORAGE/STAGING LOCATION FOR THE PROJECT. THIS SHALL BE PAID FOR AT THE CONTRACT UNIT PRICE PER EACH FOR IMPACT ATTENUATORS, RELOCATE OF THE TYPE SPECIFIED.

THIS WORK SHALL BE DONE IN ACCORDANCE WITH SECTION 704 OF THE STANDARD SPECIFICATIONS. TEMPORARY CONCRETE BARRIER WILL BE MEASURED IN FEET ALONG THE CENTERLINE OF THE BARRIER AND SHALL INCLUDE THE COST OF RENTING/OWNING THE BARRIER FOR THE TIME REQUIRED ON THE JOB PLUS HAULING TO AND FROM THE PROJECT SITE, AS WELL AS ONE PLACEMENT AND REMOVAL FROM THE ROADWAY IN ACCORDANCE WITH SECTION 704 OF THE STANDARD AND SPECIFICATION. THIS SHALL BE PAID FOR AT THE CONTRACT UNIT PRICE PER FOOT FOR TEMPORARY CONCRETE BARRIER.

RELOCATE TEMPORARY CONCRETE BARRIER WILL BE PAID FOR IN FEET ALONG THE CENTERLINE OF THE BARRIER, AND WILL BE PAID FOR EACH TIME THE BARRIER IS REQUIRED BY STAGING TO BE PICKED UP AND MOVED TO A DIFFERENT LOCATION ON THE PROJECT, WHETHER IT IS TO ANOTHER LOCATION ON THE ROADWAY OR TO A STORAGE/STAGING LOCATION FOR THE PROJECT. THIS SHALL BE PAID FOR AT THE CONTRACT UNIT PRICE PER FOOT FOR RELOCATE TEMPORARY CONCRETE BARRIER.

THE CONTRACTOR SHALL BE RESPONSIBLE FOR PROTECTING UTILITY PROPERTY DURING CONSTRUCTION OPERATIONS AS OUTLINED IN ARTICLE 107.31OF THE STANDARD SPECIFICATIONS. A MINIMUM OF 48 HOURS ADVANCE NOTICE IS REQUIRED FOR NON-EMERGENCY WORK. THE JULIE NUMBER IS 800-892-0123.

THE SSPC QP1& QP2 CONTRACT CERTIFICATIONS WILL BE REQUIRED FOR THIS CONTRACT.

## AIR MONITORS

A MINIMUM OF 2 AIR MONITORS WILL BE REQUIRED TO MONITOR ABRASIVE BLASTING OPERATIONS, SEE SPECIAL PROVISION FOR "CONTAINMENT AND DISPOSAL OF LEAD PAINT CLEANING RESIDUES". THE SSPC QP1& QP2 CONTRACT CERTIFICATIONS WILL BE REQUIRED FOR THIS CONTRACT. THE CONTRACTOR SHALL SEED ALL DISTURBED AREAS WITHIN THE PROJECT LIMITS. SEEDING CLASS 2A SHALL BE USED. THIS WORK WILL BE INCLUDED IN THE CONTRACT UNIT PRICE PER LUMP SUM FOR CLEANING AND PAINTING STEEL BRIDGE NO.1. FERTILIZER SHALL BE APPLIED TO ALL DISTURBED AREAS AND INCORPORATED INTO THE SEEDBED PRIOR TO SEEDING OR PLACEMENT OF SOD AT THE RATE SPECIFIED IN SECTIONS 250 AND 252 OF THE STANDARD SPECIFICATIONS. THIS WORK SHALL BE INCLUDED IN THE COST OF CLEANING AND PAINTING STEEL BRIDGE NO.1. MULCH METHOD IISHALL BE APPLIED OVER ALL SEEDED AREAS. THIS SHALL BE INCLUDED IN THE COST OF THE CLEANING AND PAINTING STEEL BRIDGE NO.1. ALL BORROW/WASTE/USE SITES MUST BE APPROVED BY THE DEPARTMENT PRIOR TO REMOVING ANY MATERIAL FROM THE PROJECT OR INITIATING ANY EARTHMOVING ACTIVITIES, INCLUDING TEMPORARY STOCKPILING OUTSIDE THE LIMITS OF CONSTRUCTION. THE CONTRACTOR SHALL BE RESPONSIBLE FOR PROTECTING UTILITY PROPERTY DURING CONSTRUCTION OPERATIONS AS OUTLINED IN ARTICLE 107.31OF THE STANDARD SPECIFICATIONS. A MINIMUM OF 48 HOURS ADVANCE NOTICE IS REQUIRED FOR NON-EMERGENCY WORK. THE JULIE NUMBER IS 800-892-0123.

# STATE STANDARDS

701006-05	OFF-ROAD OPERATIONS, 2L, 2W, 15' (4.5m) TO 24" (600mm) FROM PAVEMENT EDGE
701011-04	OFF-ROAD MOVING OPERATIONS, 2L, 2W, DAY ONLY
701201-05	LANE CLOSURE, 2L, 2W, DAY ONLY, FOR SPEEDS > 45 MPH
701301-04	LANE CLOSURE, 2L, 2W, SHORT TIME OPERATIONS
701901-10	TRAFFIC CONTROL DEVICES
704001-08	TEMPORARY CONCRETE BARRIER
720011-01	METAL POSTS FOR SIGNS, MARKERS & DELINEATORS
728001-01	TELESCOPING STEEL SIGN SUPPORT
729001-01	APPLICATIONS OF TYPES A & B METAL POSTS (FOR SIGNS & MARKERS)

MODEL: Default  
FILE: \\delt-aw-bentley.com\\P\\V\\DOT\\Documents\\DOT 0 cas\\District 2\\ORD Projects\\Operations\\Bridge Section\\District 2 Counties\\Whiteside\\098-0095\\64T87\\CADD\\64T87-2-ht-cover.dgn

MODEL: Design FILE NAME:	USER NAME = David,Doss	DESIGNED -	REVISED -	STATE OF ILLINOIS DEPARTMENT OF TRANSPORTATION	INDEX OF SHEETS, STATE STANDARDS & GENERAL NOTES					F.A.P. RTE.	SECTION	COUNTY	TOTAL SHEETS	SHEET NO.
		DRAWN -	REVISED -							308	{107(B-1&VB-1)}BP	WHITESIDE	10	2
	PLOT SCALE = \$SCALE\$	CHECKED -	REVISED -							CONTRACT NO. 64T87				
	PLOT DATE = 11/20/2024	DATE -	REVISED -		SCALE:	SHEET	OF	SHEETS	STA.	TO	STA.	ILLINOIS	FED. AID PROJECT	

# SUMMARY OF QUANTITIES

CODE NUMBER	ITEM	UNIT	0047 80% STP 20% STATE	TOTAL QUANTITY
			WHITESIDE COUNTY	
67100100	MOBILIZATION	L SUM	1	1
70100450	TRAFFIC CONTROL AND PROTECTION, STANDARD 701201	L SUM	1	1
70106500	TEMPORARY BRIDGE TRAFFIC SIGNALS	EACH	1	1
70400100	TEMPORARY CONCRETE BARRIER	FOOT	600	600
70400200	RELOCATE TEMPORARY CONCRETE BARRIER	FOOT	600	600
70600250	IMPACT ATTENUATORS, TEMPORARY (NON-REDIRECTIVE), TEST LEVEL 3	EACH	2	2
70600350	IMPACT ATTENUATORS, RELOCATE (NON-REDIRECTIVE), TEST LEVEL 3	EACH	2	2
X5067501	BRIDGE CLEANING AND PAINTING WARRANTY NUMBER 1	L SUM	1	1
X7010202	TRAFFIC CONTROL AND PROTECTION, STANDARD 701321 (SPECIAL)	EACH	2	2
X8950097	RELOCATE TEMPORARY BRIDGE TRAFFIC SIGNALS	EACH	1	1
Z0007101	CONTAINMENT AND DISPOSAL OF LEAD PAINT CLEANING RESIDUES NO.1	L SUM	1	1
Z0007102	CONTAINMENT AND DISPOSAL OF LEAD PAINT CLEANING RESIDUES NO.2	L SUM	1	1
Z0010501	CLEANING AND PAINTING STEEL BRIDGE NO. 1	L SUM	1	1
Z0010502	CLEANING AND PAINTING STEEL BRIDGE NO.2	L SUM	1	1
Z0048665	RAILROAD PROTECTIVE LIABILITY INSURANCE	L SUM	1	1

MODEL: Default  
FILE: \\natick-pw-bentley.com\PW\DOT\Documents\DOT 0 ces\District 2\ORR Projects\Operations\Bridge\_Section\District 2\_Counties\Whiteside\095-0095\64T87\CADD\64T87-qt-cover.dgn

	USER NAME = David.Doss	DESIGNED -	REVISED -	STATE OF ILLINOIS DEPARTMENT OF TRANSPORTATION	SUMMARY OF QUANTITIES					F.A.P. RTE.	SECTION	COUNTY	TOTAL SHEETS	SHEET NO.
		DRAWN -	REVISED -							308	{107(B-1&VB-1)}BP	WHITESIDE	10	3
	PLOT SCALE = \$SCALE\$	CHECKED -	REVISED -							CONTRACT NO. 64T87				
	PLOT DATE = 11/20/2024	DATE -	REVISED -		SCALE:	SHEET	OF	SHEETS	STA.	TO	STA.			
												ILLINOIS	FED. AID PROJECT	

# EXISTING TYPICAL SN 098-0095 & SN 098-0096

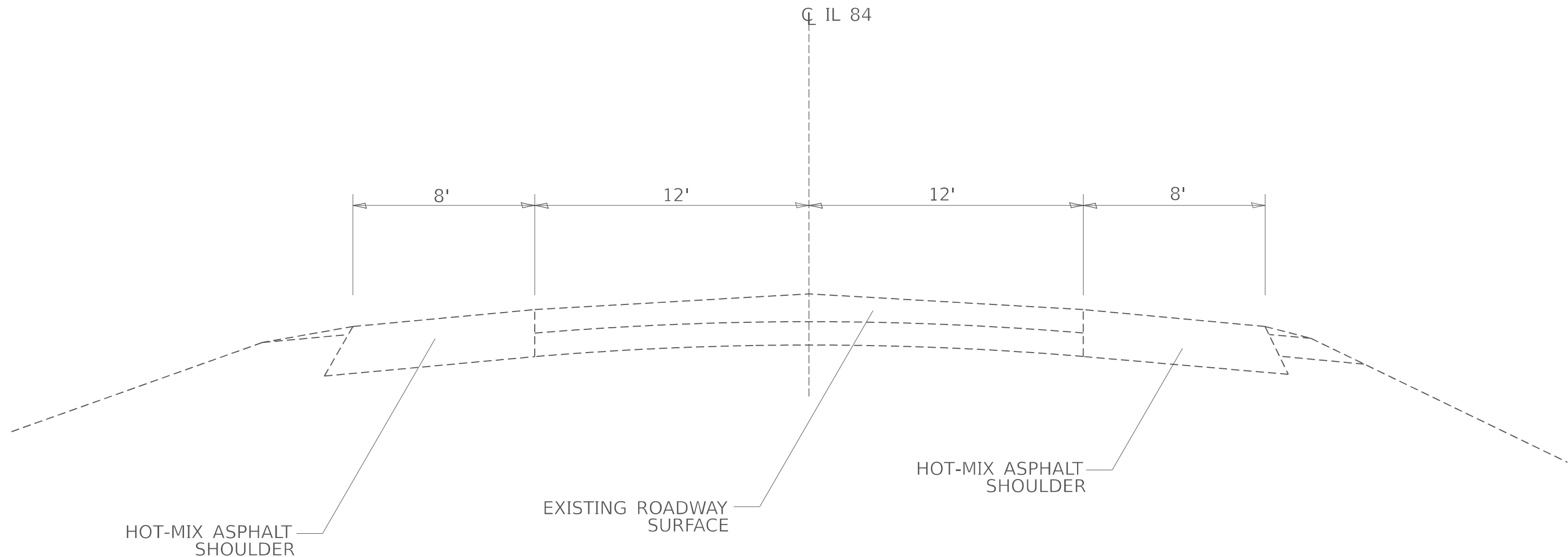

MODEL: Default  
FILE: \\nauc1c-pw\llet-pw-bentley.com\pl\llet-pw\DOT Documents\DOT 0 cas\District 2\ORR Projects\Operations\Bridges Section\District 2 Counties\Whiteside\098-0095\64T87\CAD\064T87-ht-cover.dgn

	USER NAME = David.Doss	DESIGNED -	REVISED -	STATE OF ILLINOIS DEPARTMENT OF TRANSPORTATION	EXISTING TYPICAL SN 098-0095 & SN 098-0096		F.A.P. RTE.	SECTION	COUNTY	TOTAL SHEETS	SHEET NO.
		DRAWN -	REVISED -				308	{107(B-1&VB-1))BP	WHITESIDE	10	4
	PLOT SCALE = \$SCALE\$	CHECKED -	REVISED -				CONTRACT NO. 64T87				
	PLOT DATE = 11/20/2024	DATE -	REVISED -		SCALE:	SHEET OF SHEETS	STA.	TO STA.	ILLINOIS FED. AID PROJECT		

# STAGING TYPICAL SN 098-0095 & SN 098-0096

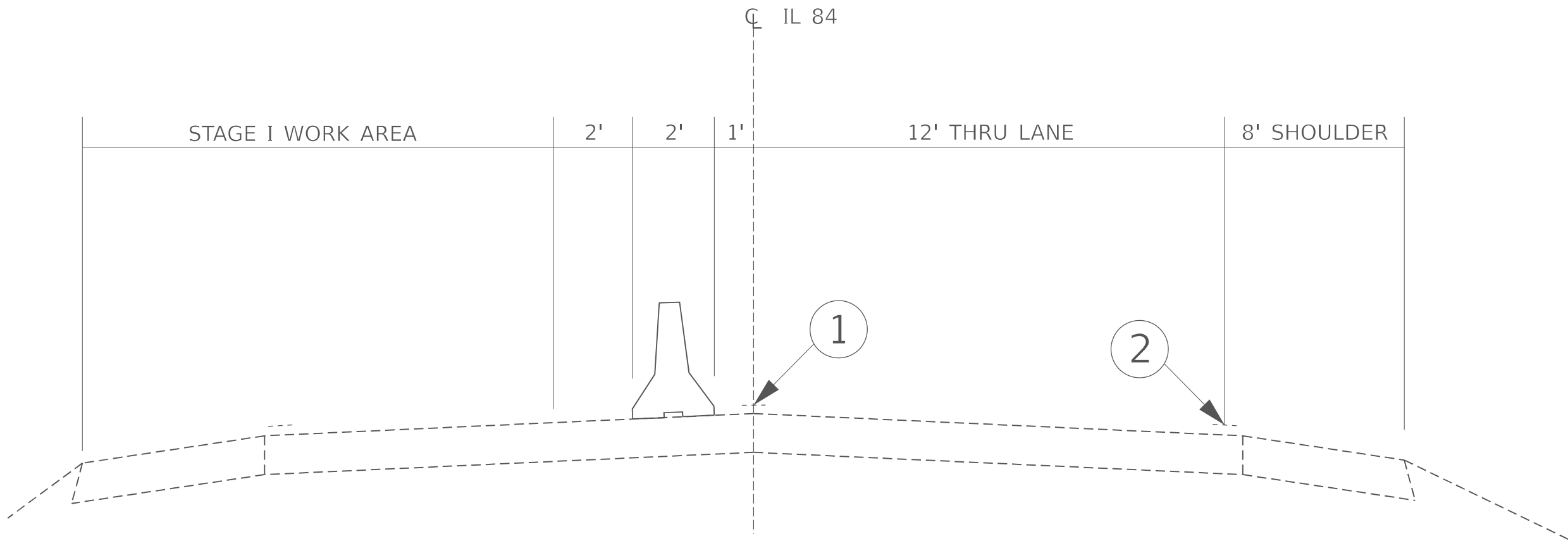

- ① TEMPORARY PAVEMENT MARKING TAPE SHALL BE PLACED THROUGHOUT THE TAPER AND ALONG-SIDE THE WORK AREA. THE RIGHT EDGE LINE SHALL BE WHITE AND THE LEFT EDGE LINE SHALL BE YELLOW.
- ② EXISTING PAVEMENT MARKING LINE

MODEL: Default  
FILE: \\nauc1c-pw\llet-aw-bentley.com\PIV\DOT\Documents\DOT 0 cas\District 2\ORR Projects\Operations\Bridge Section\District 2 Counties\Whiteside\098-0095\64T87\CADD\64T87-rt-cover.dgn

	USER NAME = David.Doss	DESIGNED -	REVISED -	STATE OF ILLINOIS DEPARTMENT OF TRANSPORTATION	STAGING TYPICAL SN 098-0095 & SN 098-0096		F.A.P. RTE.	SECTION	COUNTY	TOTAL SHEETS	SHEET NO.
		DRAWN -	REVISED -				308	{107(B-1&VB-1))BP	WHITESIDE	10	5
	PLOT SCALE = \$SCALE\$	CHECKED -	REVISED -				CONTRACT NO. 64T87				
	PLOT DATE = 11/20/2024	DATE -	REVISED -		SCALE:	SHEET OF SHEETS	STA.	TO STA.	ILLINOIS FED. AID PROJECT		

MODEL: Default  
FILE: \\dot-pw-bentley.com\pl\dot-pw\Documents\DOT 0 cas\District 2\ORR Projects\Operations\Bridge Section\District 2 Counties\Whiteside\098-0095\64T87\CADD\64T87-RT-cover.dgn

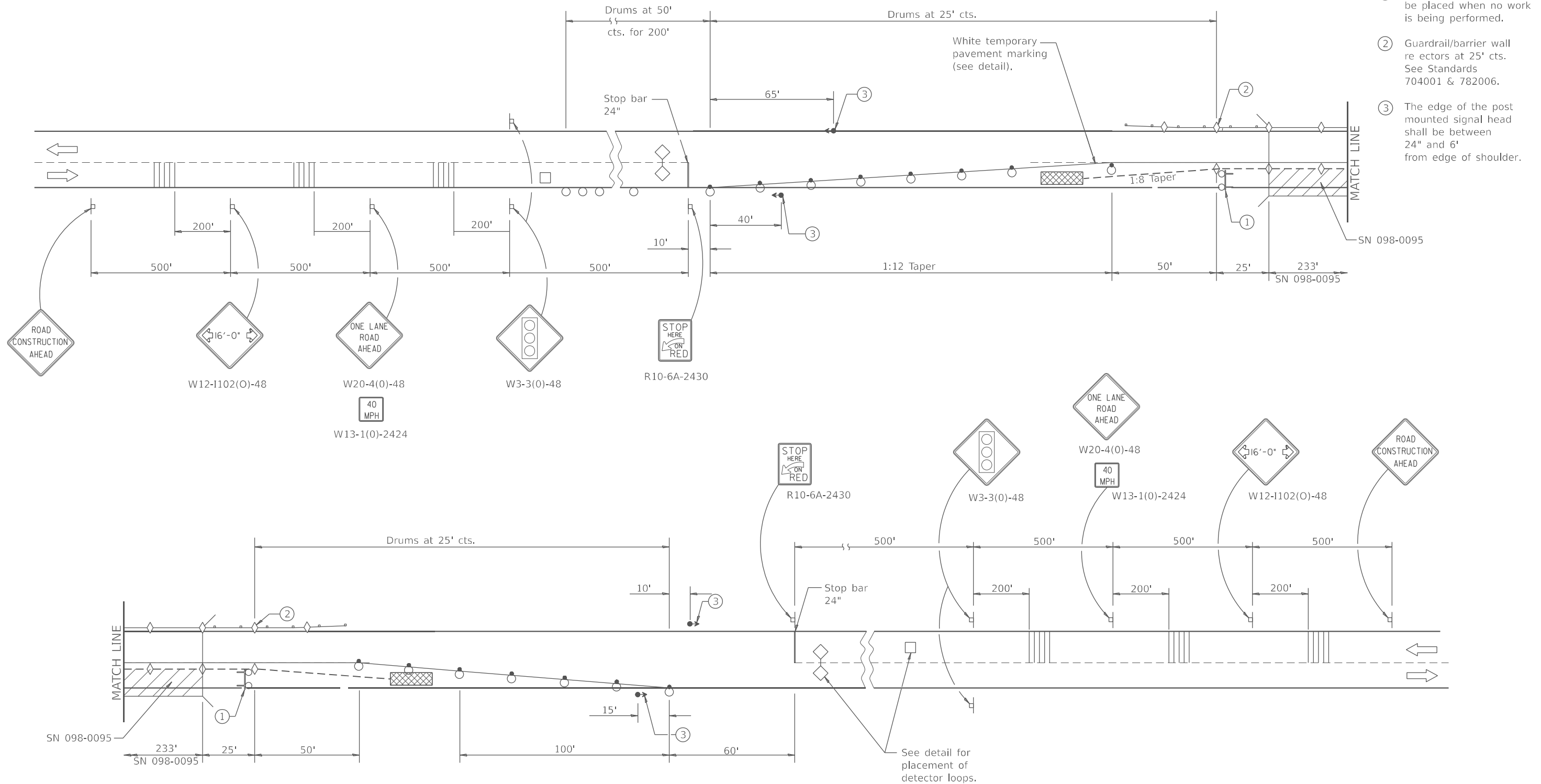

### SYMBOLS

	Work area		Drum with steady burning bi-directional light		Detector loops
	Sign		Temporary concrete barrier		Impact attenuator
	Type III barricade with flashing lights		Temporary rumble strip (when speci ed)		Crystal, bidirectional guardrail/barrier wall re ctor
	Tra c signal		Double vertical panel (see detail)		Drum

STATE OF ILLINOIS  
DEPARTMENT OF TRANSPORTATION

TRAFFIC CONTROL & PROTECTION, STANDARD 701321 (SPECIAL)  
FOR LOCATION SN 098-0095

SCALE: SHEET OF SHEETS STA. TO STA.

F.A.P. RTE.	SECTION	COUNTY	TOTAL SHEETS	SHEET NO.
308	(107(B-1&VB-1))BP	WHITESIDE	10	6
CONTRACT NO. 64T87				
ILLINOIS FED. AID PROJECT				

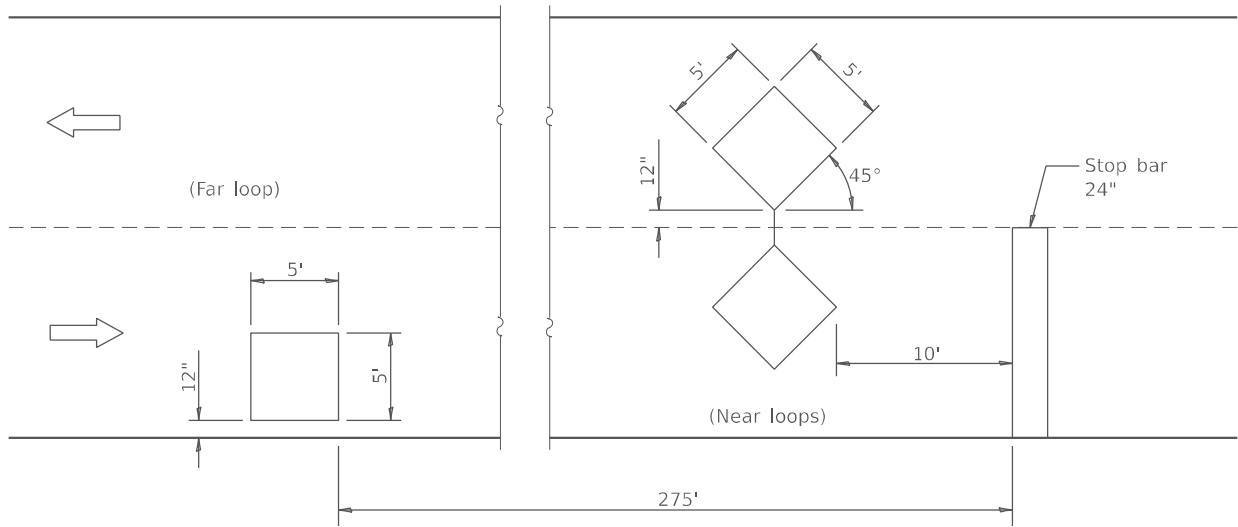

DETECTOR LOOPS

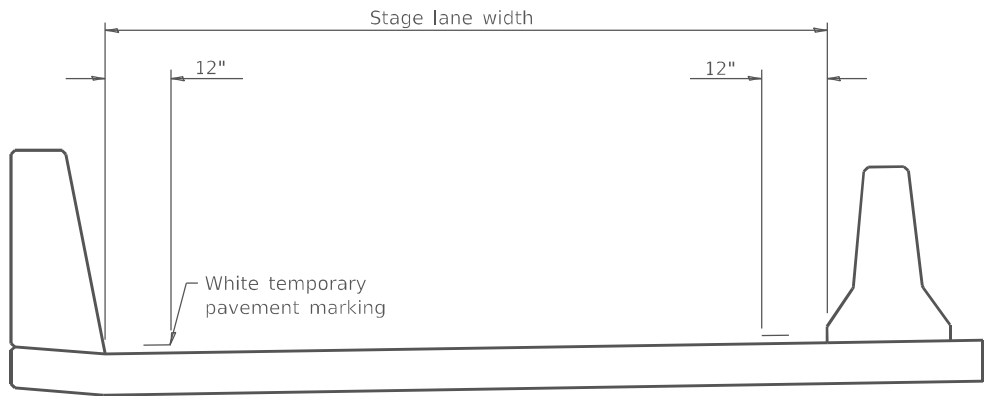

TEMPORARY PAVEMENT MARKING

TRAFFIC SIGNAL SEQUENCE						
PHASE	A			B		
INTERVAL	1	2	3	4	5	6
NORTHBOUND OR EASTBOUND	G	Y	R	R	R	R
SOUTHBOUND OR WESTBOUND	R	R	R	G	Y	R

TEMPORARY CONCRETE BARRIER	
NORMAL POSTED SPEED	TAPER RATIO
40 mph AND ABOVE	12:1
BELOW 40 mph	8:1

ADVISORY SPEED LIMIT	
NORMAL POSTED SPEED	ADVISORY SPEED
55 - 45 mph	40 mph
40 mph	35 mph
35 - 30 mph	30 mph

PAVEMENT MARKINGS

ALL TEMPORARY PAVEMENT MARKING SHALL BE, PAVEMENT MARKING TAPE, TYPE IV 4" AND THE MATERIALS SHALL BE ACCORDING TO ARTICLE 1095.06 OF THE STANDARD AND SPECIFICATIONS. THE CONTRACTOR SHALL INSTALL, MAINTAIN AND REMOVE ALL TEMPORARY PAVEMENT MARKING TAPE. THIS WORK SHALL NOT BE PAID SEPERATELY AND SHALL BE INCLUDED IN THE COST OF THE "TRAFFIC CONTROL AND PROTECTION STANDARD 701321 (SPECIAL)".

ALL CONFLICTING PAVEMENT MARKINGS AND RAISED REFLECTIVE PAVEMENT MARKERS SHALL BE PROTECTED PRIOR TO COVERING WITH PAVEMENT MARKING BLACKOUT TAPE, 4". PAVEMENT MARKING BLACKOUT TAPE, 4", SHALL EXTEND A MINIMUM OF 2 INCHES BEYOND THE EXISTING MARKINGS OR REFLECTORS IN ALL DIRECTIONS. THIS WORK SHALL INCLUDE PROTECTING EXISTING PAVEMENT MARKINGS AND RAISED REFLECTIVE PAVEMENT MARKERS, INSTALLING, MAINTAINING AND REMOVING BLACKOUT TAPE. THIS WORK SHALL NOT BE PAID SEPERATELY AND SHALL BE INCLUDED IN THE COST OF THE "TRAFFIC CONTROL AND PROTECTION STANDARD 701321 (SPECIAL)".

GENERAL NOTES

This Standard is used where, at any time, any vehicle, equipment, workers, or their activities will encroach on one lane of a bridge. Traffic signals and a positive barrier are required.

Traffic signals shall be operational only when all traffic controls are in place. When traffic signals are not in operation, flaggers shall be used and traffic control shall conform to Standard 701201 or 701206.

Temporary concrete barrier shall be according to Standard 704001.

Existing or temporary pavement markings shall be on both sides of open lane from stop bar to stop bar.

MODEL: Default  
FILE: \\nashville-arj\dotaw-bentley.com\PI\DOT\Documents\DOT 0 cas\District 2\ORR Projects\Operations\Bridge Section\District 2 Counties\Whiteside\098-0095\64T87\CADD\64T87-PT-cover.dgn

USER NAME = David.Doss	DESIGNED -	REVISED -
	DRAWN -	REVISED -
PLOT SCALE = \$SCALE\$	CHECKED -	REVISED -
PLOT DATE = 11/20/2024	DATE -	REVISED -

STATE OF ILLINOIS  
DEPARTMENT OF TRANSPORTATION

TRAFFIC CONTROL & PROTECTION, STANDARD 701321 (SPECIAL)  
FOR SN 098-0095

SCALE: SHEET OF SHEETS STA. TO STA.

F.A.P. RTE.	SECTION	COUNTY	TOTAL SHEETS	SHEET NO.
308	(107(B-1&VB-1))BP	WHITESIDE	10	7
CONTRACT NO. 64T87				
ILLINOIS FED. AID PROJECT				





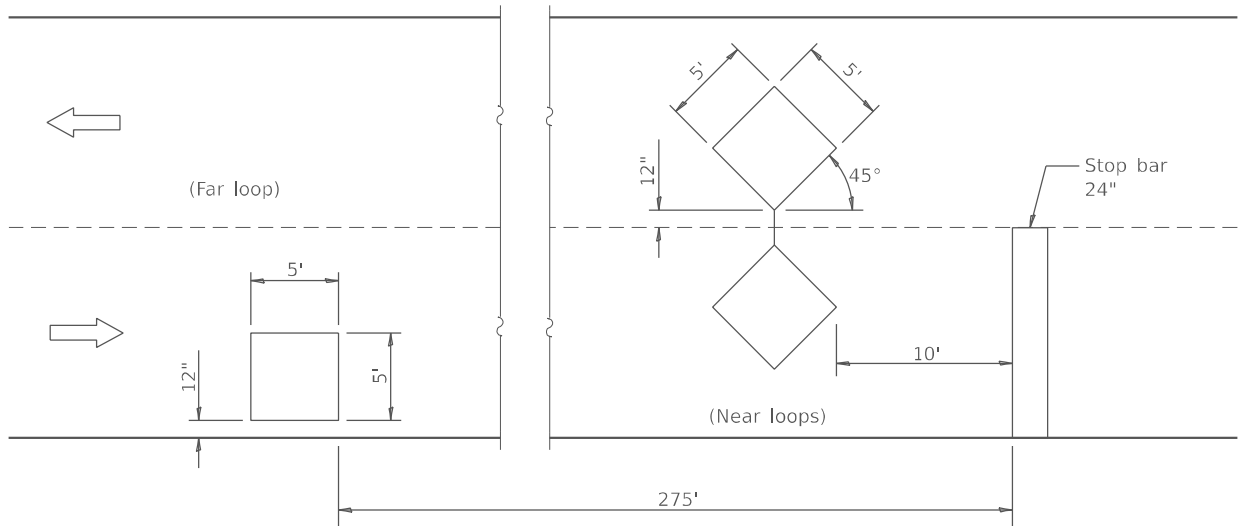

DETECTOR LOOPS

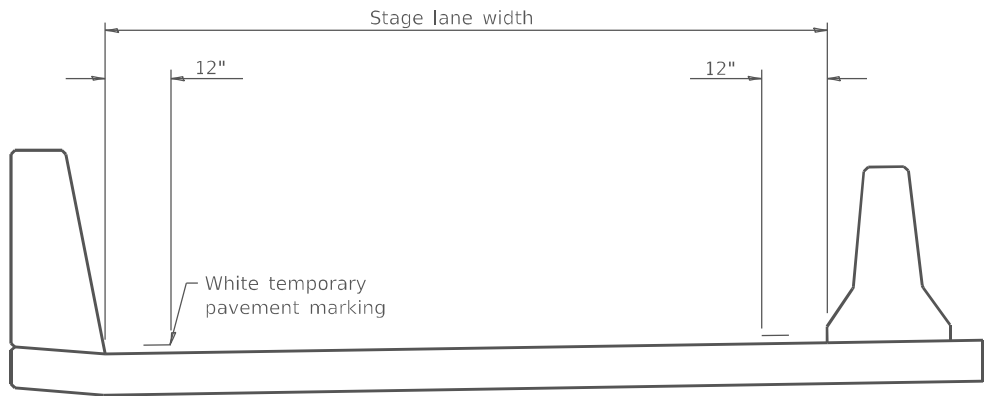

TEMPORARY PAVEMENT MARKING

TRAFFIC SIGNAL SEQUENCE						
PHASE	A			B		
INTERVAL	1	2	3	4	5	6
NORTHBOUND OR EASTBOUND	G	Y	R	R	R	R
SOUTHBOUND OR WESTBOUND	R	R	R	G	Y	R

TEMPORARY CONCRETE BARRIER	
NORMAL POSTED SPEED	TAPER RATIO
40 mph AND ABOVE	12:1
BELOW 40 mph	8:1

ADVISORY SPEED LIMIT	
NORMAL POSTED SPEED	ADVISORY SPEED
55 - 45 mph	40 mph
40 mph	35 mph
35 - 30 mph	30 mph

PAVEMENT MARKINGS

ALL TEMPORARY PAVEMENT MARKING SHALL BE, PAVEMENT MARKING TAPE, TYPE IV 4" AND THE MATERIALS SHALL BE ACCORDING TO ARTICLE 1095.06 OF THE STANDARD AND SPECIFICATIONS. THE CONTRACTOR SHALL INSTALL, MAINTAIN AND REMOVE ALL TEMPORARY PAVEMENT MARKING TAPE. THIS WORK SHALL NOT BE PAID SEPERATELY AND SHALL BE INCLUDED IN THE COST OF THE "TRAFFIC CONTROL AND PROTECTION STANDARD 701321 (SPECIAL)".

ALL CONFLICTING PAVEMENT MARKINGS AND RAISED REFLECTIVE PAVEMENT MARKERS SHALL BE PROTECTED PRIOR TO COVERING WITH PAVEMENT MARKING BLACKOUT TAPE, 4". PAVEMENT MARKING BLACKOUT TAPE, 4", SHALL EXTEND A MINIMUM OF 2 INCHES BEYOND THE EXISTING MARKINGS OR REFLECTORS IN ALL DIRECTIONS. THIS WORK SHALL INCLUDE PROTECTING EXISTING PAVEMENT MARKINGS AND RAISED REFLECTIVE PAVEMENT MARKERS, INSTALLING, MAINTAINING AND REMOVING BLACKOUT TAPE. THIS WORK SHALL NOT BE PAID SEPERATELY AND SHALL BE INCLUDED IN THE COST OF THE "TRAFFIC CONTROL AND PROTECTION STANDARD 701321 (SPECIAL)".

GENERAL NOTES

This Standard is used where, at any time, any vehicle, equipment, workers, or their activities will encroach on one lane of a bridge. Traffic signals and a positive barrier are required.

Traffic signals shall be operational only when all traffic controls are in place. When traffic signals are not in operation, flaggers shall be used and traffic control shall conform to Standard 701201 or 701206.

Temporary concrete barrier shall be according to Standard 704001.

Existing or temporary pavement markings shall be on both sides of open lane from stop bar to stop bar.

MODEL: Default  
FILE: \\dot-aw-bentley.com\\P\\DOT\\Documents\\DOT 0 cas\\District 2\\ORD Projects\\Operations\\Bridge Section\\District 2 Counties\\Whiteside\\098-0095\\64T87\\CADD\\64T87-ht-cover.dgn

	USER NAME = David.Doss	DESIGNED -	REVISED -	STATE OF ILLINOIS DEPARTMENT OF TRANSPORTATION	TRAFFIC CONTROL & PROTECTION, STANDARD 701321 (SPECIAL) FOR SN 098-0096			F.A.P. RTE.	SECTION	COUNTY	TOTAL SHEETS	SHEET NO.
		DRAWN -	REVISED -					308	(107(B-1&VB-1))BP	WHITESIDE	10	9
	PLOT SCALE = \$SCALE\$	CHECKED -	REVISED -					CONTRACT NO. 64T87				
	PLOT DATE = 11/20/2024	DATE -	REVISED -					ILLINOIS FED. AID PROJECT				
SCALE:		SHEET	OF	SHEETS	STA.	TO STA.						

FILE NAME: P:\ustation\dgn\std\pp-guidelines.dgn

CONSTRUCTION NOTES:

- 1. Any shoring system that impacts the Railroad's operation and/or supports the Railroad's embankment shall be designed and constructed per Railroad Guidelines for Temporary Shoring.
- 2. All demolition within the Railroad's right-of-way and/or demolition that may impact the Railroad's tracks or operations shall comply with the Railroad's Demolition requirements.
- 3. Erection over the Railroad's track shall be planned such that it enables the track(s) to remain open to traffic per Railroad requirements.
- 4. The elevation of the existing top-of-rail profile shall be verified before beginning construction. All discrepancies shall be brought to the attention of the Railroad prior to construction.
- 5. The proposed grade separation project shall not change the quantity and/or characteristics of the flow in the Railroad ditches and/or drainage structures.
- 6. The contractor must submit a proposed method of erosion and sediment control and have the method approved by the Railroad prior to beginning any grading on the project site.
- 7. For Railroad coordination please refer to the Railroad's Coordination Requirements as part of the Specifications or Special Provisions of the project.
- 8. Temporary Construction Clearances, including falsework clearances, shall comply with Figure 1.
- 9. All permanent clearances shall be verified before project closeout.

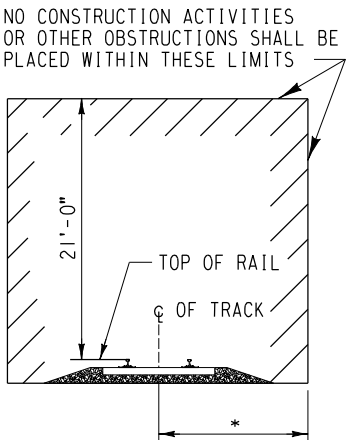



MINIMUM CONSTRUCTION CLEARANCE ENVELOPE

(NORMAL TO RAILROAD)

FIGURE 1

\* 15'-0" for BNSF and 12'-0" for UPRR

REVISIONS			DESIGN BY: RAF	DRAWN BY: KDM	CHECKED BY: KHJ
DATE	LTR.	DESCRIPTION	APPROVED:		
/			<div>K.H. Jennison</div> <div>BNSF - ASSISTANT DIRECTOR STRUCTURES DESIGN</div> <div>George J. Meyn</div> <div>UPRR - MGR SPECIAL PROJECTS STRUCTURES DESIGN</div>		
/					
/					
/					
/					
/					
/					



**BRIDGE STANDARDS**  
GRADE SEPARATION GUIDELINES (OVERHEADS)

**CONSTRUCTION NOTES**

FILE OWNER: UPRR

DATE: 1/24/07

PLAN NO.: 711100

SHEET: 3

PLOTTED: 3/30/2007 2:54:07 PM