

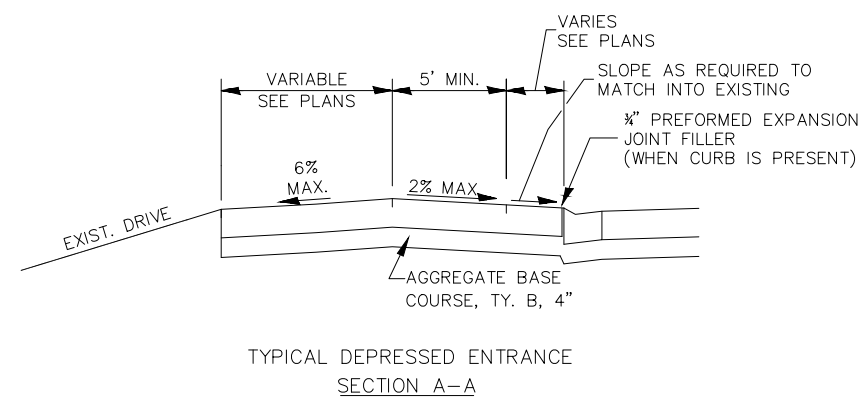



CHAMLIN & ASSOCIATES, INC. © 2025  
 Drawing Name: G:\Users\A\66499-00-Mendota Safe Routes to School 2024\CAD\02-NOTES.dwg  
 Last Modified: Tuesday, February 4, 2025 3:34:19 PM  
 Plotted On: Friday, February 7, 2025 8:10:10 AM by Adam Ostola



TYPICAL DEPRESSED ENTRANCE SECTION A-A

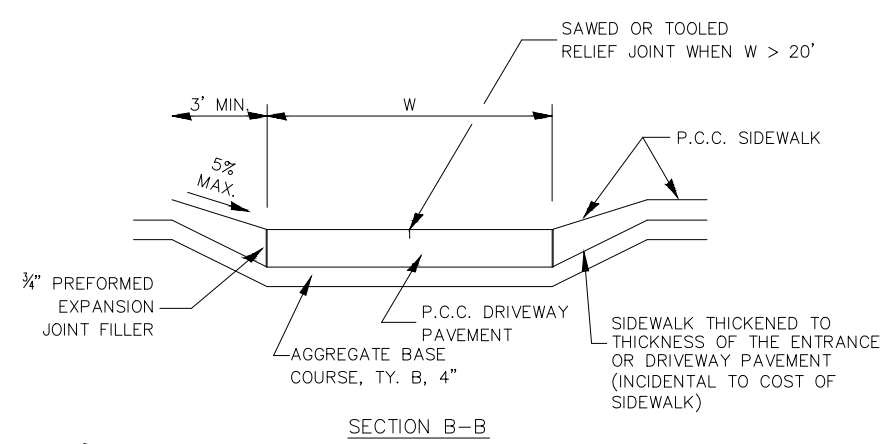

SECTION B-B

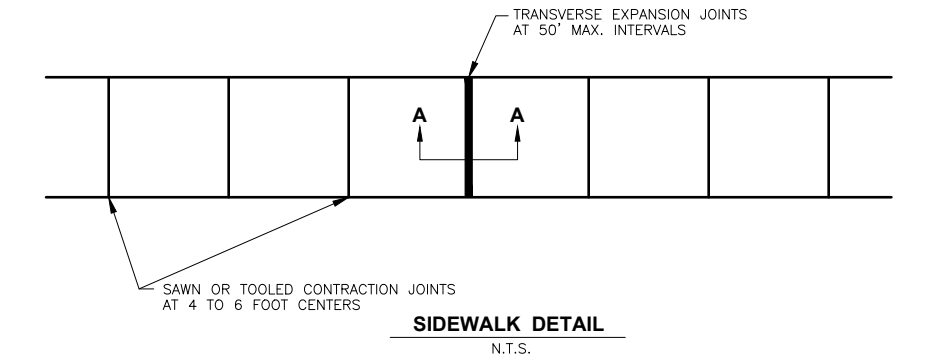

SIDEWALK DETAIL N.T.S.

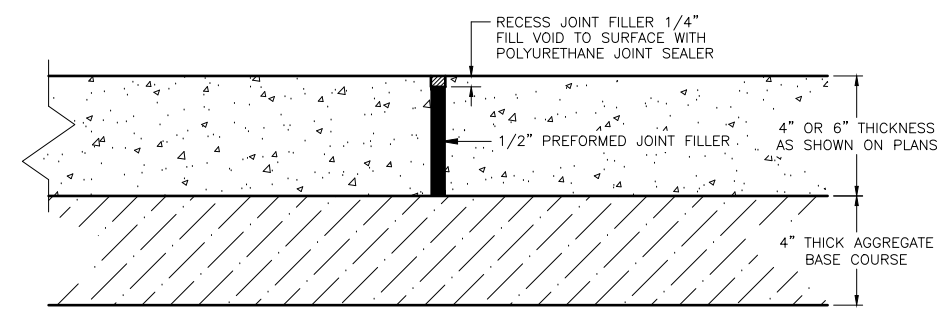

SECTION A-A N.T.S.

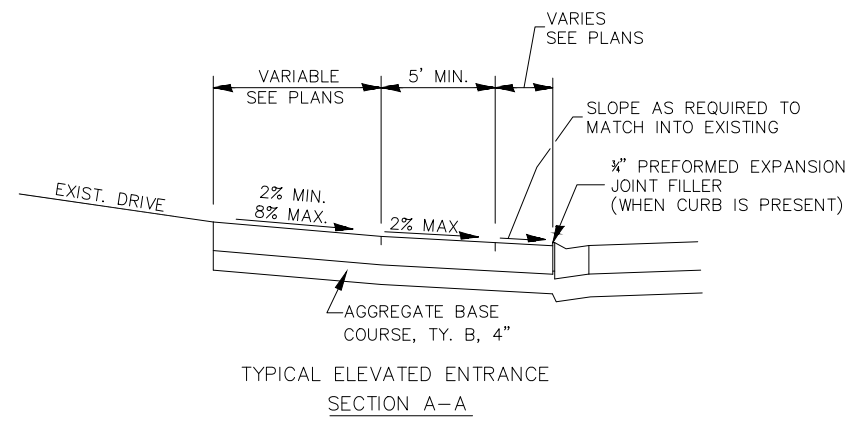

TYPICAL ELEVATED ENTRANCE SECTION A-A

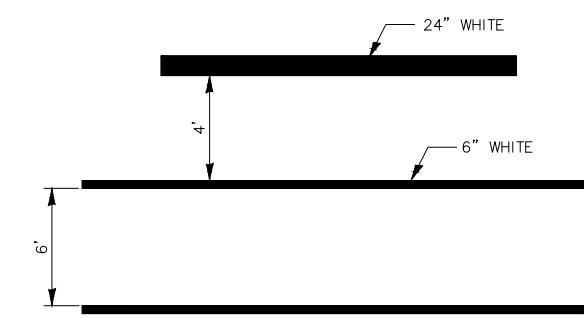
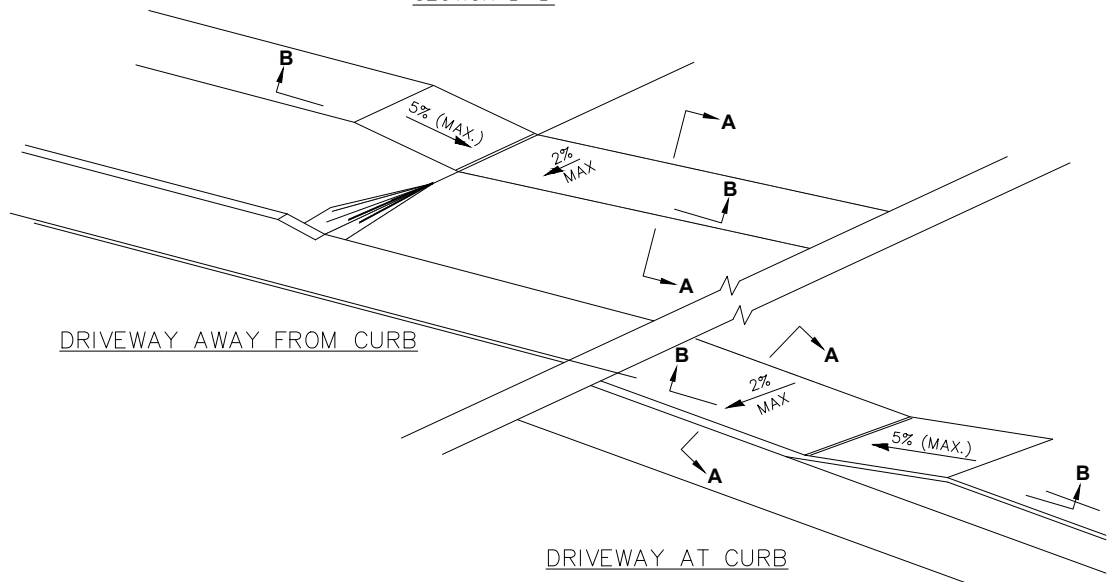

TYPICAL SPACING DETAIL FOR CROSSWALKS AND STOP BARS

**GENERAL NOTES**

- LIMITS OF SIDEWALK REMOVAL IS GENERALLY INTENDED TO BE AT AN EXISTING JOINT IN THE SIDEWALK. A FULL DEPTH SAWCUT WILL BE REQUIRED AT ALL EDGES OF SIDEWALK OR PAVEMENT TO BE REMOVED THAT BORDERS OTHER SIDEWALKS OR PAVEMENTS.
- SEEDING WILL NOT BE PERMITTED AT ANY TIME WHEN THE GROUND IS FROZEN, WET, OR IN AN UNTILLABLE CONDITION. LOCATIONS TO BE SEEDED WILL BE DETERMINED BY THE ENGINEER.
- ONLY THOSE TREES DESIGNATED BY THE ENGINEER OR LISTED IN THE TREE REMOVAL SCHEDULE SHALL BE REMOVED. THE CONTRACTOR SHALL PROTECT ALL REMAINING TREES FROM DAMAGE DUE TO HIS OPERATIONS.
- DETECTABLE WARNING SURFACES SHALL EXTEND 2.0 FT MINIMUM IN THE DIRECTION OF PEDESTRIAN TRAVEL. AT CURB RAMP AND BLENDED TRANSITIONS, DETECTABLE WARNING SURFACES SHALL EXTEND THE FULL WIDTH OF THE RAMP RUN (EXCLUDING ANY FLARES) OR BLENDED TRANSITIONS. SOME DETECTABLE WARNING PRODUCTS REQUIRE A CONCRETE BORDER FOR PROPER INSTALLATION. THE CONCRETE BORDER SHALL NOT EXCEED 2 INCHES.
- ANY REFERENCE TO A STANDARD IN THESE PLANS SHALL BE INTERPRETED TO MEAN THE EDITION AS INDICATED BY THE SUBNUMBER SHOWN IN THE LIST OF STANDARDS OR THE COPY INCLUDED IN THE PLANS.
- THE CONTRACTOR SHALL CONTACT JULIE AT LEAST 48 HOURS PRIOR TO EXCAVATION TO DETERMINE WHICH UTILITIES ARE IN THE AREA.
- THE COST OF GRADING AND COMPACTING SUBBASE FOR SIDEWALK OR DRIVEWAYS SHALL BE INCLUDED IN THE COST OF SIDEWALK REMOVAL OR DRIVEWAY PAVEMENT REMOVAL.
- THE FINISHED EARTHWORK SHALL HAVE A VEGETATION SUSTAINING SOIL COVERING THE TOP SIX INCHES IN AREAS TO BE SEEDED OR SODDED. THE VEGETATION SUSTAINING SOIL REQUIRED WILL NOT BE PAID FOR SEPARATELY BUT WILL BE INCLUDED IN THE COST OF THE LANDSCAPING, SPECIAL PAY ITEM.
- THE FOLLOWING RATES OF APPLICATION HAVE BEEN USED IN CALCULATING PLAN QUANTITIES:  
 GRANULAR MATERIALS 2.05 TONS/CU YD  
 HOT MIX ASPHALT 112 LBS/SQ YD/IN  
 BITUMINOUS MATERIALS PRIME COAT OVER AGGREGATE BASE: 0.25 LB/SQ FT RESIDUAL ASPHALT  
 BITUMINOUS MATERIALS TACK COAT BETWEEN HMA LIFTS: 0.025 LB/SQ FT RESIDUAL ASPHALT
- THE COST OF EXCAVATING AND DISPOSING OF MATERIAL BELOW AND/OR OUTSIDE OF EXISTING SIDEWALKS OR CURBS OR DRIVEWAYS AS REQUIRED TO INSTALL THE SPECIFIED AGGREGATE BASE AND AS MAY BE NECESSARY TO INSTALL FORMWORK SHALL BE CONSIDERED INCLUDED IN THE COST OF THE SIDEWALK, CURB, AND DRIVEWAY PAY ITEMS.
- THE FINISHED SURFACE OF SIDEWALKS SHALL HAVE A CROSS-SLOPE (MEASURED PERPENDICULAR TO THE TRAVEL DIRECTION) LESS THAN OR EQUAL TO 2%.
- WHERE EXCAVATIONS ARE MADE OUTSIDE OF CURBS OR CURB AND GUTTER TO ALLOW FOR FORMWORK, SUCH EXCAVATIONS SHALL BE FILLED TO THE BOTTOM OF THE PROPOSED INCIDENTAL HMA USING COMPACTED AGGREGATE BASE COURSE
- WHERE INCIDENTAL HMA SURFACING IS SPECIFIED ADJACENT TO PROPOSED CURBS, REMOVAL OF EXISTING PAVEMENTS OR AGGREGATES TO A DEPTH AS REQUIRED TO CONSTRUCT THE 5" THICK INCIDENTAL HMA SURFACE ALONG WITH GRADING AND COMPACTION OF THE BASE WILL NOT BE PAID FOR SEPARATELY, BUT SHALL BE CONSIDERED INCLUDED IN THE COST OF THE INCIDENTAL HMA SURFACING PAY ITEM.
- INCIDENTAL HMA SHALL BE PLACED IN A MINIMUM OF 2 LIFTS.
- WHERE INCIDENTAL HMA SURFACING IS SPECIFIED FOR DRIVEWAYS, REMOVAL OF THE EXISTING HMA DRIVEWAY PAVEMENT AND UNDERLYING MATERIALS TO A DEPTH AS REQUIRED TO CONSTRUCT THE 5" THICK INCIDENTAL HMA SURFACE ALONG WITH GRADING AND COMPACTION OF THE BASE WILL BE PAID FOR AS DRIVEWAY PAVEMENT REMOVAL.

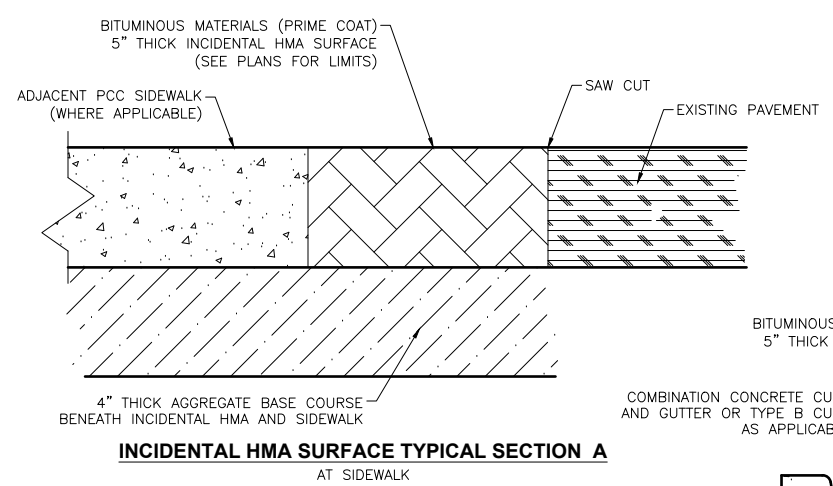

INCIDENTAL HMA SURFACE TYPICAL SECTION A AT SIDEWALK

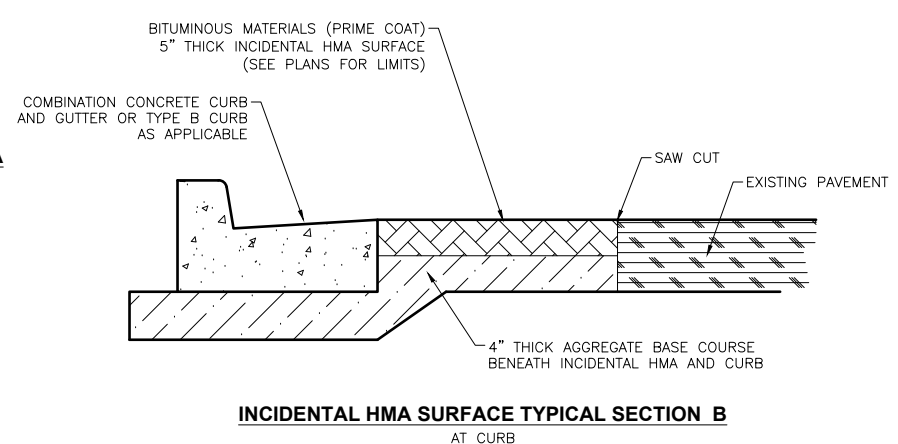

INCIDENTAL HMA SURFACE TYPICAL SECTION B AT CURB

HMA MIXTURE REQUIREMENT TABLE	
LOCATIONS:	ENTIRE PROJECT
MIXTURE USE(S):	INCIDENTAL HMA
BINDER GRADE (PG):	PG 64-22
DESIGN AIR VOIDS:	4.0% @ N50
MIXTURE COMPOSITION: (MIXTURE GRADATION)	IL 9.5
FRICTION AGGREGATE:	MIXTURE C
MIXTURE WEIGHT:	112.0 LB/SY/IN
QUALITY MANAGEMENT PROGRAM:	QCQA
SUBLOT SIZE:	N/A
DENSITY TEST METHOD:	SATISFACTION OF ENGINEER
MATERIAL TRANSFER DEVICE (REQUIRED):	NO

DRAWN BY: KED	REVISIONS			
	LEVEL	BY	DATE	DESCRIPTION
CHECKED BY: AJQ				
DATE: 08/2024				

**CA**  
 Chamlin & Associates  
 PERU MORRIS  
 OTTAWA MORTON  
 ILLINOIS

**CITY OF MENDOTA**  
**SAFE ROUTES TO SCHOOL**  
**SECTION 24-0064-00-SW**

**GENERAL NOTES AND DETAILS**

**CONTRACT NO. 87881**

CURRENT AS OF: 1/31/2025	
SCALE: AS NOTED	SHEET 2
FILE NO.: 66499.00 Y-	OF 12

CHAMLIN & ASSOCIATES, INC. © 2025  
 Drawing Name: G:\Users\AJO\OneDrive\Documents\2024\2024-0003-SOQ.dwg  
 Last Modified: Friday, February 7, 2025 1:39:20 PM  
 Plotted On: Friday, February 7, 2025 3:35:19 PM  
 by Adam Ossola

### SUMMARY OF QUANTITIES

ITEM #	ITEM DESCRIPTION	UNIT	QUANTITY
35101400	AGGREGATE BASE COURSE, TYPE B	TON	456
40200800	AGGREGATE SURFACE COURSE, TYPE B	TON	12
* 40800025	BITUMINOUS MATERIALS (PRIME COAT)	POUND	1075
* 40800029	BITUMINOUS MATERIALS (TACK COAT)	POUND	113
* 40800050	INCIDENTAL HOT-MIX ASPHALT SURFACING	TON	133
42300200	PORTLAND CEMENT CONCRETE DRIVEWAY PAVEMENT, 6 INCH	SQ YD	142
42400100	PORTLAND CEMENT CONCRETE SIDEWALK 4 INCH	SQ FT	10186
42400800	DETECTABLE WARNINGS	SQ FT	255
44000200	DRIVEWAY PAVEMENT REMOVAL	SQ YD	289
44000300	CURB REMOVAL	FOOT	1078
44000600	SIDEWALK REMOVAL	SQ FT	6069
56500600	DOMESTIC WATER SERVICE BOXES TO BE ADJUSTED	EACH	1
60260100	INLETS TO BE ADJUSTED	EACH	18
60600605	CONCRETE CURB, TYPE B	FOOT	1078
67100100	MOBILIZATION	LSUM	1
X0327618	LANDSCAPING (SPECIAL)	LSUM	1
X4240126	BRICK SIDEWALK	SQ FT	104
* X6640300	CHAIN LINK FENCE REMOVAL	FOOT	9
* X6640308	CHAIN LINK GATES (SPECIAL)	EACH	1
X7010216	TRAFFIC CONTROL AND PROTECTION (SPECIAL)	LSUM	1

\* = SPECIALTY ITEM

**CONTRACT NO. 87881**

DRAWN BY: KED	REVISIONS			
CHECKED BY: AJO	LEVEL	BY	DATE	DESCRIPTION
DATE: 12/2024				



PERU MORRIS  
OTTAWA MORTON  
ILLINOIS

**CITY OF MENDOTA**  
**SAFE ROUTES TO SCHOOL**  
**SECTION 24-00064-00-SW**

**SUMMARY OF QUANTITIES**

CURRENT AS OF: 2/7/2025	
SCALE: AS NOTED	SHEET 3
FILE NO.: 66499.00 Y-	OF 12

SIDEWALK AND DRIVEWAY SCHEDULE

	SIDEWALK REMOVAL	PORTLAND CEMENT CONCRETE SIDEWALK, 4 INCH	BRICK SIDEWALK	DRIVEWAY PAVEMENT REMOVAL	PORTLAND CEMENT CONCRETE DRIVEWAY PAVEMENT, 6 INCH	CURB REMOVAL	CONCRETE CURB TYPE B	INCIDENTAL HOT-MIX ASPHALT SURFACING	BITUMINOUS MATERIALS, PRIME COAT	BITUMINOUS MATERIALS, TACK COAT	AGGREGATE BASE COURSE, TYPE B	AGGREGATE SURFACE COURSE, TYPE B	WATER SERVICE BOXES TO BE ADJUSTED	DETECTABLE WARNINGS	INLETS TO BE ADJUSTED	PEDESTRIAN CROSSING/ RAMP HIGHWAY STANDARD NUMBER
UNIT:	SQ FT	SQ FT	SQ FT	SQ YD	SQ YD	FOOT	FOOT	TON	POUND	POUND	TON	TON	EACH	SQ FT	EACH	
PAY ITEM #:	44000600	42400100	X4240126	44000200	42300200	44000300	60600605	40800050	40800025	40800029	35101400	40200800	56500600	42400800	60260100	
<b>LOCATION</b>																
<b>EIGHTH STREET</b>																
FIFTH AVE. NW QUADRANT	276	297				43	43	3.0	25	3	12.1			18	2	424001
FIFTH AVE. NE QUADRANT	142	151				48	48	3.4	27	3	9.0			16	1	424001
FIFTH AVE. SW QUADRANT	166	178	20			42	42	3.0	24	3	9.6			18	1	424001
S. SIDE: FIFTH AVE. TO FOURTH AVE.	1584	1882		62	20	91	91	21.5	173	18	74.3	12	1	26	2	424001
FOURTH AVE. NW QUADRANT	286	326				43	43	3.0	25	3	12.9			16	1	424001
N. SIDE: FOURTH AVE. TO 3RD AVE.	617	1848	44	60	38	78	78	12.8	103	11	70.9			24	2	424001
<b>THIRD AVENUE</b>																
W. SIDE: SEVENTH ST. TO EIGHTH ST.	381	2709				451	451	38.4	309	31	122.6			43	3	424001/424021
EIGHTH ST. SE QUADRANT	101	106				30	30	2.2	18	2	6.0			8		424001
<b>SEVENTH STREET</b>																
FOURTH AVE. NW QUADRANT	187	198				38	38	2.7	22	3	9.2			18	1	424001
FOURTH AVE. SW QUADRANT	184	164	20			46	46	3.2	26	3	9.6			16	2	424001
S. SIDE FOURTH AVE. TO THIRD AVE.	1460	1673		117	33	135	135	35.6	286	29	85.6			34	3	424001
THIRD AVE. SE QUADRANT	110	131				33	33	2.4	20	2	7.0			18		424001
N. SIDE: THIRD AVE. TO ALLEY	575	523	20	50	51			2.1	17	2	27.1					
TOTAL QUANTITY	<b>6069</b>	<b>10186</b>	<b>104</b>	<b>289</b>	<b>142</b>	<b>1078</b>	<b>1078</b>	<b>133</b>	<b>1075</b>	<b>113</b>	<b>456</b>	<b>12</b>	<b>1</b>	<b>255</b>	<b>18</b>	

NOTE: QUANTITIES FOR AGGREGATE BASE COURSE INCLUDE 4" BENEATH ALL DRIVEWAY PAVEMENTS, SIDEWALKS, INCIDENTAL HMA, AND CURBS.

PAVEMENT MARKING SCHEDULE - FOR REFERENCE ONLY		
	PAINT PAVEMENT MARKING, LINE - 24"	PAINT PAVEMENT MARKING, LINE - 6"
UNIT:	FOOT	FOOT
PAY ITEM #:	78001180	78001130
<b>LOCATION</b>		
INTERSECTION OF EIGHTH ST. AND FOURTH AVE.	55	219
INTERSECTION OF EIGHTH ST. AND THIRD AVE.	28	113
INTERSECTION OF SEVENTH ST. AND FOURTH AVE.	53	217
INTERSECTION OF SEVENTH ST. AND THIRD AVE.	53	225

NOTE: PAVEMENT MARKING QUANTITIES ARE SHOWN FOR INFORMATION ONLY. PAVEMENT MARKINGS WILL BE COMPLETED BY OTHERS FOLLOWING ROADWAY RESURFACING AS PART OF A SEPARATE PROJECT.

CONTRACT NO. 87881

CHAMLIN & ASSOCIATES, INC. © 2025  
Drawing Name: G:\Users\VA\66499-00-Mendota Safe Routes to School 2024\CAD\04-SCHEDULES.dwg Last Modified: Friday, February 7, 2025 1:19:20 PM Plotted On: Friday, February 7, 2025 3:24:56 PM by Adam Osola

DRAWN BY: KED	REVISIONS		
CHECKED BY: AJO	LEVEL	BY	DATE
DATE: 12/2024			



PERU MORRIS  
OTTAWA MORTON  
ILLINOIS

**CITY OF MENDOTA**  
**SAFE ROUTES TO SCHOOL**  
**SECTION 24-00064-00-SW**

**SCHEDULE OF QUANTITIES**

CURRENT AS OF: 2/7/2025	
SCALE: AS NOTED	SHEET 4
FILE NO.: 66499.00 Y-	OF 12

CHAMLIN & ASSOCIATES, INC. © 2025  
 Drawing Number: 24-00064-00-00-Mendota Safe Routes to School 2024\CAD\005-SHEET-INDEX.dwg  
 Last Modified: Tuesday, February 4, 2025 3:40:16 PM  
 Plotted On: Friday, February 7, 2025 8:11:51 AM  
 by Adam Casola

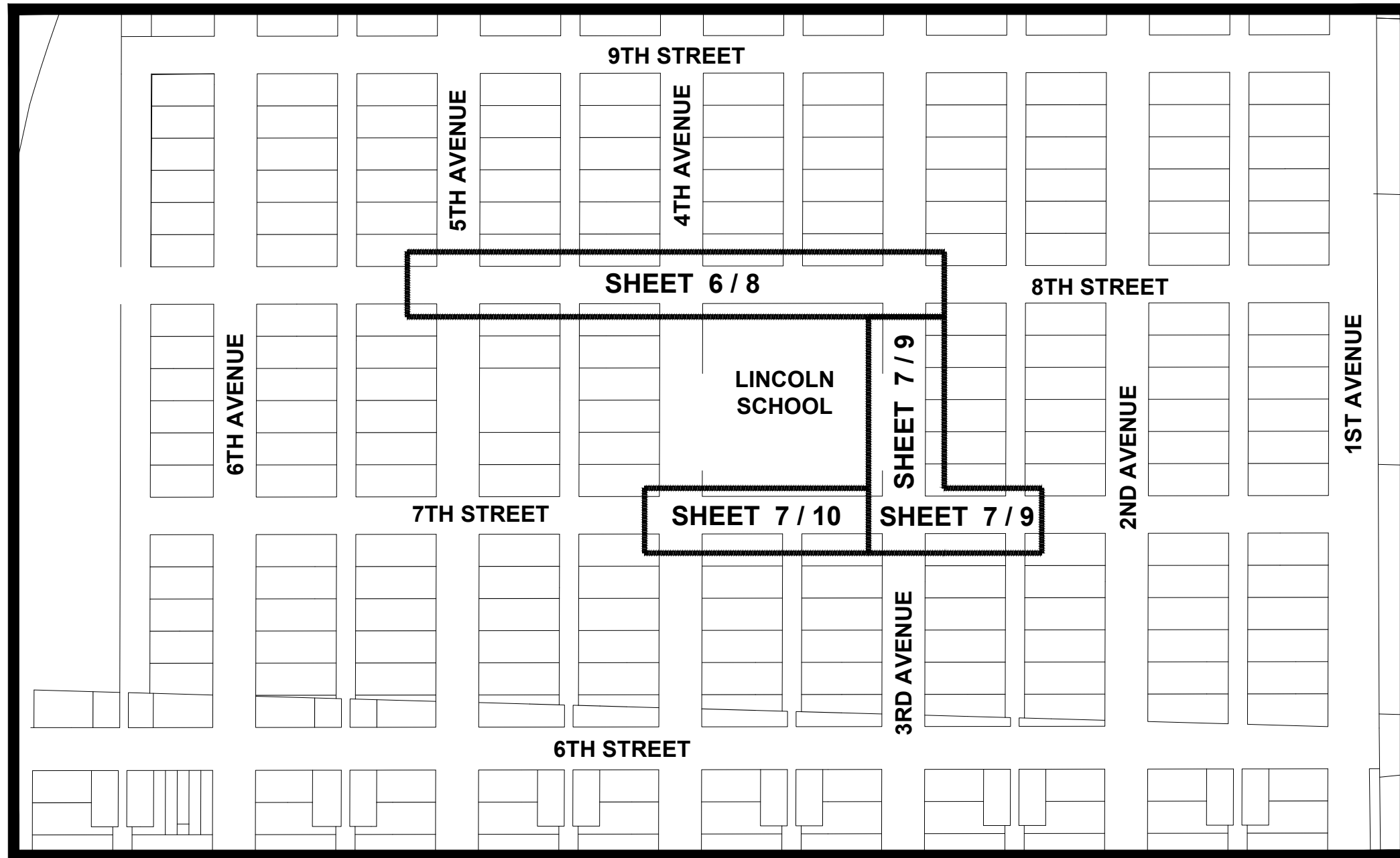

**PROJECT OVERVIEW MAP**  
 (NOT TO SCALE)

**CONTRACT NO. 87881**

DRAWN BY: AJO	REVISIONS		
CHECKED BY: AJO	LEVEL	BY	DATE
DATE: 12/2024			



PERU MORRIS  
 OTTAWA MORTON  
 ILLINOIS  
 Chamlin & Associates

**CITY OF MENDOTA**  
**SAFE ROUTES TO SCHOOL**  
**SECTION 24-00064-00-SW**

**KEY MAP**

CURRENT AS OF: 2/4/2025	
SCALE: AS NOTED	SHEET 5
FILE NO.: 66499.00 Y-	OF 12

CHAMLIN & ASSOCIATES, INC. © 2025  
 Drawing Name: G:\Users\AJO\OneDrive - Chamlin & Associates, Inc.\Desktop\2024\24-0064-00-REM-EIGHTH STREET.dwg  
 Last Modified: Friday, February 7, 2025 9:43:14 AM  
 Plotted On: Friday, February 7, 2025 9:59:59 AM by Adam Orsola

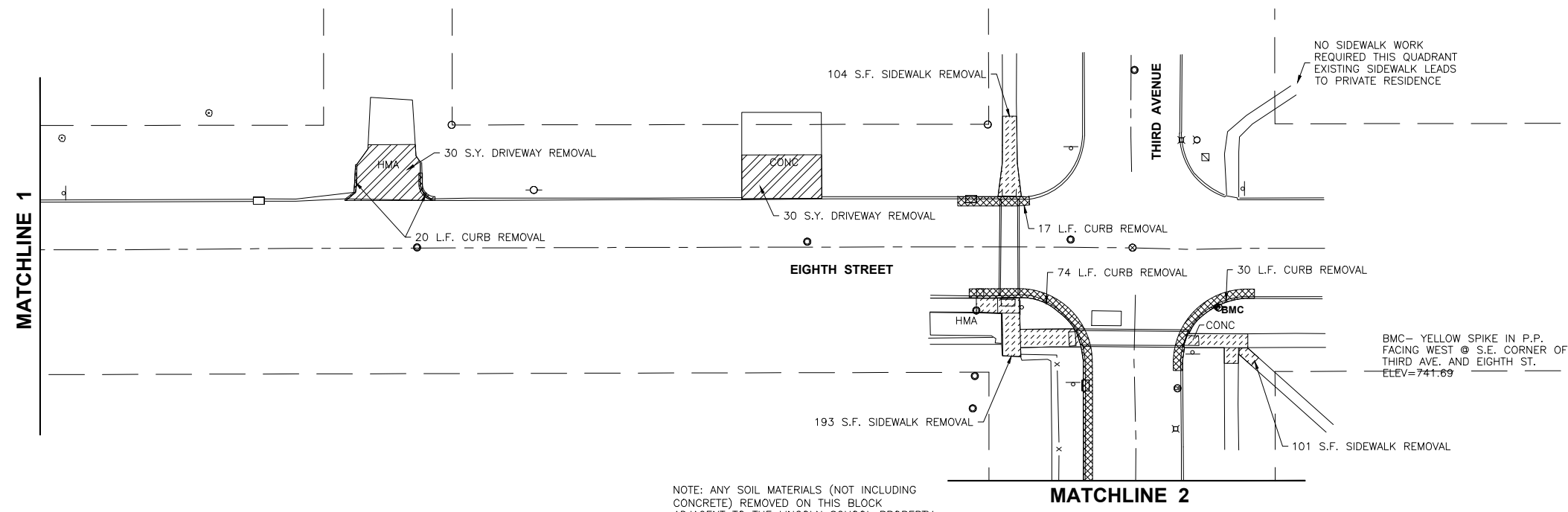
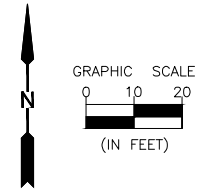
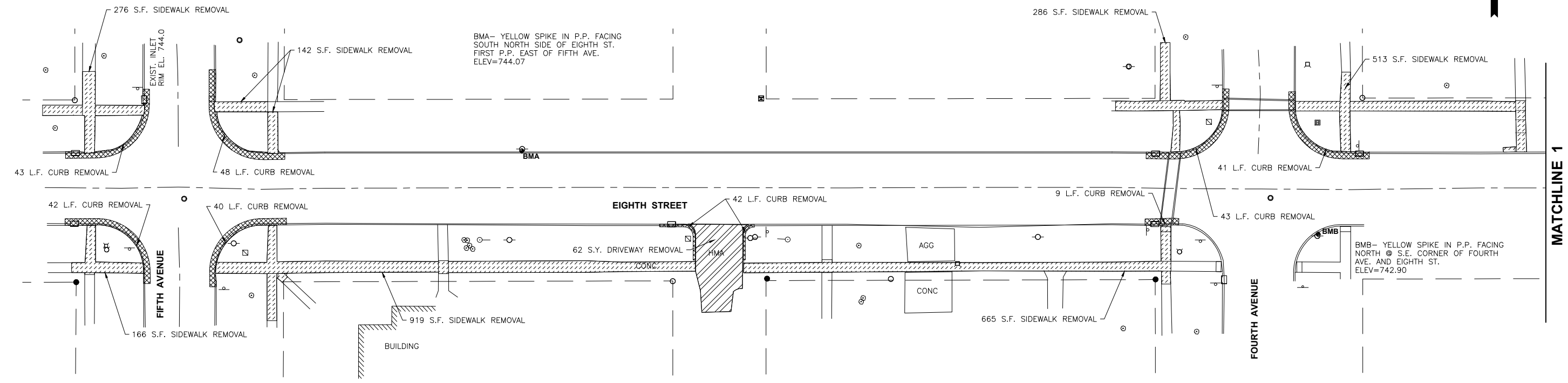
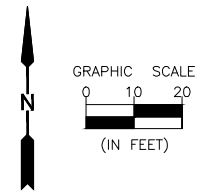

LEGEND	
	SIDEWALK REMOVAL
	DRIVEWAY REMOVAL
	CURB REMOVAL

NOTE: ANY SOIL MATERIALS (NOT INCLUDING CONCRETE) REMOVED ON THIS BLOCK ADJACENT TO THE LINCOLN SCHOOL PROPERTY SHALL REMAIN WITHIN THE RIGHT-OF-WAY ADJACENT TO THE LINCOLN SCHOOL PROPERTY. SOIL MATERIALS SHALL BE SPREAD OUT WITHIN THE RIGHT-OF-WAY WITHIN LIMITS SPECIFIED BY THE RESIDENT ENGINEER IN THE FIELD.

CONTRACT NO. 87881

LEVEL	BY	DATE	REVISIONS	DESCRIPTION



PERU OTTAWA  
 MORRIS MORTON  
 ILLINOIS

CITY OF MENDOTA  
 SAFE ROUTES TO SCHOOL  
 SECTION 24-0064-00-SW

REMOVAL PLAN  
 EIGHTH STREET

CURRENT AS OF: 02/07/2025	SHEET 6
SCALE: AS NOTED	OF 12
FILE NO.: 66499.00 Y-	

NOTE: ANY SOIL MATERIALS (NOT INCLUDING CONCRETE) REMOVED ON THIS BLOCK ADJACENT TO THE LINCOLN SCHOOL PROPERTY SHALL REMAIN WITHIN THE RIGHT-OF-WAY ADJACENT TO THE LINCOLN SCHOOL PROPERTY. SOIL MATERIALS SHALL BE SPREAD OUT WITHIN THE RIGHT-OF-WAY WEST OF THE FENCE WITHIN LIMITS SPECIFIED BY THE RESIDENT ENGINEER IN THE FIELD.

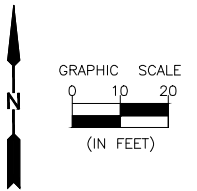
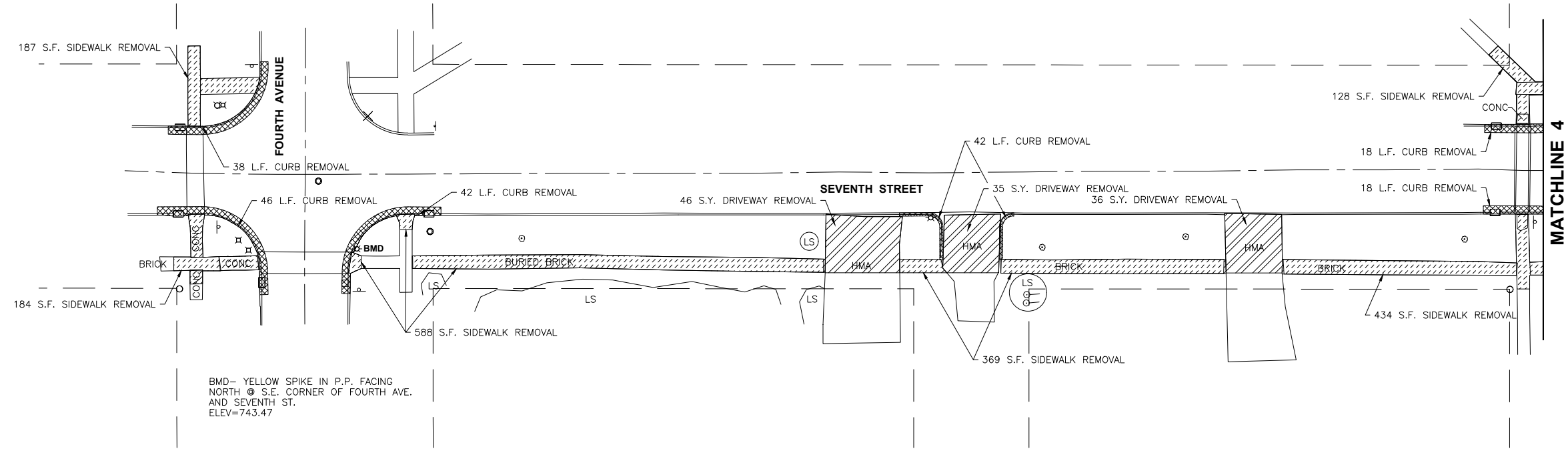
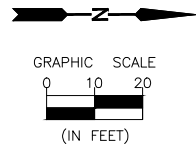
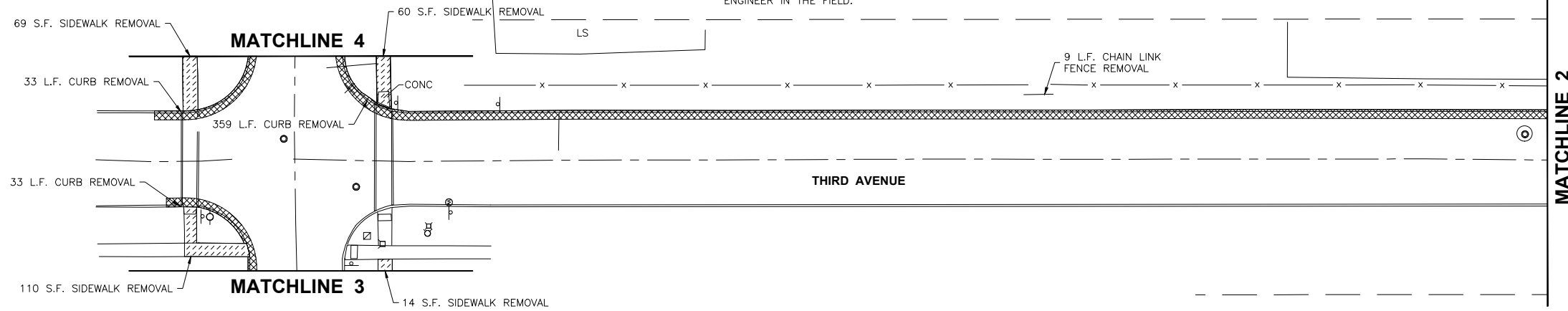

BMD- YELLOW SPIKE IN P.P. FACING NORTH @ S.E. CORNER OF FOURTH AVE. AND SEVENTH ST. ELEV=743.47

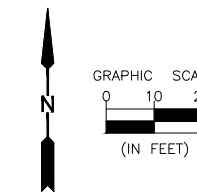
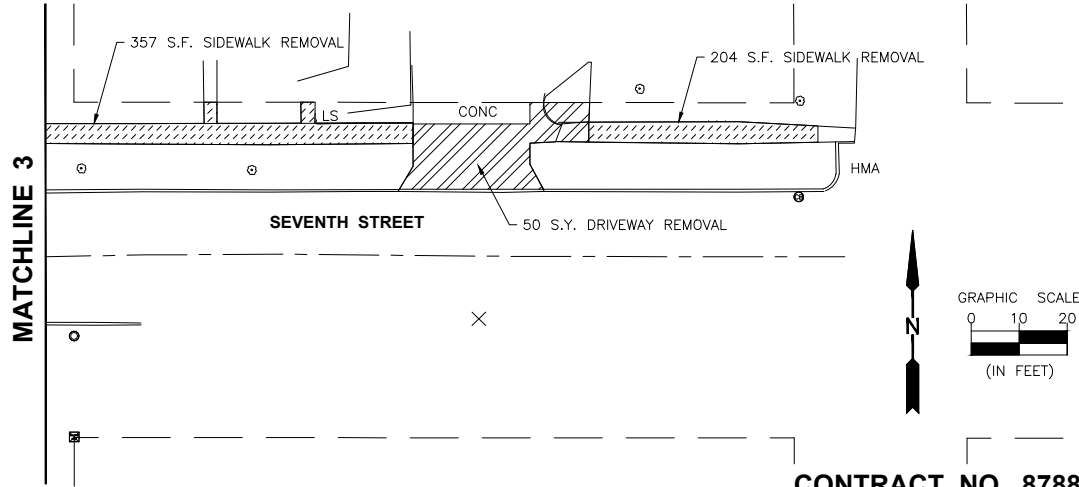
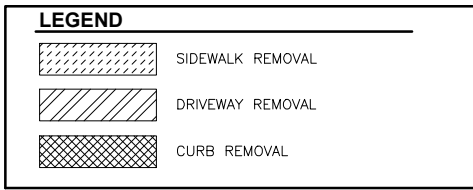

**CONTRACT NO. 87881**

CHAMLIN & ASSOCIATES, INC. © 2025  
Drawing Name: G:\Users\AJO\OneDrive - Mendota Safe Routes to School\2024\CAD\007-REM-THIRD AVE.dwg  
Last Modified: Friday, February 7, 2025 9:57:48 AM  
Printed On: Friday, February 7, 2025 9:58:38 AM  
By: Adam Dasica

DRAWN BY: LMP	REVISIONS			
CHECKED BY: AJO	LEVEL	BY	DATE	DESCRIPTION
DATE: 10/2024				



PERU OTTAWA  
MORRIS MORTON  
ILLINOIS

**CITY OF MENDOTA  
SAFE ROUTES TO SCHOOL  
SECTION 24-0064-00-SW**

**REMOVAL PLAN  
THIRD AVE & SEVENTH STREET**

CURRENT AS OF: 02/7/2025	
SCALE: AS NOTED	SHEET 7
FILE NO.: 66499.00 Y-	OF 12



CHAMLIN & ASSOCIATES, INC. © 2025  
 Drawing Name: G:\Users\ajm\OneDrive\Desktop\Safe Routes to School\2024\CAD\08-PLAN-EIGHTH STREET.dwg  
 Last Modified: Friday, February 7, 2025 11:12:49 AM  
 Plotted On: Friday, February 7, 2025 11:13:42 AM  
 By: Adam Orsola

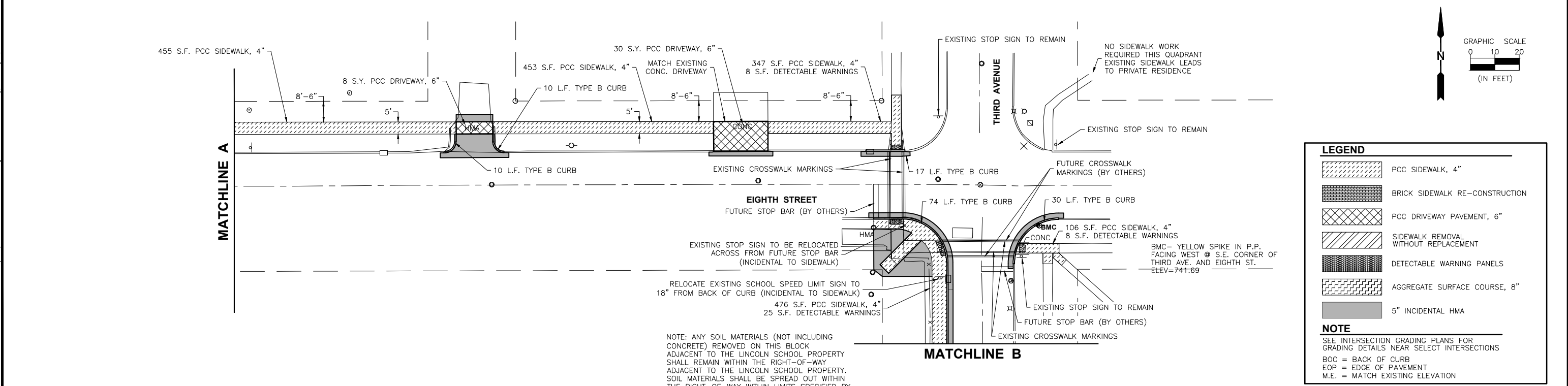
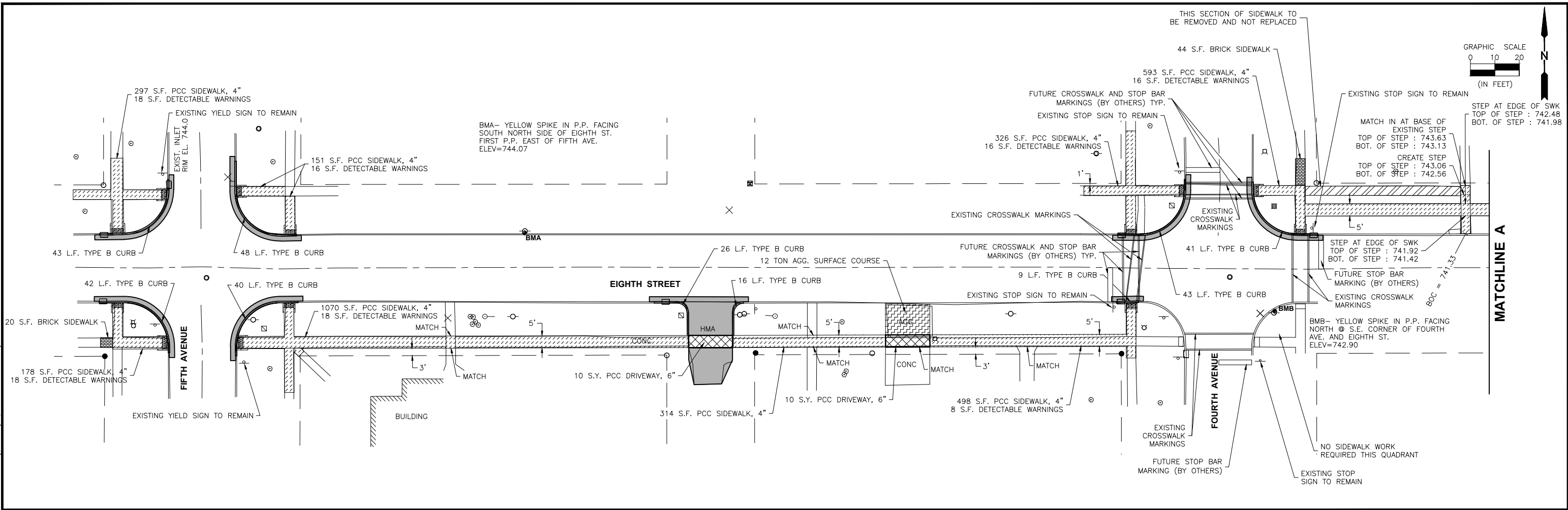

**LEGEND**

- PCC SIDEWALK, 4"
- BRICK SIDEWALK RE-CONSTRUCTION
- PCC DRIVEWAY PAVEMENT, 6"
- SIDEWALK REMOVAL WITHOUT REPLACEMENT
- DETECTABLE WARNING PANELS
- AGGREGATE SURFACE COURSE, 8"
- 5" INCIDENTAL HMA

**NOTE**

SEE INTERSECTION GRADING PLANS FOR GRADING DETAILS NEAR SELECT INTERSECTIONS

BOC = BACK OF CURB  
 EOP = EDGE OF PAVEMENT  
 M.E. = MATCH EXISTING ELEVATION

DRAWN BY: LMP	REVISIONS			
	LEVEL	BY	DATE	DESCRIPTION
CHECKED BY: AJO				
DATE: 10/2024				



**CITY OF MENDOTA**  
**SAFE ROUTES TO SCHOOL**  
**SECTION 24-0064-00-SW**

**PLAN SHEET**  
**EIGHTH STREET**

CURRENT AS OF: 02/07/2025	
SCALE: AS NOTED	SHEET 8
FILE NO.: 66499.00 Y-	OF 12

**CONTRACT NO. 87881**







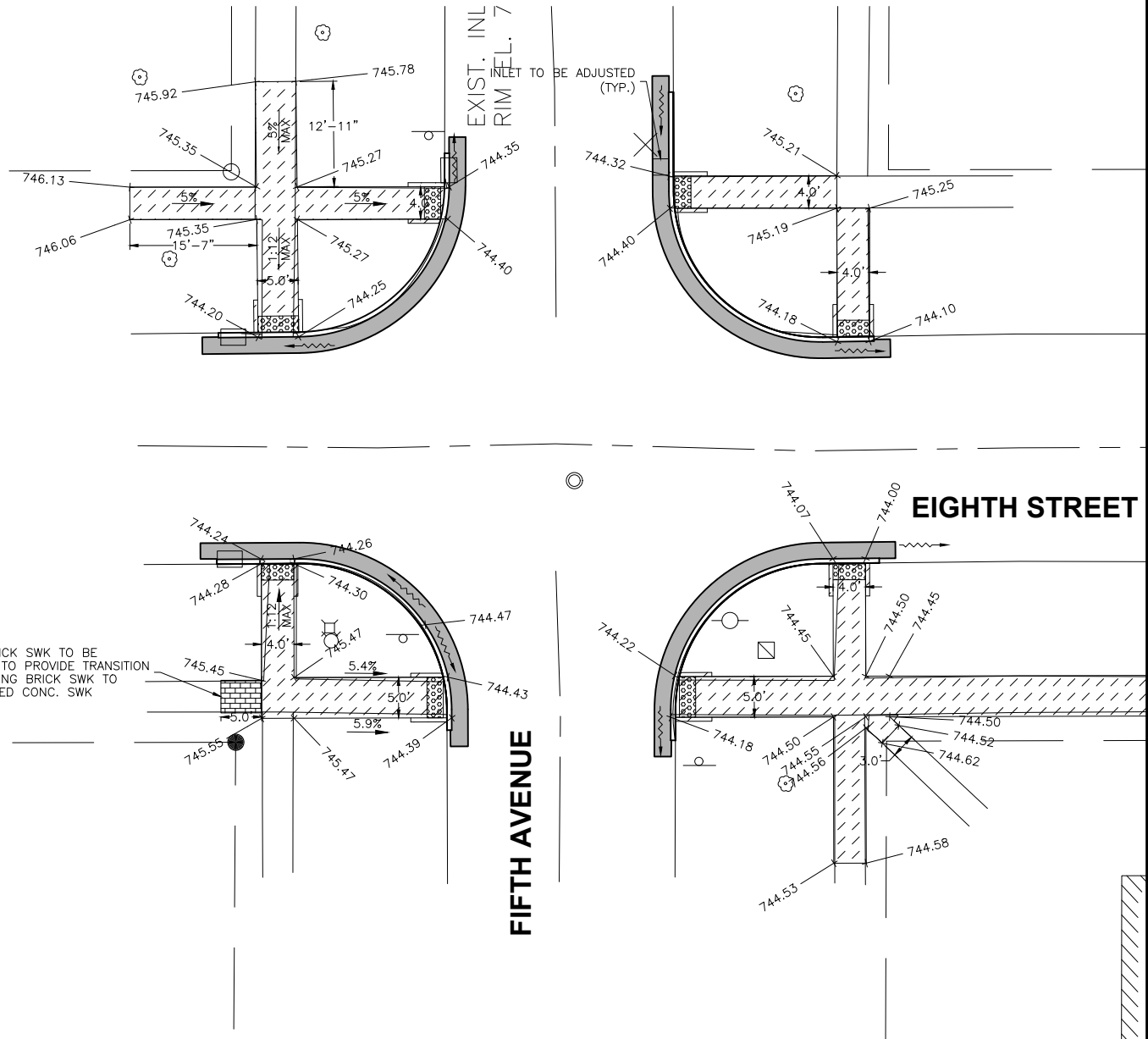
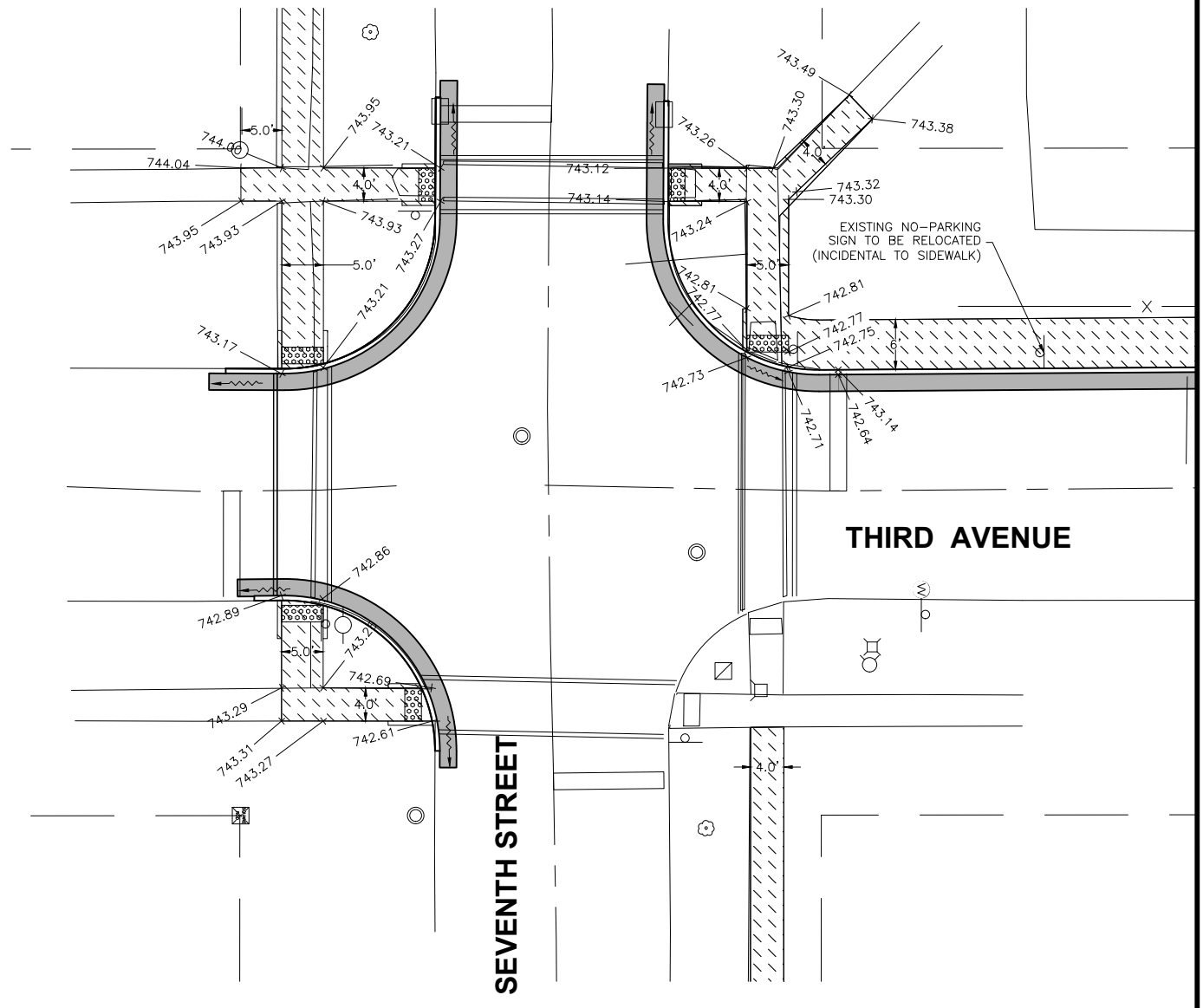
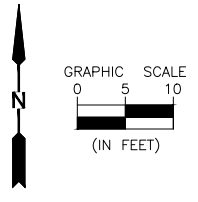
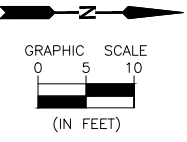

CHAMLIN & ASSOCIATES, INC. © 2024  
 Drawing Name: G:\Users\AJO\OneDrive - Chamlin & Associates, Inc.\Desktop\24-00064-00-SW-Mendota Safe Routes to School 2024\CAD\011-012-INTER-DETAILS.dwg Last Modified: Friday, February 7, 2025 2:45:04 PM Plotted On: Friday, February 7, 2025 2:45:36 PM by Adm. Otsola

DRAWN BY: LMP	REVISIONS			
CHECKED BY: AJO	LEVEL	BY	DATE	DESCRIPTION
DATE: 10/2024				

**PERU OTTAWA**  
**MORRIS MORTON**  
**ILLINOIS**

**CITY OF MENDOTA**  
**SAFE ROUTES TO SCHOOL**  
**SECTION 24-00064-00-SW**

**INTERSECTION DETAILS**

CONTRACT NO. 87881	
CURRENT AS OF: 02/07/2025	
SCALE: AS NOTED	SHEET 11
FILE NO.: 66499.00 Y-	OF 12



