

DATE	
BY	
DESIGNED	
DRAWN	
CHECKED	
IN CHARGE	
DATE	
NOTE BOOK NO.	
FILE NAME	

DATE	
BY	
DESIGNED	
DRAWN	
CHECKED	
IN CHARGE	
DATE	
NOTE BOOK NO.	
FILE NAME	

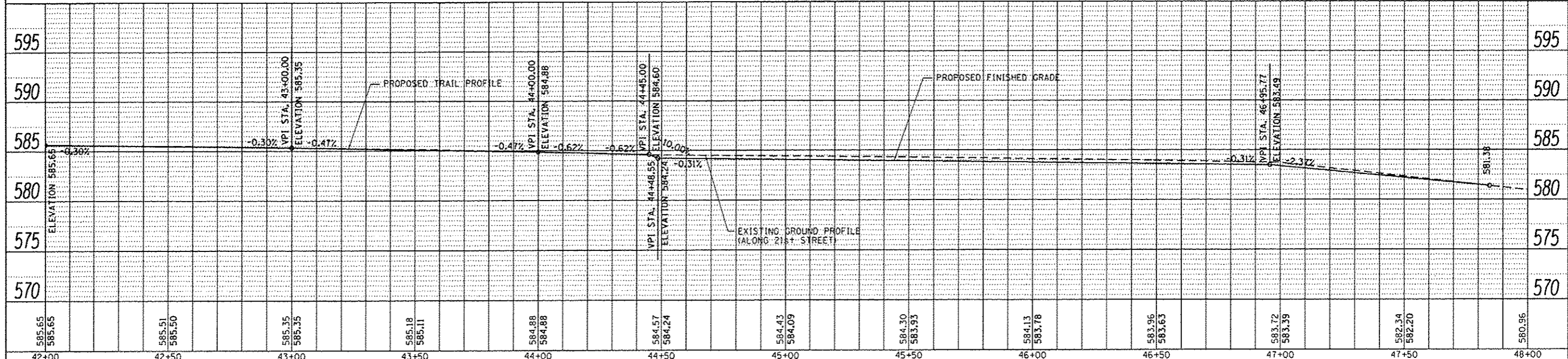

585.65 585.65	585.51 585.50	585.35 585.35	585.18 585.11	584.88 584.88	584.57 584.24	584.43 584.09	584.30 583.93	584.13 583.78	583.96 583.63	583.72 583.39	582.34 582.20	580.96
42+00	42+50	43+00	43+50	44+00	44+50	45+00	45+50	46+00	46+50	47+00	47+50	48+00

FILE NAME :	USER NAME :	DESIGNED :	REVISED :
L:\1001\1186618\WD_7\Draw\C400_Sheets\13-NP808.dgn	Matt Overbey	MJO	-
		DRAWN :	REVISED :
		MJO	-
		CHECKED :	REVISED :
		SPH	-
		DATE :	REVISED :
		2/1/2013	-

DESIGNED :	REVISED :
MJO	-
DRAWN :	REVISED :
MJO	-
CHECKED :	REVISED :
SPH	-
DATE :	REVISED :
2/1/2013	-

**STATE OF ILLINOIS  
DEPARTMENT OF TRANSPORTATION**

**PLAN AND PROFILE - 21st STREET - ELEMENT 3  
IDNR ILLINOIS BEACH STATE PARK**

SCALE: SHEET 8 OF 16 SHEETS STA. TO STA.

F.A.P. RTE.	SECTION	COUNTY	TOTAL SHEETS	SHEET NO.
N/A	PARK ROADS	LAKE	60	45
IDNR NO. 2-12-DIO		CONTRACT NO. 46250		
ILLINOIS FED. AID PROJECT				